

Rural Payments Agency
1 of 5

Rural Land Register (RLR) Map

SBI - 106284031
Page 1 of 2

Legend

- Your RLR Parcel(s)
- SPS Permanent Ineligible Features
- Adjacent Parcel Boundary
- Unconfirmed Boundary

RLR Information

Sheet ID	Parcel ID	Total Area (ha)	SPS Recorded Eligible Area (ha)	English Region
SD7339	6472	1.06	1.06	N
SD7339	5279	1.12	1.12	N
SD7339	4186	1.59	1.59	N
SD7340	3001	2.13	2.13	N
SD7339	3090	0.93	0.93	N
		6.83		

Scale - 1:5000

W 50m 0m 50m 100m 150m 200m E

You are not permitted to copy, sub-license, distribute or sell any of this data to third parties in any form.
© Crown copyright and database right 2013. All rights reserved.
Ordnance Survey Licence number 100029155
Licensed for RPA for PGA through Next Perspectives™

Date: 01/04/2015

374000

374500

375000

375500



Rural Land Register (RLR) Map

2 of 5

SBI - 106284031
Page 2 of 2

Legend

- Your RLR Parcel(s)
- SPS Permanent Ineligible Features
- Adjacent Parcel Boundary
- Unconfirmed Boundary

RLR Information

Sheet ID	Parcel ID	Total Area (ha)	SPS Recorded Eligible Area (ha)	English Region
SD7437	2599	1.26	1.25	N
SD7437	3195	1.64	1.64	N
SD7437	4588	5.47	5.47	N
SD7438	3809	0.86	0.86	N
SD7437	6867	1.19	1.19	N
SD7437	0785	0.70	0.70	N
SD7437	4762	1.03	1.03	N
SD7438	1503	1.07	1.07	N
		13.22		

438000

438000

437500

437500

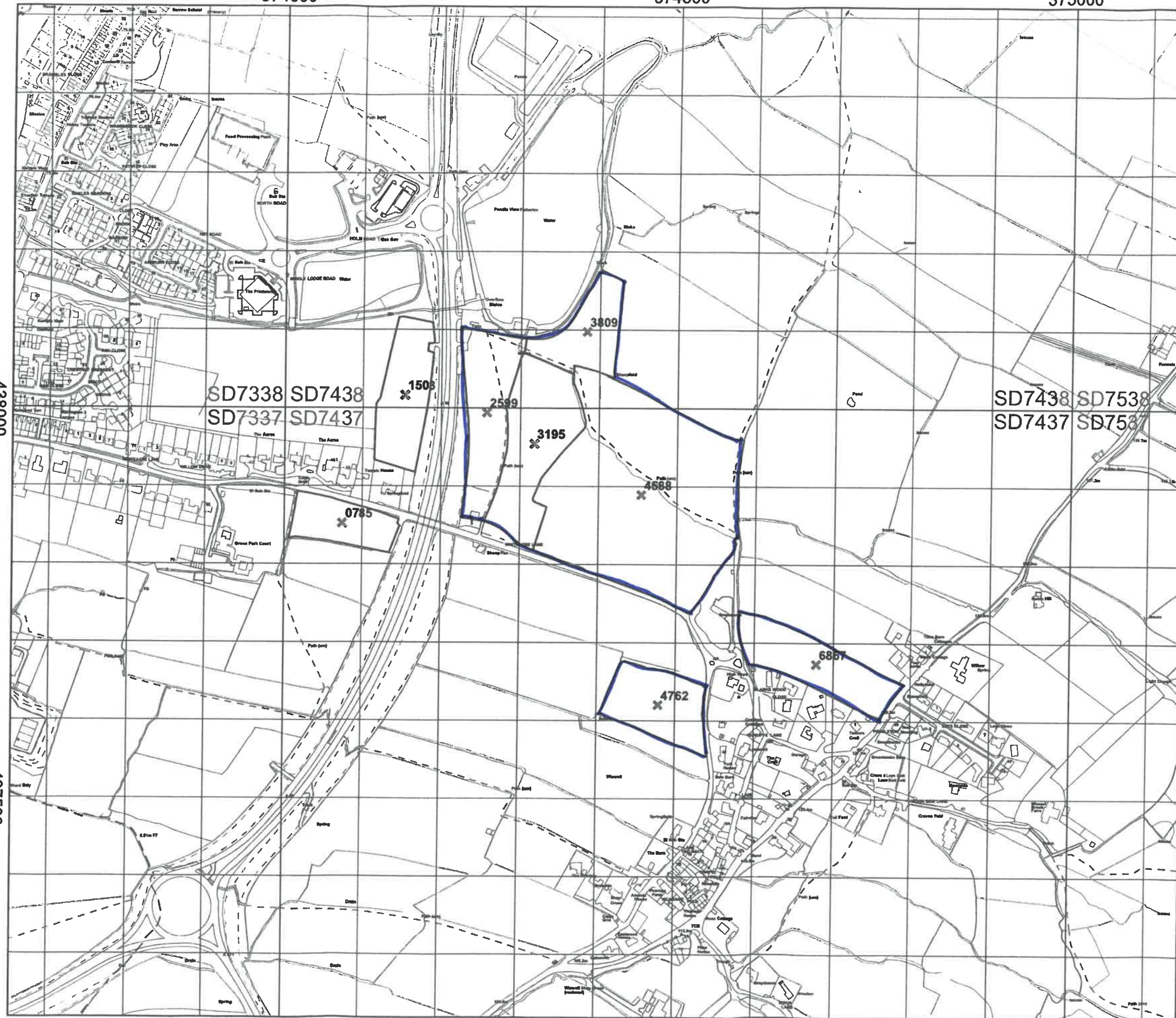

You are not permitted to copy, sub-license, distribute or sell any of this data to third parties in any form.
 © Crown copyright and database right 2013. All rights reserved.
 Ordnance Survey Licence number 100029155
 Licensed for RPA for PGA through Next Perspectives™

Date: 01/04/2015

374000

374500

375000

375500

Please return this sheet to us if you want to make any changes to the parcels shown on it.

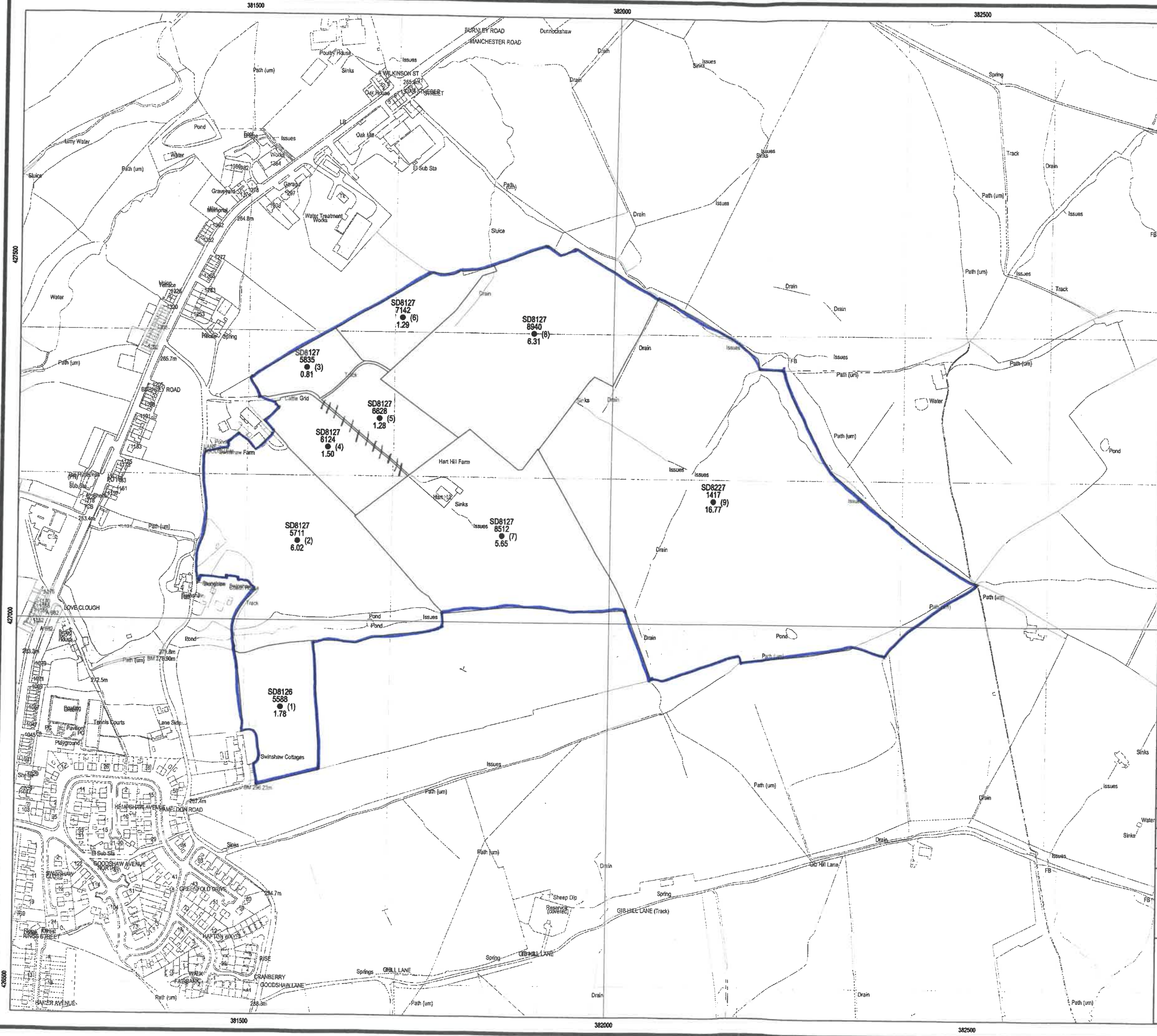

Main Holding Number
21/387/0513

Sheet Holding Number : **21/387/0513**

Updated IACS 2002 Information

Plot ID	Map Sheet	Field Nos.	Original Field Size (ha)	New Digital Field Size (ha)	Incorrect Boundary
	OS Map Sheet	NG Field			
1	SD8126	5588	1.78	1.78	
2	SD8127	5711	6.64	6.02	
3	SD8127	5835	0.81	0.81	
4	SD8127	6124	1.50	1.50	X
5	SD8127	6828	1.28	1.28	X
6	SD8127	7142	1.29	1.29	
7	SD8127	8512	5.54	5.65	
8	SD8127	8940	6.31	6.31	
9	SD8227	1417	16.79	16.77	

41.94

Print Name :

Signed : Date :

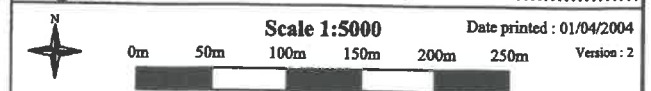

This map is reproduced from Ordnance Survey material with the permission of Ordnance Survey on behalf of the Controller of Her Majesty's Stationery Office. © Crown copyright. Unauthorised reproduction infringes Crown copyright and may lead to prosecution or civil proceedings. DEFRA licence No 100018880 2004

