

Peter Hitchen  
Architects

Marathon House  
The Sidings Business Park  
Whalley, BB7 9SE

01254 823 885

[www.peterhitchenarchitects.co.uk](http://www.peterhitchenarchitects.co.uk)

NOTES:

[illegible]

CLIENT:

## EARLY BAIRDS NURSERY

PROJECT:

ALTERATIONS TO THE JUDGE  
WALMSLEY, WHALLEY ROAD,  
BILLINGTON, BB7 9NT

SHEET:   

# PROPOSED SITE PLAN

Project number PHA/399

Date 19/12/2019

Drawn by RH

Checked by \_\_\_\_\_ PH \_\_\_\_\_

A101

Scale 1 : 200

Sheet size	A1
------------	----

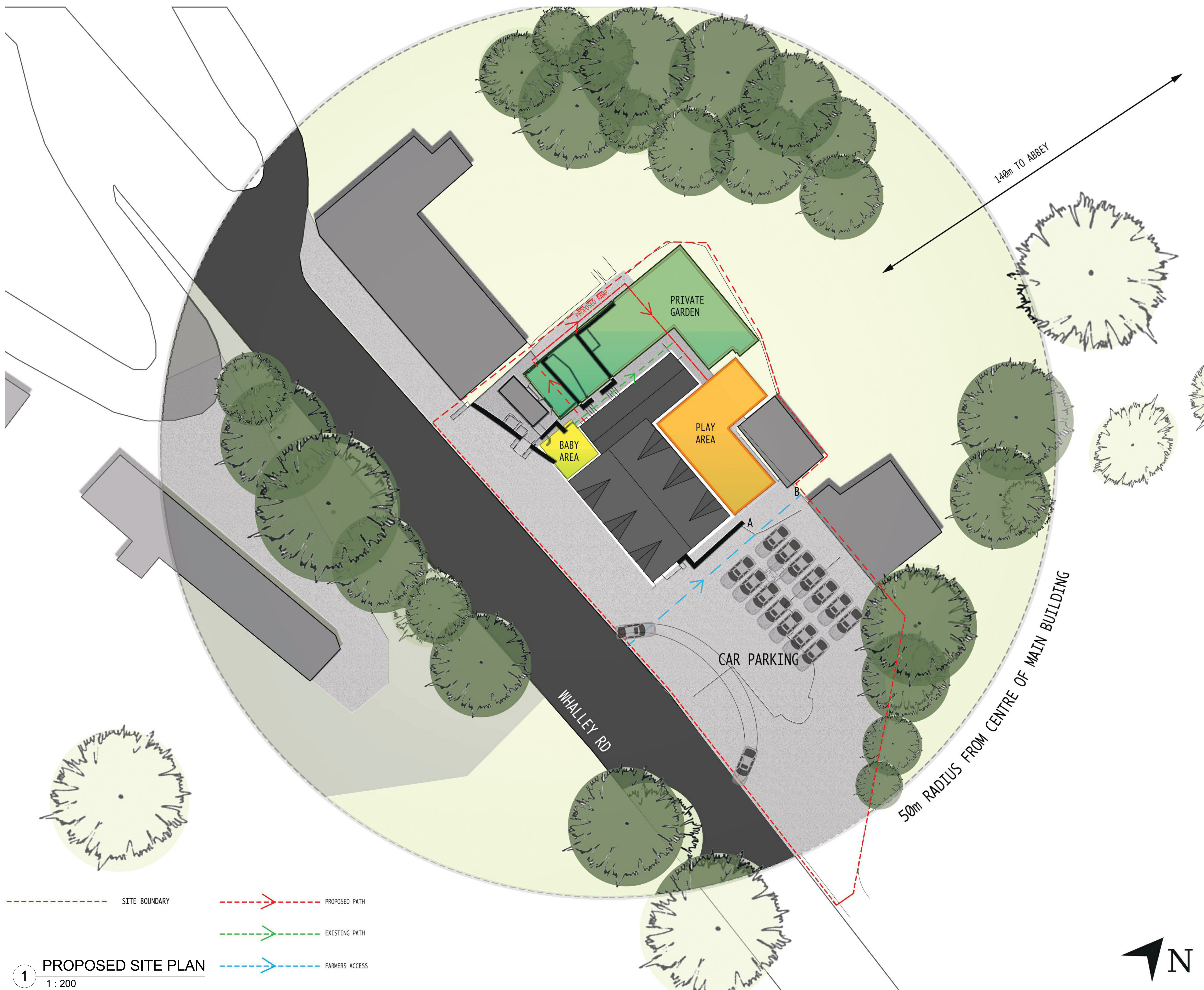

1

## PROPOSED SITE PLAN

1 : 200