

First Floor

KEY:

Existing to be removed

New Wall / Structure

A	Additional Survey Information Included	6-Sep-17	SJS	GLB
rev	description	date	drawn	check

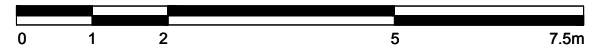

client

Onward Homes

project

Refurbishment to existing dwellings

No. 4 & No. 5 Beech Close

Clitheroe

drawing

Proposed Floor Plans

file name 19 0506 - SK101 SK201 Proposed Plans and Elevations	drawn 30-Sep-19
--	--------------------

drawing reference 19 0506 SK101	rev A	scale 1:100 @ A4
------------------------------------	----------	---------------------

issue status Feasibility	original by SJS
	checked by RJE

The copyright of this drawing is held by DC&MG Associates Limited, and no reproduction is allowed without prior permission. This drawing must be checked and verified by the contractor prior to work commencing on site. Liability shall not be taken for any defects in this drawing unless, prior to commencing, this drawing and all its dimensions have been so checked and verified. All drawings issued prior to being checked to be treated as draft. Do not scale.

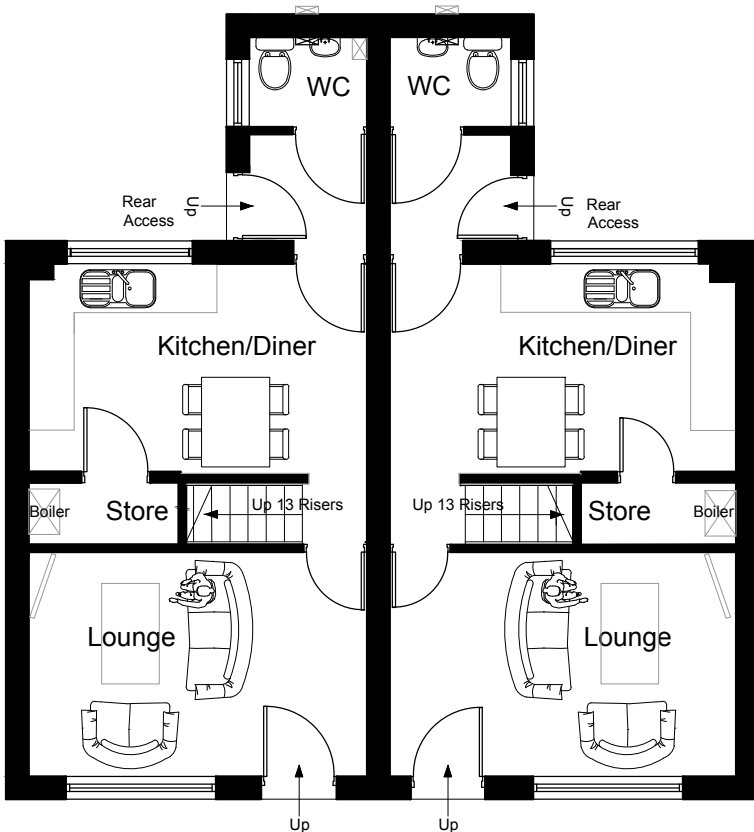

Ground Floor

No.5
Main Entrance

No.4
Main Entrance

DC&MG ASSOCIATES

DC&MG Associates, The Annexe, Rear of 29 Station Rd, Kirkham, Lancashire, PR4 2HA
 email@dcmgassociates.co.uk
 t: 01772 686 030
 www.dcmgassociates.co.uk