

Existing Site Plan - 1:1000

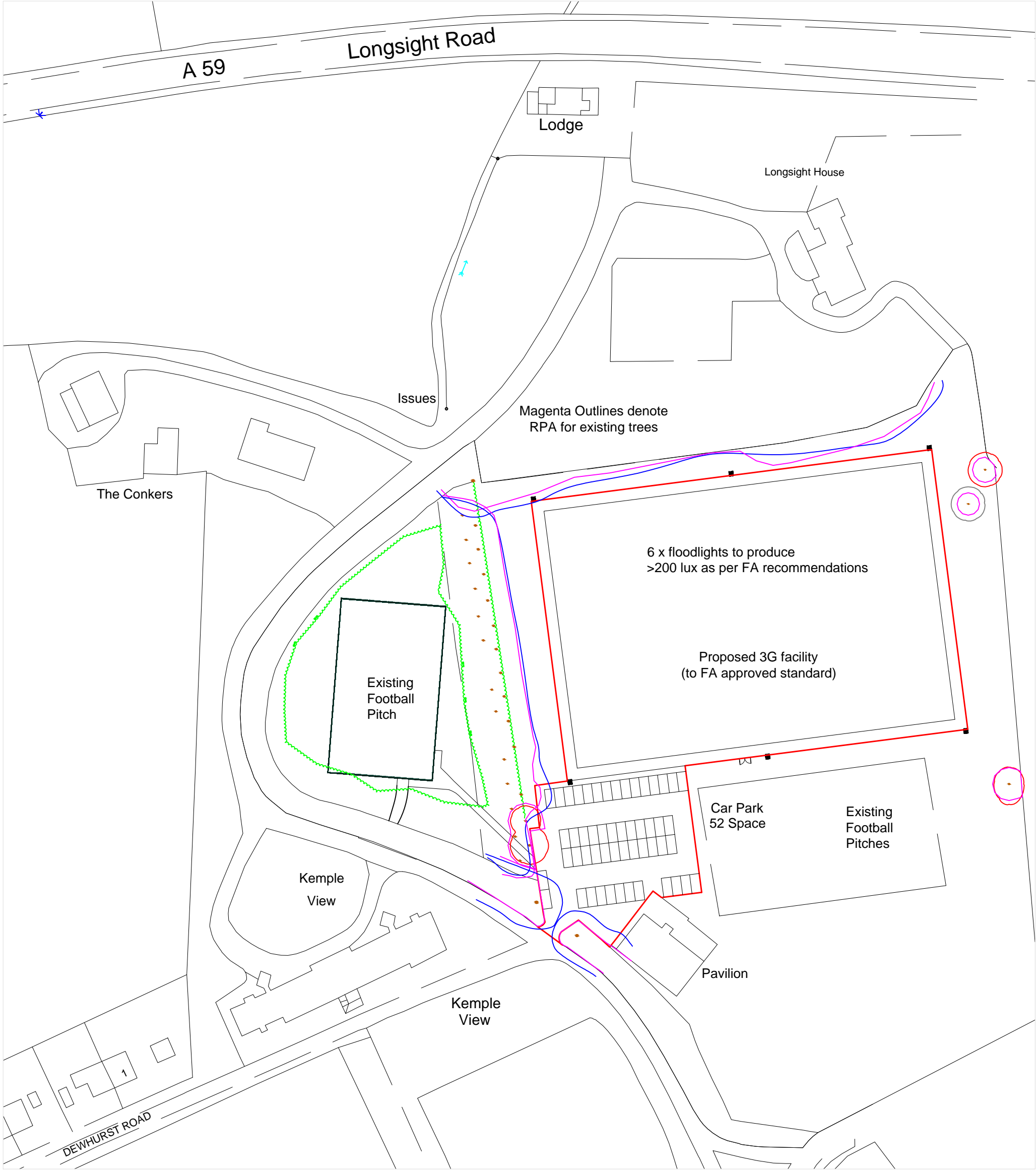

Proposed Site Plan - 1:1000

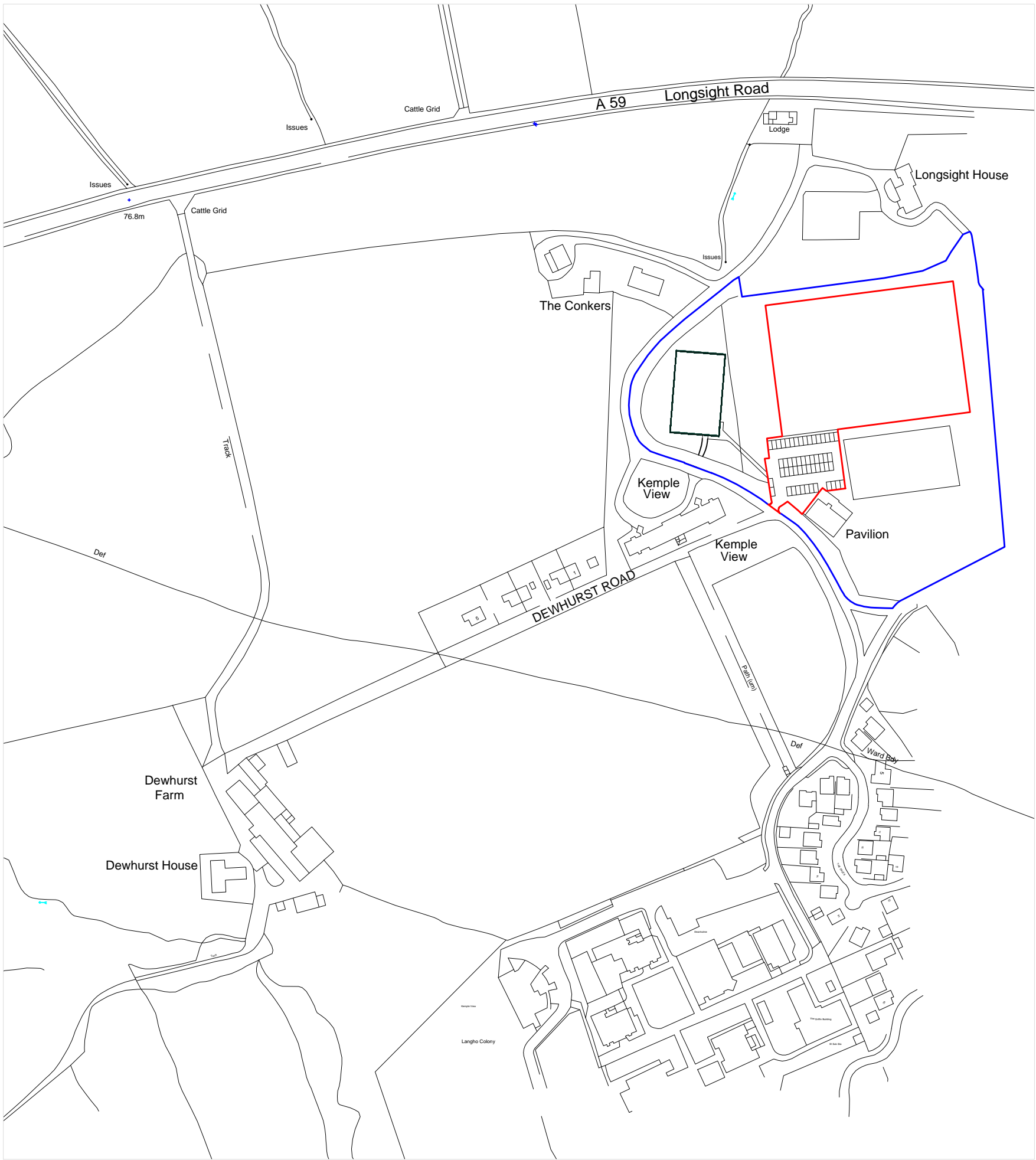

Location Plan - 1:2500

Notes:

Floodlight Specification -

6 x 15 metre high masts (M1 - M6).

Masts (M1, M3, M4, M6) carrying 2 x Philips BVP527 NB/A55

Masts (M2, M5) carrying 3 x Philips BVP527 NB/A55

Lamps = Philips LED

Illuminance Levels -

Initial - (100 hours) E.i.ave = 240 Lux

Maintained - (4000 hours) E.i.ave = 216 Lux

Uniformity - Emin / Eave = 0.68

Grid Values in Lux(initial)

Grid Interval = 5m.

Contour values in Lux (initial).

Contours: 5, 15, 25, 50 Lux.

Maintenance Factor = 0.90

Amendment C - 08.06.2020: Notes amended to reflect recommended lighting requirements.

Amendment B - 02.06.2020: Position of pitch amended and 1No. car parking space removed to avoid any impact on the RPA's of existing trees.

Amendment A - 29.05.2020: Tree Survey Data Added to Proposed Site Plan



Gary Hearty Associates
Suite 9 - Grindleton Business Centre
The Spinney
Grindleton, Clitheroe
Lancashire
BB7 2DG
T: 01200 449700
Email: paul@ghaonline.co.uk

Project: (Project Ref. No: Read.505.2827)

Proposed 3G Sports Facility at
Langho Football Sport & Country Club
Dewhurst Road
Langho
BB6 8AF

Title: Existing and Proposed Site Plans, Site Views,
Location Plan.

Drawing No: Read/505/2827/01

Drawn: PF

Client: Langho Football Club

Date: 29.05.2020

Scale:
1:200, 1:1000 & 1:2500 @ A1

Amendments

A B C

Site bounded by established Lime Trees approx 15 metres in height

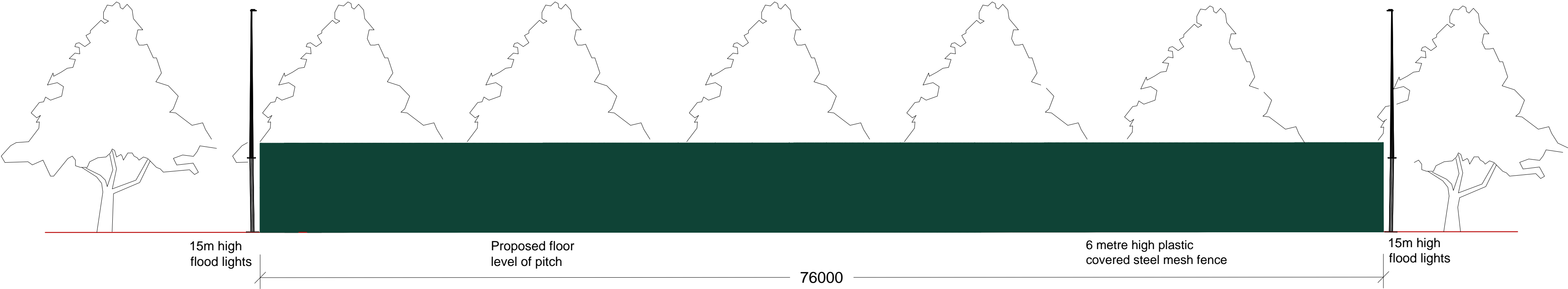

Proposed Westerly View into Site - 1:200

Site bounded by established Lime Trees approx 15 metres in height

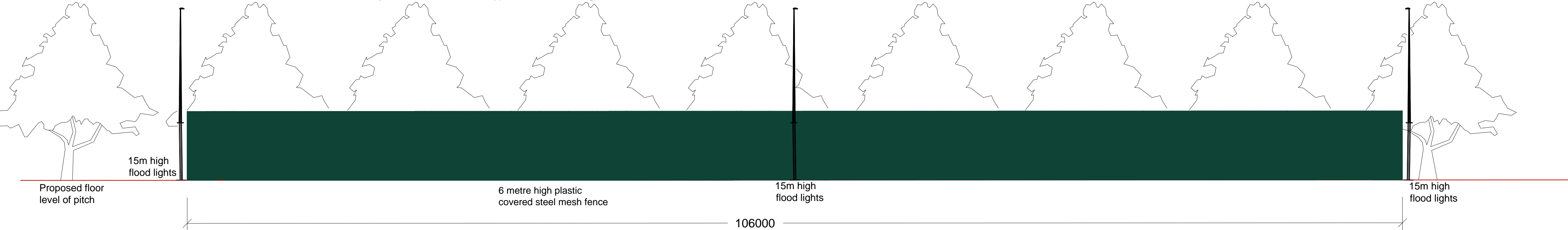

Proposed Northerly View into Site - 1:200