



RIBBLE VALLEY
BOROUGH COUNCIL

320200455P

For office use only

Application No.

Date received

Fee paid £

Receipt No:

Council Offices, Church Walk, Clitheroe, Lancashire. BB7 2RA

Tel: 01200 425111

www.ribblevalley.gov.uk

Application for tree works: works to trees subject to a tree preservation order (TPO)
and/or notification of proposed works to trees in a conservation area.

Town and Country Planning Act 1990

You can complete and submit this form electronically via the Planning Portal by visiting www.planningportal.gov.uk/apply

Publication of applications on planning authority websites

Please note that the information provided on this application form and in supporting documents may be published on the Authority's website. If you require any further clarification, please contact the Authority's planning department.

Please complete using block capitals and black ink.

You must use this form if you are applying for work to trees protected by a tree preservation order (TPO). (You may also use it to give notice of works to trees in a conservation area).

It is important that you read the accompanying guidance notes before filling in the form. Without the correct information, your application / notice cannot proceed.

1. Applicant Name and Address

Title:	MR	First name:	JAMES
Last name:	MERRIN		
Company (optional):			
Unit:		House number:	
		House suffix:	
House name:	BRAMLEY MEADE		
Address 1:	WISWELL LANE		
Address 2:	WHALLEY		
Address 3:			
Town:	CLITHEROE		
County:	LANCS		
Country:			
Postcode:	BB7 9AF9		

2. Agent Name and Address

Title:		First name:	
Last name:			
Company (optional):			
Unit:		House number:	
		House suffix:	
House name:			
Address 1:			
Address 2:			
Address 3:			
Town:			
County:			
Country:			
Postcode:			

3. Trees Location

If all trees stand at the address shown in Question 1, go to Question 4. Otherwise, please provide the full address/location of the site where the tree(s) stand (including full postcode where available)

Unit:	<input type="text"/>	House number:	<input type="text"/>	House suffix:	<input type="text"/>
House name:	<input type="text"/>				
Address 1:	<input type="text"/>				
Address 2:	<input type="text"/>				
Address 3:	<input type="text"/>				
Town:	<input type="text"/>				
County:	<input type="text"/>				
Postcode (if known):	<input type="text"/>				

If the location is unclear or there is not a full postal address, either describe as clearly as possible where it is (for example, 'Land to the rear of 12 to 18 High Street' or 'Woodland adjoining Elm Road') or provide an Ordnance Survey grid reference:

Description:

4. Trees Ownership

Is the applicant the owner of the tree(s): ☒ Yes ☐ No
If 'No' please provide the address of the owner (if known and if different from the trees location)

Title:	<input type="text"/>	First name:	<input type="text"/>
Last name:	<input type="text"/>		
Company (optional):	<input type="text"/>		
Unit:	<input type="text"/>	House number:	<input type="text"/>
House name:	<input type="text"/>		
Address 1:	<input type="text"/>		
Address 2:	<input type="text"/>		
Address 3:	<input type="text"/>		
Town:	<input type="text"/>		
County:	<input type="text"/>		
Country:	<input type="text"/>		
Postcode:	<input type="text"/>		

Telephone numbers

Country code:	National number:	Extension number:
<input type="text"/>	<input type="text"/>	<input type="text"/>

Country code: Mobile number (optional):

5. What Are You Applying For?

Are you seeking consent for works to tree(s) subject to a TPO? ☒ Yes ☐ No

Are you wishing to carry out works to tree(s) in a conservation area? ☐ Yes ☐ No

6. Tree Preservation Order Details

If you know which TPO protects the tree(s), enter its title or number below.

7. Identification Of Tree(s) And Description Of Works

Please identify the tree(s) and provide a full and clear specification of the works you want to carry out. Continue on a separate sheet if necessary. You might find it useful to contact an arborist (tree surgeon) for help with defining appropriate work. Where trees are protected by a TPO, please number them as shown in the First Schedule to the TPO where this is available. Use the same numbers on your sketch plan (see guidance notes).

Please provide the following information below : tree species (and the number used on the sketch plan) and description of works. Where trees are protected by a TPO you must also provide reasons for the work and, where trees are being felled, please give your proposals for planting replacement trees (including quantity, species, position and size) or reasons for not wanting to replant.

E.g. Oak (T3) - fell because of excessive shading and low amenity value. Replant with 1 standard ash in the same place.

93 1 ash to remove ash die back.
94 3 ash to remove " " "
T15 Retrenchment to prune lime tree in decline.
98 Sycamore to fell twin stemmed vshape included union

7. Identification Of Tree(s) And Description Of Works continued ...

8. Trees - Additional Information

Additional information may be attached to electronic communications or provided separately in paper format.

For all trees

A sketch plan clearly showing the position of trees listed in Question 7 must be provided when applying for works to trees covered by a TPO. A sketch plan is also advised when notifying the LPA of works to trees in a conservation area (see guidance notes). It would also be helpful if you provided details of any advice given on site by an LPA officer.

For works to trees covered by a TPO

Please indicate whether the reasons for carrying out the proposed works include any of the following. If so, your application must be accompanied by the necessary evidence to support your proposals. (See guidance notes for further details)

1. **Condition of the tree(s)** - e.g. it is diseased or you have fears that it might break or fall: ☒ Yes ☐ No
If YES, you are required to provide written arboricultural advice or other diagnostic information from an appropriate expert.
2. **Alleged damage to property** - e.g. subsidence or damage to drains or drives. ☐ Yes ☐ No
If YES, you are required to provide for:

Subsidence

A report by an engineer or surveyor, to include a description of damage, vegetation, monitoring data, soil, roots and repair proposals. Also a report from an arboriculturist to support the tree work proposals.

Other structural damage (e.g. drains, walls and hard surfaces)

Written technical evidence from an appropriate expert, including description of damage and possible solutions.

Documents and plans (for any tree)

Are you providing separate information (e.g. an additional schedule of work for Question 7)? ☒ Yes ☐ No

If YES, please provide the reference numbers of plans, documents, professional reports, photographs etc in support of your application. If they are being provided separately from this form, please detail how they are being submitted.

9. Authority Employee / Member

With respect to the Authority, I am:

- (a) a member of staff (c) related to a member of staff
(b) an elected member (d) related to an elected member

Do any of these statements apply to you?

☐ Yes

☒ No

If Yes, please provide details of the name, relationship and role

10. Application For Tree Works - Checklist

Only one copy of the application form and additional information (Question 8) is required. Please use the guidance and this checklist to make sure that this form has been completed correctly and that all relevant information is submitted. Please note that failure to supply precise and detailed information may result in your application being rejected or delayed. You do not need to fill out this section, but it may help you to submit a valid form.

Sketch Plan

- A sketch plan showing the location of all trees (see Question 8)

☒

For all trees

(see Question 7)

- Clear identification of the trees concerned
- A full and clear specification of the works to be carried out

☒

☒

For works to trees protected by a TPO

(see Question 7)

Have you:

- stated reasons for the proposed works?
- provided evidence in support of the stated reasons? in particular:
 - if your reasons relate to the condition of the tree(s) - written evidence from an appropriate expert
 - if you are alleging subsidence damage - a report by an appropriate engineer or surveyor and one from an arboriculturist.
 - in respect of other structural damage - written technical evidence
- included all other information listed in Question 8?

☒

☐

☐

☐

☐

11. Declaration - Trees

I/we hereby apply for planning permission/consent as described in this form and the accompanying plans/drawings and additional information. I/we confirm that, to the best of my/our knowledge, any facts stated are true and accurate and any opinions given are the genuine opinions of the person(s) giving them.

Signed - Applicant:

Or signed - Agent:

Date (DD/MM/YYYY):

(This date must not be before the date of sending or hand-delivery of the form)

12. Applicant Contact Details

Telephone numbers

Country code: National number: Extension number:

Country code: Mobile number (optional):

Country code: Fax number (optional):

Email address (optional):

13. Agent Contact Details

Telephone numbers

Country code: National number: Extension number:

Country code: Mobile number (optional):

Country code: Fax number (optional):

Email address (optional):

Electronic communication - If you submit this form by fax or e-mail the LPA may communicate with you in the same manner.
(Please see guidance notes)

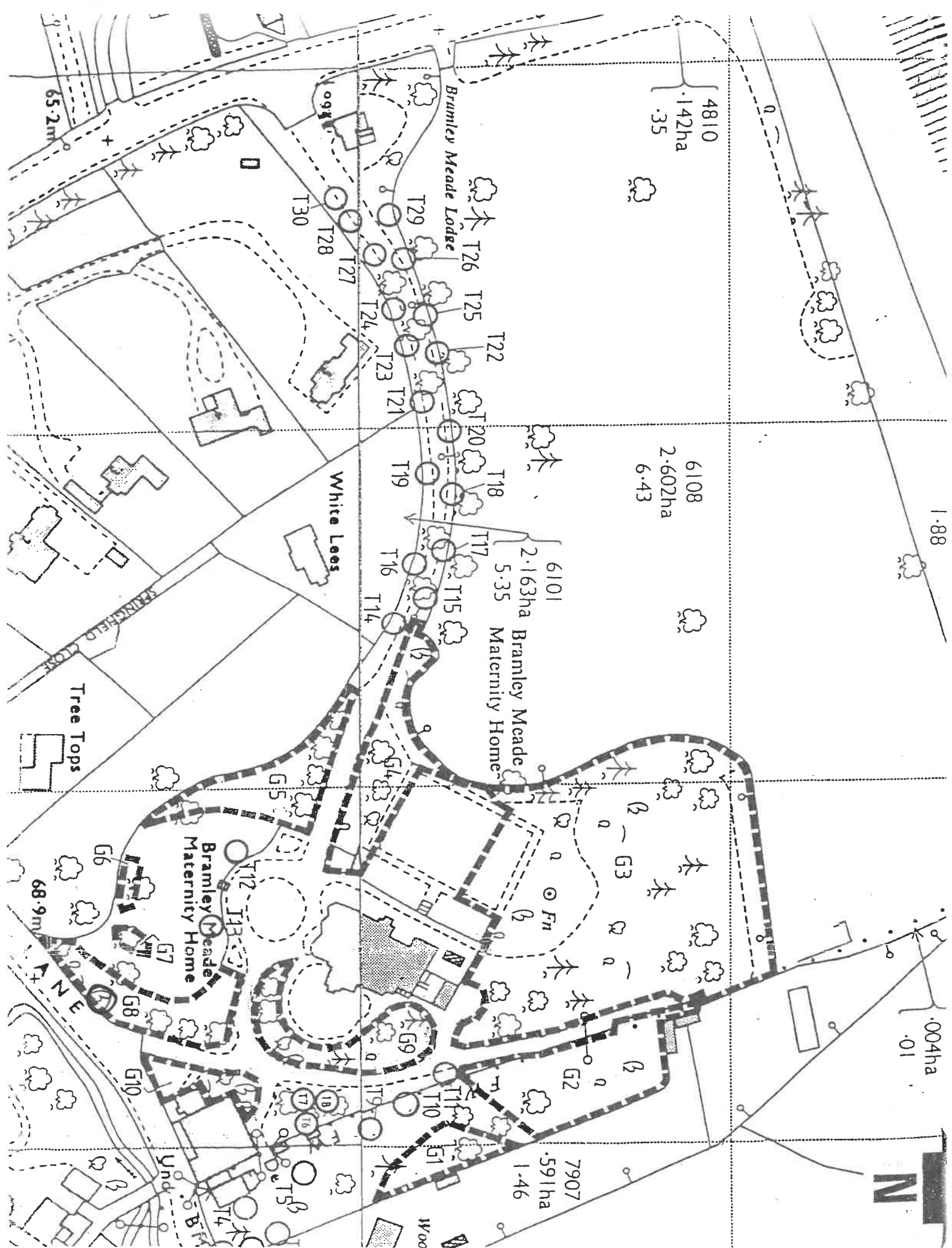

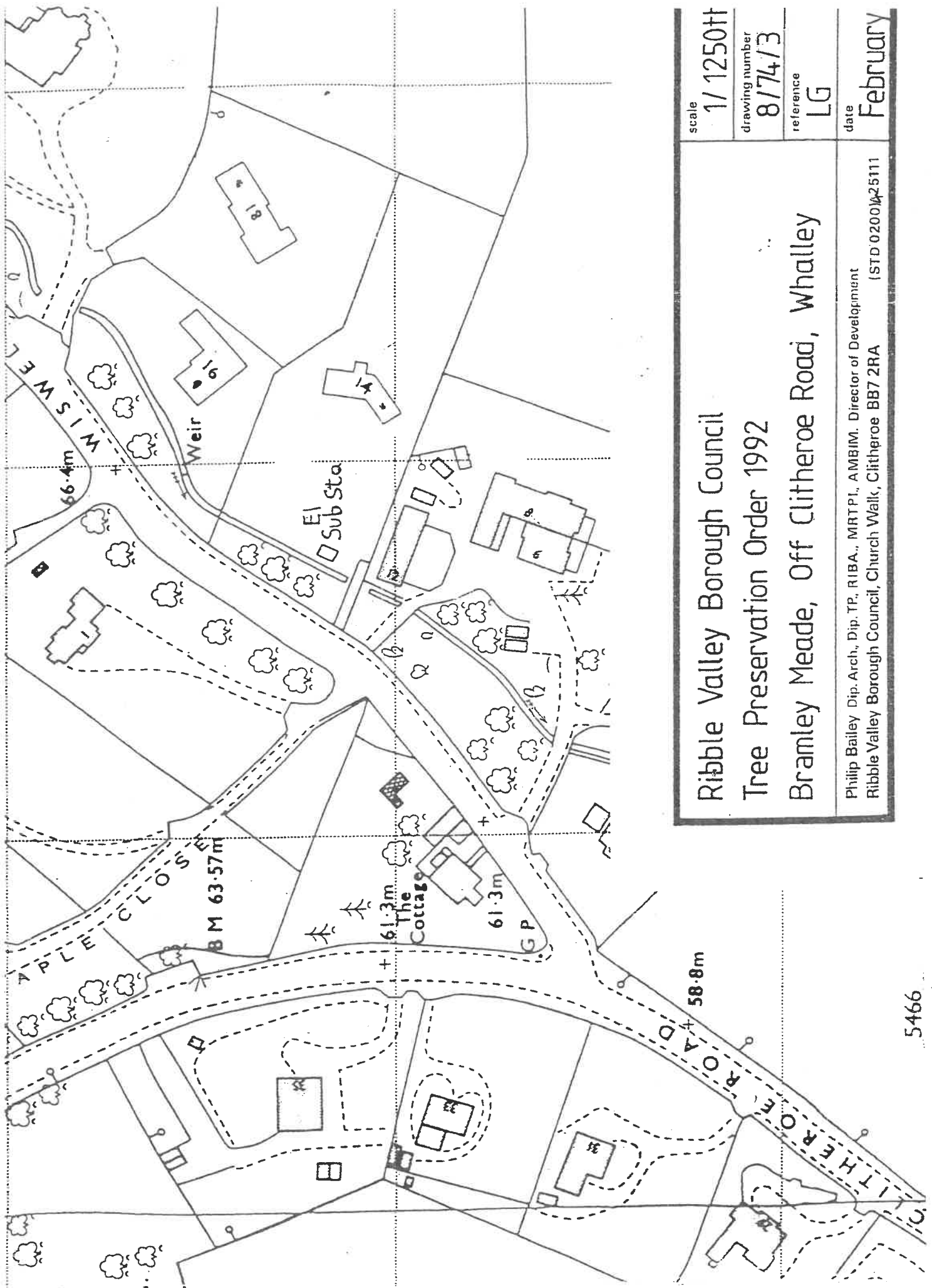

<p>Ribble Valley Borough Council</p> <p>Tree Preservation Order 1992</p> <p>Bramley Meade, Off Clitheroe Road, Whalley</p> <p>Philip Bailey Dip. Arch., Dip. TP., RIBA., MRTPI., AMBIM. Director of Development</p> <p>Ribble Valley Borough Council, Church Walk, Clitheroe BB7 2RA (STD 0200) 25111</p>	scale	1/1250ft
	drawing number	8174/3
	reference	LG
	date	February

FIRST SCHEDULE
TREES SPECIFIED INDIVIDUAL*
(encircled in black on the map)

No of Map	Description	Situation
T1	Sycamore)
T2	Sycamore)
T3	Sycamore)
T4	Monkey Puzzle)
T5	Beech)
T6	Common Ash)
T7	Beech)
T8	Lime)
T9	Horse Chestnut)
T10	Horse Chestnut) Located on land
T11	Sycamore)
T12	Cedar) within the curtilage
T13	Cedar)
T14	Lime) of Bramley Meade
T15	Lime)
T16	Lime) Hospital, Whalley
T17	Lime)
T18	Lime)
T19	Lime)
T20	Lime)
T21	Lime)
T22	Lime)
T23	Lime)
T24	Common Ash)
T25	Lime)
T26	Lime)
T27	Lime)
T28	Lime)
T29	Lime)
T30	Pine)

TREES SPECIFIED BY REFERENCES TO AN AREA*
(within a dotted black line on the map)

No. on Map	Description	Situation
N/A	N/A	N/A ,

GROUPS OF TREES*

(within a broken black line on the map)

No. on Map	Description	Situation
G1 = 20 trees	including Birch, Willow and Sycamore.	Located on land within
G2 = 28 trees	including Beech, Sycamore, Horse Chestnut, Pine, Common Ash, Birch and Oak.	the curtilage of Bramley Meade Hospital, Whalley
G3 = 86 trees	including Beech, Birch, Common Ash, Sycamore, Oak, Pine, Cypress, Yew and Holly.)
G4 = 34 trees	including Yew, Holly, Common Ash, Cypress, Sycamore and Beech.)
G5 = 26 trees	including Beech, Lime, Oak (including Evergreen Oak), Sycamore, Yew, Holly and Cypress)
G6 = 14 trees	including Common Ash, Sycamore, Yew and Cypress.)
G7 = 8 trees	including Sycamore, Cypress, Holly, Yew and Spruce.)
G8 = 27 trees	including Birch, Horse Chestnut, Sycamore, Holly, Yew and Elm.)
G9 = 19 trees	including Lime, Cypress, Yew, Holly, Cherry and Sycamore.)
G10 = 17 trees	including Common Ash, Sycamore, Holly, Willow and Birch.)

WOODLANDS*

(within a continuous black line on the map)

No. on Map	Description	Situation
N/A	N/A	N/A

* The word "NONE" must be entered where necessary