

Client: Mrs Fiona Johnstone

Site address: Slated Laithe, Paa Lane, Paythorne. BB74JD

Title: Proposed Sheep housing, winter fodder store and equipment store

Date : 23/2/2020 Drawn by: OJN drawing no. 05

Scale 1:100 on A3 paper

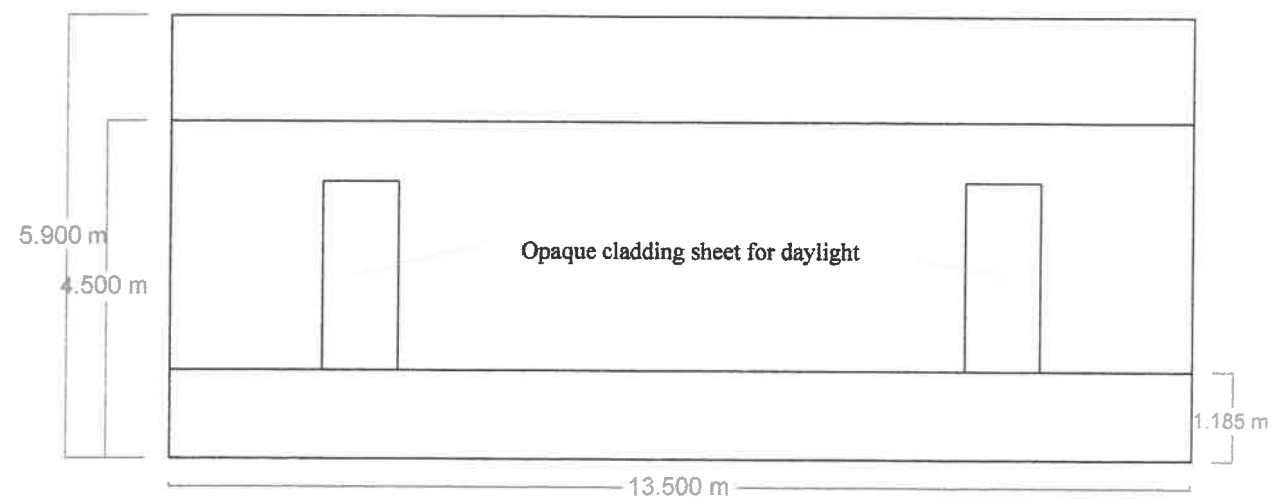
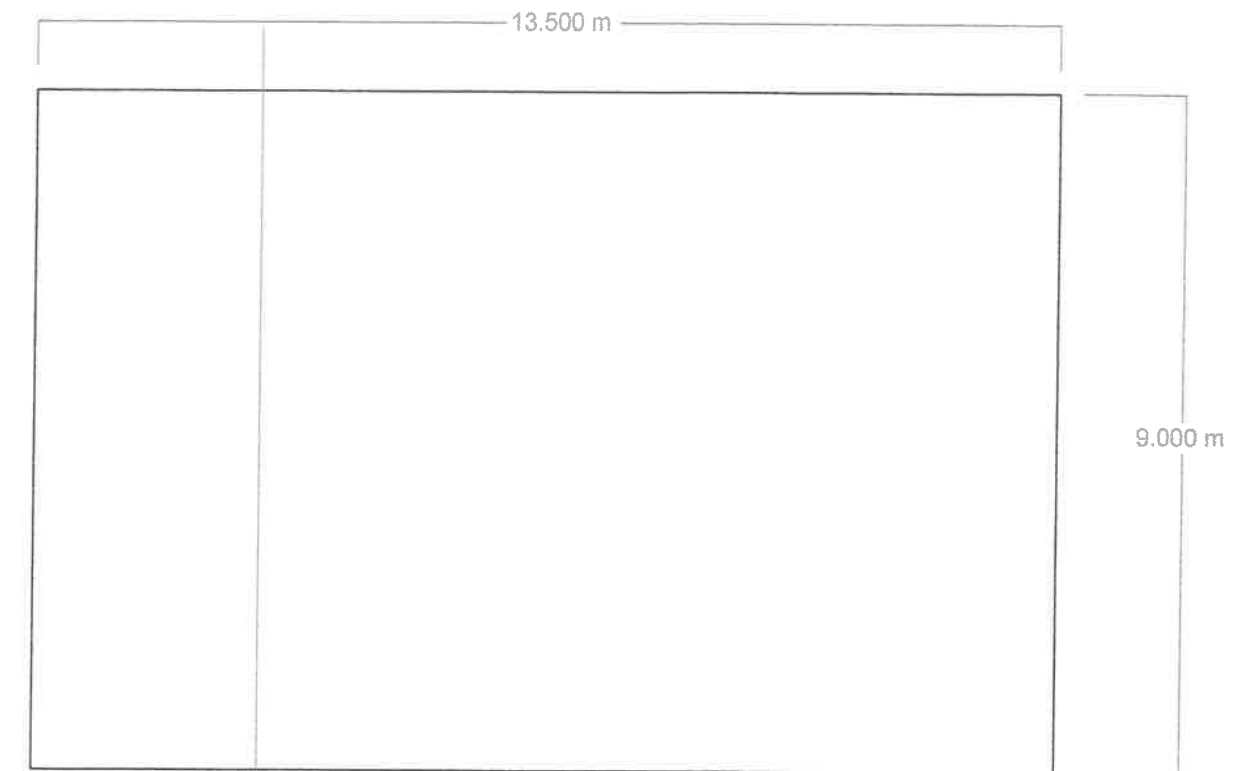
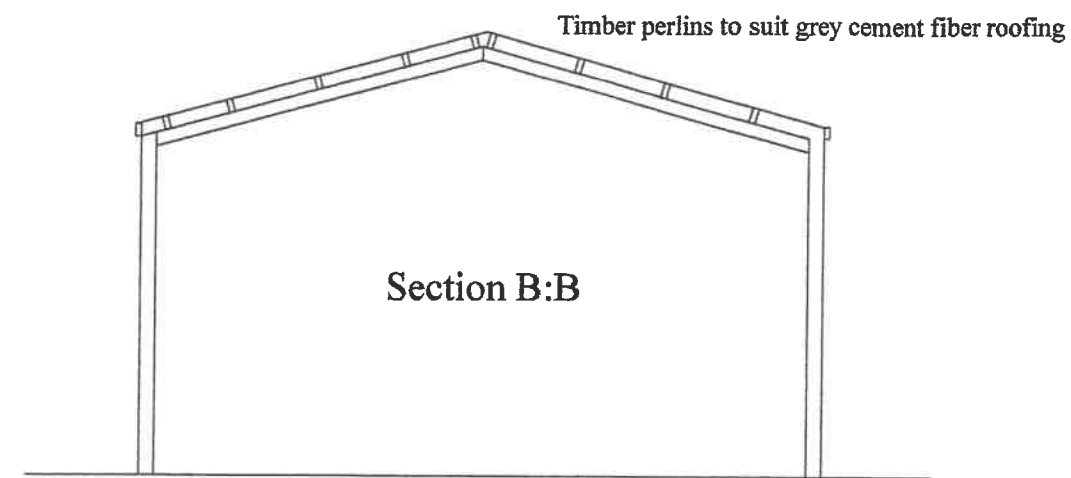

North West elevation, South east elevation is a mirror of other elevation

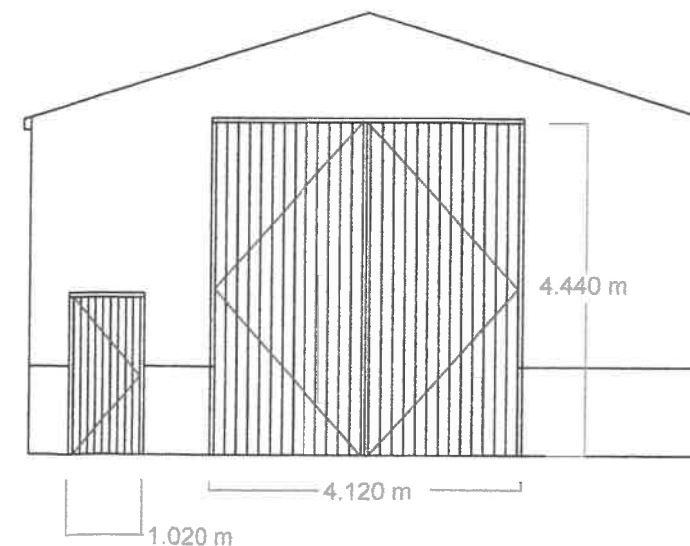

North east elevation

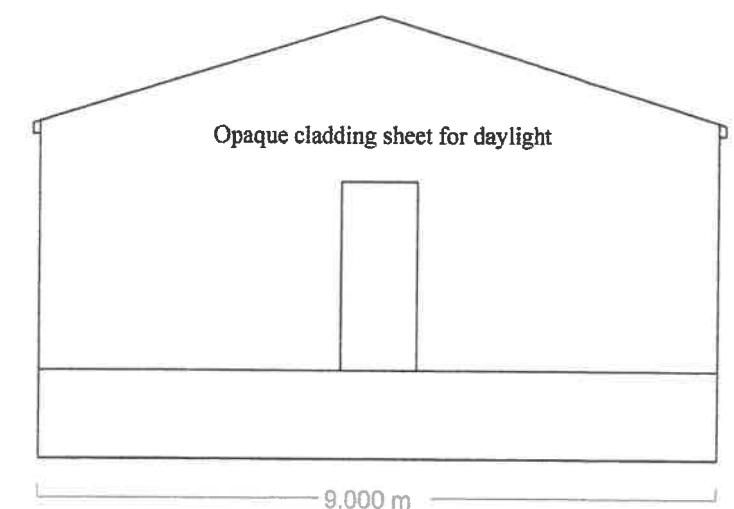

South west elevation

Proposed Steel portal frame building, grey cement fiber roof sheets with Merlin grey wall cladding boxprofile sheets

Extrenal cladding to be steel box profile sheets in Merlin grey with natural random limestone walling to 1.2m high

Roof to be clad with grey cement fiber sheeting with 6 opaque sheets for natural daylight

Doors to be timber boards

Client: Mrs Fiona Johnstone
Site address: Slated Laithe, Paa Lane, Paythorne. BB74JD
Title: Proposed site layout of new Agricultural building
Drawn by: OJN drawing no. 09 Date 23/2/2020 Scale 1:500 on A3 paper rev 3 18/5/2020

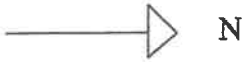

- Application area
- Property Boundary under applicants ownership
- Areas to Recive additional planting with native deciduous trees and hedging

