

# **Landscaping proposal for a proposed lodge site**

at

**Bowland Wild Boar Park  
Wardsley Rd  
Chipping  
Preston  
PR3 2QT**

Prepared by  
Mary Miller  
Rural Futures (North West) Ltd  
78a Main St  
Warton  
Carnforth  
LA5 9PG



The proposed lodges will be located within a pocket of land which is surrounded by mature broad leaved woodland. The additional planting will be carried out around the lodges and the perimeter of the site. The planting will consist of areas of native species trees and lengths of native species hedgerow which have been chosen specifically to be beneficial to insect and bird species.

## **SOFT LANDSCAPING**

### **Introduction**

This landscaping proposal is in respect of planning application for nine holiday lodges located to the south of the access road to the Bowland Wild Boar Park.

The proposed planting will be undertaken around the lodges and the wider site to provide screening and to increase the biodiversity of the site. The trees and hedges will also create private spaces for the individual lodges.

The works shall comply with B.S.4428 (1989) General Landscape Operations. Plants should be ordered to suit site requirements and only in accordance with the schedule spacings.

## **PLANTING**

### **General**

All trees and shrubs shall conform to the relevant parts of B.S. 3936 and all plantings will conform to the proposal described below. All trees and hedgerow plants will be sourced from accredited British growers.

The proposal is to plant approximately 220 metres of native species hedgerow around individual lodge pitches. Approximately 65 native species trees will be interspersed within the hedgerows and planted in clumps around the site. The selection of species is typical of the wider area and also offers a mixture of species for insects and other wildlife.

### **Rejection of Plants**

Any plant material, which in the opinion of the Landscape Architect does not meet the requirements of the specification, or is unsuitable, or defective in any way, will be rejected. The minimum specified sizes in the plant schedule will be strictly enforced.

### **Planting**

All planting material shall generally be planted between November and March in open cool weather. Planting shall not take place in frosty, snowy or waterlogged conditions. Where approved, pot or container grown plants may be planted outside the described season, but adequate watering shall be supplied. Torn or damaged roots and branches shall be clearly pruned prior to planting.

### **Planting of Transplants or Shrubs**

The nature of the material to be planted is variable and the contractor shall allow for planting to be properly carried out in all cases as described in B.S. 4428: 1989 5.8 Woodland, 5.9 Shrubs. All plants shall be planted at the same depth, or very slightly deeper, as they were grown. Roots shall not be bent, broken or forced into inadequate pits or notches. Plants shall be upright, firmed in and wind resistant, with no air pockets around the roots. All pots and root wrappings shall be carefully removed prior to planting. All pots and wrappings arising shall immediately be picked up and stored ready for removal to tip. Plants shall be planted at the specified centres.

### **Tree Planting**

Trees shall conform to BS 3936 and be planted in tree pits of the following sizes unless directed otherwise:

Whips up to 2 metres high - 600 x 600 x 400

Selected standards up to 4.25 metres high - 1000 x 1000 x 600

Excavated subsoil should be carted elsewhere within the site and re-used for landscaping. The bottom 250mm of the pit shall be dug and broken up. Backfill shall be retained topsoil as specified unless directed otherwise. Where footpaths or services are closer than 2 metres to tree pits they shall be protected by an approved root barrier. 'Reroot' barrier systems are approved.

### **Compost for Planting Pits**

Compost shall be a proprietary product, bark based incorporating fertilisers and improving additives. Compost shall be added to and mixed with topsoil backfill at a rate of 20% by volume. The type of compost shall be approved before its delivery on site, and the details of the product shall be supplied.

### **Tree Ties and Stakes**

Trees shall be twin staked with cross bar. Ties shall be approved nail-on type with cushioned spacer such as Toms, or other equal and approved. Nails shall be flat headed galvanised and shall hold the ties securely into the stake. Ties shall not be over tight on the tree stems.

### **Planting of Trees**

The tree shall be set upright and at the same depth as grown in the nursery, the roots shall be spread out and the topsoil, or compost/topsoil mixture, backfilled. Backfilling should be done to ensure close contact between roots and by firming in layers. The soil shall be left level and tidy, any subsoil clods, bricks or stones over 500mm arising, collected and carted off site. The trees will be planted 2 metres apart to provide dense clumps.

### **Shrubs**

The shrubs will be planted adjacent to the supporting legs for the decking to screen the timber structure. Planting shall conform to BS 3936 and as described for the trees above.

### **MAINTENANCE**

All dead, diseased, damaged plants must be replaced for up to 7 years.

### Weeding

All beds to be kept weed free by cultivating and/or by using approved herbicides. Beds to be forked over as necessary to keep soil loose to approved cambers with no hollows.

### Pruning

At appropriate time, prune plants to remove dead, dying or diseased wood and suckers to promote healthy growth and natural shape. Dress cut ends exceeding 25mm diameter with fungicidal sealant.

### Watering

Sufficient water is applied to maintain healthy growth.

### Proposed species list

TREES	HEIGHT	QUANTITY
<i>Quercus petraea</i>	80-90 cm	12
<i>Alnus glutinosa</i>	80-90 cm	15
<i>Sorbus aucuparia</i>	80-90 cm	12
<i>Betula pendula</i>	80-90 cm	15
<i>Prunus avium</i>	80-90 cm	11
Hedge plants	HEIGHT	Proportion of plants
<i>Crataegus monogyna</i>	40-60cm	60%
<i>Prunus spinosa</i>	40-60cm	8%
<i>Ilex aquifolium</i>	40-60cm	8%
<i>Corylus avellana</i>	40-60cm	7%
<i>Viburnum opulus</i>	40-60cm	7%
<i>Prunus padus</i>	40-60cm	5%
<i>Acer campestre</i>	40-60cm	5%

The above trees and hedge plants will be planted in accordance with the accompanying site plan.

### HARD LANDSCAPING

The access from the tarmac entrance to the lodge site will be constructed using crushed limestone. The proposed car parking area for each lodge will be created using a plastic grasscrete type of product which will allow the grass to grow through it but will create a permeable surface to allow rainwater to drain through into the ground below.



# Proposed planting layout

Proposed area for bin store / refuse collection point

ex car parking area

Iron-age roundhouse

Proposed managers accommodation, subject to separate panning application

Existing camping pods

New Ground Wood

Native species hedgerows

Native species trees – see list above

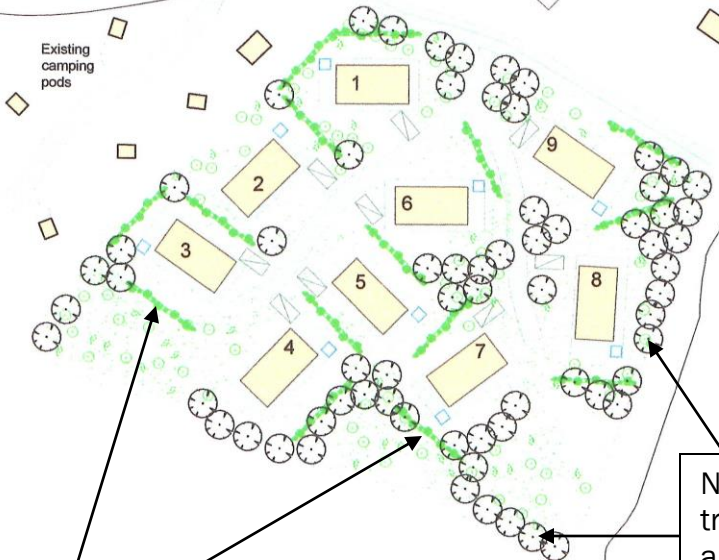

Reproduced from Ordnance Survey data by the permission of Ordnance Survey on behalf of the Controller of Her Majesty's Stationery Office. © Crown Copyright 2002. All rights reserved. Licence number AL100034006

0 5 10 20 30 40 50m  
1:500 Scale