

Roof Plan

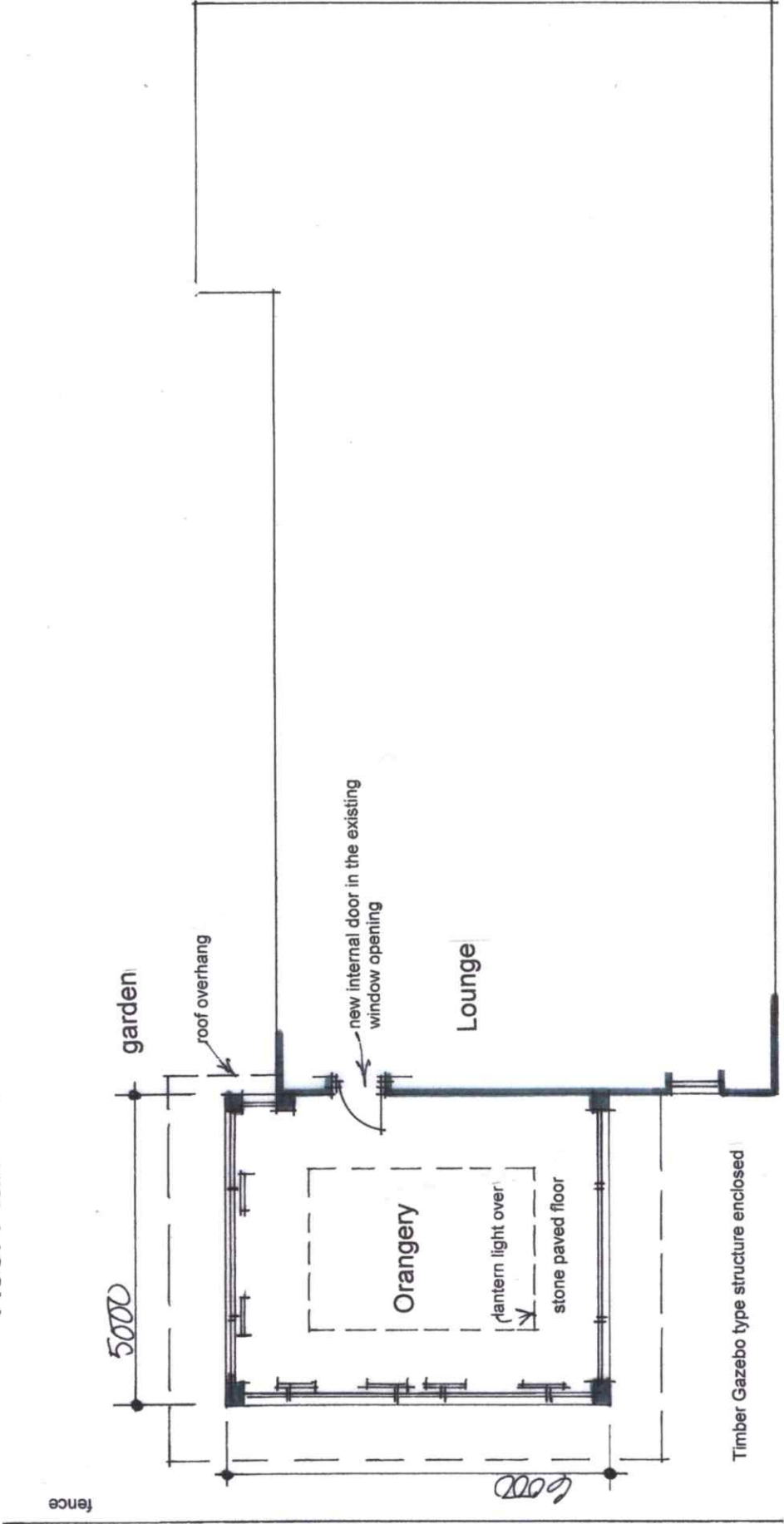

Ground Floor Plan

glazing and sliding door configurations to client's requirements and approval

David LIVERSIDGE *Design*
 architecture development
 construction
 259 Rossendale Road, Burnley, Lancs. BB11 5BZ
 also at Haywards Heath, West Sussex, RH16 4DZ
 t: 07977 463 496
 e: davidliversidge@msn.com

Proposed Orangery
 Plans as Proposed

The Willows
 Kayley Lane, Chatburn
 for Mr. and Mrs. Gaughan

scale: 1/100th @ A3 drawing no:
 date: August 2020 20/61/2