

PROPOSED SITE PLAN-1

BANKS COTTAGE - CHIPPING ROAD - LONGRIDGE - PRESTON - LANCASHIRE - PR3 2NB

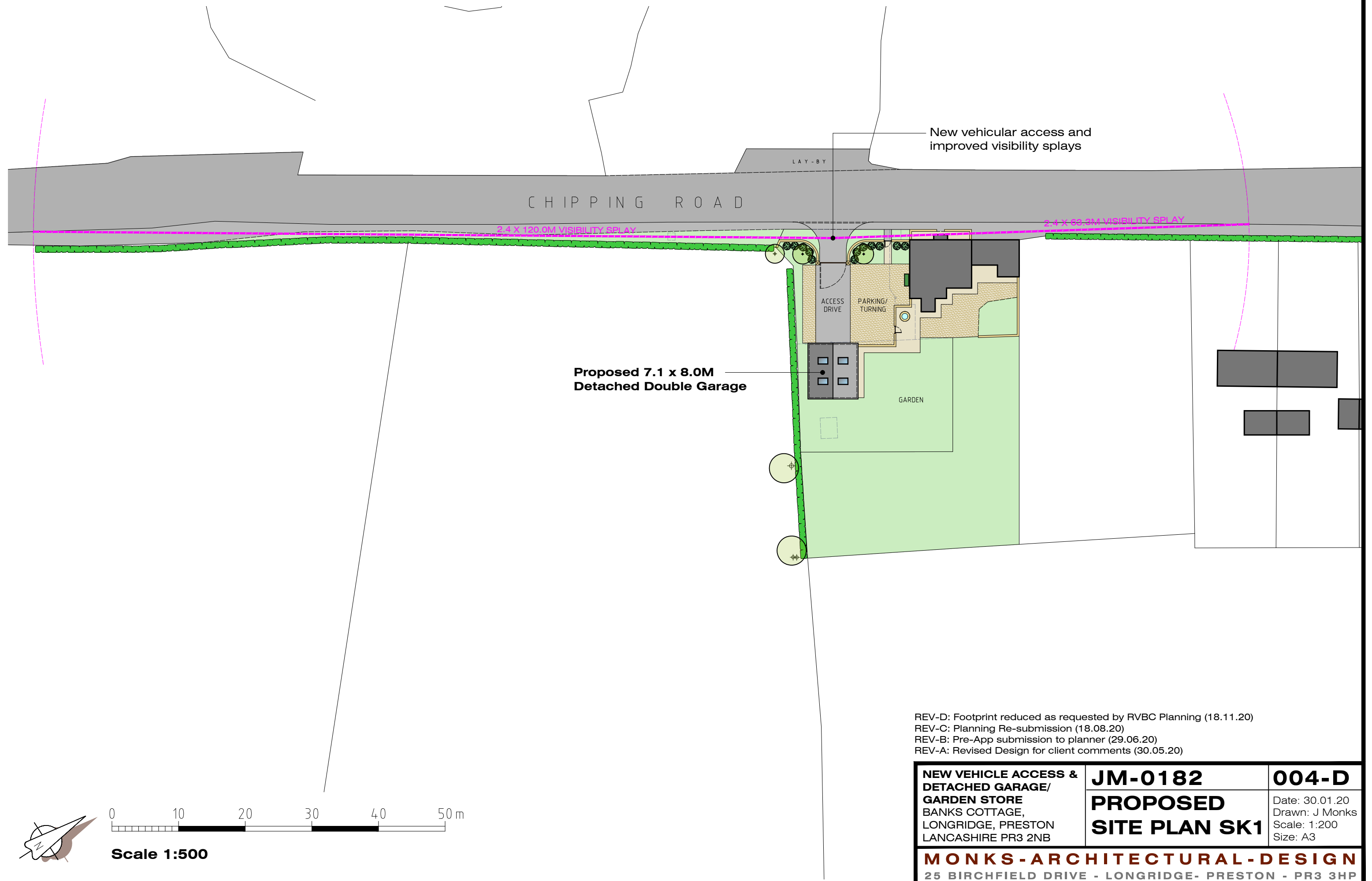

REV-D: Footprint reduced as requested by RVBC Planning (18.11.20)
 REV-C: Planning Re-submission (18.08.20)
 REV-B: Pre-App submission to planner (29.06.20)
 REV-A: Revised Design for client comments (30.05.20)

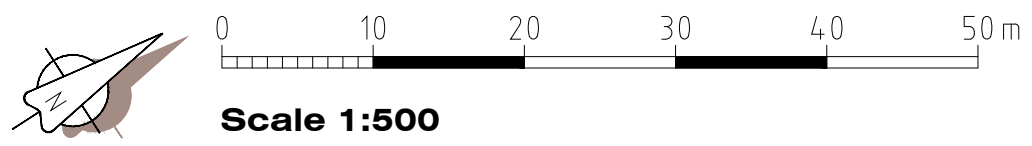

NEW VEHICLE ACCESS & DETACHED GARAGE/ GARDEN STORE BANKS COTTAGE, LONGRIDGE, PRESTON LANCASHIRE PR3 2NB	JM-0182	004-D
	PROPOSED SITE PLAN SK1	Date: 30.01.20 Drawn: J Monks Scale: 1:200 Size: A3
MONKS-ARCHITECTURAL-DESIGN 25 BIRCHFIELD DRIVE - LONGRIDGE- PRESTON - PR3 3HP		

PROPOSED SITE PLAN-2

BANKS COTTAGE - CHIPPING ROAD - LONGRIDGE - PRESTON - LANCASHIRE - PR3 2NB

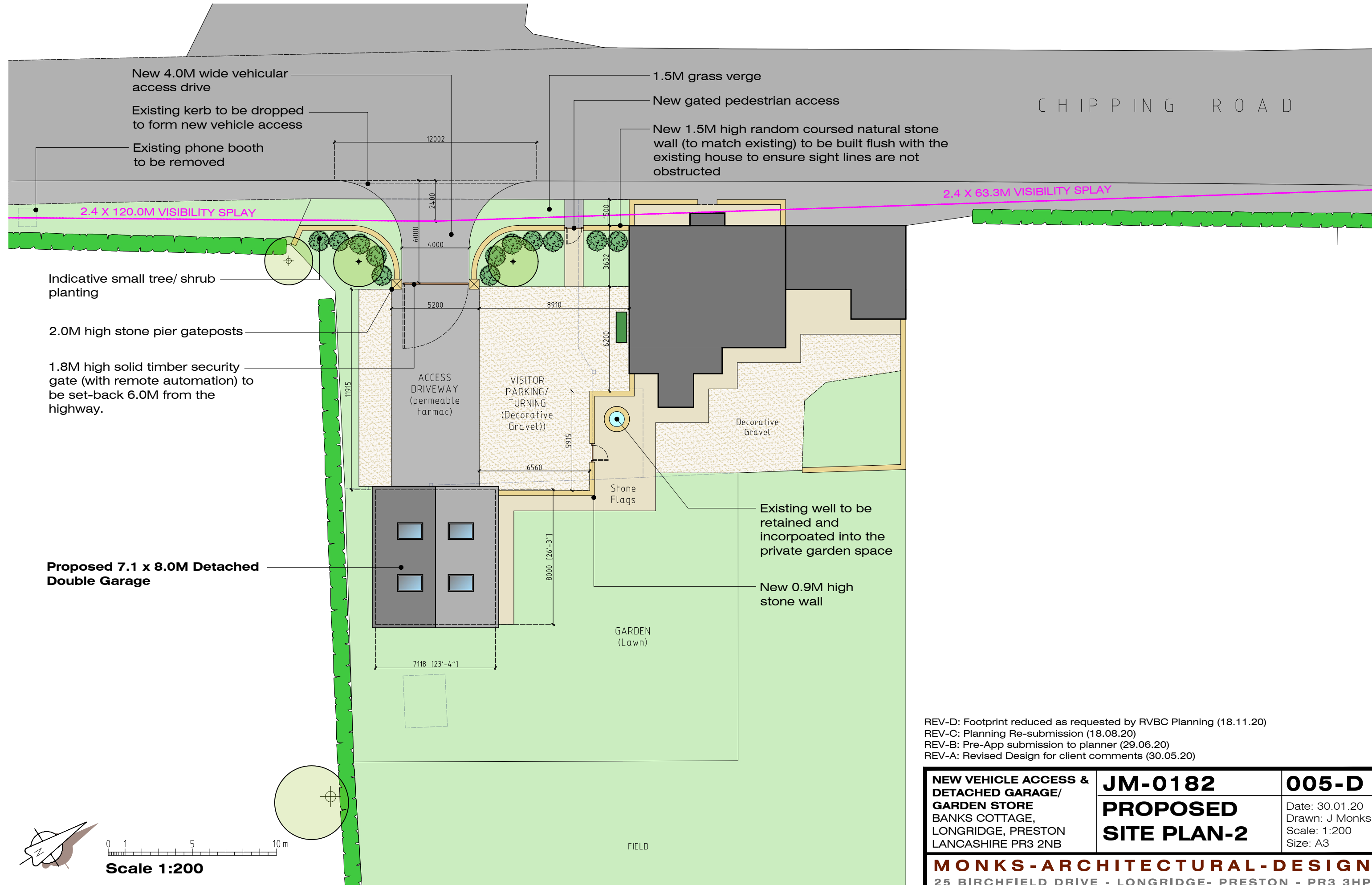

REV-D: Footprint reduced as requested by RVBC Planning (18.11.20)
 REV-C: Planning Re-submission (18.08.20)
 REV-B: Pre-App submission to planner (29.06.20)
 REV-A: Revised Design for client comments (30.05.20)

NEW VEHICLE ACCESS & DETACHED GARAGE/ GARDEN STORE BANKS COTTAGE, LONGRIDGE, PRESTON LANCASHIRE PR3 2NB	JM-0182	005-D
	PROPOSED SITE PLAN-2	
Date: 30.01.20 Drawn: J Monks Scale: 1:200 Size: A3		

MONKS-ARCHITECTURAL-DESIGN
 25 BIRCHFIELD DRIVE - LONGRIDGE- PRESTON - PR3 3HP

