

This drawing is part of the reservation process and should be read in conjunction with all other reservation documents. The information shown is the standard Brick or Render elevations and plans for an 'AS' (as drawn in the construction pack) version only. For an 'O/P' (a handed / mirrored version to that shown in the construction pack) description of / and alternative elevations please talk to a Sales representative. This drawing is subject to copyright law. **Do Not Scale Off This Drawing**

Contractor to:

1. Remove existing radiator and form a new opening with door
2. Form new window in existing wall
3. Construct timber stud wall with plasterboard and insulation in/it to Building reg requirements

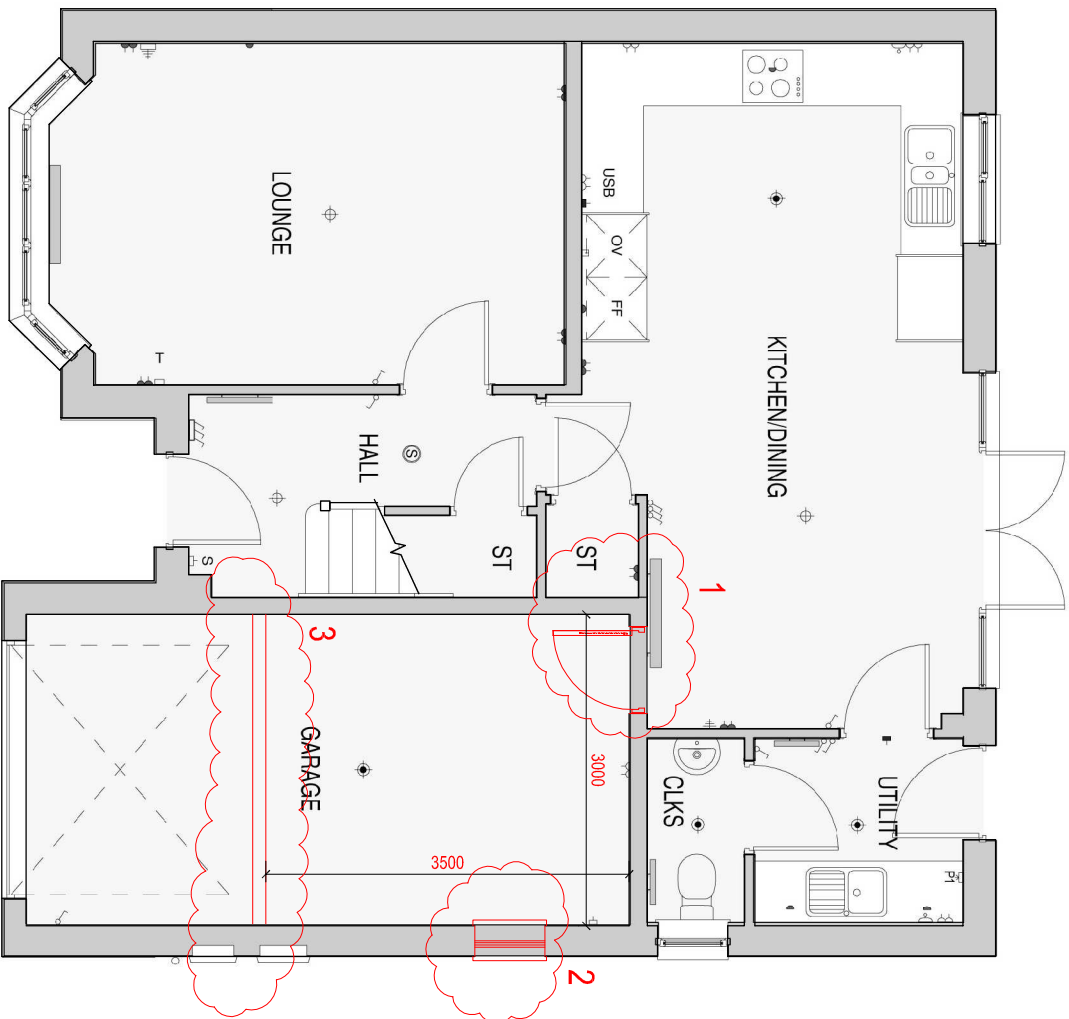

**GROUND FLOOR PLAN**

Floor Area

**1318 #2**

**122.43 m<sup>2</sup>**

House Reference Code

**EF\_OXFO\_DM.2.0**

Release Date

**Mar 2018**



Group Design & Technical Department,  
Redrow Group Services, Redrow House  
Finsbury, CH3 5HX, Tel: 01249 520049

	Electrical Devices
	Smoke Detector
	Fridge Freezer
	Oven
	Batten Light
	Pendant Light
	Radiator
	Cooker Connection Unit
	Fused Outlet - Boiler/immersion
	Isolation Switch
	Socket - Unswitched - Low Level
	TV Point
	Data/Satellite/TV Point
	Socket - Double - Low Level
	Socket - Double - High Level
	Telephone Point
	USB
	Socket - Double - High Level with USB
	Zone 1 Programmable Thermostat
	Bank of Switches
	Light Switch
	Light Switch
	Light Switch
	Thermostat