

Stanton Andrews do not accept liability for any loss or degradation of information held in the drawing resulting from the translation from the original file format to any other file format or from the recipient's reading of it in any other programme or on any other version of the programme. Stanton Andrews accepts no liability for use of this drawing by parties other than the party for whom it was prepared or for purposes other than those for which it was prepared.

DWG issues - when this drawing is issued in DWG format it is an uncontrolled version and is provided to enable the recipient to prepare its own documents/drawings for which it is solely responsible. It is based on background information current at the time of issue. Stanton Andrews accepts no liability for any alterations, additions to or discrepancies arising out of changes to such background information which occur after it has been issued by Stanton Andrews.

This drawing must be printed in colour, if this text is not RED the drawing must be reprinted.

Do not scale, use figured dimensions only. All dimensions to be checked on site. This drawing should be printed and read at the original size, as stated in the block. Stanton Andrews accept no responsibility for errors that occur as a result of reviewing this drawing or any other size. Stanton Andrews to be notified of any discrepancies before proceeding.

Drawing is to be read in conjunction with all relevant consultants and specialist drawings. (As existing) drawings based on information provided by others - no measured survey of the property has been undertaken by the architect. This drawing is subject to copyright.

revision	date	note
A	19.07.2019	issued for pre-app
B	10.2020	submitted for planning
C	01.2021	amendments for highways
D	11.2021	amendments for highways

KEY PLAN

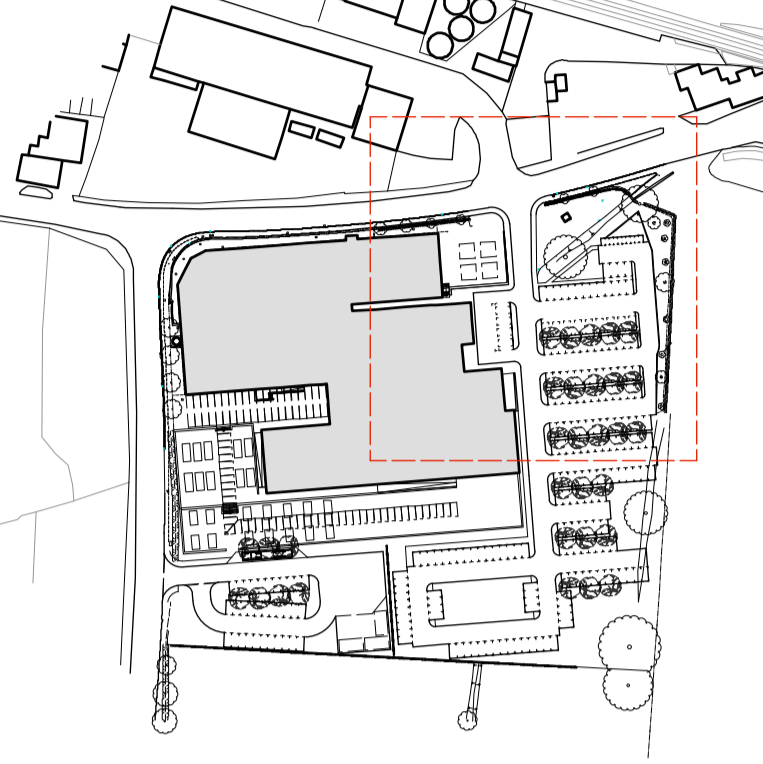

red hatch indicates 2.4x43m visibility splays to customer access
car tracking illustrated in grey

CLITHEROE ROAD

LEGEND

- block paving
- paving
- pedestrian paths
- proposed trees
- soft landscaping/planting beds etc.

landscaping as described in supporting design statement and generally as illustrated to drg.no.1859/PL01 - proposed site plan

parking arrangement reconfigured, formalised and orientated to face the garden centre - extents of hardsurfacing to be largely unchanged

car park layout illustrated with road markings/decals for clarity of anticipated arrangement

car park surface treatment to be a combination of permeable and impermeable surfaces (i.e. tarmacadam and block paving) - see legend

car park to be drained using a sustainable drainage system - see supporting drainage strategy - to control surface water runoff

soft landscaping, planting beds and tree lined parking runs introduced wherever possible around the car parking areas to reduce the visual impact of cars on the surrounding context and break up the hard surfacing.

remaining car park layout as drg.no.1859/PL11

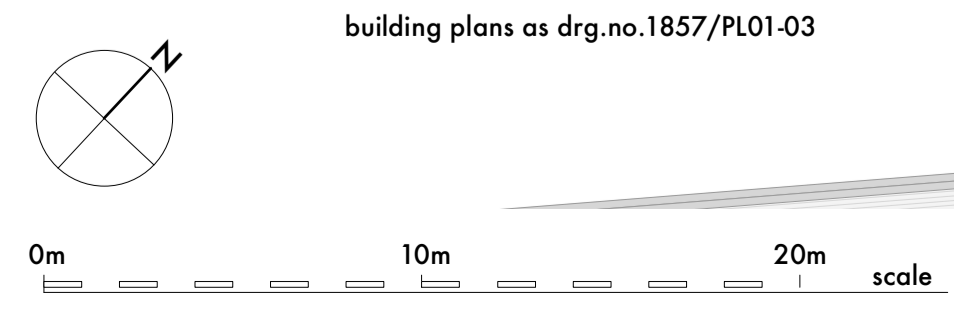

building plans as drg.no.1857/PL01-03

5no. cycle bays (10 spaces)

4no. cycle bays (8 spaces)

4no. cycle bays (8 spaces)

4no. accessible/disabled bays

10no. motorcycle bays

4no. bays for elec. vehicles (inc. electric charging points)

13no. bays

9no. accessible/disabled bays

13no. bays

13no. bays

13no. bays

14no. bays

14no. bays

one way

min. 6000

min. 6000

min. 6000

SA stanton andrews architects

44 york street clitheroe BB7 2DL
t. 01200 444490 e. mail@stantonandrews.co.uk w. stantonandrews.co.uk

project shackletons home & garden 18.59

proposed car park layout 1/2

scale 1 to 200 @ A1 date 02.19 status planning

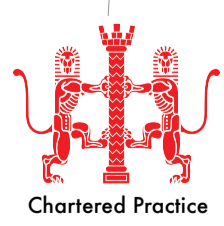

drawing number **PL.10**

revision D