

Stanton Andrews do not accept liability for any loss or degradation of information held in the drawing resulting from the translation from the original file format to any other file format or from the recipient's reading of it in any other programme or an earlier version of the programme. Stanton Andrews accepts no liability for use of this drawing by parties other than the party for whom it was prepared or for purposes other than those for which it was prepared.

DWG issues - when this drawing is issued in DWG format it is an uncontrolled version and is provided to enable the recipient to prepare its own documents/drawings for which it is solely responsible. It is based on background information current at the time of issue. Stanton Andrews accepts no liability for any alterations, additions to or discrepancies arising out of changes to such background information which occur after it has been issued by Stanton Andrews.

This drawing must be printed in colour, if this text is not RED the drawing must be reprinted.

Do not scale, use figured dimensions only. All dimensions to be checked on site. This drawing should be printed and read at the original size, as stated in the block. Stanton Andrews accept no responsibility for errors that occur as a result of reviewing this drawing at any other size. Stanton Andrews to be notified of any discrepancies before proceeding.

Drawing is to be read in conjunction with all relevant consultants and specialist drawings. As existing drawings based on information provided by others - no measured survey of the property has been undertaken by the architect. This drawing is subject to copyright.

revision	date	note
A	19.07.2019	issued for pre-app
B	10.2020	submitted for planning

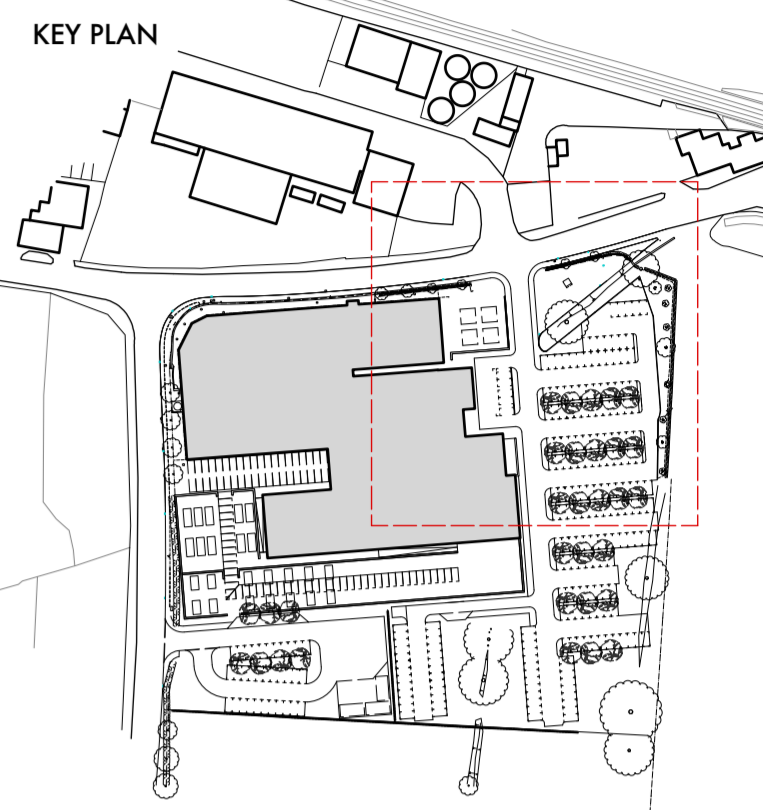

CLITHEROE ROAD



LEGEND

- block paving
- paving
- pedestrian paths
- proposed trees
- soft landscaping/planting beds etc.

landscaping as described in supporting design statement and generally as illustrated to drg.no.1859/PL01 - proposed site plan

parking arrangement reconfigured, formalised and orientated to face the garden centre - extents of hardsurfacing to be largely unchanged

car park layout illustrated with road markings/decals for clarity of anticipated arrangement

car park surface treatment to be a combination of permeable and impermeable surfaces (i.e. tarmacadam and block paving) - see legend

car park to be drained using a sustainable drainage system - see supporting drainage strategy - to control surface water runoff

soft landscaping, planting beds and tree lined parking runs introduced wherever possible around the car parking areas to reduce the visual impact of cars on the surrounding context and break up the hard surfacing.

remaining car park layout as drg.no.1859/PL11

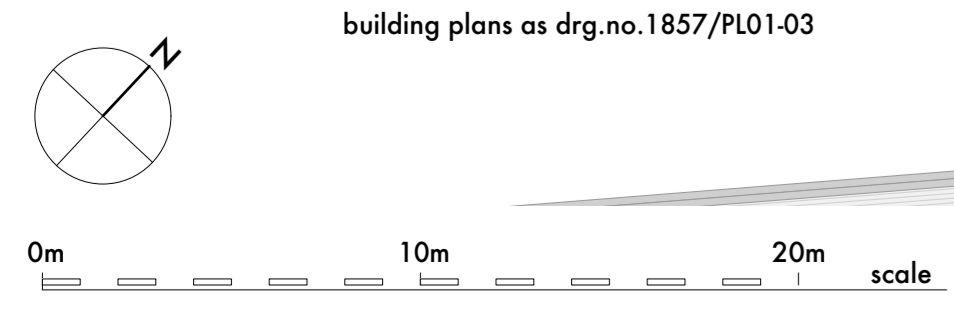

**SA stanton andrews architects**  
 44 york street clitheroe BB7 2DL  
 t. 01200 444490 e. mail@stantonandrews.co.uk w. stantonandrews.co.uk



project: shackletons home & garden 18.59  
 name: proposed car park layout 1/2  
 scale: 1 to 200 @ A1 date: 02.19 status: planning revision: B

drawing number: PL.10

Stanton Andrews do not accept liability for any loss or degradation of information held in the drawing resulting from the translation from the original file format to any other file format or from the recipient's reading of it in any other programme or an earlier version of the programme. Stanton Andrews accept no liability for errors that occur as a result of reviewing this drawing at any other size. Stanton Andrews to be notified of any discrepancies before proceeding.

Do not scale, use figured dimensions only. All dimensions to be checked on site. This drawing should be printed and read at the original size, as stated in this block. Stanton Andrews accept no responsibility for errors that occur as a result of reviewing this drawing at any other size. Stanton Andrews to be notified of any discrepancies before proceeding.

DWG issues - when this drawing is issued in DWG format it is an uncontrolled version and is provided to enable the recipient to prepare its own documents/drawings for which it is solely responsible. It is based on background information current at the time of issue. Stanton Andrews accept no liability for any alterations, additions to or discrepancies arising out of changes to such background information which occur after it has been issued by Stanton Andrews.

This drawing must be printed in colour, if this text is not RED the drawing must be reprinted.

revision	date	note
A	19.07.2019	issued for pre-app
B	10.2020	submitted for planning

building plans as drg.no.1857/PL01-03

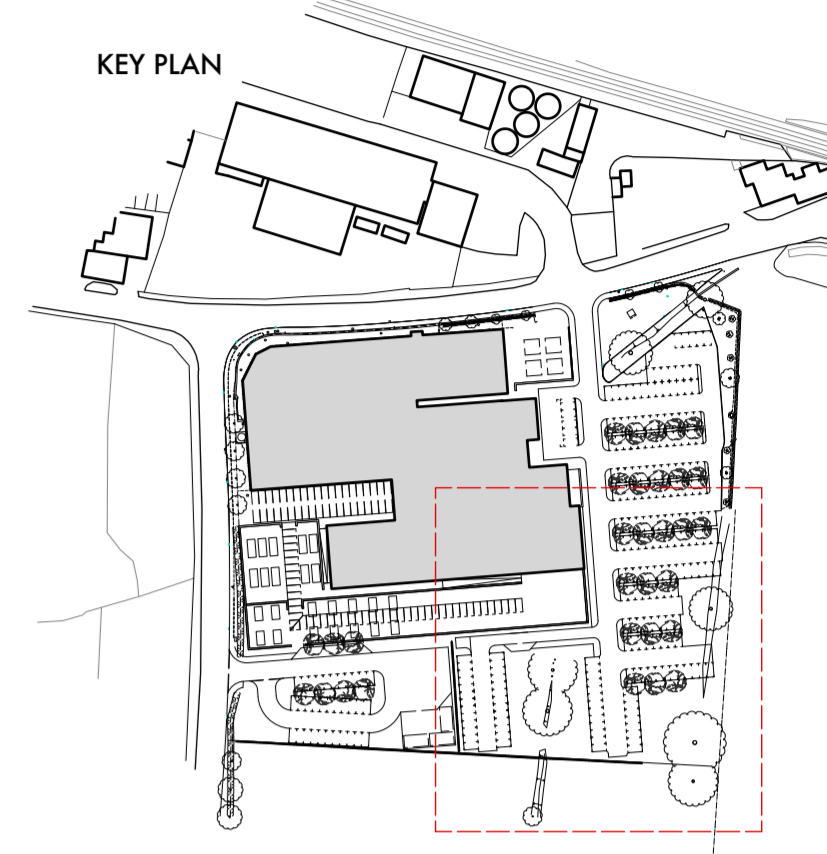

- LEGEND**
- block paving
  - paving
  - pedestrian paths
  - proposed trees
  - soft landscaping/planting beds etc.

- landscaping as described in supporting design statement and generally as illustrated to drg.no.1859/PL01 - proposed site plan
- parking arrangement to rear car park arranged to avoid disruption to existing tree root protection areas (broken magenta lines)
- car park layout illustrated with road markings/decals for clarity of anticipated arrangement
- car park surface treatment to be a combination of permeable and impermeable surfaces (i.e. tarmacadam and block paving) - see legend
- car park to be drained using a sustainable drainage system - see supporting drainage strategy - to control surface water runoff
- soft landscaping, planting beds and tree lined parking runs introduced wherever possible around the car parking areas to reduce the visual impact of cars on the surrounding context and break up the hard surfacing.
- overspill parking accessed via single lane track to avoid impact on tree root protection area (broken magenta lines) - passing point and manoeuvring head provided to accommodate single lane

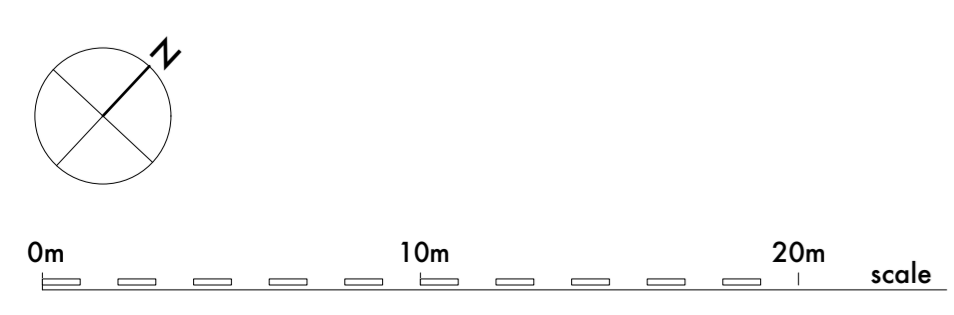

**stanton andrews**  
architects

44 york street clitheroe BB7 2DL  
t. 01200 444490 e. mail@stantonandrews.co.uk w. stantonandrews.co.uk

Chartered Practice

---

project **shackletons home & garden** 18.59

name **proposed car park layout 2/2**

scale 1 to 200 @ A1 date 02.19 status planning

PL.11

drawing number