

WARNING TO HOUSE PURCHASERS
Property Misdescriptions Act 1991
 Buyers are warned that this is a working drawing and is not intended to be treated as definitive material. It is subject to any particular property or development, any of the specific matters mentioned by any other notes on the plan. The contents of this drawing may be subject to change and the design and construction of any building or other works shown on the drawing may be subject to change. Consequently the layout, form, content and dimensions of the building construction may differ from those shown here. In the absence of a contract, this drawing is not a contract, nor is it a warranty.

REFUSE STRATEGY DRAWING KEY

- Hardstanding for refuse/recycling bins
- Travel route to collection point

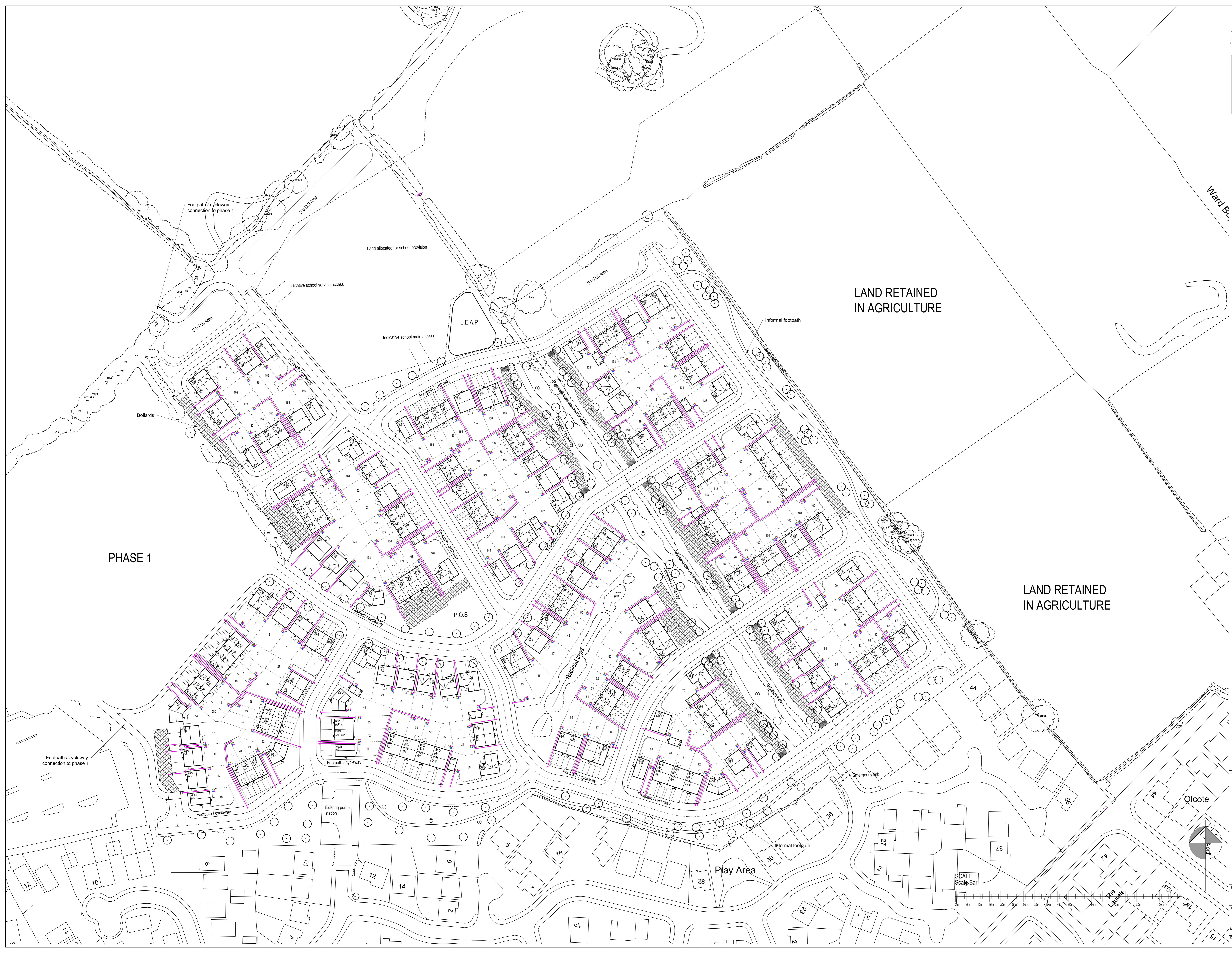

Rev	Description	Date	By
07	Revised plans B1-B3 & 100-109 from Devon to include	07-06-21	GB
06	Fix raised walkways to 0.2m, Hardways to 0.1m and Downpipes to 0.1m	25-08-20	GB
05	Amended to planning layout rev 07	18-06-19	AA
04	Amended to planning layout rev 06	07-05-19	GB
03	Amended to planning layout rev 05	04-03-19	AA
02	Amended to planning layout rev 04	13-02-19	AA
01	Amended to planning layout rev 03	21-01-19	AA

BARRATT HOMES MANCHESTER
 Barratt Homes Manchester
 (A division of BDW Trading Ltd)
 4 Brindley Road
 City Park
 Manchester
 M16 9HQ
 Tel: 0161 872 0161
 Fax: 0161 855 2828

CHIPPING LANE LONGRIDGE

Title: PHASE 2 / 3 REFUSE STRATEGY LAYOUT

Design By	Scale	Drawing Number	Rev
AA	05-10-18	459-RS04	07
Drawn By	Scale		
AA	1:500		