

PROPOSED SITE PLAN-2

BANKS COTTAGE - CHIPPING ROAD - LONGRIDGE - PRESTON - LANCASHIRE - PR3 2NB

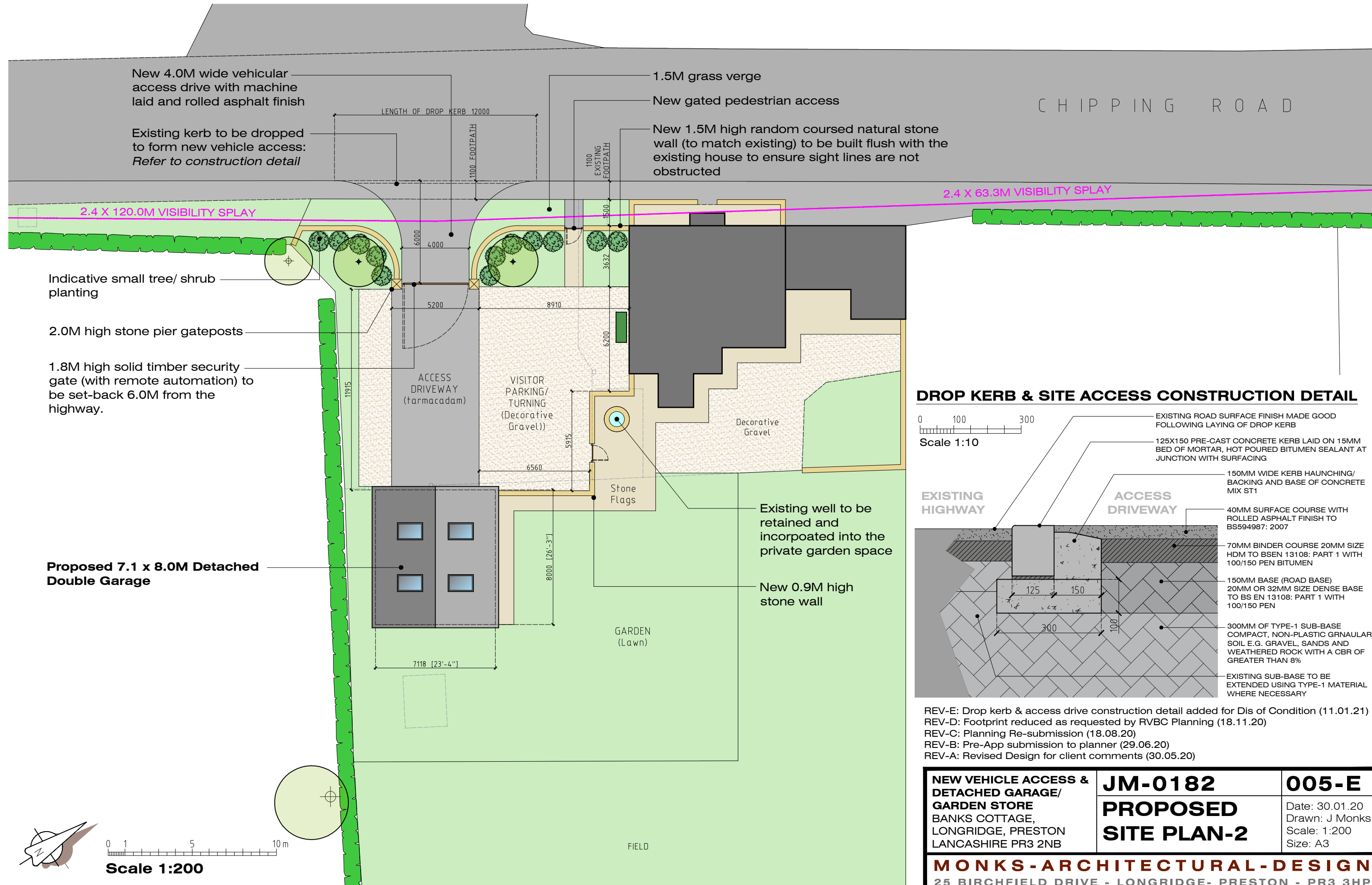

DROP KERB & SITE ACCESS CONSTRUCTION DETAIL

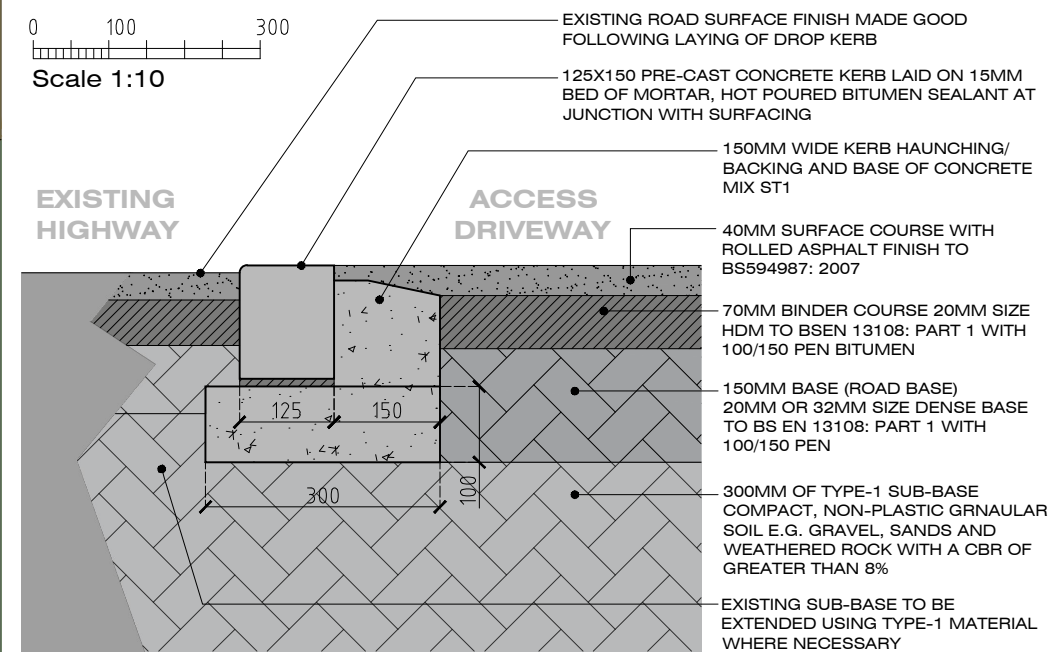

REV-E: Drop kerb & access drive construction detail added for Dis of Condition (11.01.21)
 REV-D: Footprint reduced as requested by RVBC Planning (18.11.20)
 REV-C: Planning Re-submission (18.08.20)
 REV-B: Pre-App submission to planner (29.06.20)
 REV-A: Revised Design for client comments (30.05.20)

NEW VEHICLE ACCESS & DETACHED GARAGE/ GARDEN STORE BANKS COTTAGE, LONGRIDGE, PRESTON LANCASHIRE PR3 2NB	JM-0182	005-E
	PROPOSED SITE PLAN-2	
Date: 30.01.20 Drawn: J Monks Scale: 1:200 Size: A3		
MONKS-ARCHITECTURAL-DESIGN 25 BIRCHFIELD DRIVE - LONGRIDGE- PRESTON - PR3 3HP		