

A. SETTING OUT.

1. PLANTING SHALL BE SET OUT AS INDICATED ON THE DRAWING. ALL BEDS TO BE A MINIMUM OF 1 METRE WIDE AND MEASURED FROM EXISTING FIXED POINTS.

2. IF THE BED IS SEALED WITH CONCRETE THE CONTRACTOR SHALL INFORM THE SITE MANAGER OR LANDSCAPE ARCHITECT TO DETERMINE IF FOOTINGS ARE EXCESSIVE AND CAN BE REDUCED OR PAVED.

B. GROUND PREPARATION.

1. THE FOLLOWING WORKS SHOULD BE CARRIED OUT TO EXISTING TOPSOIL TO ENSURE IT CONFORMS TO BS 3882 1994. TOPSOIL SHOULD BE FREE FROM ROCKS LARGER THAN 50MM IN DIAMETER, CONCRETE, WIRE, BRICK, ALL ROOTS AND LESS THAN 20% CLAY.

C. PLANTING.

1. ALL PLANTING TO BE WATERED IN WITH 20 LITRES PER SQUARE METER. TREES SHALL BE WATERED IN WITH 25 LITRES PER TREE POSITION. TREES TO INCLUDE IRRIGATION PIPES.

2. TREES TO INCLUDE 1.6M CHESTNUT STAKE 600MM ABOVE GROUND AND 100MM BELOW THE GROUND AND 1 NO. TREE TIE AND SPACER.

3. TURF TO BE PREMIUM GRADE CULTIVATED TURF.

4. ALL CLIMBERS TO INCLUDE PRESSURE TREATED SOFTWOOD TRELLIS WORKS (1.80 X 1.80M) FIXED TO EXISTING WALLS OR FENCES.

D. MULCH

FOLLOWING PLANTING SUPPLY & SPREAD 50MM OF ORNAMENTAL BARK MIXED CONIFER MULCH 30-50MM PARTICLE SIZE TO ALL PLANTED AREAS. FINISHED MULCH LEVELS SHALL BE NO HIGHER THAN 15MM BELOW GRASS OR PAVEMENT LEVELS TO AVOID ANY SPILLAGE ONTO PAVEMENTS OR LAWNS.
GENERAL NOTES FOR THE DEVELOPER

ALL SOIL LEVELS FOR SHRUB BEDS AND GRASS AREAS SHOULD HAVE ANY COMPACTED SUB-GRADE THOROUGHLY BROKEN UP BY MACHINE BEFORE INSTRUCTING THE GROUND WORKER TO SPREAD TOPSOIL OR THE LANDSCAPE CONTRACTOR TO COMMENCE WORK AS THE BEDS WILL BECOME WATERLOGGED IN WET WEATHER AND THE PLANTS AND TURF WILL DIE.

TOPSOIL

TOPSOIL SPREAD FROM ON SITE SHOULD BE TO THE FOLLOWING DEPTHS. SHRUB BEDS - 450MM GRASS AREAS - 150MM TOPSOIL SHALL BE SPREAD FOR GRASS AREAS FLUSH WITH ANY AREA OF PAVING AND AFTER SETTLEMENT, THE SOIL LEVEL SHOULD BE NO GREATER THAN 10MM BELOW PAVED AREAS TO ALLOW FOR TURF.

C.D.M. REGULATIONS RISK ASSESSMENT.

IT IS THE DEVELOPERS RESPONSIBILITY TO DESIGN FOUNDATIONS TO ACCOMMODATE THE PROPOSED TREE AND SHRUB PLANTING. REFERENCE SHOULD BE MADE TO NHBC STANDARDS VOLUME PARTS 4.2 AND 4.3 REGARDING TREES AND SHRUBS IN RELATION TO FOUNDATIONS.

ALL BARE ROOT PLANTS TO HAVE RABBIT GUARDS

ALL TREES IN CLOSE PROXIMITY TO HARD SURFACES/ SERVICES AND FOOTPATHS ETC ARE TO HAVE GREEN LEAF ERODIOLO ROOT BARRIERS OR SIMILAR APPROVED.

BIRD AND BAT BOXES TO BE LOCATED IN MATURE EXISTING TREES AT LEAST 5M ABOVE GROUND, OR AS DIRECTED BY AN ECOLOGIST. TYPE TO BE APPROVED.

NORTH IS ASSUMED

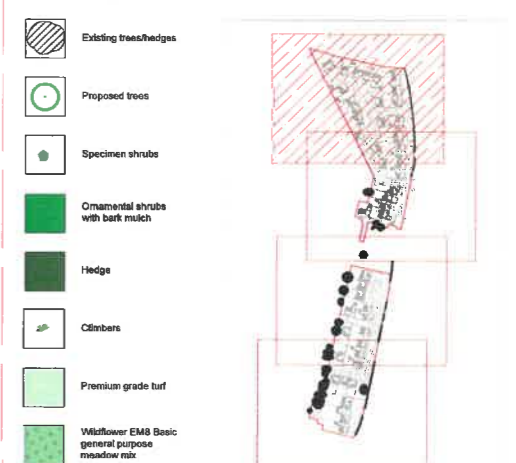

Revision		
A	Scheme adjusted to new layout	JW 11.12.20