

GROUND FLOOR GARAGE/UTILITY EXTENSION

Ground floor to the extension to achieve a minimum u value of 0.22W/m2k. To consist of consolidated compacted hardcore, blinded with 50mm sand blinding, 1200gauge DPM lapped up and linked in with the DPC level. Provide 100mm Kingspan insulation or similar approved with minimum 25mm perimeter insulation to the external walls, separating layer with a proposed minimum 100mm thick Gen 2 concrete slab.

WALLS

Line internal walls with timber stud frame 75\*50mm on sole plate on dpc. Infill studs with 75mm kingspan insulation. finish with 12.5mm plasterboard and plaster. Maintain cavity between external wall and internal timber stud frame

ROOF EXTENSION

Propose trussed roof construction to be design by truss manufacturer. tiled on 25\*5mm tile baton on breathable membrane. Vertical restraint provided to 100\*75mm wall plate by 35\*5mm MS straps at 1500mm centres

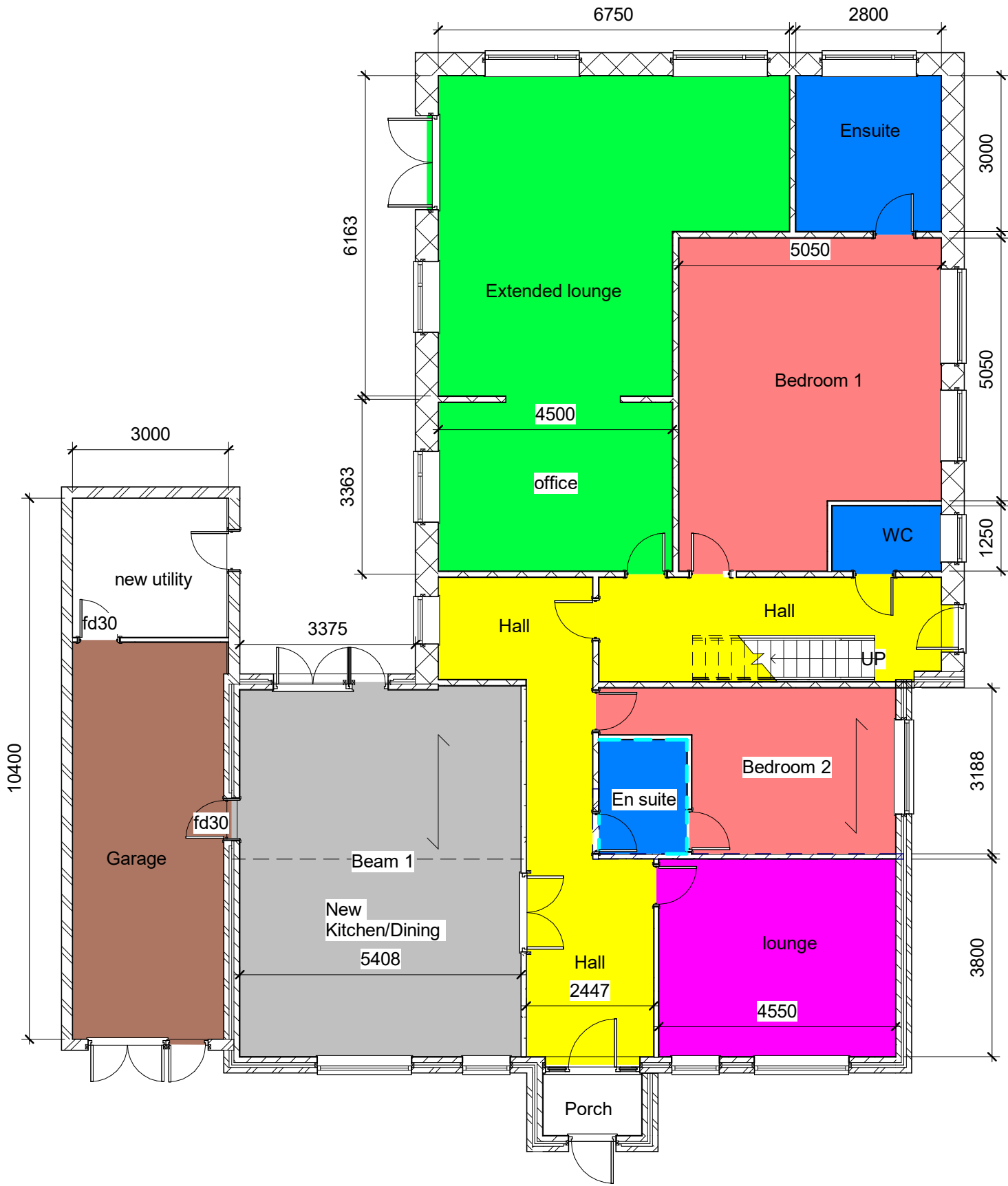

1 Ground floor  
1 : 100

	No.	Description	Date	<div><b>AUTODESK</b> www.autodesk.com/revit</div>				PROJECT First floor extension		CLIENT 21 Paris		
										Date Issue Date	Project number Project Number	Scale (@ A3) 1 : 100
				CODE	STATUS	SUITABILITY DESCRIPTION	PURPOSE OF ISSUE	SHEET Proposed Floor Plan		Drawn by Author	DRWAING NUMBER B101 revision 1	
										Checked by Checker		REV