



See inset plan below

LEGEND

Surface materials

- Reclaimed Yorkshire stone cobbles proposed
Colour: Natural
- Tarmac with timber edging proposed
Colour: Natural
- Timber decking with timber decking steps proposed
Colour: Natural
- Self binding gravel path proposed
Colour: Natural

Boundary materials

- Post and wire fence proposed
Colour: Natural
- Timber post and rail gate proposed (located at northern boundary)
Colour: Natural
- Timber post and rail fencing (located at entrance)
Colour: Natural
- Timber post and rail gate, vehicular and pedestrian
Colour: Natural (located at entrance)

Lighting

- Timber downlit lighting bollard to pathways and roadsides
Colour: Natural
Not currently shown on plan

General

- Application boundary
- Ownership boundary
- Public Right of Way existing
- Public Right of Way extinguished
- Public Right of Way proposed

INDICATIVE PLANT LIST

Woodland matrix
Sizes to include 18-20cmg, 8-10cmg and whips

- Alnus glutinosa (Alder)
- Betula pubescens (Downy Birch)
- Corylus avellana (Hazel)
- Ilex aquifolium (Holly)
- Malus domestica 'Dog's Snout' (Apple)
- Malus domestica 'Ribston Pippin' (Apple)
- Quercus patrea (Sessile Oak)
- Sorbus aucuparia (Rowan)
- Salix caprea (Goat Willow)

Individual trees
Sizes to include 18-20cmg and 8-10cmg

- Alnus glutinosa (Alder)
- Betula pendula (Silver birch)
- Pyrus Chanticleer (Ornamental pear)

Individual trees (continued)

- Quercus robur (Oak)
- Sorbus aria (Whitebeam)

Native Hedgerow Species
Size 80-100cm height

- Acer campestre (Field Maple)
- Crataegus monogyna (Hawthorn)
- Corylus avellana (Hazel)
- Ilex aquifolium (Holly)
- Malus sylvestris (Crab Apple)
- Lonicera periclymenum (Common Honeysuckle)
- Rosa canina (Dog Rose)

Woody shrub buffer
Size: whips

- Crataegus monogyna (Hawthorn)
- Corylus avellana (Hazel)
- Field maple (Acer campestre)
- Ilex aquifolium (Holly)
- White willow (Salix alba)
- Wych elm (Ulmus glabra)

Pond species
Size 2L pots

- Flowering rush (Butomus umbellatus)
- Meadowswet (Filipendula ulmaria)
- Pendulous sedge (Carex pendula)

Pond Species (continued)

- Purple loosestrife (Lythrum salicaria)
- Stinking iris (Iris foetidissima)
- Water smartweed (Persicaria amphibia)

Meadow
Existing grass to be subjected to scrapping and seeding. Seed mix Emorsgate EM3 – Special general purpose meadow mixture or equivalent and approved to be used. Existing grasses allowed to grow and mowing regime applied to encourage wildflower growth. Mown paths are created throughout to allow visitors to use.

Soft materials

- Existing trees and vegetation to be retained with Root Protection Area shown in pink
- Existing trees to be removed
- Tree proposed
- Woodland matrix proposed
- Woody shrub buffer proposed
- Hedge proposed
- Grass proposed
- Meadow proposed with mown paths
- Pond
- Pond species
- Timber bench
- Fallen trunk, informal play feature

Inset Plan

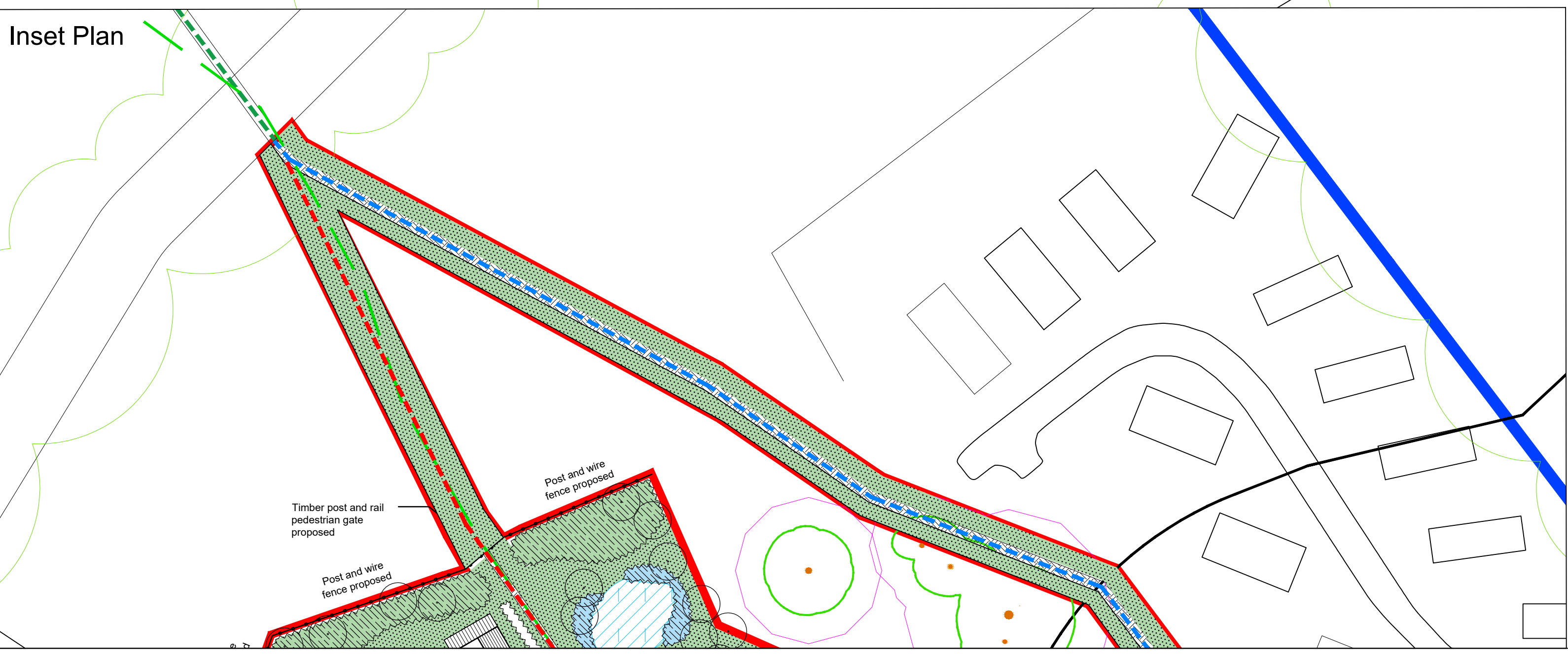

04/10/21
date
01
rev

04/10/21
date
01
rev

PROW redirected, road moved, site bridge removed
description

Job no. RS1108

902

Proposed hard and soft landscape
drawing scale (format - 1:500 @ A1)

Reed Studio | Keelham Cottage | Keelham Lane | Todmorden | OL14 8RX

©2013 do not scale from drawing report discrepancies immediately

Reed Studio