

Higher Road, Longridge

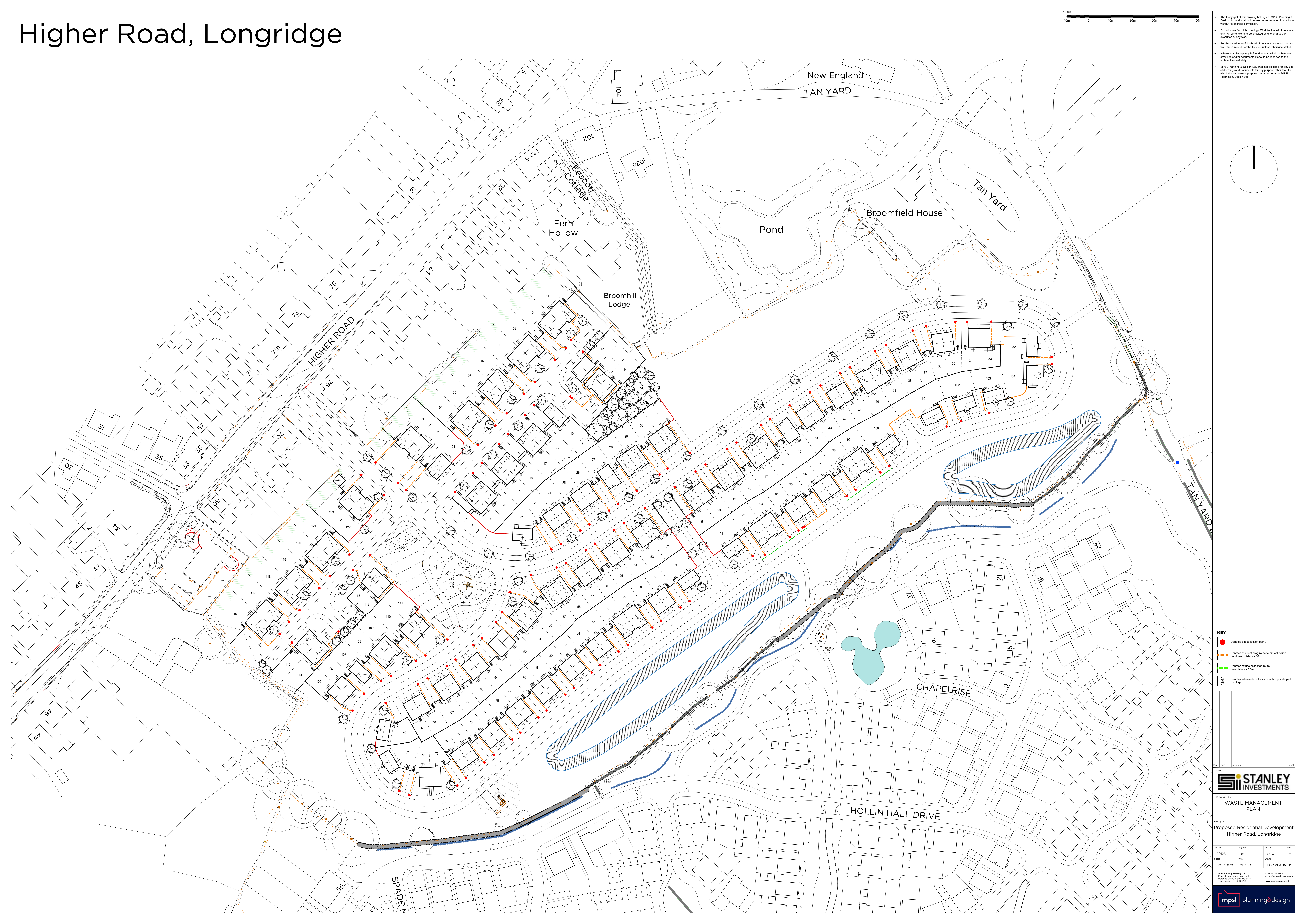

1:500
0 10m 20m 30m 40m 50m

The Copyright of this drawing belongs to MPSL Planning & Design Ltd. and shall not be used or reproduced in any form without its express permission.

Do not scale from this drawing - Work to figure dimensions only. All dimensions to be checked on site prior to the execution of any work.

For the avoidance of doubt all dimensions are measured to wall structure and not the finishes unless otherwise stated.

Where any discrepancy is found to exist within or between drawings and/or documents it should be reported to the architect immediately.

MPSL Planning & Design Ltd. shall not be liable for any use of drawings and documents for any purpose other than for which the same were prepared by or on behalf of MPSL Planning & Design Ltd.

KEY

- Denotes bin collection point.
- Denotes resident drop route to bin collection point, max distance 20m.
- Denotes refuse collection route, max distance 20m.
- Denotes wheelie bins location within private plot curtilage.

Rev	Date	Revision
1	08/04/2021	FOR PLANNING

STANLEY INVESTMENTS

WASTE MANAGEMENT PLAN

Project: Proposed Residential Development Higher Road, Longridge

Drawn By	Drawn Date	Drawn	Rev
08	08/04/2021	CSW	1

Scale: 1:500 @ A0 April 2021 FOR PLANNING

mssl planning & design ltd
14 west coast commercial park
clarence avenue, rufford park,
newcastle upon tyne
NE17 7GJ

T: 0191 725 9999
E: info@msslplanning.co.uk
www.msslplanning.co.uk

mssl planning & design