

Design and Access Statement

**Proposed New Field Barn
Mulberry Grange
Dancer Lane
Rimington
Clitheroe
BB7 4EE**

Proposed New Field Barn

Proposal to be read in conjunction with attached drawings.

1. Introduction

Mr and Mrs Ford have developed Mulberry Grange over the last 14 years, including upgrading and refurbishing the farmhouse and outbuildings.

An application (3?2019/0537) approved in 2019 approved the construction of a single storey stable block on the site of the original (now demolished) concrete barn (24m x 14m). The site of the concrete barn has now been returned to grass and a decision has been made not to construct the stable block on this area of land. (This can be conditioned).

The stable block approved was 190m². Mulberry Grange has 59 acres of land.

2. Proposal

To obtain planning approval for an oak built and clad field barn approximately 50m from the timber clad garage barn. The field barn measures 15m x 10m (150m²) and is single storey. (This will be smaller than the approved stable block).

The barn is located at the end of an existing gravel track shown on the site plan (4573/3/01) and the Google Earth photograph of the site (attached).

Currently the proposed site is used for 2No. sea containers which house:

1. Farm equipment.
2. Feedstore / Hay.
3. Quad bikes and general equipment.

The proposal is to replace this storage compound with a new timber field barn capable of security housing all the equipment including a tractor, the shepherd's hut, all the current farm equipment and space for straw and animal feed.

The main access door is high enough to drive in with a tractor and trailer. Farm equipment security is paramount in the 21st century.

3. The Site

The site is flat, a watercourse is adjacent so the rainwater can be drained into the stream from the roof.

The driveway and surrounds will be finished in gravel.

It is intended to plant 6No. new oak trees around the site.

4. The Building

The building is an oak framed field barn (see attached drawings) with vertical oak boarding full height to the external walls with a cedar shingle roof, 15m x 10m x 6m.

This design reflects the existing retained garage barn adjacent to the house.

Duncan N Isherwood RIBA
May 2021



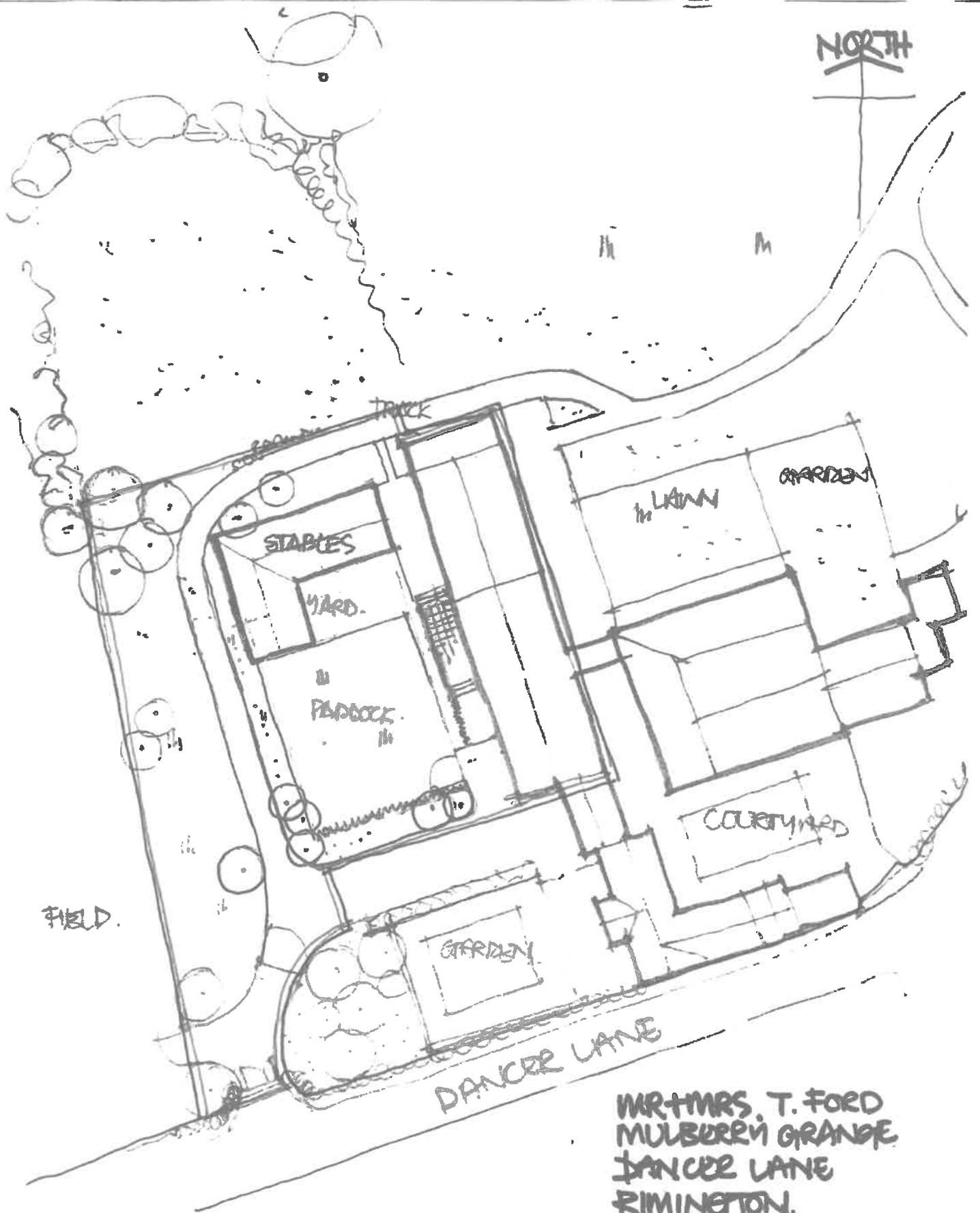

MR + MRS. T. FORD
 MULBERRY GRANDE
 1500 MULBERRY LANE
 RIMINGTON.

PROPOSED SITE PLAN
 SCALE 1:500 @ A4.
 4573-05-6.A.

320190777F

