

Heritage Statement

For

Proposed erection of a Class B2 (light industrial) building on former coach depot. Build of random stone height 1200mm with green metal sheet cladding above and green metal sheet roofing with roof lights

Within the land to the rear of

Pimlico Barn, Gisburn

On behalf of

Mr Rick Wilson

Introduction

This application is for the erection of a storage building within the rear curtilage of Pimlico Barn, Gisburn. This building is to replace a former Duckworth's coach depot that was demolished in the 2000s following a fire, causing the building to fall into a derelict state, causing serious safety breaches for those working in the local proximity.

The proposed building is surrounded by random stone dwellings to the north and east elevations. With a yard area separating the building and Pimlico Barn to the south. The west edge of the site and building is bordered with Mill Lane.

This document is to be read alongside the Planning Statement.

Conservation Area: Gisburn

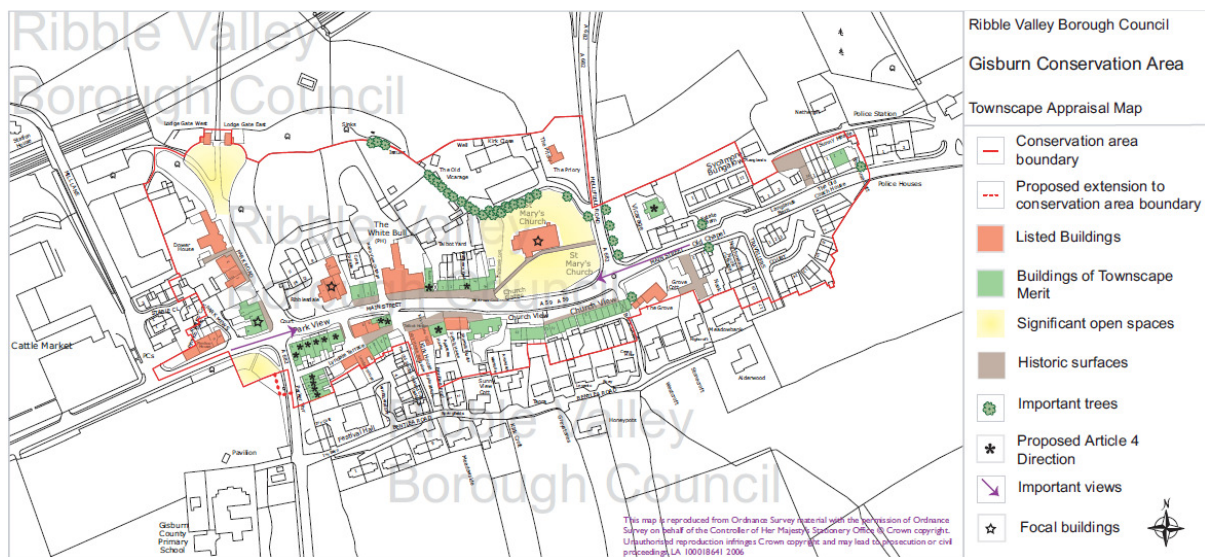

As can be seen from the map extract above, taken from the RVBC website, the proposed site lies outside the Conservation Area. The buildings that line the main road, to the front of the site, are inside the Conservation Area, however the site shall not have any negative impacts or adjoin these buildings in any way.

There shall be no Listed Buildings, Buildings of Townscape merit, significant open spaces, historic surfaces, important trees or local buildings affected by the proposals.

Conclusion

Should the application be successful there shall be no negative impacts upon the Conservation Area and Heritage assets of Gisburn.