

PROPOSED GROUND FLOOR PLAN  
1:50 @ A1 1:100 @ A3

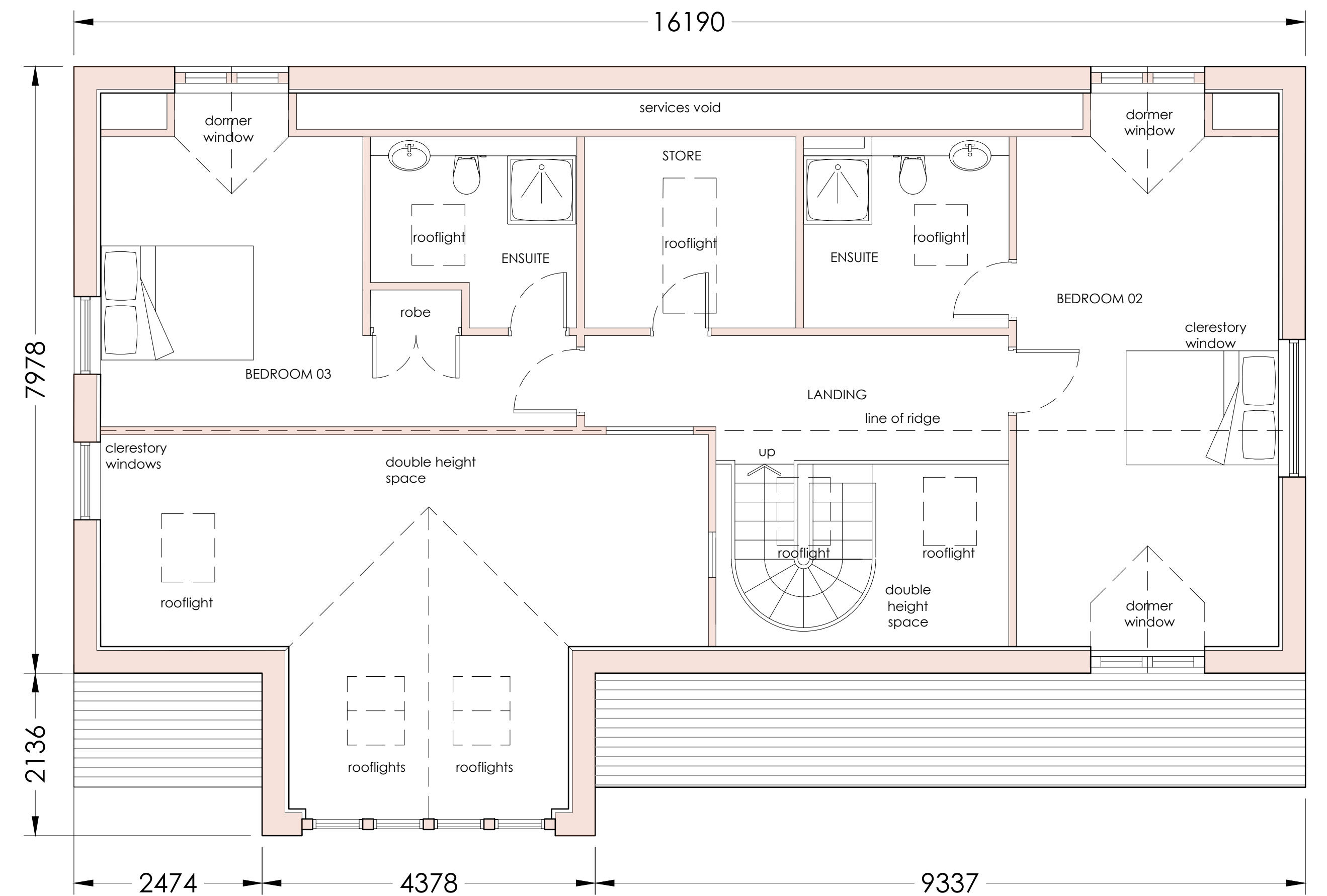

PROPOSED UPPER LEVEL PLAN  
1:50 @ A1 1:100 @ A3

#### NOTES

Rev A - Floor plan areas reduced  
Rev B - Dimensions added  
Rev C - Floor plan areas revised  
Rev D - Dimensions added

PROJECT AND DETAILS:  
Proposed Single Storey House

scalable in metres

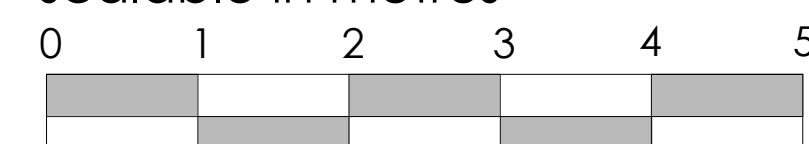

ADDRESS:  
Tree Tops, Springfield Close,  
Wiswell Lane, Whalley BB7 9AF

CLIENT:  
Kevin and Helen Eastham

SCALE: 1:50 @ A1  
1:100 @ A3

DRAWN:  
IB

DATE: 13 05 2021

REVISION	A	B	C	D

DWG TITLE:  
PROPOSED FLOOR PLANS

DWG NO:  
354-PL05D

**ATOLL**  
art and architecture collaborative

Ian Banks • Director  
m 0771 7710014 • ian.banks@atolluk.com • www.atolluk.com