

PROPOSED GROUND FLOOR PLAN
1:50 @ A1 1:100 @ A3

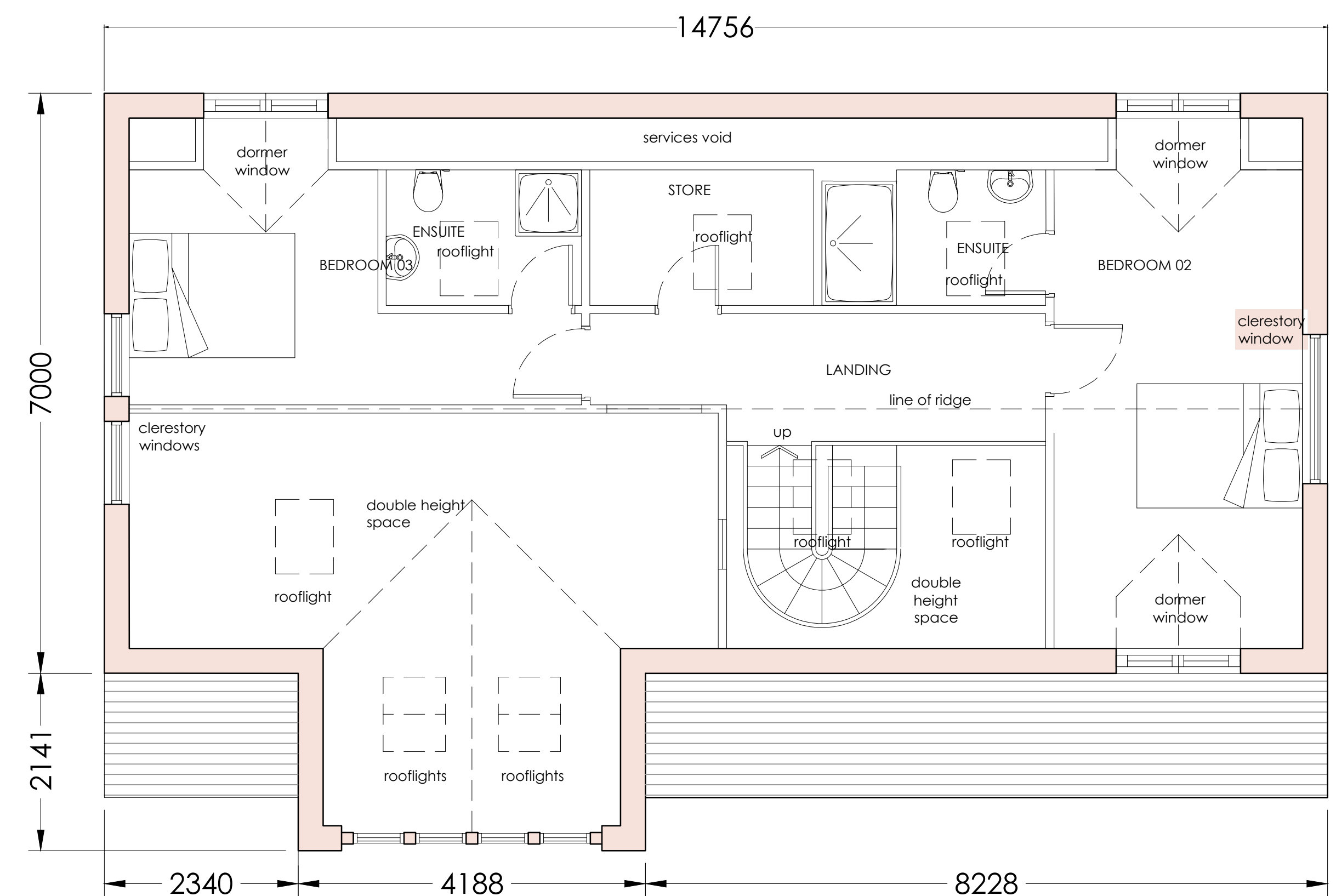

PROPOSED UPPER LEVEL PLAN
1:50 @ A1 1:100 @ A3

NOTES

Rev A - Floor plan areas reduced
Rev B - Dimensions added

PROJECT AND DETAILS:
Proposed Single Storey House

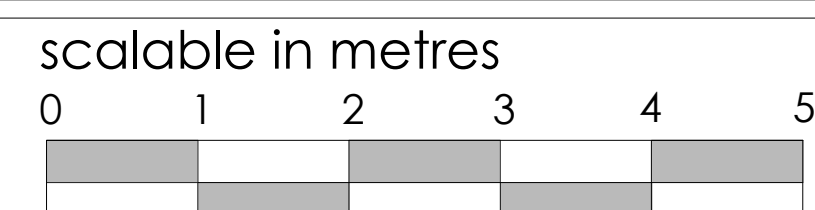

ADDRESS:
Tree Tops, Springfield Close,
Wiswell Lane, Whalley BB7 9AF

CLIENT:
Kevin and Helen Eastham

SCALE: 1:50 @ A1
1:100 @ A3

DRAWN:
IB

DATE: 13 05 2021

REVISION

A	B				

DWG TITLE:
PROPOSED FLOOR PLANS

DWG NO:
354-PL05B

ATOLL
art and architecture collaborative

Ian Banks • Director
m 0771 7710014 • ian.banks@atolluk.com • www.atolluk.com