

23 Whalley Road, Wilpshire

Transport Note

106 Albert Mill
10 Hulme Hall Road
Manchester,
M15 4LY

0161 4649495

✉ info@modetransport.co.uk

Client: TLC

Date: 12 October 2021

Prepared by: LJ

Job No J326099

Approved by: ME

1. Introduction

1.1.1 Mode Transport Planning ('Mode') has been appointed by TLC (the 'Applicant') to provide transport planning and highways advice in relation to a residential development at 23 Whalley Road in Wilpshire, Ribble Valley (hereinafter referred to as the 'Site').

1.1.2 The site location is shown in Figure 1.1.

Figure 1.1 : Site Location (source: Google Earth)



- 1.1.3 The existing unit comprises a photography studio. The development proposals will create 3no. 2-bedroom flats (Use Class C3) . The proposals include 3no. car parking spaces and secure cycle parking for up to 10no. cycles.
- 1.1.4 This note has been prepared to assess the development proposals, with particular consideration to the car parking provision and on-street parking availability, expected trip generation and accessibility by sustainable modes of travel.

2. Existing Conditions

2.1 Local Highway Network

A666 Whalley Road

- 2.1.1 The site is located on Whalley Road in Wilpshire, c.4km north of Blackburn Town Centre. In the site vicinity, Whalley Road consists of a c.7m wide two-way single carriageway, with c.2.0m wide footways on both sides of the road. Whalley Road is subject to a 30mph speed limit and benefits from the presence of street lighting columns.
- 2.1.2 Unrestricted on-street parking is available along sections of Whalley Road in the vicinity of the site.

2.2 Road Safety

- 2.2.1 Collision data at or within the vicinity of the site has been obtained from the CrashMap database (crashmap.co.uk).
- 2.2.2 A review of the CrashMap database shows there has been one Personal Injury Collision (PIC) recorded in the most recent available 5-year period, the location and severity are shown in [Figure 2.1](#).

Figure 2.1 : Personal Injury Collision Data (source: CrashMap Pro)

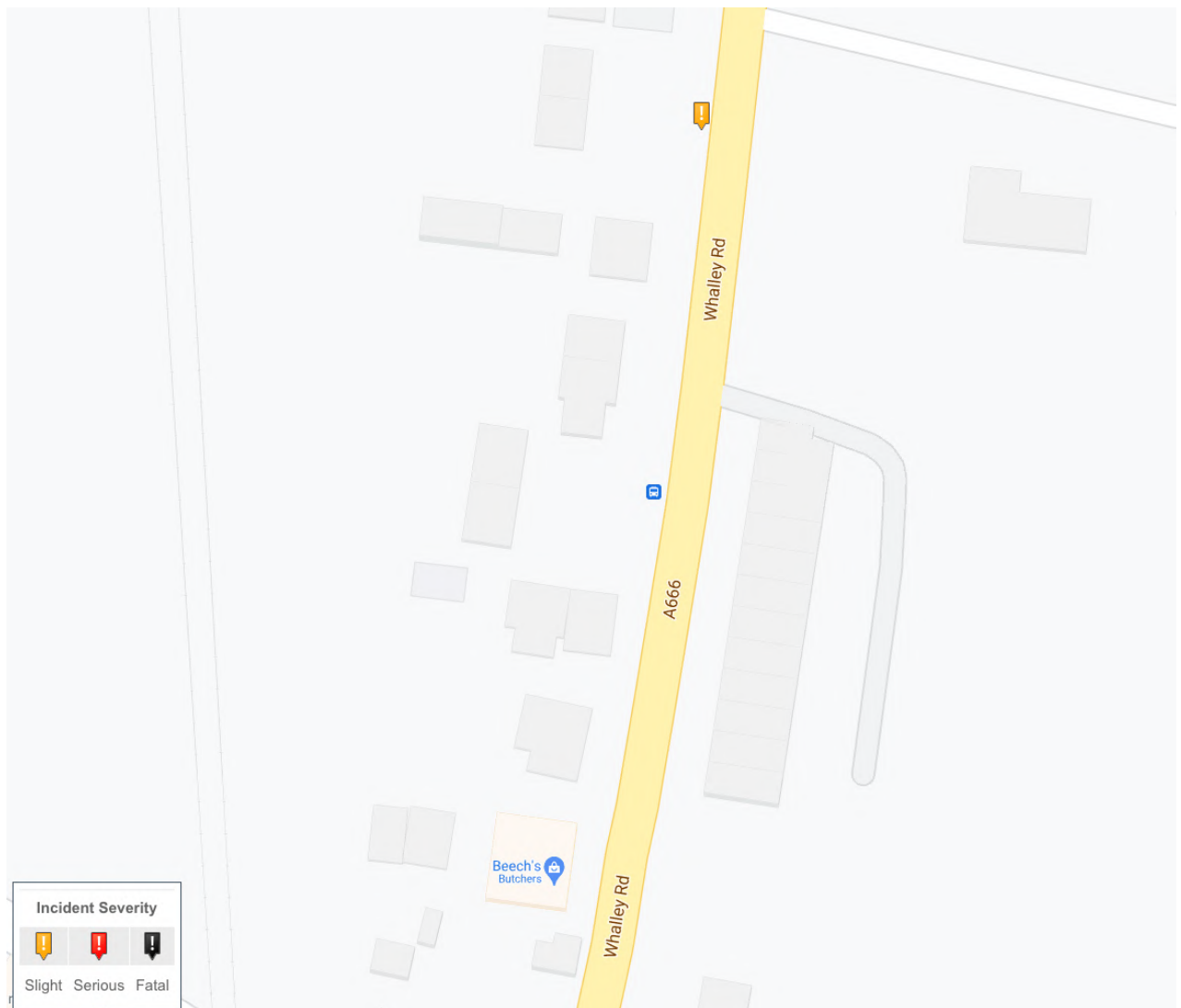

2.2.3 There is no evidence to suggest that the highway layout, design or condition were a significant factor in the recorded PIC. There is also no evidence to suggest that the proposed development would increase risk of PICs in the surrounding area or have a detrimental impact on highway safety.

3. Development Proposals

3.1.1 The development proposals will convert an existing photography studio and create 3no. 2-bedroom flats (Use Class C3). The proposals include 3no. car parking spaces and parking for up to 10no. cycles with associated refuse storage area and garden courtyard. The proposed site layout plans are shown below in [Figure 3.1](#) and attached in [Appendix A](#).

Figure 3.1 : Proposed Site Layout Plan (source: Mark Gordon Design + Associates)

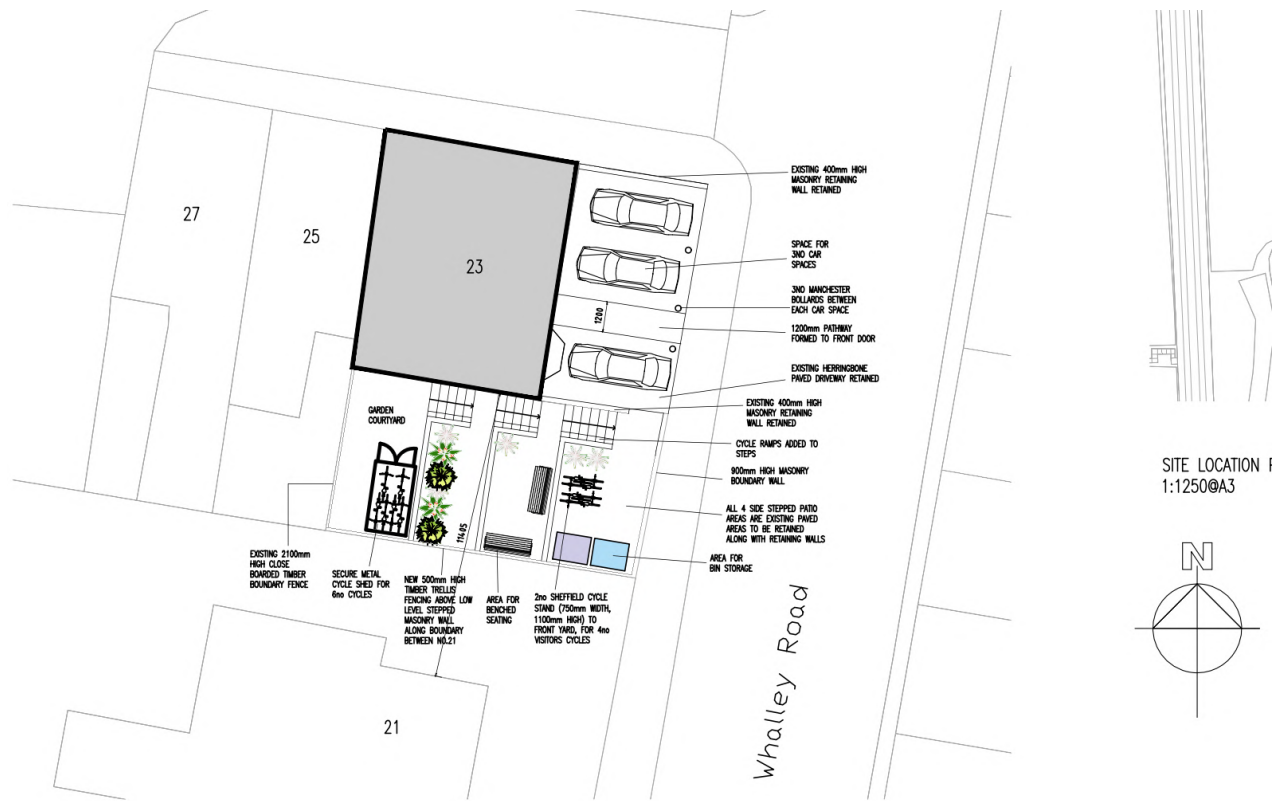

3.2 Servicing Arrangement

3.2.1 As shown in Figure 3.1, the refuse storage area will be located on the southern boundary to enable the site to be serviced directly from Whalley Road. In accordance Manual for Streets (MfS) guidance and BS:5906, residents will not be required to carry waste for more than 30m and waste collection vehicles will be able to get within 25m of the waste collection point.

3.3 Parking Provision

3.3.1 The Joint Lancashire Structure Plan (JLSP) adopted in 2005 sets out local parking standards. For 3no. 2-bedroom apartments (Use Class C3), in sites with low accessibility (as defined by the Accessibility Questionnaire), the parking standards presented in Table 3.1 apply.

Table 3.1 : Local Parking Standards

Use Class	Broad Land Use	Bedrooms	Car Parking per Dwelling	Cycle Parking per Dwelling
C3	Dwelling Houses	2-3 bedrooms	2 spaces	2 spaces

3.3.2 Based on the adopted parking standards the proposed development would need to provide 6no. car parking spaces and 6no. cycle parking spaces.

- 3.3.3 As outlined above, the proposed development will provide 3no. parking spaces, which equates to 1no. parking space per dwelling. An evidenced based approach to justify parking provision below the adopted standard has been considered in [Section 5](#) of the note using 2011 Census household car and van availability for the local area.
- 3.3.4 The proposed cycle parking provision for 10no. cycles (6no. spaces provided within secure cycle storage and 2no. Sheffield Stands providing 4no. spaces) is in compliance with minimum cycle parking standard specified in the JLSP.

4. Sustainable Accessibility

4.1 Introduction

- 4.1.1 Current Government policy and guidance places significant emphasis on the promotion of sustainable transport modes for all new developments. This forms part of a long-term strategy to reduce the reliance on private car trips.
- 4.1.2 The National Planning Policy Framework (NPPF), published in July 2021, sets out the Government's planning policies for England and how these are expected to be applied. Chapter 9 of the NPPF, '*Promoting Sustainable Transport*', sets out the important role that transport issues and policies have in facilitating sustainable development.
- 4.1.3 Paragraph 105 states that: "*Significant development should be focused on locations which are or can be made sustainable, through limiting the need to travel and offering a genuine choice of transport modes. This can help to reduce congestion and emissions and improve air quality and public health. However, opportunities to maximise sustainable transport solutions will vary between urban and rural areas, and this should be considered in both plan-making and decision-making.*"
- 4.1.4 The subsequent sub-sections consider accessibility via sustainable modes of transport to the proposed development site, including access by public transport, cycle and on foot.

4.2 Walking

- 4.2.1 Guideline walking distances provided in the Chartered Institution of Highways and Transportation (CIHT) document '*Guidelines for Providing for Journeys on Foot (2000)*', are shown in [Table 4.1](#).

Table 4.1 : CIHT Acceptable Walking Distances

Criteria	Town Centre	Commuting	Elsewhere
Desirable	200m	500m	400m
Acceptable	400m	1,000m	800m
Preferred Maximum	800m	2,000m	1,200m

4.2.2 The CIHT guidelines shown in [Table 4.1](#) suggest that for commuting purposes up to 500m is a desirable walking distance, up to 1,000m is considered an acceptable walking distance and 2,000m is the preferred maximum walking distance.

4.2.3 Appropriate walking distances are dependent upon the location of a specific development. As described previously in this note, this site is located on Vincent Avenue and connects with existing footways on the local highway network. The network of footways provide access to a range of local amenities along Wilbraham Road, as well as other amenities and public transport provision within a short walk of the site.

4.2.4 As shown in [Figure 4.1](#) there are a wide variety of local amenities located within 500m, 1,000m and 2,000m walking catchments from the site.

Figure 4.1 : Walking Catchment Area and Local Amenities

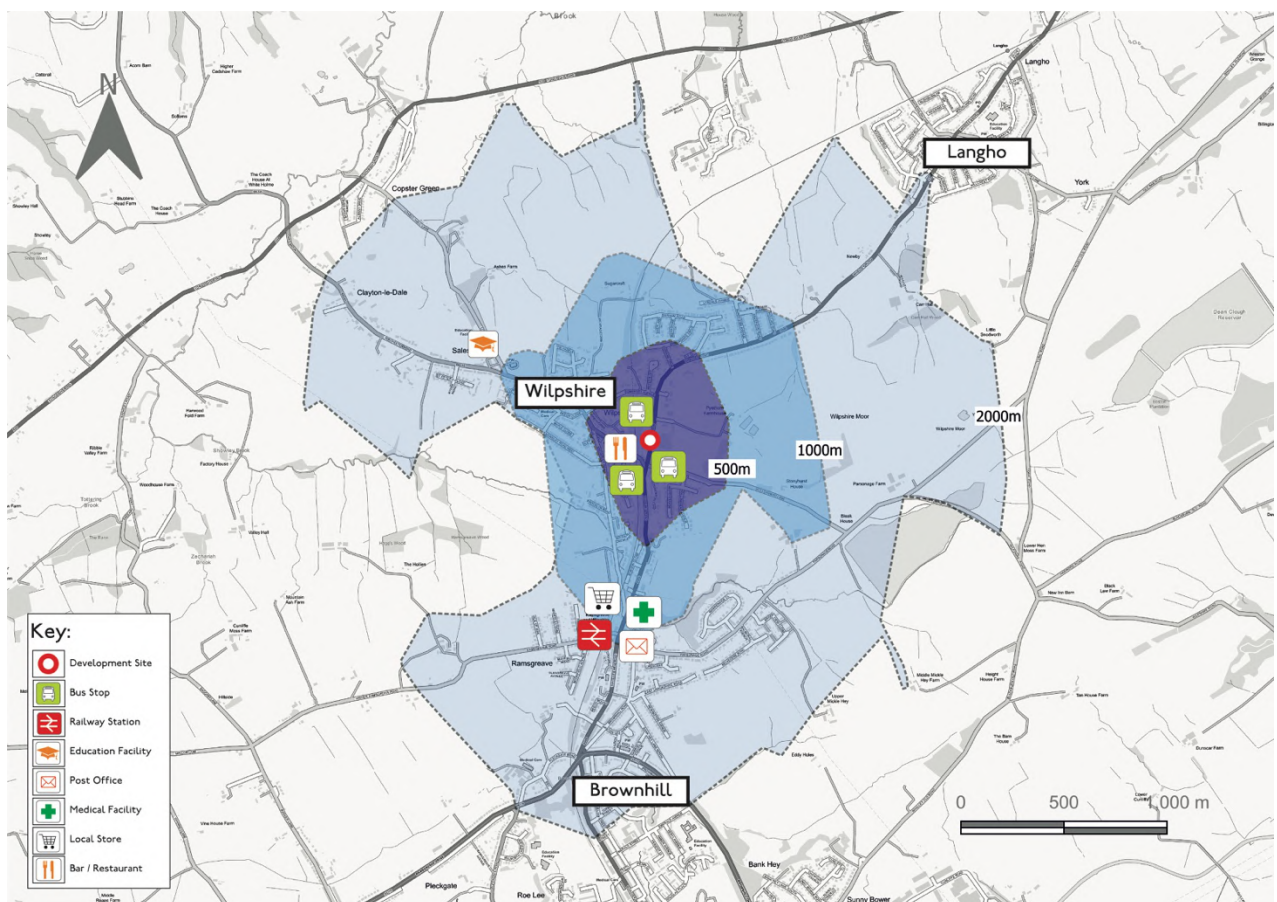

4.2.5 [Table 4.2](#) provides an indication of the distances and approximate walking times to public transport connections and other local amenities. The distances have been measured from the site access; the times are based on an average walking speed of 1.4 metres per second and do not allow for waiting time to cross junctions.

Table 4.2 : Local Amenities and Walking Distances

Amenity	Distance	Walking Time
Bus Stop on Whalley Road NB	25m	<1 minute
Bus Stop on Whalley Road SB	95m	1 minute
Wilpshire Hotel (Bar and Restaurant)	100m	1 minute
The Wilpshire Clinic	850m	10 minutes
Salesbury Post Office	950m	11 minutes
Co-op Food Store	1km	12 minutes
Ramsgreave and Wilpshire Station	1km	12 minutes
Salesbury Primary	1.2km	14 minutes

- 4.2.6 Table 4.2 shows that there are bus stops and a pub/restaurant within 100m (1-minute walk) of the site.
- 4.2.7 In addition, there is a health clinic, post office, food store and railway station within 1km (12-minute walk) from the site.
- 4.2.8 Based on the site's location, proximity to local public transport services and easy access to a wide range of local amenities, walking can be considered to be a realistic method of travel for commuting, shopping and leisure trips.

4.3 Cycling

- 4.3.1 As with pedestrian accessibility, the level of a site's cycle accessibility depends upon a combination of the distance from local amenities and the standard of existing cycle infrastructure. It should, however, be noted that that cycle infrastructure can include facilities shared with vehicles and pedestrians, as well as dedicated cycle infrastructure.
- 4.3.2 In respect of acceptable cycle distances, 'Local Transport Note 1/20: Cycle Infrastructure Design', published by Department for Transport (DfT), states that *'two out of every three personal trips are less than five miles in length - which is an achievable distance to cycle for most people'*.
- 4.3.3 As shown in Figure 4.2, there are a number of locations accessible within 2km and 5km cycle catchments.

Figure 4.2 : Cycle Catchment Area

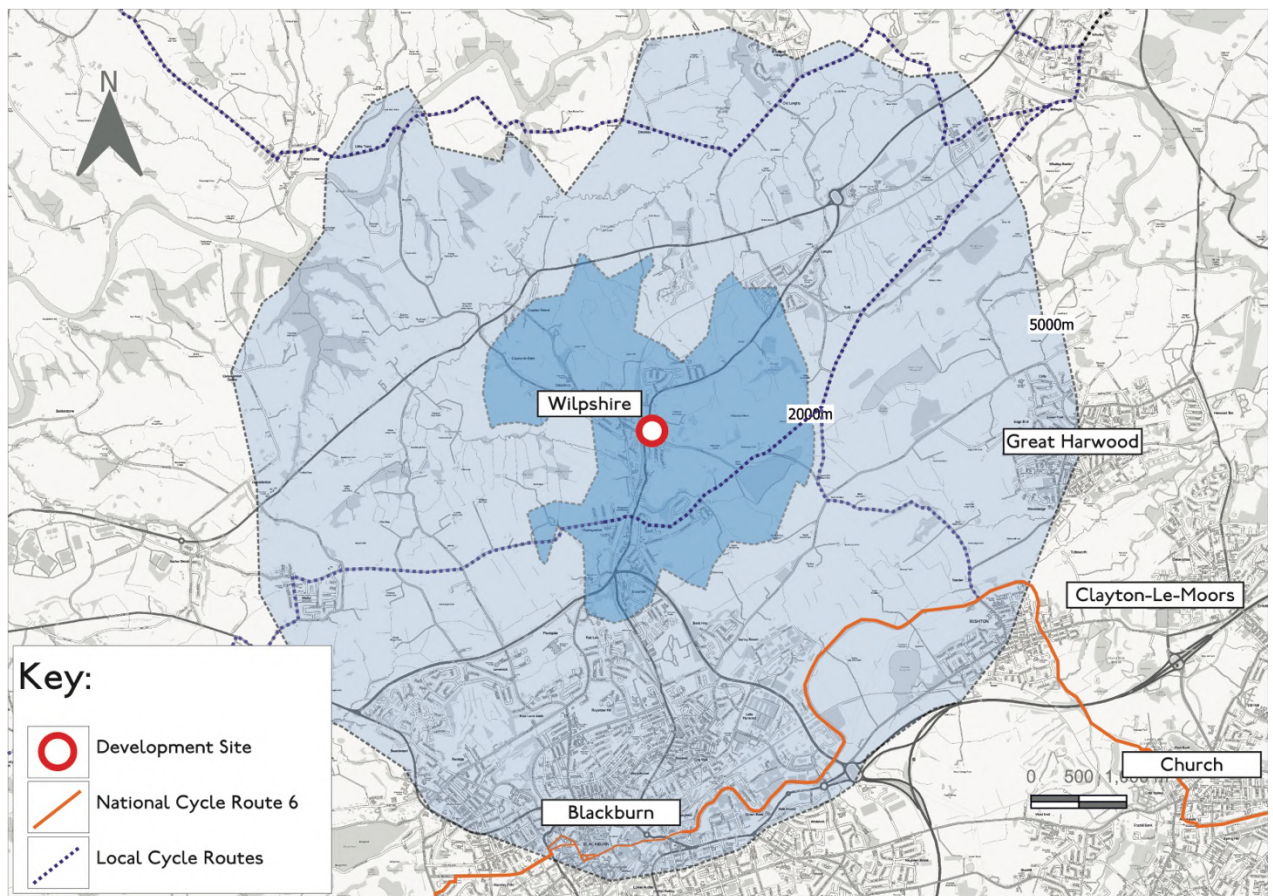

4.3.4 As shown in Figure 4.2, Ramsgreave, Great Harwood and Blackburn Town Centre are located within a 5km cycle catchment of the development site. Furthermore, there is an on-road local cycle route is accessible c.1km south of the site that connects with National Cycle Network (NCN) Route 6.

4.3.5 Access to good quality local cycle infrastructure will encourage cycling for commuting, as well as leisure purposes.

4.4 Public Transport

Local Bus Services

4.4.1 The development site is located within 100m (<1minute walk) of bus stops along Whalley Road providing access to regular high-frequency services to a wide range of local and regional destinations.

4.4.2 Table 4.3 provides a summary of routes and times of local bus services accessible from Whalley Road. Full timetables are attached in Appendix B.

Table 4.3 : Local Bus Services – Wilbraham Road

Service No.	Route	Approximate Two-Way Frequency (buses/hour)				
		AM	Off-Peak	PM	Sat	Sun
22 Valleyline	Clitheroe – Blackburn - Shadsworth	4	4	4	4	2

4.4.3 As summarised in [Table 4.3](#), regular bus services are available from bus stops located within a short walk of the site, including high-frequency weekday and weekend services to key destinations such as Blackburn Town Centre, Royal Blackburn Hospital, Shadsworth and Clitheroe.

Rail Services

4.4.4 In addition to bus services, the site is located within 1km (12-minute walk) of Ramsgreave and Wilpshire railway station. [Table 4.4](#) provides a summary of rail services accessible from this station. Full timetables are attached in [Appendix C](#).

Table 4.4 : Rail Services – Ramsgreave and Wilpshire

Service	Approximate Two-Way Frequency (trains / hour)			
	Mon-Fri (AM/PM peak)	Mon-Fri (off-peak)	Sat	Sun
Manchester – Blackburn - Clitheroe	4	2	2	2

4.4.5 [Table 4.4](#) confirms that there are rail services accessible from Ramsgreave and Wilpshire station, including direct services to Manchester Victoria, Salford Crescent, Salford Central, Blackburn and Clitheroe. This will enable residents of the proposed development to utilise the services for both commuting and leisure purposes providing a viable alternative to single occupancy car journeys.

4.5 Accessibility Assessment

4.5.1 LCC require new residential developments to calculate a Development Accessibility Score. This has been undertaken by Mode on behalf of the Applicant and the site has achieved a 'Low' accessibility score of **15**.

4.5.2 Despite this being in the low category, it has been demonstrated within this section that the site is within acceptable walking and cycling distances of high frequency public transport connections which offer a realistic alternative to single occupancy car journeys.

4.5.3 The inputs and results are summarised below in [Table 4.5](#).

Table 4.5 : Development Accessibility Score Summary

Question	Answer	Score
Distance to nearest bus stop	<200m	5
Distance to nearest railway station	>800m	1
Distance from defined cycling routes	<1km	1
Distance to nearest business park / employment site	<4km	1
Bus frequency from nearest bus stop	30 minutes or less	3
Train frequency from nearest station	30 minutes or less	3
Accessibility to other basic services	3 within 1.5km	1
Total		15

4.6 Summary

- 4.6.1 Overall, it has been shown that the site benefits for excellent levels of accessibility by sustainable modes of travel, including walking, cycling and public transport.
- 4.6.2 The site is located within walking distances of well-established integrated transport systems, offering residents multi-modal access to locations across South Ribble, Blackburn and Greater Manchester – thereby offering a realistic alternative to car trips.

5. Parking Assessment

5.1 Household Car / Van Availability

- 5.1.1 Evidence to support the proposed car parking provision has been derived by analysing car availability data from the 2011 Census for flats / apartments for the Middle Layer Super Output Areas that include and border the proposed development site. The MSOAs are listed below and shown in [Figure 5.1](#):

- Ribble Valley 007;
- Ribble Valley 008;
- Blackburn with Darwen 001; and

- Hyndburn 003.

Figure 5.1 : 2011 Census - MSOA Map (source: Nomis Web)



5.1.2 The car availability data for flats and apartments in the MSOAs listed above is summarised in [Table 5.1](#). The raw Census 2011 data is included in [Appendix D](#).

Table 5.1 : Household Car or Van Availability

Accommodation Type	Households	No Car or Van	1 Car or Van	2+ Cars or Vans
Flats and Apartments (Households)	1,008	387 (38%)	497 (50%)	124 (12%)

5.1.3 [Table 5.1](#) shows that, in total, 38% of flats / apartments in the MSOAs have no access to a car or van, 50% have access to at least one car or van and 12% have access to two or more cars or vans.

5.1.4 To estimate the number of cars (parking demand) associated with the proposed development, the number of households/units proposed (3no.) have been multiplied by the proportions shown in Table 5.1. The results are shown below in Table 5.2.

Table 5.2 : Car or Van Availability – Proposed Development

Accommodation Type	Households	No Car or Van	1 Car or Van	2+ Cars or Vans	Total Cars
Flats and Apartments Proposed	3	1 (0 cars)	2 (2 cars)	0 (0 cars)	2 cars

5.1.5 As shown in Table 5.2, the proposed development is expected to generate parking demand for 2no. cars or vans. As such the proposed 3no. car parking spaces will accommodate the expected levels of demand.

5.2 Alternative to Car Usage

5.2.1 Although the development site has achieved a 'low' accessibility score, it has been shown that the site does benefit from excellent levels of accessibility by public transport, including frequent bus services available from bus stops located with 100m on Whalley Road and train services available from Ramsgreave and Wilpshire Railway Station.

5.2.2 The existing public transport services that are accessible from the site provide a good quality and reliable alternative to the car and demonstrate that car ownership is not a requirement for living at this site.

5.2.3 The existing levels of accessibility by sustainable modes of travel also supports the car availability census data, which shows that 38% of flats and apartments in the area do not have access to a car. This therefore provides further evidence to support the proposed parking provision at the development.

6. Summary and Conclusion

6.1 Summary

6.1.1 This Transport Note has been prepared by Mode Transport Planning to consider transport planning and highways matters in relation to a residential development at 23 Whalley Road in Wilpshire, South Ribble.

6.1.2 The existing unit comprises a photography studio. The development proposals will create 3no. 2-bedroom flats (Use Class C3). The proposals include 3no. car parking spaces and cycle parking for up to 10no. cycles.

6.1.3 This note has been prepared in accordance with current policy, guidance, and best practice. The results of the analysis in this note demonstrates that:

- The site has direct access onto a good quality footway network, which provide safe walking routes to local amenities and public transport connections;
- This site is accessible by a range of sustainable modes of transport, including buses and rail services which can be accessed within an acceptable walking distance of the site. The site can therefore be deemed sustainable in transport and highways terms and is in accordance with the NPPF;
- Analysis of 'Car / Van Availability by Accommodation Type' 2011 census data for the *Ribble Valley 007*, *Ribble Valley 008*, *Blackburn with Darwen 001* and *Hyndburn 003* MSOAs indicates that the proposed level of car parking provision (3no. spaces) will accommodate the 2no. vehicles expected to be available to the residents of the proposed development;
- Despite LCC's 'low' accessibility score, the site does benefit from excellent levels of accessibility including frequent bus services available from bus stops located with 100m on Whalley Road and train services available from Ramsgreave and Wilpshire Railway Station, which provide a good quality and reliable alternative to the car and demonstrate that car ownership is not a requirement for living at this site.
- The site's accessibility by sustainable modes of travel supports the car availability census data, which shows that 38% of flats and apartments in the area do not have access to a car. This therefore provides further evidence to support the proposed parking provision at the development.
- Overall, it can be concluded that the proposed development will not have a severe impact on the local highway network, which is the threshold stated by NPPF (Paragraph 111) under which development should not be refused on highways grounds.

6.2 Conclusion

6.2.1 In conclusion, based on the evidence and analysis presented in this note, there should be no highways or transportation reasons that prevent this planning application from being approved.

APPENDIX A – Site Layout Plan



PROPOSED BLOCK SITE PLAN
1:200@A3

- WASTE STATION 1,000L
1375x1075mm, WITHIN
TIMBER STORAGE
- RECYCLING STATION 1,000L
1375x1075mm, WITHIN
TIMBER STORAGE



LOCKABLE WHITE PLASTIC EUROBIN STORAGE UNIT, WITH OPENABLE LID FOR BIN USE, AND DOUBLE LOCKABLE DOORS FOR EASY ACCESS/EGRESS

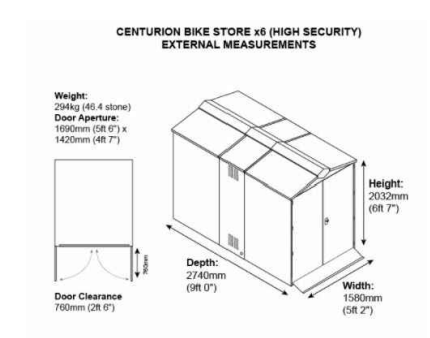

METAL SHED FOR 6no CYCLES BEING 2740mm DEEP AND 1580mm WIDE, WITH A HEIGHT OF 2030mm, POLICE APPROVED. SECURE WITH PADLOCK TO AMIN OF SOLD SECURE SILVER STANDARD. ALSO WITHIN UNIT PROVIDE 3no SHEFFIELD RACKS SECURED TO A SOLID FOUNDATION.



SITE LOCATION PLAN - 200sqm
1:1250@A3

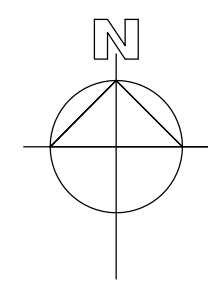

Rev	Amendments	Date	Ints
P2	Amendments after client comments	25.08.21	MG
P1	Amendments after client comments	28.06.21	MG
Rev	Amendments	Date	Ints
Mark Gordon Design + Associates			
Project			
23 WHALLEY ROAD BLACKBURN, BB1 9LQ			
Drawing Title			
SITE LOCATION PLAN PROPOSED SITE PLAN			
Drawn	TW	Checked	—
Date	APR 2021	Scale	1 : 100
Drawing No.	23WR/200/PL	Rev.	P2

APPENDIX B – Bus Timetables

Mondays to Fridays

Clitheroe Interchange stand 6
Whalley bus station stand A
Langho Northcote Road
Emerald Street Roe Lee Park
Blackburn bus station
Blackburn bus station stand 2
Royal Blackburn Hospital bus station stand A
Shadsworth Fecitt Brow

arr
dep

0610	0640	0710	0735	0755	0823	0832	0843	0913	0943		13	43		1413	1453	1443	1523
0623	0653	0723	0749	0809	0837	0857	0857	0927	0957		27	57		1427	1507	1512	1539
0630	0700	0730	0756	0816	0844	0904	0904	0934	1004		34	04		1434	1514	1519	1546
0642	0712	0744	0812	0832	0856	0916	0916	0946	1016		46	16		1446	1526	1531	1558
0655	0725	0759	0827	0847	0909	0929	0929	0959	1029		59	29		1459	1540	1545	1612
0630	0700	0735	0805	0835	0905	0935	0935	1005	1035		05	35		1505	1530	1550	1620
0642	0712	0747	0817	0847	0917	0947	0947	1017	1047		17	47		1518	1543	1603	1633
0646	0716	0751	0821	0851	0921	0951	0951	1021	1051		21	51		1522	1547	1607	1637

this bus runs on school days only and also calls at
Clitheroe Royal Grammar School at 0839

this bus runs on school holidays only

this bus runs on school days except Wednesdays
and school holidays only

this bus runs on school day Wednesdays only and also
calls at Clitheroe Royal Grammar School at 1453

Clitheroe Interchange stand 6
Whalley bus station stand A
Langho Northcote Road
Emerald Street Roe Lee Park
Blackburn bus station
Blackburn bus station stand 2
Royal Blackburn Hospital bus station stand A
Shadsworth Fecitt Brow

arr
dep

1553	1543	1623	1653	1713	1743	1813	1833	1853	1923
1609	1612	1639	1709	1729	1756	1826	1846	1906	1936
1616	1619	1646	1716	1736	1802	1832	1851	1911	1941
1628	1631	1658	1728	1748	1814	1844	1900	1920	1950
1642	1645	1712	1742	1802	1825	1855	1909	1929	1959
1650	1650	1720	1750	1810		1905		2005	
1703	1703	1733	1803	1822		1913		2013	
1707	1707	1737	1807	1826		1916		2016	

this bus runs on school days except Wednesdays and
also calls at Clitheroe Royal Grammar School at 1553

this bus runs on school day Wednesdays
and holidays only

Saturdays

Clitheroe Interchange stand 6
Whalley bus station stand A
Langho Northcote Road
Emerald Street Roe Lee Park
Blackburn bus station
Blackburn bus station stand 2
Royal Blackburn Hospital bus station stand A
Shadsworth Fecitt Brow

arr
dep

	0713	0743	0813	0843	then every 30 mins at	13	43	until	1713	1743	1813	1843	1923	
	0657	0727	0757	0827		0857	27		57	1726	1756	1826	1856	1936
	0704	0734	0804	0834		0904	34		04	1732	1802	1832	1901	1941
	0716	0746	0816	0846		0916	46		16	1744	1814	1844	1910	1950
	0729	0759	0829	0859		0929	59		29	1755	1825	1855	1919	1959
0635	0735	0805	0835	0905	0935	05	35		1805		1905		2005	
0647	0747	0817	0847	0917	0947	17	47		1813		1913		2013	
0651	0751	0821	0851	0921	0951	21	51		1816		1916		2016	

Sundays

Clitheroe Interchange stand 6
Whalley bus station stand A
Langho Northcote Road
Emerald Street Roe Lee Park
Blackburn bus station
Blackburn bus station stand 2
Royal Blackburn Hospital bus station stand A
Shadsworth Fecitt Brow

arr
dep

0918	1018	1118	1218	1318	1418	1518	1618	1718
0932	1032	1132	1232	1332	1432	1532	1632	1732
0938	1038	1138	1238	1338	1438	1538	1638	1738
0949	1049	1149	1249	1349	1449	1549	1649	1749
1000	1100	1200	1300	1400	1500	1600	1700	1800
	1010	1110	1210	1310	1410	1510	1610	
	1019	1119	1219	1319	1419	1519	1619	
	1023	1123	1223	1323	1423	1523	1623	

Mondays to Fridays

Shadsworth Fecitt Brow	
Royal Blackburn Hospital bus station stand B	
Blackburn bus station	arr
Blackburn bus station stand 10	dep
Emerald Sreett Roe Lee Park	
Langho Royal Taj	
Whalley bus station stand D	
Clitheroe Interchange	

0617	0647	0717	0752	0822	0852		22 52		1322	1352	1423	1453	1523	1548	1608
0626	0656	0728	0803	0833	0903		33 03		1333	1403	1435	1505	1535	1600	1620
0636	0706	0742	0818	0848	0916	then	48 16		1346	1416	1449	1519	1549	1614	1634
0550	0620	0645	0710	0733	0745	every	55 25		1355	1425	1455	1525	1555	1620	1640
0558	0628	0653	0718	0743	0755	30	05 35	until	1405	1435	1505	1536	1606	1631	1651
0606	0636	0704	0729	0756	0808	mins	17 47		1417	1447	1517	1549	1619	1644	1704
0613	0643	0713	0738	0805	0817	at	26 56		1426	1456	1526	1558	1628	1653	1713
0625	0655	0725	0750	0819	0831		38 08		1438	1508	1538	1610	1640	1705	1725

on school days this bus continues to
Clitheroe Royal Grammar School at 0839

Shadsworth Fecitt Brow	
Royal Blackburn Hospital bus station stand B	
Blackburn bus station	arr
Blackburn bus station stand 10	dep
Emerald Sreett Roe Lee Park	
Langho Royal Taj	
Whalley bus station stand D	
Clitheroe Interchange	

1638	1708	1738	1808	1827	1917	2017
1650	1720	1749	1819	1835	1925	2025
1704	1734	1802	1832	1845	1935	2035
1710	1740	1810	1840			
1721	1751	1818	1848			
1734	1804	1828	1858			
1743	1813	1837	1907			
1755	1825	1849	1919			

Saturdays

Shadsworth Fecitt Brow	
Royal Blackburn Hospital bus station stand B	
Blackburn bus station	arr
Blackburn bus station stand 10	dep
Emerald Sreett Roe Lee Park	
Langho Royal Taj	
Whalley bus station stand D	
Clitheroe Interchange	

0628	0652	0722	0752		22 52		1722	1752	1817	1917	2017
0638	0703	0733	0803		33 03		1733	1803	1825	1925	2025
0649	0716	0746	0816	then	48 16		1746	1816	1835	1935	2035
0625	0655	0725	0755	every	55 25		1755	1840			
0633	0703	0733	0805	30	05 35	until	1803	1848			
0644	0714	0744	0817	mins	17 47		1813	1858			
0653	0723	0753	0826	at	26 56		1822	1907			
0705	0735	0805	0838		38 08		1834	1919			

Sundays

Shadsworth Fecitt Brow	
Royal Blackburn Hospital bus station stand B	
Blackburn bus station	arr
Blackburn bus station stand 10	dep
Emerald Sreett Roe Lee Park	
Langho Royal Taj	
Whalley bus station stand D	
Clitheroe Interchange	

1024	1124	1224	1324	1424	1524	1624
1032	1132	1232	1332	1432	1532	1632
1042	1142	1242	1342	1442	1542	1642
0930	1030	1130	1230	1330	1430	1530
0938	1038	1138	1238	1338	1438	1538
0950	1050	1150	1250	1350	1450	1550
0959	1059	1159	1259	1359	1459	1559
1011	1111	1211	1311	1411	1511	1611

APPENDIX C – Rail Service Timetables



NORTHERN

12

Train times

4 October –
11 December 2021

Manchester to Blackburn and Clitheroe



This timetable shows all train services between **Clitheroe/Blackburn and Manchester**. Other trains run between **Bolton and Manchester** (Timetable 11).

How to read this timetable



Look down the left hand column for your departure station. Read across until you find a suitable departure time. Read down the column to find the arrival time at your destination. Through services are shown in bold type (this means you won't have to change trains). Connecting services are shown in light type. If you travel on a connecting service, change at the next station shown in bold or if you arrive on a connecting service, change at the last station shown in bold, unless a footnote advises otherwise.

Minimum connection times



All stations have a minimum connection time of 5 minutes unless stated.

Community Rail Partnerships and community groups



We support a number of active community rail partnerships (CRPs) across our network. CRPs bring together local communities and the rail industry to deliver benefits to both, and encourage use of the lines they represent.

Clitheroe Line Community Rail Partnership
www.communityraillancashire.co.uk

Some stations on this route are adopted by local community groups. For more information visit **northernrailway.co.uk/community**

Planning your journey



National Rail Enquiries

For full details of all train times, fares and rail travel information anywhere on the national rail network, call **03457 48 49 50**, or visit **nationalrail.co.uk**

TrainTracker™

For up to date travel information and live departures direct to your mobile, text your station **name** or **location code** to **8 49 50**.

Customers with disabilities or restricted mobility are encouraged to contact our **Customer Experience Centre** who will book assistance for you.

Call: **0800 138 5560**

Textphone: **0800 138 5561**

Email: **assistance@northernrailway.co.uk**

Improving our railway



Engineering work to help improve our services sometimes affects trains, particularly at weekends and bank holidays.

Visit: **northernrailway.co.uk/improvements** or call National Rail Enquiries: **03457 48 49 50** to check before you travel.

Delay Repay



You can claim Delay Repay if one of our trains is late or cancelled and as a result you get to your destination station later than scheduled, whether it is our fault or not.

Visit **northernrailway.co.uk/delayrepay** for more information.

Whilst every care has been taken to ensure the accuracy of the information contained in this timetable, we can accept no liability for any inaccuracies, and reserve the right to change information without further notice. Visit our website for the most up to date timetables and check before you travel.

Manchester - Blackburn - Clitheroe

Mondays to Saturdays from 4 October

					T	T	T	T	T	T	T
									SX	SO	
Manchester Victoria	d	-	0537	-	0741	0839	0941	1041	1141	1144	1241
Salford Central	-	-	0540	-	0744	0842	0944	1044	1144	1148	1244
Salford Crescent	-	-	0545	-	0748	0846	0948	1048	1148	1152	1248
Bolton	-	-	0559	-	0800	0900	1000	1100	1200	1204	1300
Hall I' Th' Wood	-	-	0604	-	0806	0906	1006	1106	1206	1209	1306
Bromley Cross	-	-	0609	-	0810	0910	1010	1110	1210	1212	1310
Entwistle	-	-	06x16	-	08x17	09x17	10x17	11x17	12x17	12x19	13x17
Darwen	a	-	0622	-	0823	0923	1023	1123	1223	1225	1323
	d	-	0624	-	0825	0925	1025	1125	1225	1226	1325
Blackburn	a	-	0631	-	0832	0932	1032	1132	1232	1233	1332
Blackburn	d	0611	0632	0732	0833	0933	1033	1133	1233	1234	1334
Ramsgreave & Wilpshire		0617	0638	0738	0839	0939	1039	1139	1239	1240	1340
Langho		0622	0643	0743	0844	0944	1044	1144	1244	1245	1345
Whalley		0626	0647	0747	0848	0948	1048	1148	1248	1249	1349
Clitheroe	a	0634	0655	0755	0856	0956	1056	1156	1256	1257	1357

Mondays to Saturdays from 4 October

					T	T	T	T	T	T	T
					SX	SO			SX	SO	
Manchester Victoria	d	1344	1341	1441	1541	1641	1709	1711	1741	1841	1941
Salford Central		1347	1344	1444	1544	1644	1712	1715	1744	1844	1944
Salford Crescent		1350	1348	1449	1548	1648	1718	1718	1748	1848	1948
Bolton		1402	1400	1501	1600	1700	1733	1733	1800	1900	2000
Hall I' Th' Wood		1407	1406	1506	1606	1705	1738	1738	1806	1906	2006
Bromley Cross		1411	1410	1511	1610	1710	1742	1742	1810	1910	2010
Entwistle		14x17	14x17	15x17	16x17	17x16	17x49	17x49	18x17	19x17	20x17
Darwen	a	1424	1423	1524	1623	1723	1755	1755	1823	1923	2023
	d	1425	1425	1525	1625	1725	1756	1756	1825	1925	2025
Blackburn	a	1432	1432	1533	1632	1732	1806	1806	1832	1932	2032
Blackburn	d	1433	1433	1533	1633	1733	-	-	1833	1933	2033
Ramsgreave & Wilpshire		1439	1439	1539	1639	1739	-	-	1839	1939	2039
Langho		1444	1444	1544	1644	1744	-	-	1844	1944	2044
Whalley		1448	1448	1548	1648	1748	-	-	1848	1948	2048
Clitheroe	a	1456	1456	1557	1656	1756	-	-	1856	1956	2056

Mondays to Saturdays from 4 October

					T	T	T	T			
Manchester Victoria	d	2041	2140	2216	2307	-	-	-	-	-	-
Salford Central		2044	2143	2219	2312	-	-	-	-	-	-
Salford Crescent		2048	2147	2223	2317	-	-	-	-	-	-
Bolton		2100	2159	2235	2329	-	-	-	-	-	-
Hall I' Th' Wood		2106	2205	2240	2334	-	-	-	-	-	-
Bromley Cross		2110	2210	2243	2339	-	-	-	-	-	-
Entwistle		21x17	22x16	22x50	23x45	-	-	-	-	-	-
Darwen	a	2123	2223	2256	2352	-	-	-	-	-	-
	d	2125	2224	2257	2353	-	-	-	-	-	-
Blackburn	a	2132	2231	2304	0002	-	-	-	-	-	-
Blackburn	d	2133	2232	2305	-	-	-	-	-	-	-
Ramsgreave & Wilpshire		2139	2238	2311	-	-	-	-	-	-	-
Langho		2144	2243	2316	-	-	-	-	-	-	-
Whalley		2148	2247	2320	-	-	-	-	-	-	-
Clitheroe	a	2156	2255	2328	-	-	-	-	-	-	-

Notes

x Stops on request.

T From Rochdale.

SO Saturdays only.

SX Mondays to Fridays only.

Manchester - Blackburn - Clitheroe

Sundays from 10 October

C

Manchester Victoria	d	0755	-	0841	0945	1048	1145	1245	1345	1445	-
Salford Central		-	-	0844	0948	1051	1148	1248	1348	1448	-
Salford Crescent		0802	-	0848	0952	1054	1152	1252	1352	1452	-
Bolton		0815	-	0900	1004	1107	1204	1304	1404	1504	-
Hall I' Th' Wood		0820	-	0905	1009	1112	1209	1309	1409	1509	-
Bromley Cross		0823	-	0909	1013	1115	1213	1313	1413	1513	-
Entwistle		08x30	-	09x16	10x19	11x22	12x19	13x19	14x19	15x19	-
Darwen	a	0836	-	0922	1026	1128	1226	1326	1426	1526	-
	d	0836	-	0923	1026	1129	1226	1326	1426	1526	-
Blackburn	a	0844	-	0932	1033	1136	1233	1333	1433	1533	-
Preston	d	-	0839	-	-	-	-	-	-	-	1526
Blackburn	d	0844	0900	0939	1034	1137	1234	1334	1434	1534	1551
Ramsgreave & Wilpshire		0850	0906	0946	1040	1143	1240	1340	1440	1540	1557
Langho		0855	0911	0952	1045	1148	1245	1345	1445	1545	1601
Whalley		0859	0915	0956	1049	1152	1249	1349	1449	1549	1605
Clitheroe	a	0907	0921	1004	1057	1200	1257	1357	1457	1557	1612
	d	-	0924	-	-	-	-	-	-	-	1612
Hellifield	a	-	0947	-	-	-	-	-	-	-	1635

Sundays from 10 October

Manchester Victoria	d	1545	1645	1757	1845	1945	2112	2207	2314	-	-
Salford Central		1548	1648	1800	1848	1948	2115	2210	2317	-	-
Salford Crescent		1552	1652	1803	1852	1952	2119	2214	2321	-	-
Bolton		1604	1704	1819	1904	2004	2132	2226	2336	-	-
Hall I' Th' Wood		1609	1709	1824	1909	2009	2137	2231	2341	-	-
Bromley Cross		1613	1713	1827	1913	2013	2141	2235	2344	-	-
Entwistle		16x19	17x19	18x34	19x19	20x19	21x48	-	23x51	-	-
Darwen	a	1626	1726	1840	1926	2026	2154	2246	2357	-	-
	d	1626	1726	1841	1926	2026	2155	2246	2357	-	-
Blackburn	a	1633	1733	1848	1933	2033	2204	2254	0005	-	-
Preston	d	-	-	-	-	-	-	-	-	-	-
Blackburn	d	1634	1734	1849	1934	2034	2205	2254	-	-	-
Ramsgreave & Wilpshire		1640	1740	1855	1940	2040	2211	2300	-	-	-
Langho		1645	1745	1900	1945	2045	2216	2305	-	-	-
Whalley		1649	1749	1904	1949	2049	2220	2309	-	-	-
Clitheroe	a	1657	1757	1912	1957	2057	2228	2317	-	-	-
	d	-	-	-	-	-	-	-	-	-	-
Hellifield	a	-	-	-	-	-	-	-	-	-	-

Notes

x Stops on request.

C From Blackpool North.

Clitheroe - Blackburn - Manchester

Mondays to Saturdays from 4 October

		R SX	R SO	R	R	R	R	R	R	R	R	
Ramsgreave & Wilpshire	Clitheroe	d	-	-	0623	0647	0723	0823	0923	1023	1123	1223
	Whalley		-	-	0629	0653	0729	0829	0929	1029	1129	1229
	Langho		-	-	0634	0658	0734	0834	0934	1034	1134	1234
			-	-	0638	0702	0738	0838	0938	1038	1138	1238
	Blackburn	a	-	-	0647	0711	0747	0847	0947	1047	1147	1247
	Blackburn	d	0616	0616	0648	0713	0748	0848	0948	1048	1148	1248
	Darwen	a	0623	0623	0655	0725	0755	0855	0955	1055	1155	1255
		d	0627	0625	0656	0727	0756	0856	0956	1056	1156	1256
	Entwistle		06x34	06x32	07x03	07x34	08x03	09x03	10x03	11x03	12x03	13x03
	Bromley Cross		0640	0638	0709	0740	0809	0908	1009	1109	1209	1309
	Hall I' Th' Wood		0643	0641	0712	0743	0812	0911	1012	1112	1212	1312
	Bolton	a	0648	0646	0717	0748	0817	0916	1017	1117	1217	1317
	Salford Crescent	a	0701	0659	0732	0802	0832	0932	1032	1131	1232	1332
	Salford Central	a	0705	0702	0736	0805	0836	0935	1036	1134	1236	1336
	Manchester Victoria	a	0708	0707	0740	0808	0841	0941	1041	1138	1241	1341

Mondays to Saturdays from 4 October

			R	R	R	R	R	R	R	R	SX	
Ramsgreave & Wilpshire	Clitheroe	d	1323	1423	1523	1623	1723	1823	1908	2023	2123	2253
	Whalley		1329	1429	1529	1629	1729	1829	1914	2029	2129	2258
	Langho		1334	1434	1534	1634	1734	1834	1919	2034	2134	2303
			1338	1438	1538	1638	1738	1838	1923	2038	2138	2307
	Blackburn	a	1347	1447	1547	1647	1747	1847	1932	2047	2147	2317
	Blackburn	d	1348	1448	1548	1648	1748	1848	1946	2048	2148	2317
	Darwen	a	1355	1455	1555	1655	1756	1855	1953	2055	2155	2325
		d	1356	1456	1556	1656	1756	1856	1956	2056	2156	2325
	Entwistle		14x03	15x03	16x03	17x03	18x03	19x03	20x03	21x03	22x03	23x32
	Bromley Cross		1409	1509	1609	1709	1809	1909	2009	2109	2209	2338
Hall I' Th' Wood		1412	1512	1612	1712	1812	1912	2012	2112	2212	2340	
Bolton	a	1417	1517	1617	1717	1817	1917	2017	2117	2217	2345	
Salford Crescent	a	1432	1532	1632	1732	1832	1931	2031	2130	2232	2357	
Salford Central	a	1435	1537	1636	1736	1836	1935	2035	2133	2236	0001	
Manchester Victoria	a	1440	1540	1641	1740	1841	1940	2041	2136	2239	0005	

Mondays to Saturdays from 4 October

			SO									
	Clitheroe	d	2252	2339	-	-	-	-	-	-	-	-
	Whalley	-	2258	2345	-	-	-	-	-	-	-	-
	Langho	-	2303	2350	-	-	-	-	-	-	-	-
Ramsgreave & Wilpshire	-	-	2307	2354	-	-	-	-	-	-	-	-
Blackburn	a	-	2317	0001	-	-	-	-	-	-	-	-
Blackburn	d	-	2317	-	-	-	-	-	-	-	-	-
Darwen	a	-	2325	-	-	-	-	-	-	-	-	-
	d	-	2325	-	-	-	-	-	-	-	-	-
	Entwistle	-	23x32	-	-	-	-	-	-	-	-	-
	Bromley Cross	-	2338	-	-	-	-	-	-	-	-	-
	Hall I' Th' Wood	-	2340	-	-	-	-	-	-	-	-	-
	Bolton	a	2345	-	-	-	-	-	-	-	-	-
	Salford Crescent	a	2357	-	-	-	-	-	-	-	-	-
	Salford Central	a	-	-	-	-	-	-	-	-	-	-
	Manchester Victoria	a	0007	-	-	-	-	-	-	-	-	-

Notes

x Stops on request.

R To Rochdale.

SO Saturdays only.

SX Mondays to Fridays only.

Clitheroe - Blackburn - Manchester

Sundays from 10 October

Hellifield	d	-	-	-	1030	-	-	-	-	-	-
Clitheroe	a	-	-	-	1053	-	-	-	-	-	-
	d	-	0923	1023	1058	1123	1223	1323	1423	1523	1623
Whalley		-	0929	1029	1104	1129	1229	1329	1429	1529	1629
Langho		-	0934	1034	1109	1134	1234	1334	1434	1534	1634
Ramsgreave & Wilpshire		-	0938	1038	1114	1138	1238	1338	1438	1538	1638
Blackburn	a	-	0947	1047	1126	1147	1247	1347	1447	1547	1647
Preston	a	-	-	-	1157	-	-	-	-	-	-
Blackburn	d	0848	0948	1048	-	1148	1248	1348	1448	1548	1648
Darwen	a	0855	0955	1055	-	1155	1255	1355	1455	1555	1655
	d	0856	0956	1056	-	1156	1256	1356	1456	1556	1656
Entwistle		09x03	10x03	11x03	-	12x03	13x03	14x03	15x03	16x03	17x03
Bromley Cross		0909	1009	1109	-	1209	1309	1409	1509	1609	1709
Hall I' Th' Wood		0913	1012	1112	-	1212	1312	1412	1512	1612	1712
Bolton	a	0918	1017	1117	-	1217	1317	1417	1517	1617	1717
Salford Crescent	a	0932	1033	1132	-	1233	1332	1433	1533	1633	1733
Salford Central	a	0935	1036	1136	-	1236	1335	1436	1536	1636	1736
Manchester Victoria	a	0938	1039	1139	-	1239	1338	1439	1539	1639	1739

Sundays from 10 October

B

Hellifield	d	-	1734	-	-	-	-	-	-	-	-
Clitheroe	a	-	1755	-	-	-	-	-	-	-	-
	d	1719	1800	1823	1947	2023	2123	2243	-	-	-
Whalley		1725	1806	1829	1953	2029	2129	2249	-	-	-
Langho		1730	1811	1834	1958	2034	2134	2253	-	-	-
Ramsgreave & Wilpshire		1734	1816	1838	2002	2038	2138	2258	-	-	-
Blackburn	a	1743	1826	1847	2011	2047	2147	2307	-	-	-
Preston	a	-	1846	-	-	-	-	-	-	-	-
Blackburn	d	1744	-	1850	2017	2048	2148	2307	-	-	-
Darwen	a	1751	-	1857	2026	2055	2155	2315	-	-	-
	d	1752	-	1858	2027	2056	2156	2315	-	-	-
Entwistle		17x59	-	19x05	20x34	21x03	22x03	23x22	-	-	-
Bromley Cross		1805	-	1911	2040	2109	2209	2328	-	-	-
Hall I' Th' Wood		1808	-	1914	2043	2112	2212	2330	-	-	-
Bolton	a	1813	-	1919	2048	2117	2217	2335	-	-	-
Salford Crescent	a	1833	-	1933	2100	2133	2233	2348	-	-	-
Salford Central	a	1836	-	1936	2104	2136	2236	2351	-	-	-
Manchester Victoria	a	1839	-	1939	2107	2139	2239	2354	-	-	-

Notes

x Stops on request.

B To Blackpool North.

Useful contact details



Fares and service information

National Rail Enquiries
visit nationalrail.co.uk
call **03457 48 49 50**
textphone **0345 60 50 600**



Customer helpline

For comments and enquiries
visit northernrailway.co.uk/comments
call **0800 200 6060**



facebook [/northernassist](https://www.facebook.com/northernassist)



twitter [@northernassist](https://twitter.com/northernassist)



Access or disabled information and assistance

call **0800 138 5560**
email assistance@northernrailway.co.uk



Lost property

email lostproperty@northernrailway.co.uk
call **0800 200 6060**

Correspondence

Customer Experience Centre
Freepost NORTHERN RAILWAY



British Transport Police

call **0800 40 50 40** text **61016**

This timetable is also available online and you can download it to your mobile. This saves space in your pocket or bag, as well as paper and the planet! northernrailway.co.uk/timetables

All our policy documents can be found at
northernrailway.co.uk/legal

APPENDIX D – Census 2011 Car and Van Availability Data

LC4415EW - Accommodation type by car or van availability by number of usual residents aged 17 or over in household

ONS Crown Copyright Reserved [from Nomis on 12 October 2021]

population All households
units Persons
date 2011
accommodation type Flat, maisonette, apartment, caravan or other mobile or temporary structure
no of usual residents in household All categories: Number of usual residents aged 17 or over in household

Cars or Vans	E02002615 : Blackburn with Darwen 001	E02005277 : Ribble Valley 008	E02005276 : Ribble Valley 007	E02005214 : Hyndburn 003
All categories: Car or van availal	326	152	348	182
No cars or vans in household	177	27	67	116
1 car or van in household	137	89	213	58
2 or more cars or vans in housel	12	36	68	8

In order to protect against disclosure of personal information, records have been swapped between different geographic areas. Some counts will be affected, particularly small counts at the lowest geographies.