

SURVEY STATIONS			
Name	Easting	Northing	Height
N1	363031.776	441099.740	101.284
N2	363201.909	441110.460	103.436
N3	363257.216	441088.618	107.853
N4	363304.445	441044.151	111.773
N5	363357.893	441033.817	113.282
N6	363124.991	441103.263	103.242

- KEY**
- CHANNEL GENERAL
  - TOP OF KERB
  - BOTTOM OF BATTER
  - TOP OF BATTER
  - LEVEL STRING
  - FENCELINE
  - BUILDING
  - BT OVERHEADS
  - HEDGE LINE
  - TREE LINE
  - WALL
  - GATE
  - CATV SURFACE BOX
  - BT POLE
  - GULLY
  - HYDRANT
  - RIDGE HEIGHT
  - EAVES HEIGHT
  - SURVEY CONTROL
- 56.24 + ← spot level

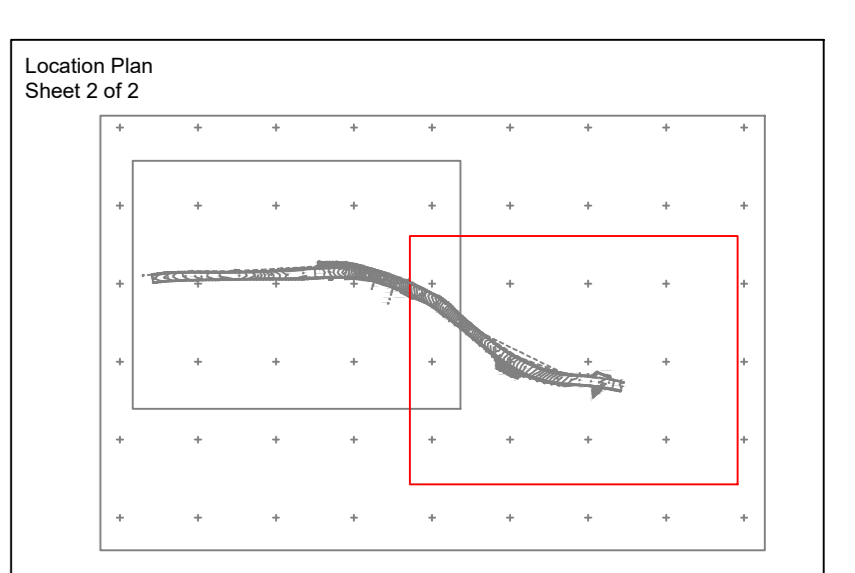
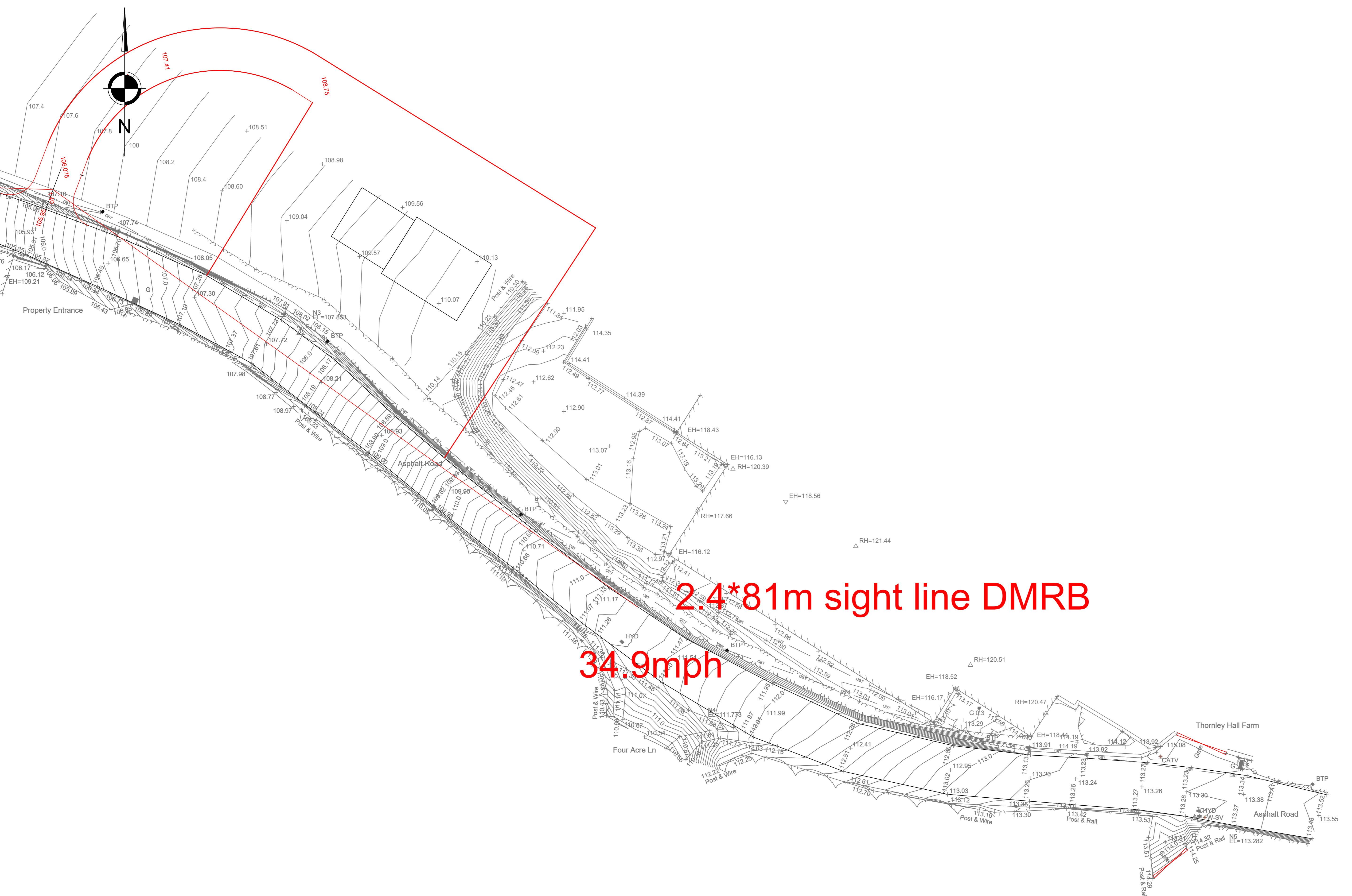

Client / Location: GHA  
 Thornton Hill Farm, Longridge, PR3 2TH  
 Drawing Title:  
 Access and sight lines  
 All work to our standard terms & conditions (see website)  
 Additional Comments:  
 To read grid based on OSGB36. Ground calculated scale factor applied around point NZ. Scale factor = 1.0000  
 Drawing Number: J1377 access sight lines fig 1  
 Drawn By: AJC  
 Checked By: AD  
 Date: 09/03/22  
 Scale: 1:200 @ A0  
 Sheet: 2 of 2