

Z:\projects\3651 Standen Estate, Clitheroe (Phases 5 & 6)\CAD\Croft Drawings\3651-F02\_Rev E (Visibility Phase 5).dwg

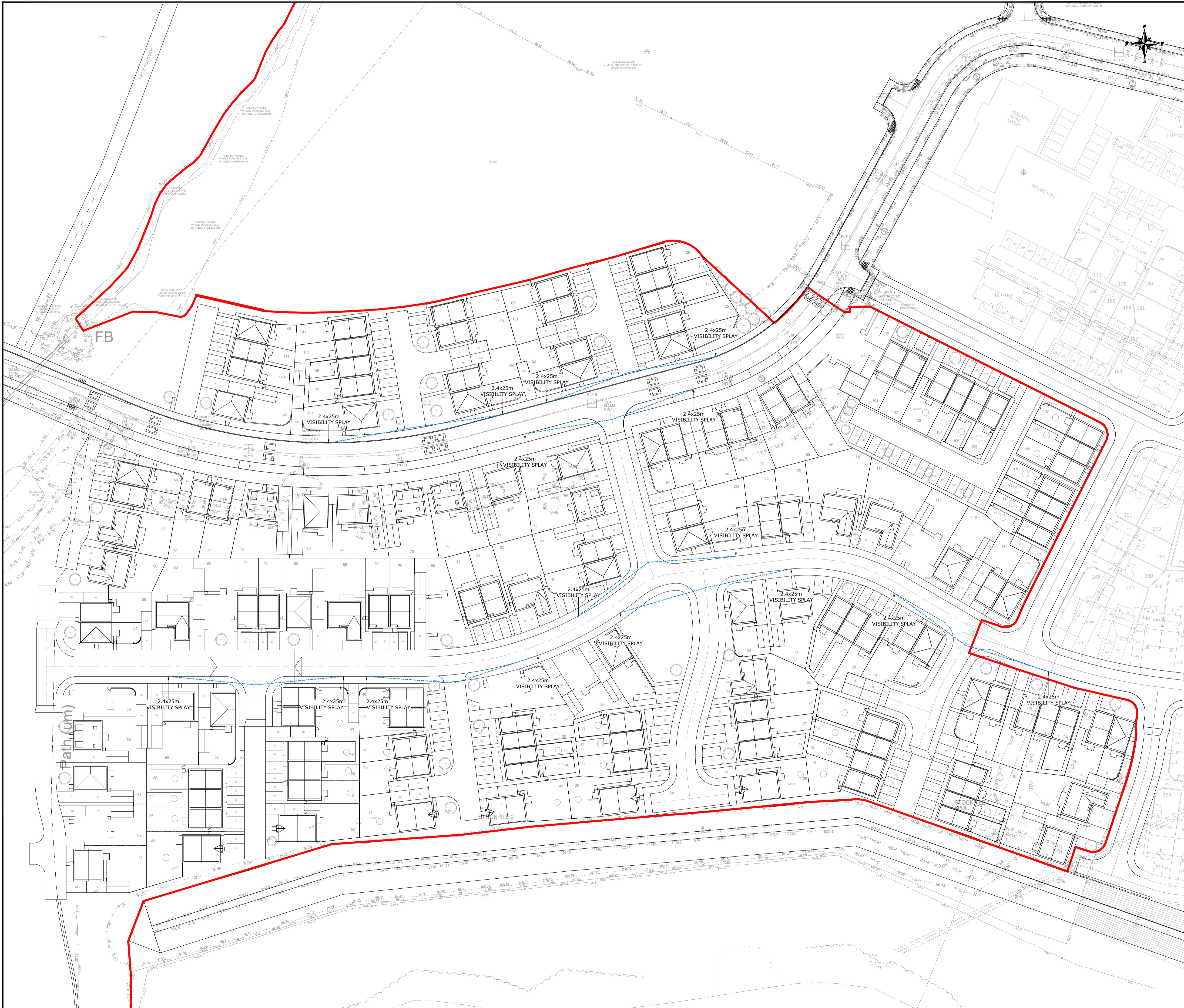

**NOTES**

THIS IS NOT A CONSTRUCTION DRAWING AND IS FOR INDICATIVE PURPOSES ONLY. THE DRAWING WILL BE SUBJECT TO CHANGE FOLLOWING LOCAL AUTHORITY REVIEW AND CONFIRMATION OF PUBLIC HIGHWAY AND THIRD PARTY LAND BOUNDARIES.

— INDICATIVE SITE BOUNDARY  
 - - - 2.4 x 25m VISIBILITY SPLAY

REV	DESCRIPTION	SL	TB	DATE
B	SITE LAYOUT & VISIBILITY UPDATED	SL	TB	SEP 2025
D	SITE LAYOUT & VISIBILITY UPDATED	SL	TB	MAR 2025
C	SITE LAYOUT & VISIBILITY UPDATED	SL	TB	DEC 2024

CLIENT: **TAYLOR WIMPEY**

PROJECT: **STANDEN ESTATE, CLITHEROE**

DRAWING TITLE: **VISIBILITY PLAN PHASE 5**

SCALES: **1:500 @ A1**

DRAWN: HZ      CHECKED: TB      DATE: DEC 2024

Eddisons  
 340 Deansgate  
 Manchester  
 M3 4LY  
 Email: info@crofts.co.uk  
 Tel: 0161 837 7380  
 Web: www.eddisons.com/services/transport-planning

DRAWING NUMBER: **3651-F02**      REVISION: **E**

**Eddisons**