

Z:\projects\3651 Standen Estate, Clitheroe (Phases 5 & 6)\CAD\Croft Drawings\3651-F06 Rev A (Driveway Visibility Phase 5).dwg

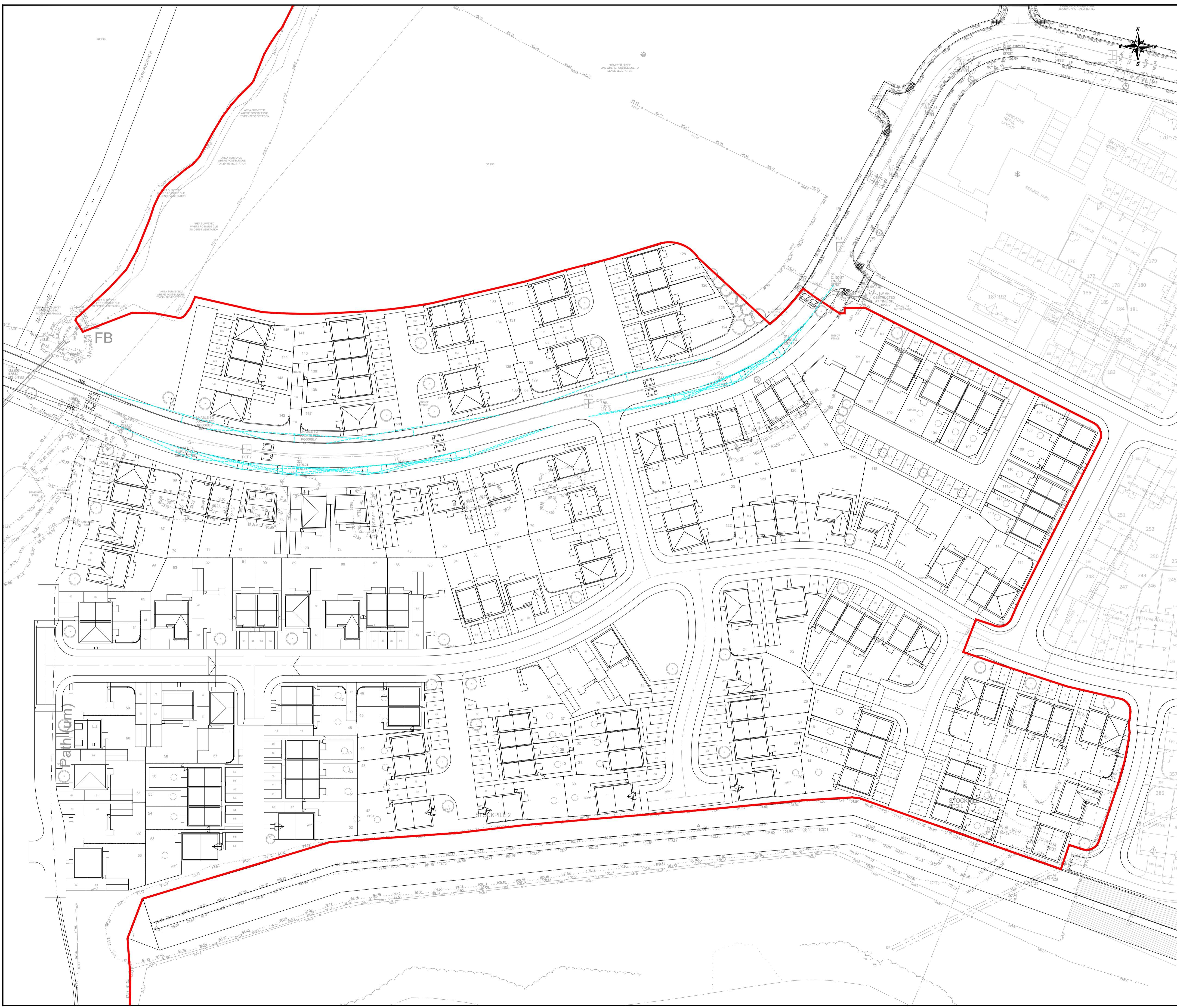

NOTES

THIS IS NOT A CONSTRUCTION DRAWING AND IS FOR INDICATIVE PURPOSES ONLY. THE DRAWING WILL BE SUBJECT TO CHANGE FOLLOWING LOCAL AUTHORITY REVIEW AND CONFIRMATION OF PUBLIC HIGHWAY AND THIRD PARTY LAND BOUNDARIES.

- INDICATIVE SITE BOUNDARY
- - - 2.4 x 25m VISIBILITY SPLAY FOR DRIVEWAYS

A	PROPOSED SITE LAYOUT UPDATED	SL	TB	SEP 2025
REV	DETAILS	DRAWN	CHECKED	DATE

CLIENT: **TAYLOR WIMPEY**

PROJECT: **STANDEN ESTATE, CLITHEROE**

DRAWING TITLE: **DRIVEWAY VISIBILITY PLAN
PHASE 5**

SCALE: **1:500 @ A1**

DRAWN: SL	CHECKED: TB	DATE: JUL 2025
-----------	-------------	----------------

Eddisons
340 Deansgate
Manchester
M3 4LY

Email: info@crofts.co.uk
Tel: 0161 837 7380
Web: www.eddisons.com/services/transport-planning

DRAWING NUMBER: 3651-F06	REVISION: A
---------------------------------	--------------------

