

Z:\projects\3651 Stander Estate, Clitheroe (Phases 5 & 6)\CAD\Croft Drawings\3651-SP01 Rev D (Refuse Vehicle Tracking Phase 6).dwg

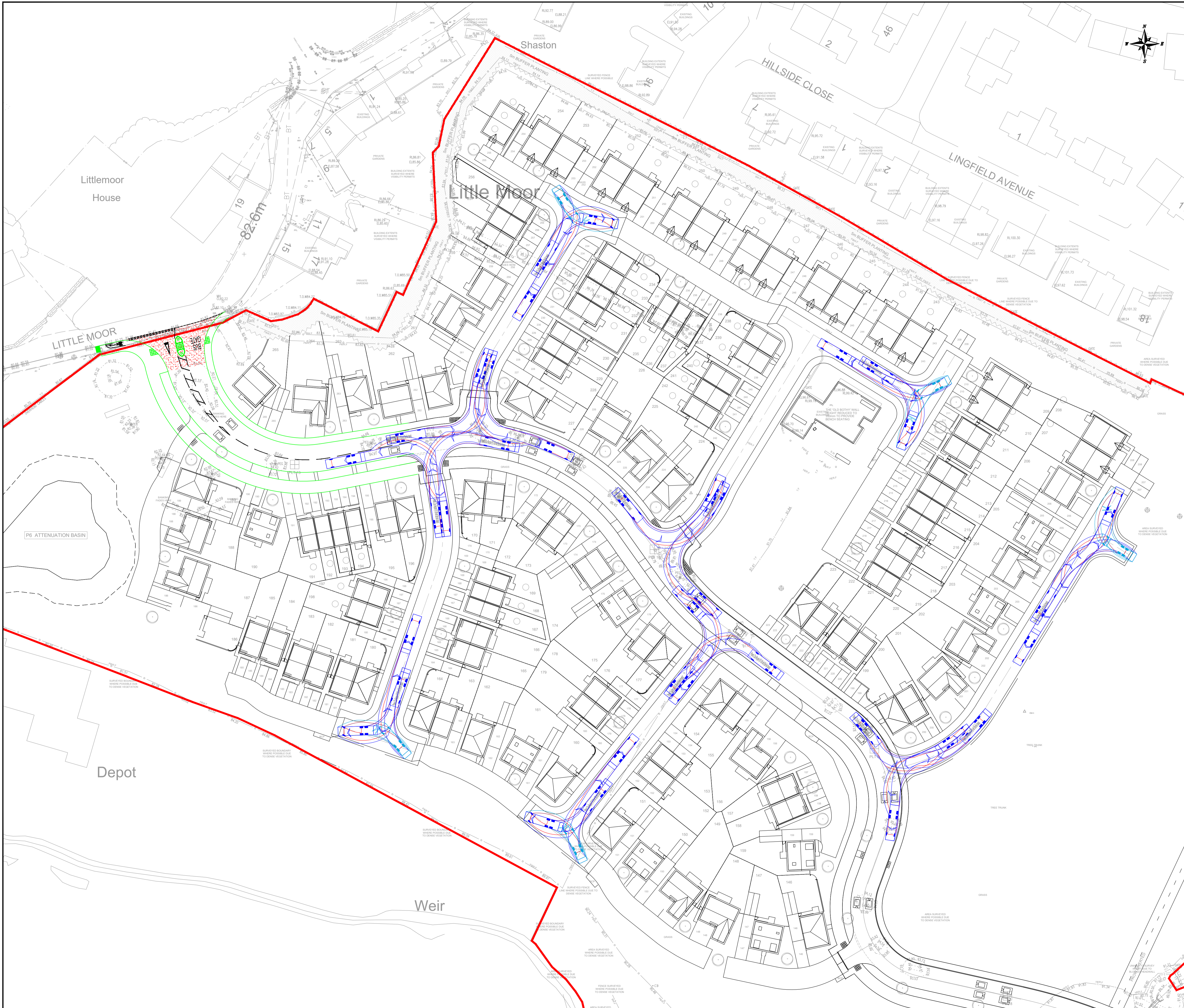

### NOTES

THIS IS NOT A CONSTRUCTION DRAWING AND IS FOR INDICATIVE PURPOSES ONLY. THE DRAWING WILL BE SUBJECT TO CHANGE FOLLOWING LOCAL AUTHORITY REVIEW AND CONFIRMATION OF PUBLIC HIGHWAY AND THIRD PARTY LAND BOUNDARIES.

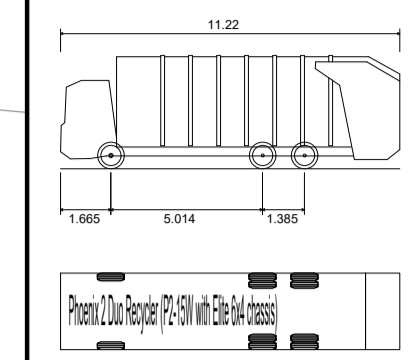

Phoenix 2 Duo Recycler (P2-15W with Elite 6x4 chassis)  
Overall Length 11.220m  
Overall Width 2.530m  
Overall Body Height 3.750m  
Min Body Ground Clearance 0.909m  
Track Width 2.530m  
Lock to lock time 4.00s  
Kerb to Kerb Turning Radius 11.550m

D	SITE LAYOUT & TRACKING UPDATED	SL	TB	SEP 2025
C	SITE LAYOUT UPDATED	SL	TB	MAR 2025
B	SITE LAYOUT UPDATED	SL	TB	DEC 2024
A	SITE LAYOUT & TRACKING UPDATED	SL	TB	AUG 2024
REV	DETAILS	DRAWN	CHECKED	DATE

CLIENT:  
**TAYLOR WIMPEY**

PROJECT:  
**STANDEN ESTATE, CLITHEROE**

DRAWING TITLE:  
**PROPOSED SITE LAYOUT,  
REFUSE VEHICLE TRACKING,  
PHASE 6**

SCALES:  
**1:500 @ A1**

DRAWN:	SL	CHECKED:	PW	DATE:	JUL 2024
--------	----	----------	----	-------	----------

Eddisons  
340 Deansgate  
Manchester  
M3 4LY  
Email: [info@crofts.co.uk](mailto:info@crofts.co.uk)  
Tel: 0161 837 7380  
Web: [www.eddisons.com/services/transport-planning](http://www.eddisons.com/services/transport-planning)

DRAWING NUMBER:	3651-SP01	REVISION:	D
-----------------	-----------	-----------	---

