

This drawing is subject to copyright and is not to be reproduced in part or whole without approval. Do not scale this drawing - check all dimensions on site.

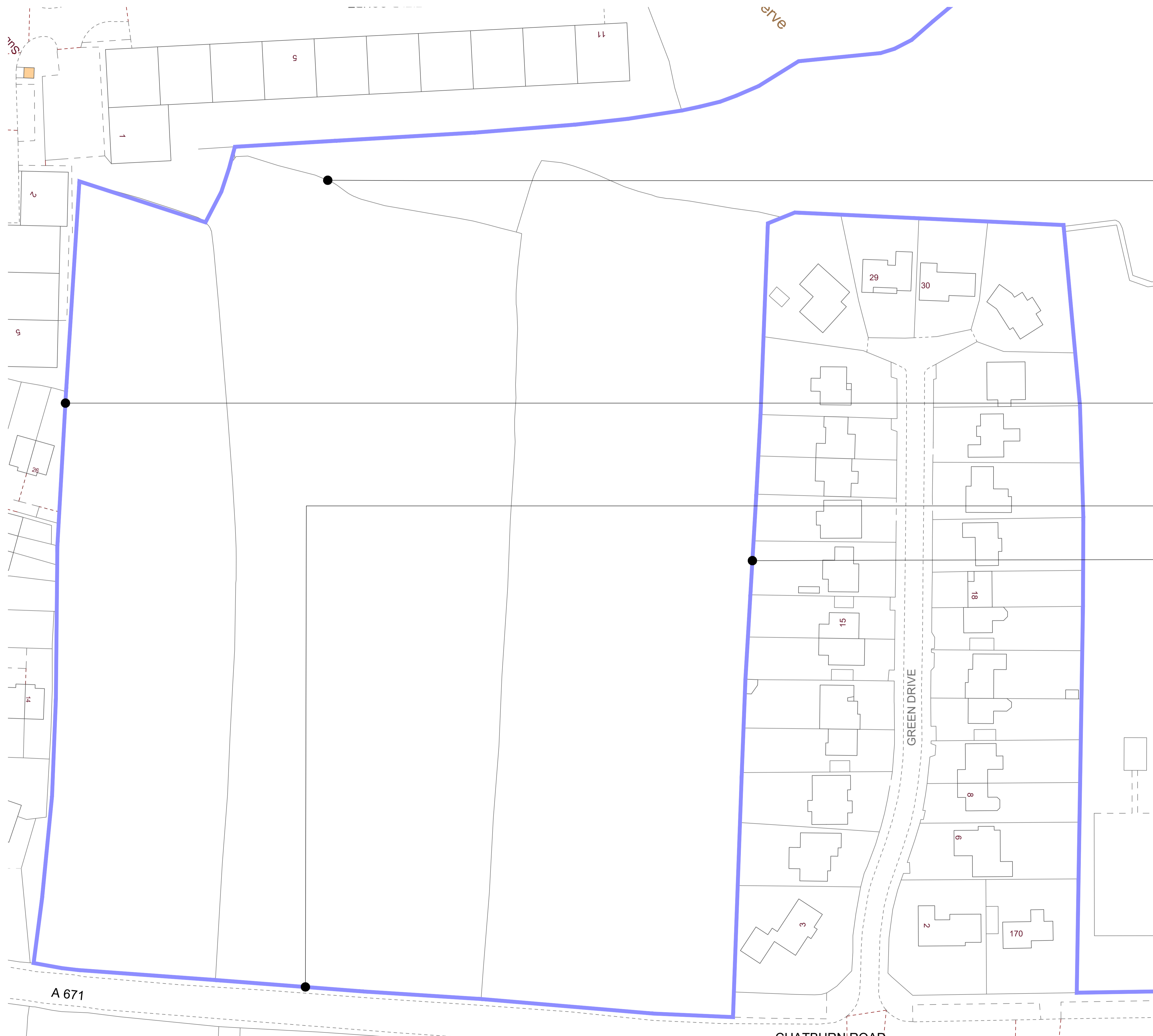
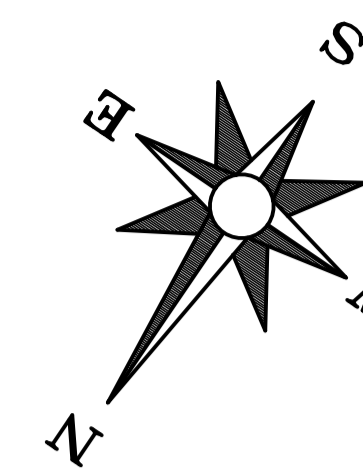

Existing shrubbery and trees noted to rear of site.

Existing low level wired fencing noted, circa 1.2m in height which straddles the boundary between the school grounds and the neighboring gardens. Noted to provide minor security measure to the side of school.

3No. Existing farm style gate and low level transparent timber picket fence offering inadequate security protection from vandals and trespassers alike.

Existing low level fencing noted, circa 1.2m in height which straddles the boundary between the school grounds and the neighboring gardens. Noted to provide adequate security measure to the side of school.

Client			
The School Governors C/O CRGS			
CRGS, Chatburn Rd, Clitheroe, Lancashire, BB7 2BA			
Project			
CIF BID 2021-22			
CRGS, Chatburn Rd, Clitheroe, Lancashire, BB7 2BA			
Drawing Title			
EXISTING SITE PLAN OVERVIEW - CHATBURN ROAD SITE			
URGENT SAFEGUARDING MEASURES			
Drawn by	JW	Checked by	NS Date Mar 2022
Status	PLANNING	Scale @ A1	1:500
Job no.	P2830	Dwg. no.	L02 Rev. P1
Cassidy+Ashton			C+A
www.cassidyashton.co.uk			
Architecture + Building Surveying + Town Planning			
7 East Cliff, Preston, Lancashire, PR1 3JE 01772 268 356			
10 Hunters Walk, Canal Street, Chester, CH1 4EB 01244 402 900			