

Flat 1 size

Sketchool

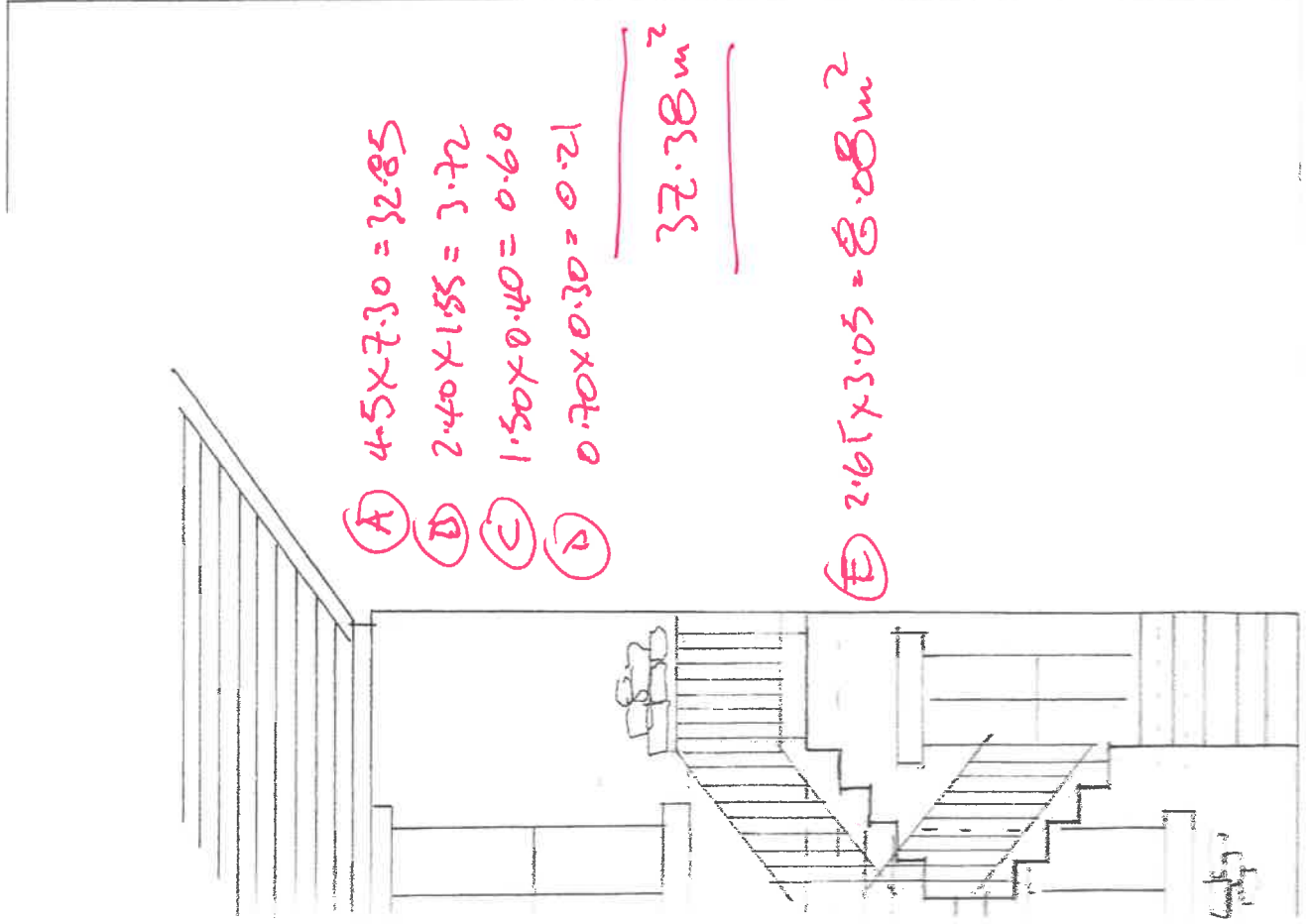

- (A) $4.5 \times 7.30 = 32.85$
- (B) $2.40 \times 1.55 = 3.72$
- (C) $1.50 \times 0.40 = 0.60$
- (D) $0.70 \times 0.30 = 0.21$

37.38 m^2

(E) $2.65 \times 3.05 = 8.08 \text{ m}^2$

