

Kirk House

Kirk

0.91m  
F Cam

**GENERAL NOTES**

1. DRAWINGS ARE TO BE READ IN CONJUNCTION WITH ALL RELEVANT SPECIFICATIONS, ENGINEERS, ARCHITECTS & SERVICES DRAWINGS, INCLUDING APPROVED BUILDERS WORK DRAWINGS. CONTRACTOR TO NOTIFY ENGINEER OF DISCREPANCIES BETWEEN STRUCTURAL DRAWINGS AND SPECIFICATIONS OR OTHER DRAWINGS.
2. ALL DIMENSIONS ARE IN MILLIMETRES UNLESS NOTED OTHERWISE.
3. DO NOT SCALE FROM THIS DRAWING. WORK TO DIMENSIONS OR CO-ORDINATES PROVIDED. ALL LEVELS ARE IN METRES AND ALL DIMENSIONS ARE IN MILLIMETRES, UNLESS OTHERWISE NOTED. ANY AMBIGUITIES, OMISSIONS AND ERRORS ON DRAWINGS, SHALL BE BROUGHT TO THE ENGINEERS ATTENTION IMMEDIATELY.
4. INFORMATION CONTAINED ON THIS DRAWING IS SCHEME DESIGN ONLY AND REQUIRES FURTHER DETAILED DESIGN AND CO-ORDINATION WITH THE CONTRACTOR, DESIGN TEAM AND APPROPRIATE SUB-CONTRACTORS.

**KEY**

- SITE BOUNDARY
- EXISTING OPEN WATERCOURSE
- EXISTING 900MM Ø CULVERTED WATERCOURSE
- EXISTING FOUL WATER DRAINAGE RUN
- PROPOSED SURFACE WATER DRAINAGE RUN
- LAND DRAIN TO DISCHARGE INTO NEW CULVERT SECTION
- PROPOSED FOUL WATER DRAINAGE RUN
- EXISTING FOUL WATER MANHOLE
- PROPOSED SURFACE WATER MANHOLE
- PROPOSED FOUL WATER MANHOLE
- NEW CULVERT & HEADWALL TO EXISTING WATERCOURSE 1200MM Ø ON TWINWALL PIPE WITH STONE PITCHING TO FORM HEADWALL

**SURFACE WATER DRAINAGE**

CONSIDERATION HAS BEEN GIVEN TO THE HIERARCHY OF DRAINAGE OPTIONS FOR THE SITE AS FOLLOWS:

1. DISCHARGE INTO GROUND - GROUND CONDITIONS INDICATE STRATA TO BE UNSUITABLE.
2. DISCHARGE TO SURFACE WATER BODY - SURFACE WATER WILL DISCHARGE TO WATERCOURSE NORTH OF THE SITE.
3. DISCHARGE TO SURFACE WATER SEWER, HIGHWAY DRAIN OR OTHER DRAINAGE SYSTEM - CONNECTION TO WATERCOURSE IS THE PREFERRED OPTION.

THE PROPOSAL AT THIS TIME IS TO DISCHARGE SURFACE WATER FROM THE DEVELOPMENT INTO THE WATERCOURSE NORTH OF THE SITE AS SHOWN, AT A RATE RESTRICTED TO THE GREENFIELD RUN OFF RATE OF SITS.

**FOUL WATER DRAINAGE**

FOUL WATER GENERATED BY THE SITE WILL DISCHARGE INTO THE EXISTING COMBINED WATER SEWER TO THE NORTH OF THE SITE.

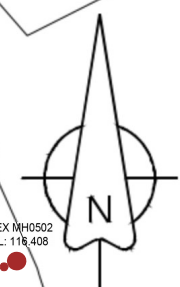

Rev.D	Amended following comments by Planning Officer.	28.12.2022	SDH
Rev.C	Amended in accordance with LCC Highways comments.	26.08.2022	SDH
Rev.B	TPO tree's north of site boundary indicated.	14.08.2022	SDH
Rev.A	Updated to suit tree survey.	23.07.2022	SDH



PROJECT				
Proposed Residential Development at Church Rake, Chipping.				
DRAWING TITLE				
Drainage Strategy.				
DATE	SCALE	DRAWN	DRWG No.	REV
May 2022	1:250 @ A1	SAH	DS/GA01	C