

Kirk House

Kirk

0.91m
F Cam

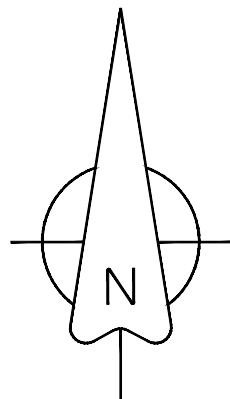

- KEY:
- Compound
 - Haul Road
 - Storage Area
 - Pedestrian Route
 - Perimeter Fencing
 - Build Route
 - First Aid point
 - Main Health & Safety Signage
 - Fire assembly point
 - Fire Equipment
 - Wheel Wash
 - Contractors Parking
 - Fill Material & Topsoil Stockpiles

NOTES

ALL VISITORS, CONTRACTORS & DRIVERS TO REPORT TO SITE OFFICE FOR INDUCTION/ SIGN IN BEFORE ENTERING SITE.

ADDITIONAL SIGNAGE TO BE PROVIDED AS REQUIRED TO INDICATE ROAD SPEEDS & ADDITIONAL SAFETY INFORMATION.

NO REVERSING WITHOUT THE AID OF A BANKSMAN.

SITE SPEED LIMIT 5MPH

FIRE EXTINGUISHERS IN SITE COMPOUND, SITE OFFICE & CANTEEN.

FIRST AID AND WELFARE AVAILABLE IN MAIN COMPOUND AREA.

CONSTRUCTION HOURS: MON-FRI 07:30AM - 18:00PM ; SAT 08:00AM - 13:00PM.

The Grove

Malt Kiln House

MALT KILN BROW

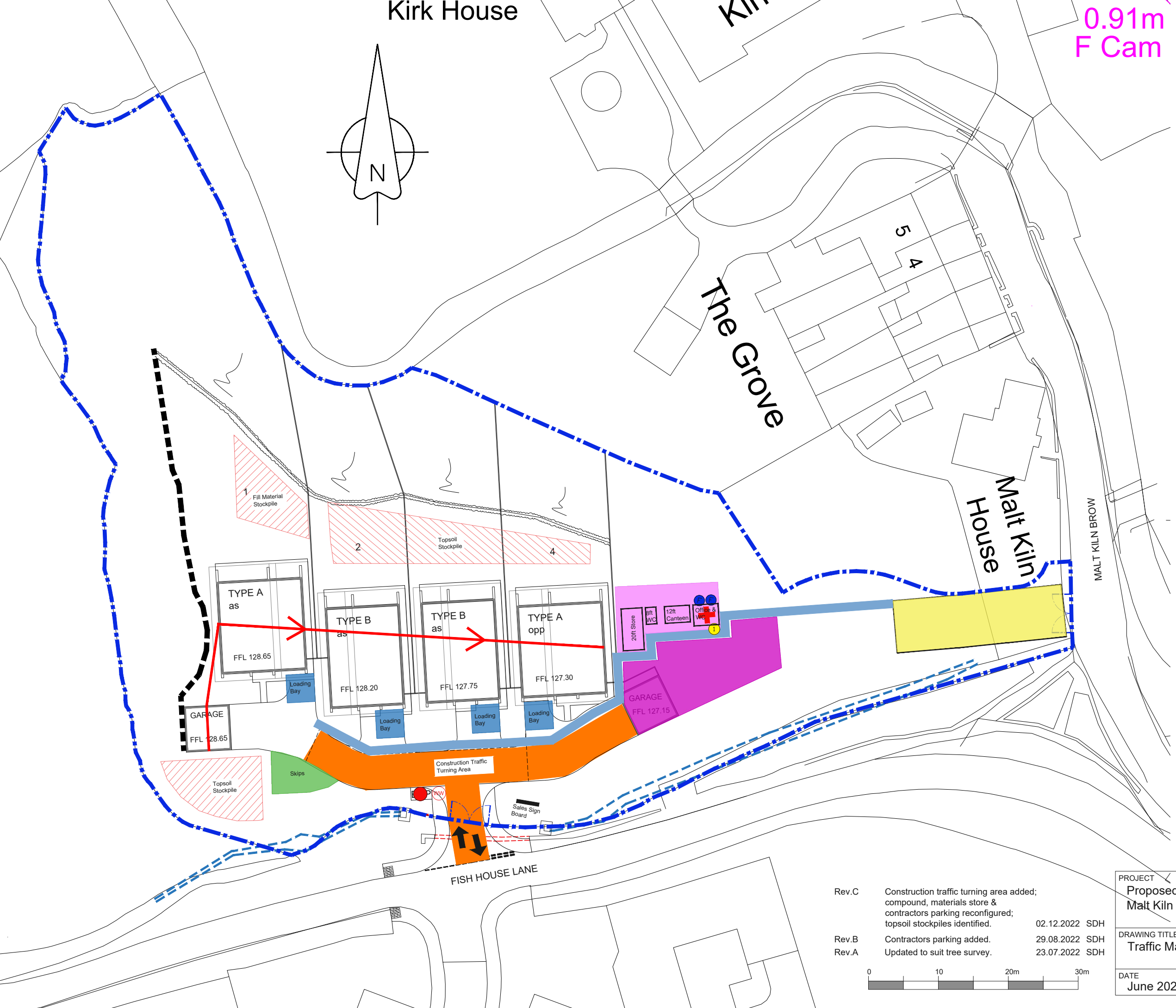

- Rev.C Construction traffic turning area added; compound, materials store & contractors parking reconfigured; topsoil stockpiles identified. 02.12.2022 SDH
- Rev.B Contractors parking added. 29.08.2022 SDH
- Rev.A Updated to suit tree survey. 23.07.2022 SDH



PROJECT				
Proposed Residential Development at Malt Kiln Brow, Chipping.				
DRAWING TITLE				
Traffic Management Plan.				
DATE	SCALE	DRAWN	DRWG No.	REV
June 2022	1:500 @ A3	SDH	MKB/P03	C