

**KEY**

-  Application site boundary
-  Existing trees to be retained & associated root protection area
-  Tree protection fencing - design as per figure 1 & 2

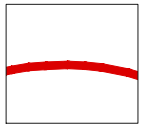
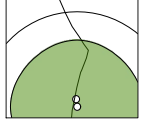
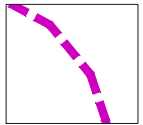
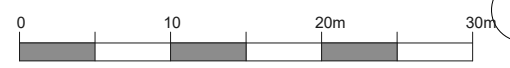
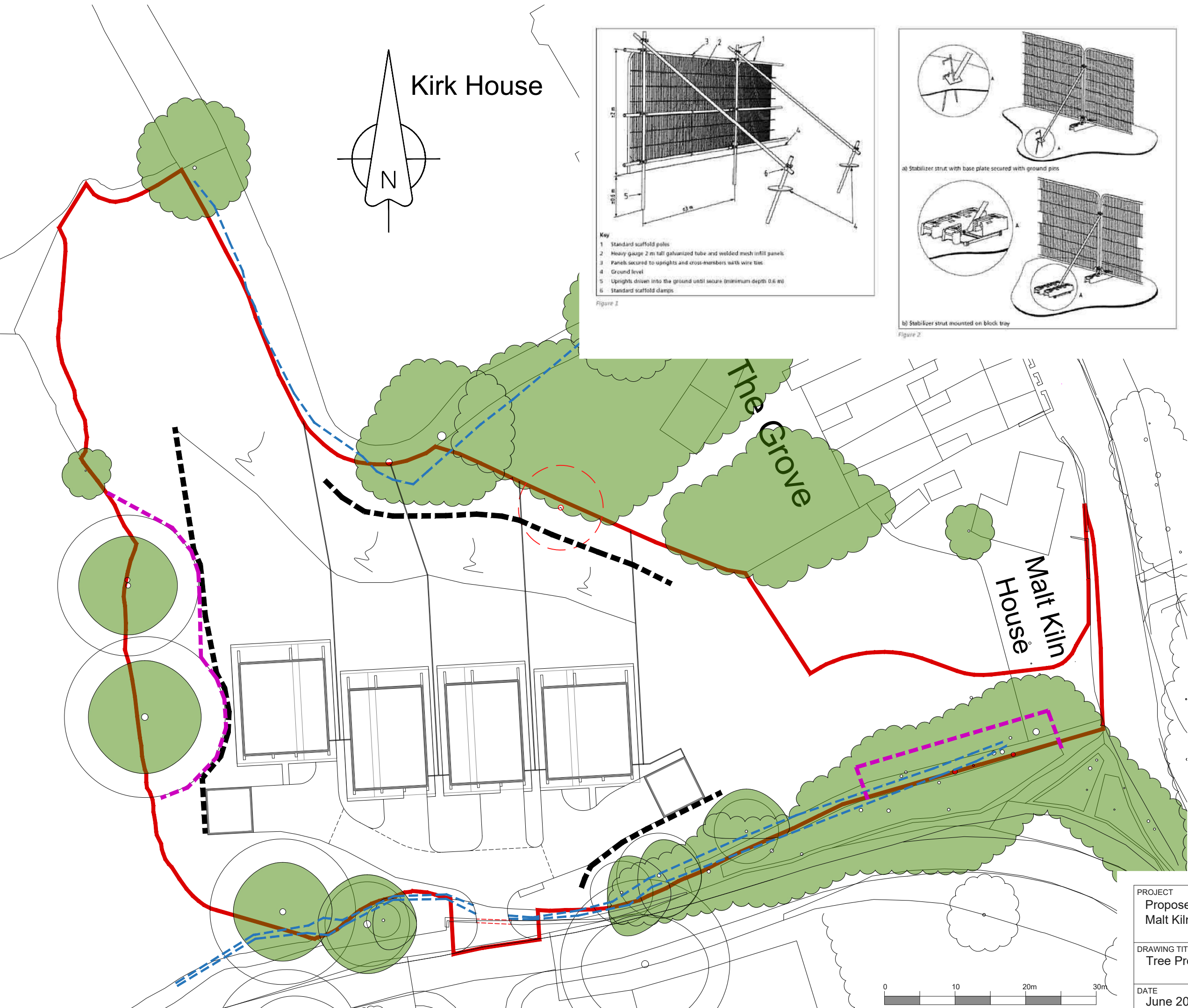

PROJECT Proposed Residential Development at Malt Kiln Brow, Chipping.				
DRAWING TITLE Tree Protection Plan.				
DATE June 2022	SCALE 1:500 @ A3	DRAWN SDH	DRWG No. MKB/P04	REV