

Site Area -
3930m² (0.39 hectares)

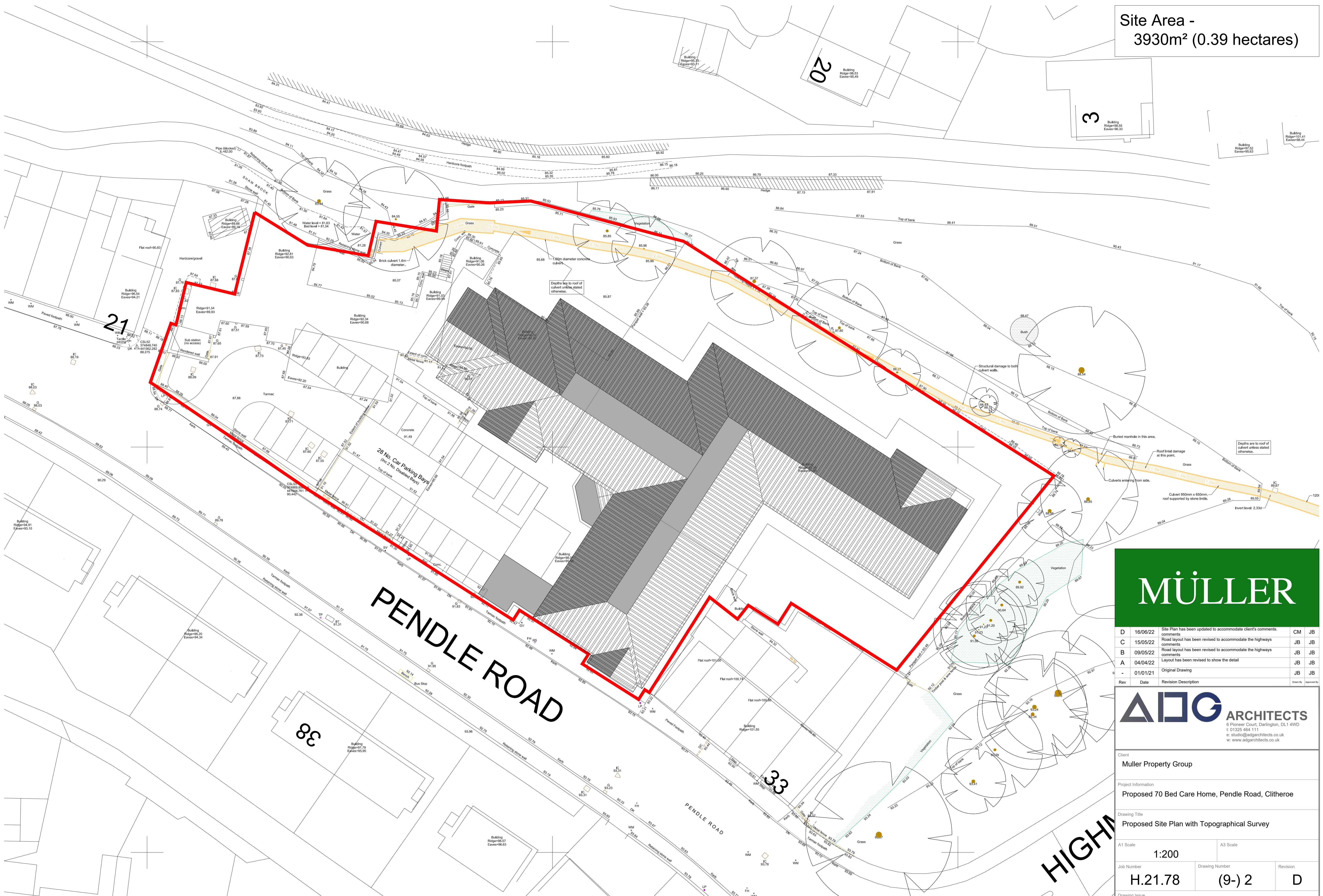

D	16/06/22	Site Plan has been updated to accommodate client's comments	CM	JB
C	15/05/22	Road layout has been revised to accommodate the highways comments	JB	JB
B	09/05/22	Road layout has been revised to accommodate the highways comments	JB	JB
A	04/04/22	Layout has been revised to show the detail	JB	JB
-	01/01/21	Original Drawing	JB	JB
Rev	Date	Revision Description	Drawn By	Approved By

ADG ARCHITECTS
 6 Pioneer Court, Darlington, DL1 4WD
 t: 01325 464 111
 e: studio@adgarchitects.co.uk
 w: www.adgarchitects.co.uk

Client
Muller Property Group

Project Information
Proposed 70 Bed Care Home, Pindle Road, Clitheroe

Drawing Title
Proposed Site Plan with Topographical Survey

A1 Scale: 1:200 A3 Scale

Job Number: H.21.78 Drawing Number: (9)- 2 Revision: D

Drawing Issue: **PLANNING**

FOR ILLUSTRATIVE PURPOSES ONLY