

This drawing is the property of SPa and is not to be reproduced, stored in a retrieval system, or transmitted in any form or by any means, electronic, mechanical, photocopying, recording, or by any information storage and retrieval system, without the prior written permission of SPa. SPa is not responsible for any errors or omissions in this drawing and shall not be liable for any damages, including consequential damages, arising from the use of this drawing. The user of this drawing is advised to verify all information and details shown on this drawing with the relevant authorities and to ensure that all necessary permits and approvals are obtained before commencing any work.

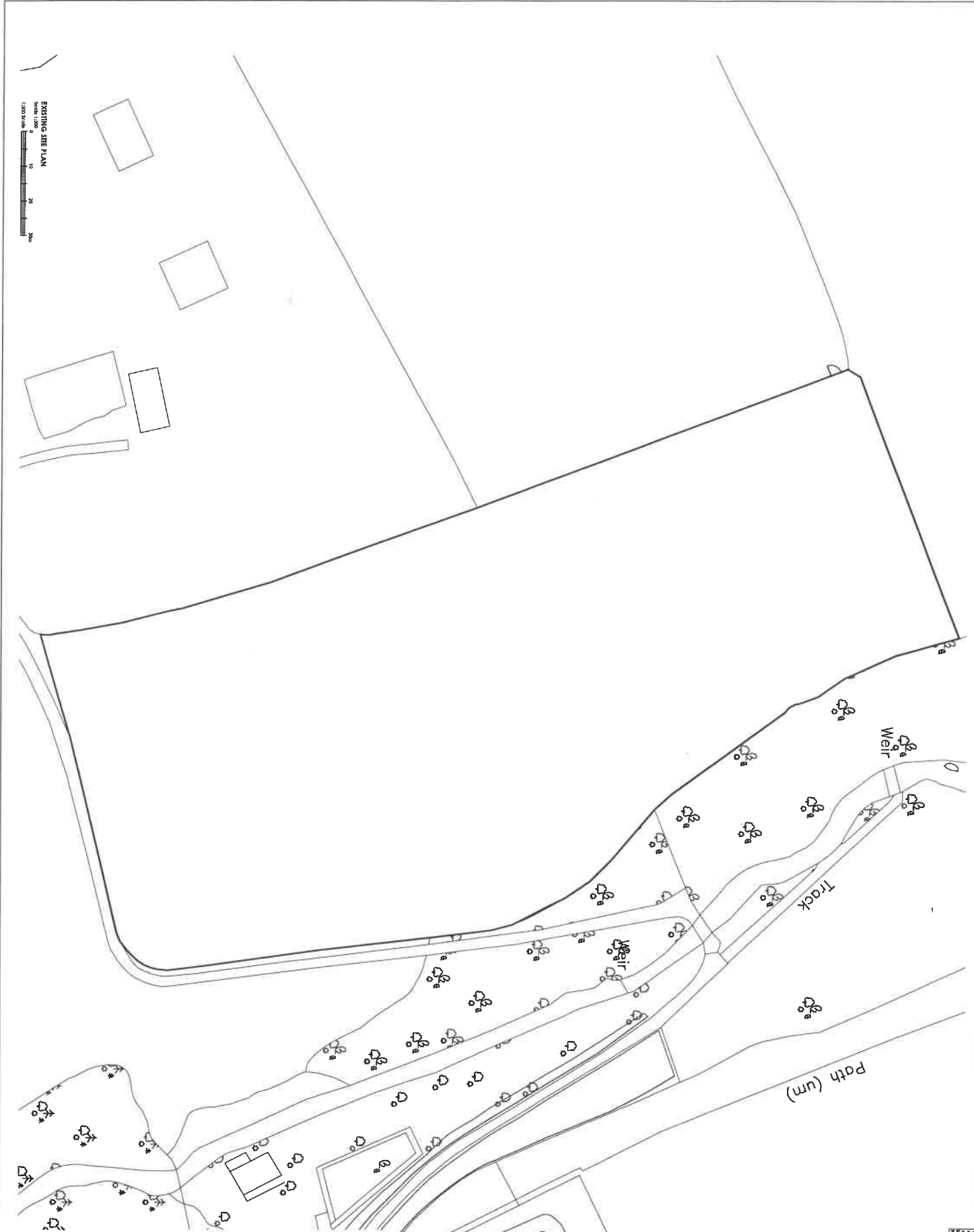
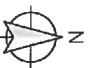

<p>Project Name: Mt Senn Midon Proposed Agricultural Building Salsburgh Road</p>	
<p>Client: TDS</p>	
<p>Site: 1500 @ A1</p>	
<p>Date: 14th July 2022</p>	
<p>Scale: 1:500</p>	
<p>Drawing No: EXISTING SITE PLAN</p>	
<p>SPa SAUNDERSLAND READING ARCHITECTS</p>	
<p>6707-001</p>	