

THIS DRAWING IS THE PROPERTY OF IVAN WILSON ARCHITECT. COPYRIGHT IS RESERVED BY THEM AND THE DRAWING IS ISSUED ON CONDITION THAT IT IS NOT COPIED EITHER WHOLLY OR IN PART WITHOUT THE CONSENT IN WRITING OF IVAN WILSON ARCHITECT.

DIMENSIONS SHOULD NOT BE SCALED. ALL DIMENSIONS TO BE CHECKED ON SITE BY THE CONTRACTOR BEFORE COMMENCEMENT OF THE RELEVANT PART OF THE WORK.

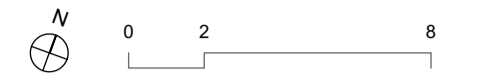

- Existing Boundary
- Residential Curtilage
- Proposed Boundary

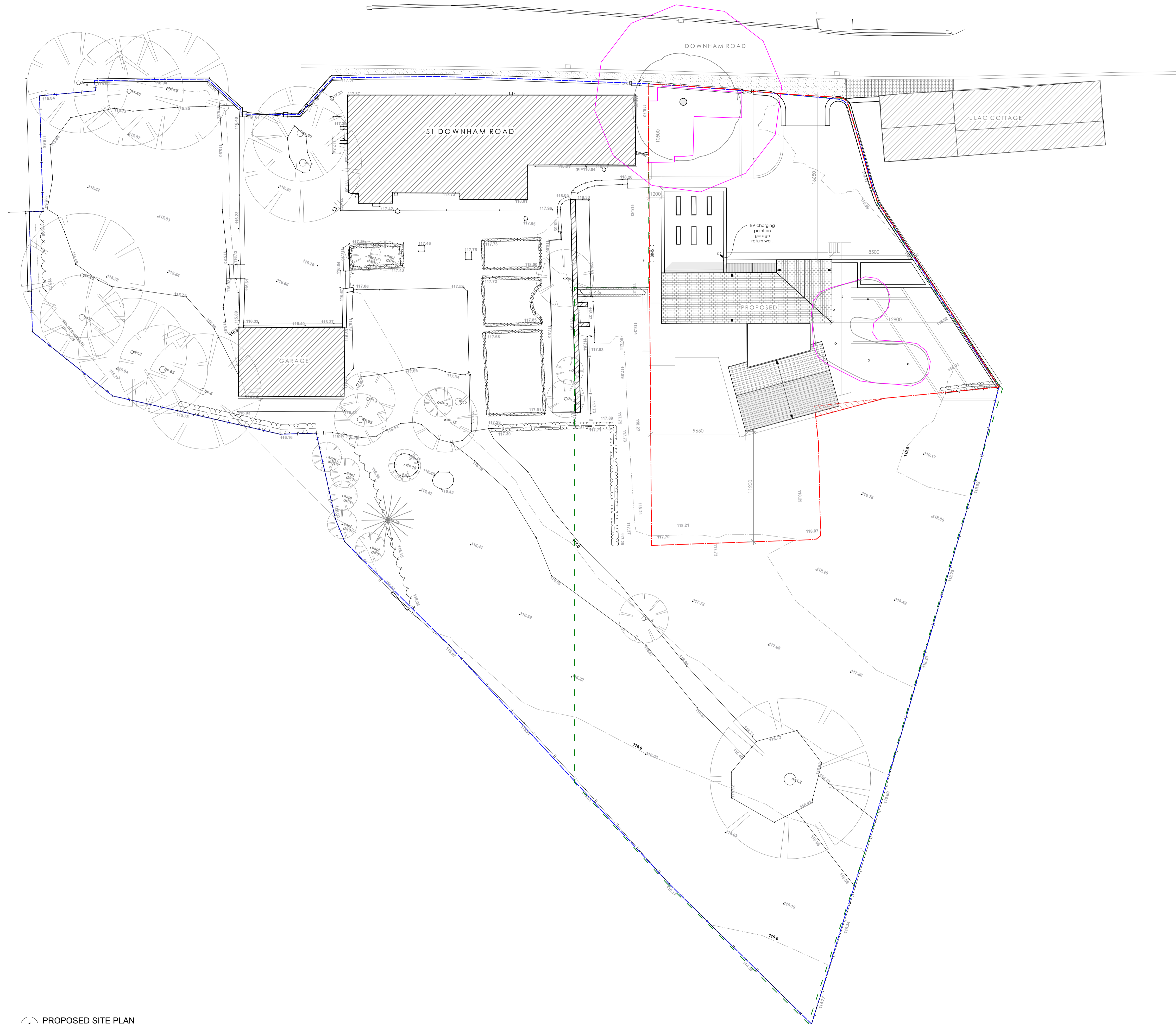

**1** PROPOSED SITE PLAN  
Scale: 1:200

Drawing No. A200      Revision D  
51 Downham Road  
Date 30 Nov 2022      Drawn By      Check

Ivan Wilson Architect

e: [ivanwilsonarchitect@gmail.com](mailto:ivanwilsonarchitect@gmail.com)  
t: 0734 489902