

Accrington Rd, Whalley

Construction Method Statement

i. The Parking of vehicles of site operatives & visitors

- This will be within the site compound area, no parking for site vehicles will be allowed on the existing surrounding estates

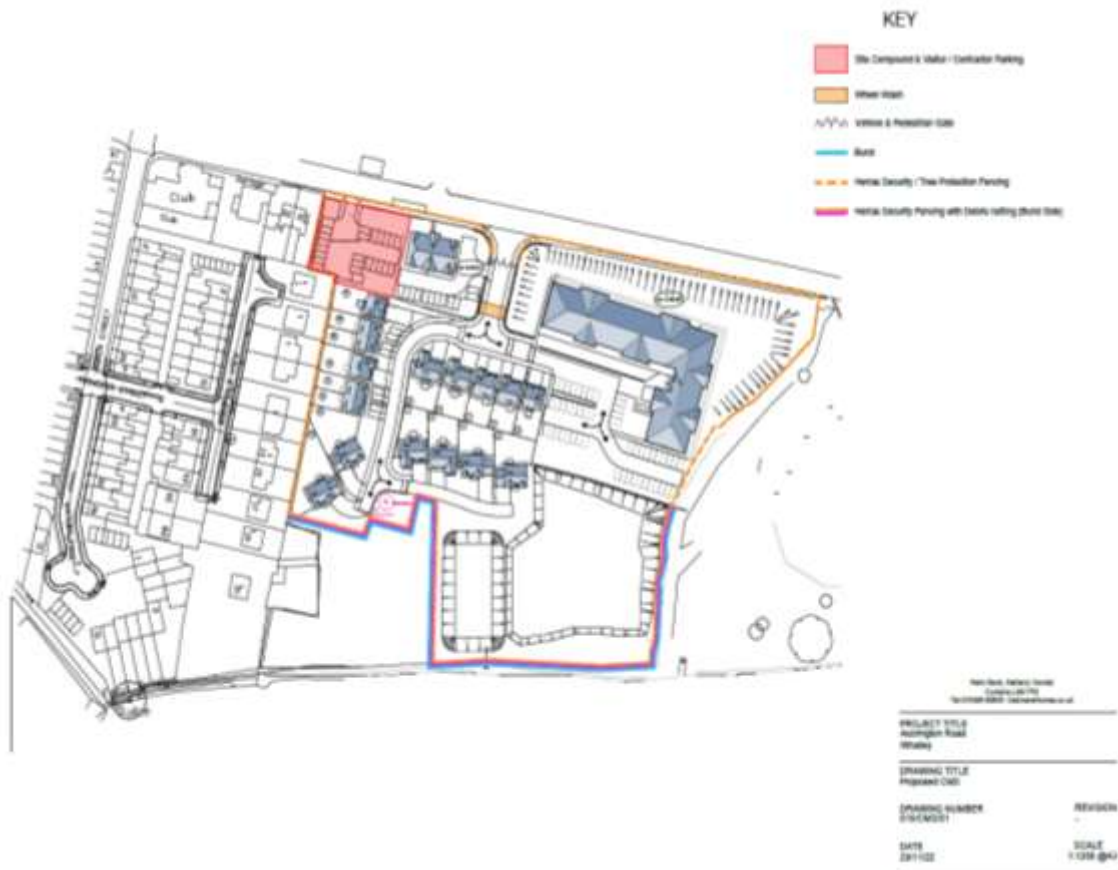

ii. Loading & unloading of plant & materials

- All sub-contract and purchase orders will contain the site 'Traffic Management Strategy' to ensure that they are aware of the restrictions when delivering plant or materials to the site.
- All wagons should be rigid where possible, any delivery requiring Articulated wagons should be discussed prior with Oakmere Homes Site Manager
- All wagons will be loaded & unloaded into the material compound or where directed by the Site Manager within the confines of the site boundary shown on the attached site layout
- No materials will be stored, loaded or unloaded outside of the site boundary

iii. Storage of plant & materials used in constructing the development

- This will be within the material storage compound shown on the attached site layout

iv. The erection & maintenance of security hoarding including decorative displays and facilities for public viewing

- The site will be fenced off using 'heras' fencing, this fencing has been selected for low visual impact with good visibility whilst maintaining segregation and security shown on the attached site layout

v. Wheel washing facilities

- Will be undertaken using a pressure washer adjacent to the site entrance prior to vehicles leaving site shown on the attached site layout

vi. Measures to control the emission of dust & dirt during construction

The following measures will be undertaken on this scheme to minimise dust/dirt production and dispersion.

- Soil Handling and storage

To be carried out as quickly and efficiently as possible and storage mound surfaces will be sealed and seeded as soon as possible.

Protect soil from the wind by choosing suitable storage location (i.e voids) or use natural topographical features or barriers to limit exposure.

- Site access road

All active haul roads will be kept damp

Road vehicles will be prevented from using untreated on-site roads

Speeds of on-site vehicles will be restricted according to site conditions nominally 5mph

Internal un-surfaced roads will be well maintained and compacted, to minimize spillage from vehicles and dust emissions from loose and uneven surfaces

- Deliveries / Loading

Minimise drop height for materials

Wagons leaving site to be sheeted



Double handling of stripped materials will be minimised wherever possible

- Concrete / Masonry Cutting

Water bottles / suppression to be used with all cutting plant. Spare water bottles to be stored in the main compound.

Face mask to be FFP3 as a minimum and face fitted.

- Road Cleaning

The main tarmac access road will be swept with a mechanical road sweeper when dust is at a level which constitutes a nuisance potential. A mechanical road sweeper will also be used on public highways in the immediate vicinity of the site if necessary to ensure the road surface remains clean. The frequency of use of a sweeper is determined by the Site manager based on weather and road conditions.

- Adverse Weather

Works will be planned with due consideration to weather conditions and weather forecasts to minimise the nuisance affects of airborne dust.

vii A scheme for recycling/disposing of waste resulting from construction works

- General site waste generated from the site will be collected in forklift skips placed adjacent to each house, these will be emptied in to segregated material waste skips located within the site compound.
- The site levels and design has taken in to account the site topography to minimise disposal of site arising and re-use suitable spoil where levels are being adjusted.