

NOTE:

- KERBS TO BE CUT TO ACCOMMODATE VEHICLE CROSSINGS
- 125x150 BN KERB REQUIRED FOR SINGULAR VEHICULAR ACCESS
- 125x255 BN KERB REQUIRED FOR MULTIPLE VEHICULAR ACCESS
- 125x255 BN KERB WITH 50mm FACE AT HUMPS AND RAISED TABLES



Diagram illustrating the cross-section (A-A) of a concrete channel kerb structure. The components and materials are labeled as follows:

- 150x150 PC CONCRETE CHANNEL KERB
- STONE SETTS
- 50mm BEDDING MORTAR
- 125mm AC32 - SEE CLAUSE 929 - DENSE BASE ASPHALT CONCRETE (DESIGN MIXTURES) - AC32 HDM BIN 40/60 DES
- SUBBASE - SUBBASE TYPE 1 TABLE 8 / 2 & CLAUSE 803 260MM THICK (ASSUMED CBR > 5% TBC ON-SITE)
- NEW KERB

150x150 PC CONCRETE CHANNEL KERB

STONE SETTS

50mm BEDDING MORTAR

125mm AC32 - SEE CLAUSE 829 - DENSE BASE ASPHALT CONCRETE
(DESIGN MIXTURES) - AC32 HDW BIN 40/60 DES

SUBBASE - SUBBASE TYPE 1 TABLE 8 / 2 & CLAUSE
803 260MM THICK (ASSUMED CBR > 5% TBC ON-SITE)

CROSS SECTION (B-B)

TYPICAL RUMBLE STRIP DETAIL

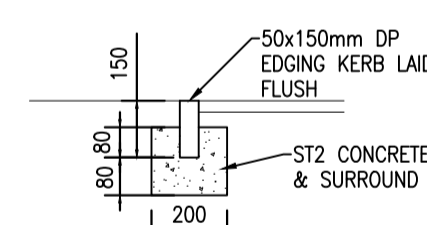

SUB - BASE BENCHED AT
150mm INTERVALS

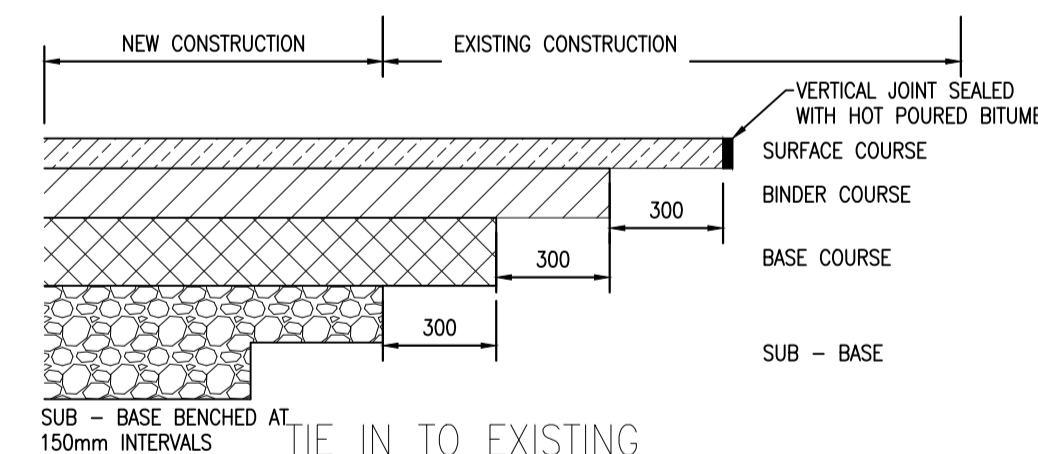

CARRIAGEWAY

NOTE:
extent and method of
tie-in to existing
carriageway to be verified
and agreed on site with
clerk of works prior to an
construction on site.

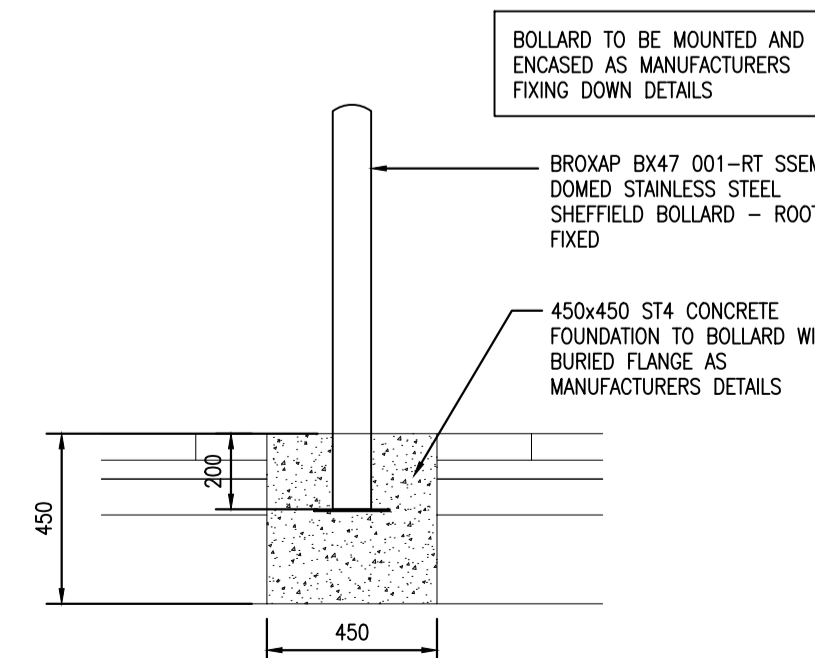

PROPOSED ADOPTABLE
BOLLARD DETAILS

1. ALL DIMENSIONS ARE IN MILLIMETRES UNLESS OTHERWISE SHOWN.
2. ALL HIGHWAY WORKS SHALL BE IN ACCORDANCE WITH THE LOCAL COUNCIL'S REQUIREMENTS
3. ALL SERVICES STRIPS SHALL BE MAINTAINED FREE OF ALL PLANTING.
4. PATHS CROSSING SERVICE STRIPS SHALL BE CONSTRUCTED AS THE FOOTWAY DETAIL.
5. FINAL DETAIL OF TIE-IN TO EXISTING ROAD SHALL BE AGREED ON SITE
6. CAPPING LAYER THICKNESS TO THE LOWEST CBR AS PER SPECIFICATION FOR HIGHWAY WORKS

CBR Value	Min 450mm Frost Susceptibility (see clause 4.68)					
	Access Road 250mm (Bituminus layer thickness)		Access Way (200mm Bituminus layer thickness)		Industrial Road (300mm Bituminus layer thickness)	
	Capping	Sub Base	Capping	Sub Base	Capping	Sub Base
	Less than 2%	550	200	500	250	600
2%	400	200	350	250	450	150
3%	300	200	250	250	350	150
4%	250	200	200	250	300	150
5% to 15%	200	200	200	250	250	150
More than 15%		200		250		150

1. TACTILE PAVING FLAGS TO BE LAID IN ACCORDANCE WITH DETR PUBLICATION, "GUIDANCE ON THE USE OF TACTILE PAVING SURFACES"
2. ANY MAKE UP IN PAVED CONSTRUCTION FOOTWAYS TO BE IN CUT FLAGS SAVED FROM EXISTING FOOTWAY. CONCRETE INFILL ONLY TO BE USED WITH THE INSTRUCTION OF SITE ENGINEER
3. CONCRETE INFILL ONLY TO BE USED WITH THE INSTRUCTION OF THE LOCAL AUTHORITY HIGHWAYS INSPECTORS
4. DROP CROSSINGS TO ALIGN WITH CROSSING ON THE OPPOSITE SIDE SIDE OF ROAD. BLUSTERS ON TACTILE PAVING MUST ALIGN WITH BLUSTERS ON PAVERS ON OPPOSITE SIDE OF ROAD
5. FOR KERBS ADJACENT A WATER CARRYING CHANNEL UPSTAND SHOULD BE 6mm ABSOLUTE MAXIMUM DESIRABLE 0mm
6. PROPRIETARY APPROVED "STICK ON" BLUSTER TILES TO BE USED WHERE APPROPRIATE ON SERVICE BOXES AFTER RE-BEDDING OF COVER AND FRAME ALLOWING FOR THE THICKNESS OF TILE

1. KERBS ARE TO BE PRECAST TO BS 7263: 1994.
2. TRANSITION KERBS ARE TO BE USED AT ALL CHANGES OF KERB TYPE.
3. CONCRETE BED AND HAUNCHING TO BE IN ACCORDANCE WITH SPECIFICATION CLAUSE 2602 (MIX STA)
4. CONCRETE BED IS TO REST ON OR WITHIN SUB-BASE LAYER OR ON ADDITIONAL CONCRETE, MEASURED SEPARATELY TO ALLOW IT TO REST ON SUB-BASE. SUB-BASE IS TO PROTRUDE 500mm FROM FACE OF KERB, BEHIND KERB AND IS TO HAVE A MINIMUM THICKNESS OF 100mm WHERE SUB-BASE IS TO BE DRAINED OR AN APPROVED METHOD OF DRAINAGE PROVIDED. (WITHOUT AN AGREEMENT, ALL EXISTING KERB RACE TO BE EXCAVATED)
5. KERBS SHALL BE LAID ON CLASS 1 MORTAR LAID ON BED IN ACCORDANCE WITH CLAUSE 2402 AND HAVING A MINIMUM THICKNESS OF 10mm AND A MAXIMUM THICKNESS OF 40mm. ALL KERBS TO BE LAID ON MORTAR BED AS PER DRAWN KERB DETAILS.
6. DOWEL BARS ARE SPECIFIED WHEN SMALL ELEMENT EDGING IS USED. THEY ARE TO BE BEDDED AT 500mm CENTERS.
7. IF HALF BATTERED KERBS ARE USED IN CONJUNCTION WITH 'SAFETICURBS' TYPE HB2 HALF BATTERED KERBS, KERB FACE IS TO BE REDUCED TO 100mm TO SUIT.

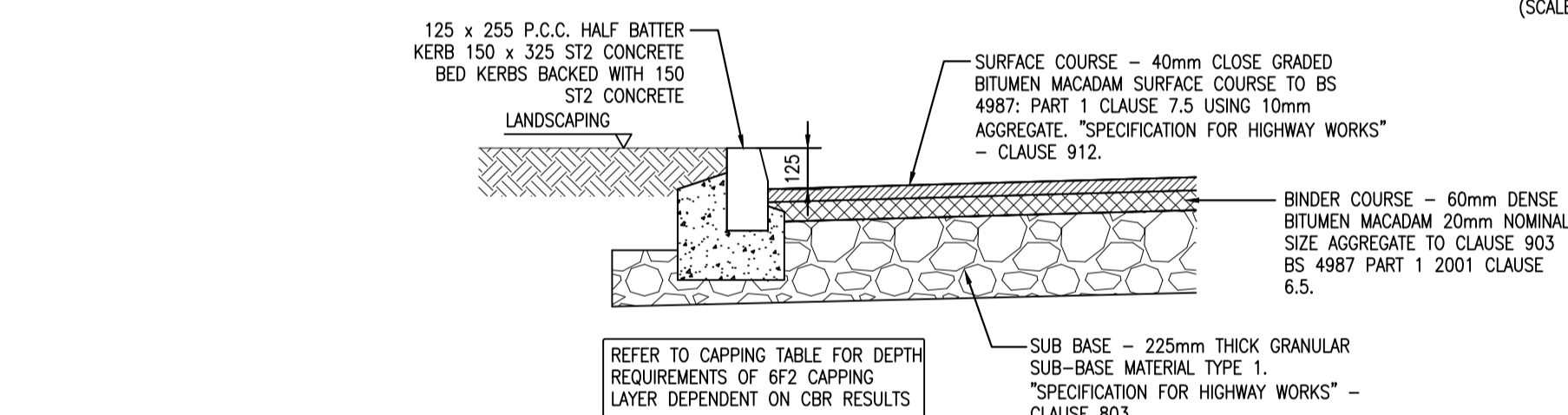

(SCALE 1:20)

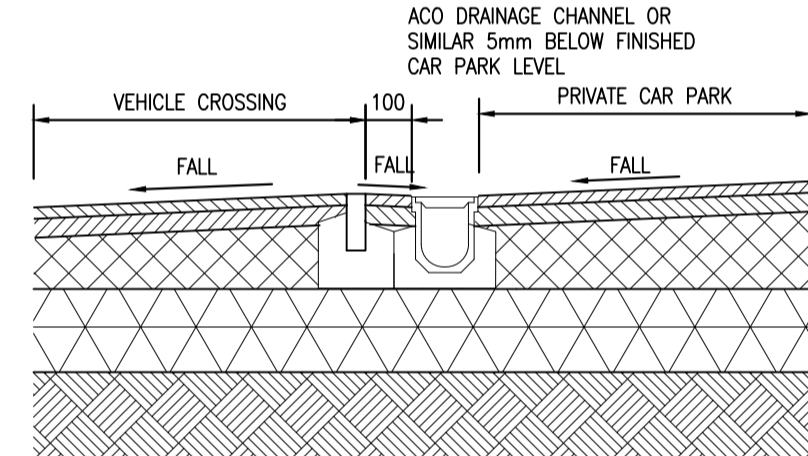

DISHED DRAINAGE CHANNEL TO PRIVATE CAR PARKS

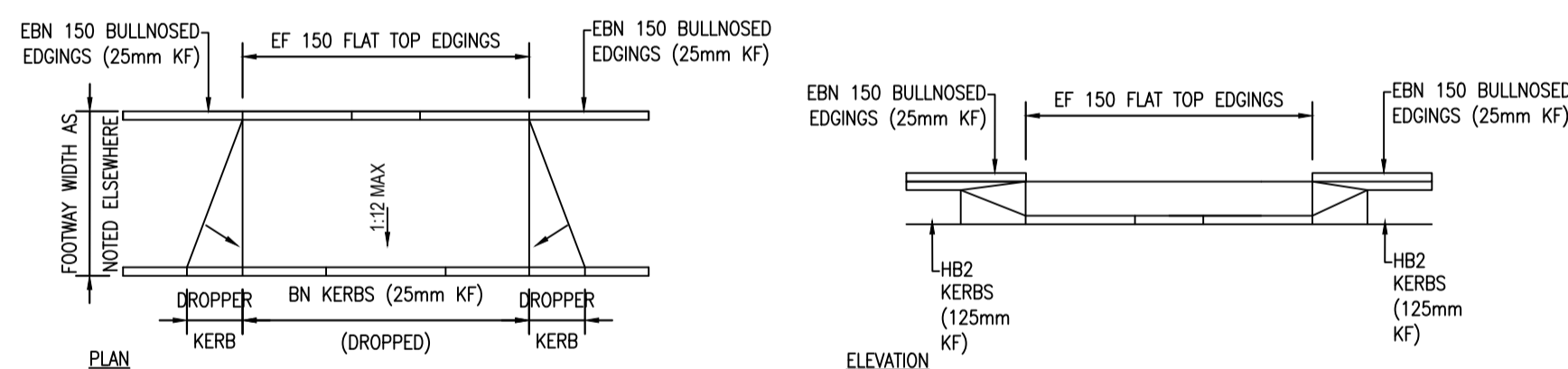

VEHICULAR CROSSING

NOTE:
FOOTWAY CAMBER OF 1:40 MUST ONLY BE USED WHERE THERE IS THE POSSIBILITY OF VEHICLES GROUNDING WITH PRIVATE BACKFALL. APPROVAL MUST BE OBTAINED FROM HIGHWAYS ENGINEER. THE 1:40 FOOTWAY CROSSFALL SHOULD MAINTAINED THROUGH THE VEHICULAR CROSSING POINTS AND THE REAR-EDGING KERB ADJUSTED ACCORDINGLY.

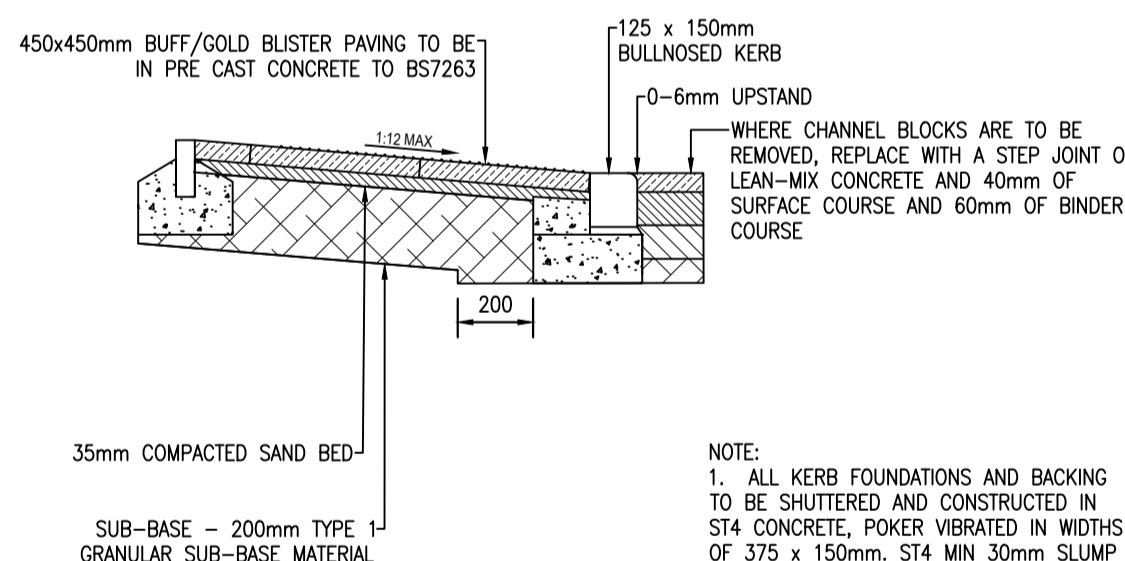

NOTE:
1. ALL KERB FOUNDATIONS AND BACKING
TO BE SHUTTERED AND CONSTRUCTED IN
ST4 CONCRETE, POKER VIBRATED IN WIDTHS
OF 375 x 150mm. ST4 MIN 30mm SLUMP
CONCRETE FOUNDATIONS AND HAUNCH

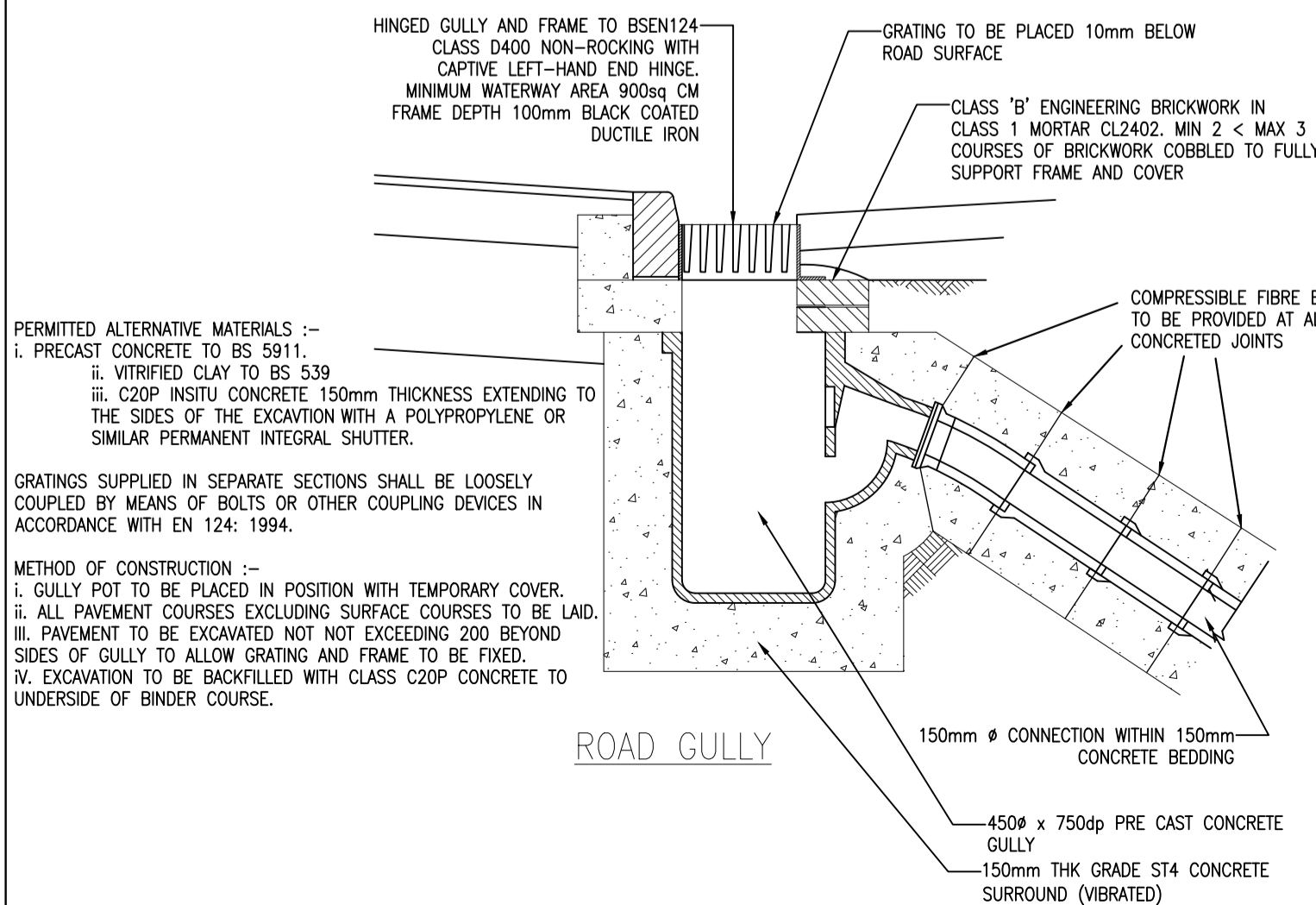
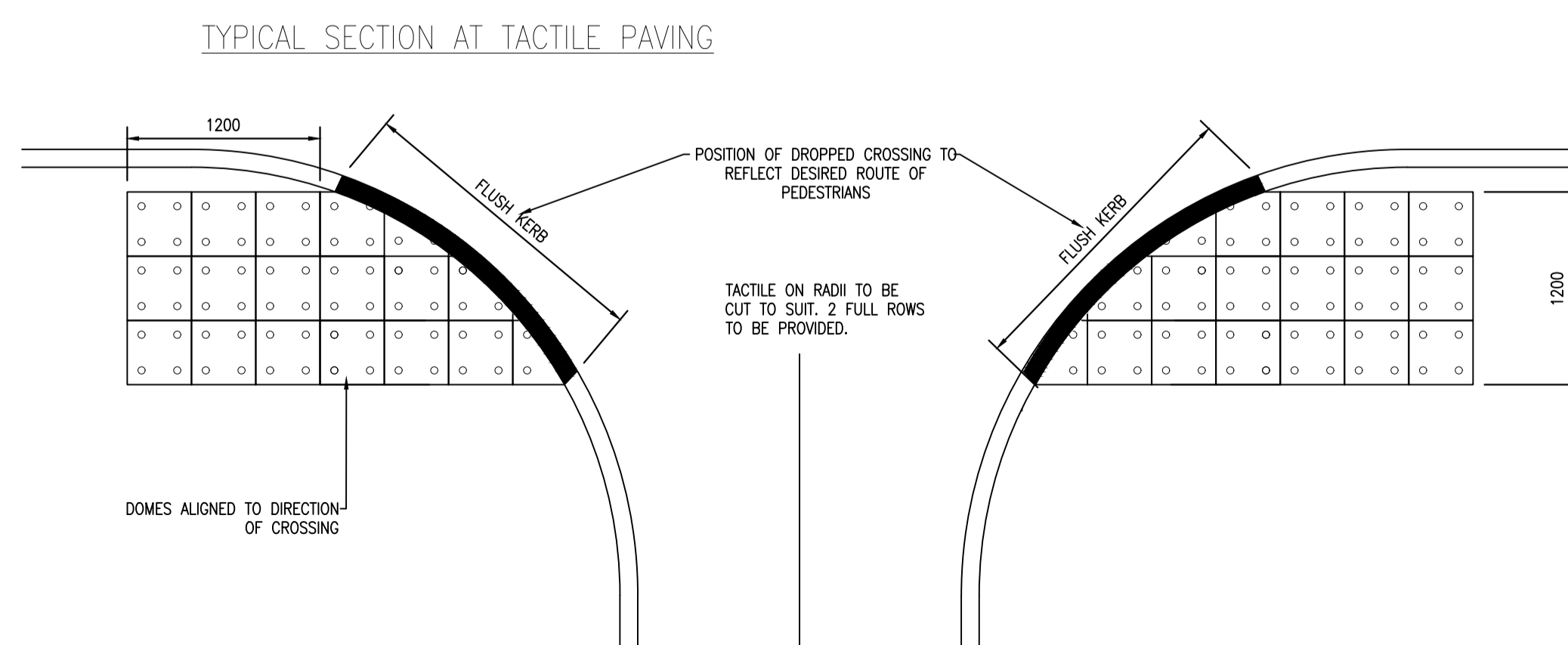
ROAD GULLY

PLAN OF TACTILE PAVING

SUBJECT TO S38/278 AGREEMENT

[illegible]

CLIENT: OAKMERE HOMES LTD

ARCHITECT

ARCHITECT

PROJECT

NEW HOUSING DEVELOPMENT
ACCRINGTON ROAD
WHALLEY

TITLE	DATE	BY	NO.	PRICE	REMARKS
1. <i>...</i>
2. <i>...</i>
3. <i>...</i>
4. <i>...</i>
5. <i>...</i>
6. <i>...</i>
7. <i>...</i>
8. <i>...</i>
9. <i>...</i>
10. <i>...</i>
11. <i>...</i>
12. <i>...</i>
13. <i>...</i>
14. <i>...</i>
15. <i>...</i>
16. <i>...</i>
17. <i>...</i>
18. <i>...</i>
19. <i>...</i>
20. <i>...</i>
21. <i>...</i>
22. <i>...</i>
23. <i>...</i>
24. <i>...</i>
25. <i>...</i>
26. <i>...</i>
27. <i>...</i>
28. <i>...</i>
29. <i>...</i>
30. <i>...</i>
31. <i>...</i>
32. <i>...</i>
33. <i>...</i>
34. <i>...</i>
35. <i>...</i>
36. <i>...</i>
37. <i>...</i>
38. <i>...</i>
39. <i>...</i>
40. <i>...</i>
41. <i>...</i>
42. <i>...</i>
43. <i>...</i>
44. <i>...</i>
45. <i>...</i>
46. <i>...</i>
47. <i>...</i>
48. <i>...</i>
49. <i>...</i>
50. <i>...</i>
51. <i>...</i>
52. <i>...</i>
53. <i>...</i>
54. <i>...</i>
55. <i>...</i>
56. <i>...</i>
57. <i>...</i>
58. <i>...</i>
59. <i>...</i>
60. <i>...</i>
61. <i>...</i>
62. <i>...</i>
63. <i>...</i>
64. <i>...</i>
65. <i>...</i>
66. <i>...</i>
67. <i>...</i>
68. <i>...</i>
69. <i>...</i>
70. <i>...</i>
71. <i>...</i>
72. <i>...</i>
73. <i>...</i>
74. <i>...</i>
75. <i>...</i>
76. <i>...</i>
77. <i>...</i>
78. <i>...</i>
79. <i>...</i>
80. <					

HIGHWAYS DETAILS

STATUS:	PROJECT No.	ORIGINATOR	PHASE	LEVEL	TYPE	ROLE	DRAWING No.	REV:
S2	21315 - GAD - ZZ - 01 - DR - C - 1530							P01

SCALE @ A'

DESIGNED:

<p>  </p>	<p> DRAWN: </p>
--	------------------------

	CHECKED:
--	----------

	APPROVED
--	----------

DATE:

Unit 20

M & P Gadsden
Consulting Engineers Ltd

Meetings Industrial Estate
Park Road, LA14 4TL
Tel: 01229 813333
www.mpg-consulting.co.uk