

**IMPORTANT NOTES**

ALL WORK TO BE CARRIED OUT IN ACCORDANCE WITH THE BUILDING REGULATION, ALL RELEVANT BRITISH STANDARDS SPECIFICATION, CODES OF PRACTICE, LOCAL AUTHORITY BYLAWS, AND IN COMPLIANCE WITH THE LOCAL AUTHORITY APPROVAL. CONTRACTORS MUST CHECK ALL DIMENSIONS ON SITE BEFORE COMMENCING ANY WORK OR MAKING ANY SHOP DRAWINGS. WHERE WRITTEN DIMENSIONS ARE PROVIDED THESE SHOULD BE TAKEN IN PREFERENCE TO SCALES OR MEASUREMENTS BUT THEY MUST BE STILL CHECKED ON SITE OR BY REFERENCE TO THE AGENT.

THE PARTY WALL ACT CAN APPLY TO CERTAIN KINDS OF DEVELOPMENT WHERE YOU ARE BUILDING EXTENSIONS OR ALTERING BUILDINGS CLOSE TO YOUR NEIGHBOUR'S PROPERTY.

PLEASE NOTE THAT IN CERTAIN SITUATIONS YOU WILL NEED TO ENGAGE A PARTY WALL SURVEYOR. FOR FURTHER INFORMATION AS TO WHETHER THE PARTY WALL ACT WOULD APPLY TO THE WORKS DESCRIBED ON THESE PLANS, YOU CAN VISIT THE OFFICE OF THE DEPUTY PRIME MINISTER'S WEBSITE AT [WWW.DPM.GOV.UK](http://WWW.DPM.GOV.UK).

PLEASE NOTE THAT THIS LEGISLATION IS NOT ENFORCED BY THE LOCAL AUTHORITY AND/OR THE BUILDING INSPECTOR UNLESS SEPARATELY RESTRICTED. WE DO NOT GET INVOLVED WITH PARTY WALL MATTERS.

IF THE PROPOSED WORKS ARE TO BE CARRIED OUT BY MORE THAN ONE CONTRACTOR THEN THE CONSTRUCTION DESIGN AND MANAGEMENT REGULATIONS 2015 WILL APPLY. FOR FURTHER INFORMATION PLEASE SPEAK TO THE AGENT OR LOOK UP [WWW.CDM.GOV.UK](http://www.cdm.gov.uk)

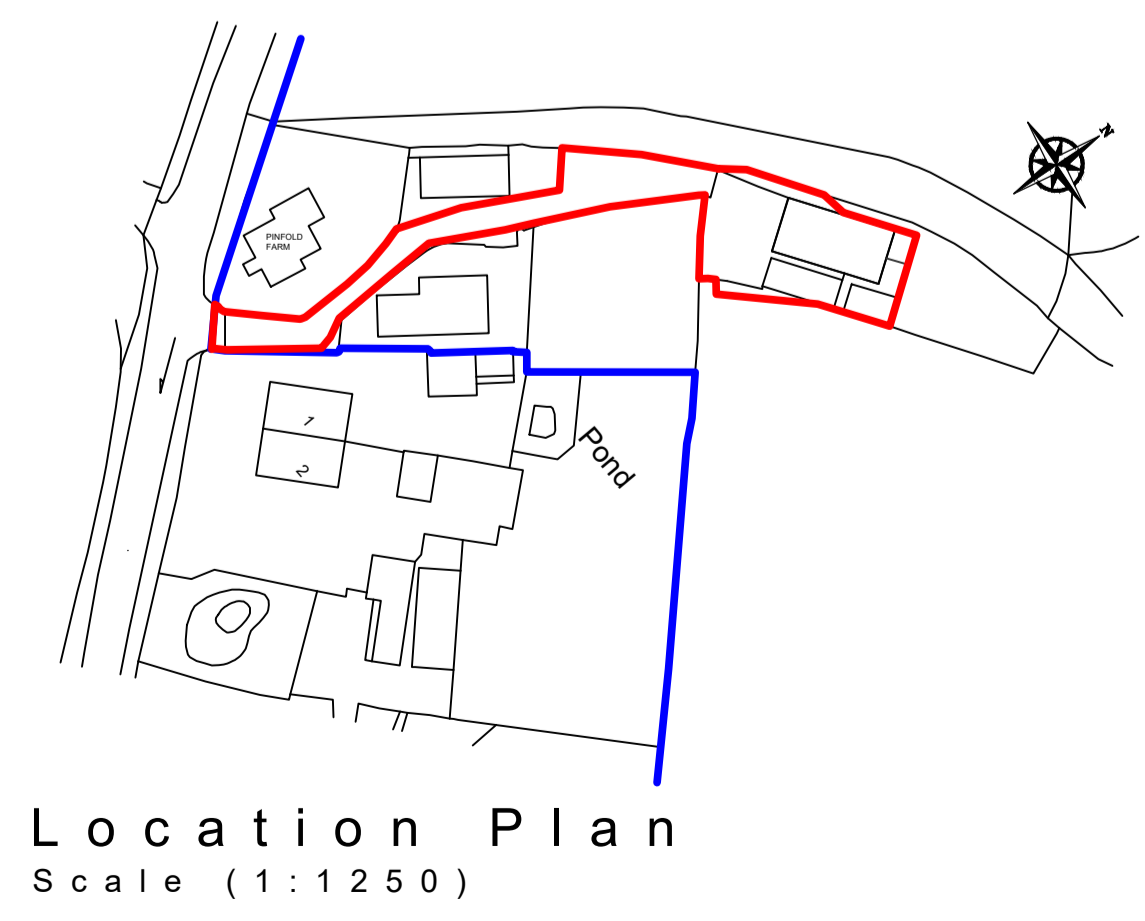
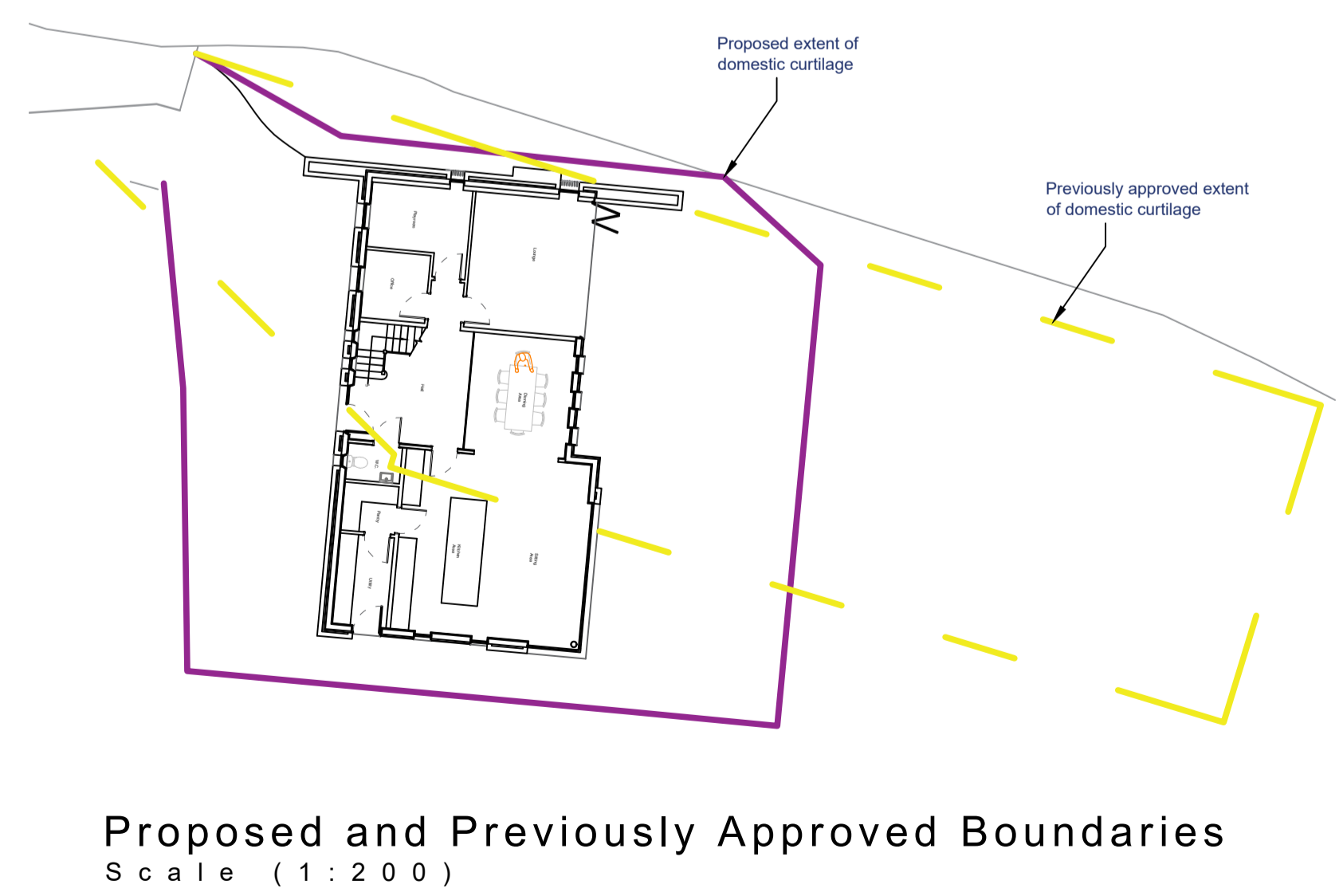
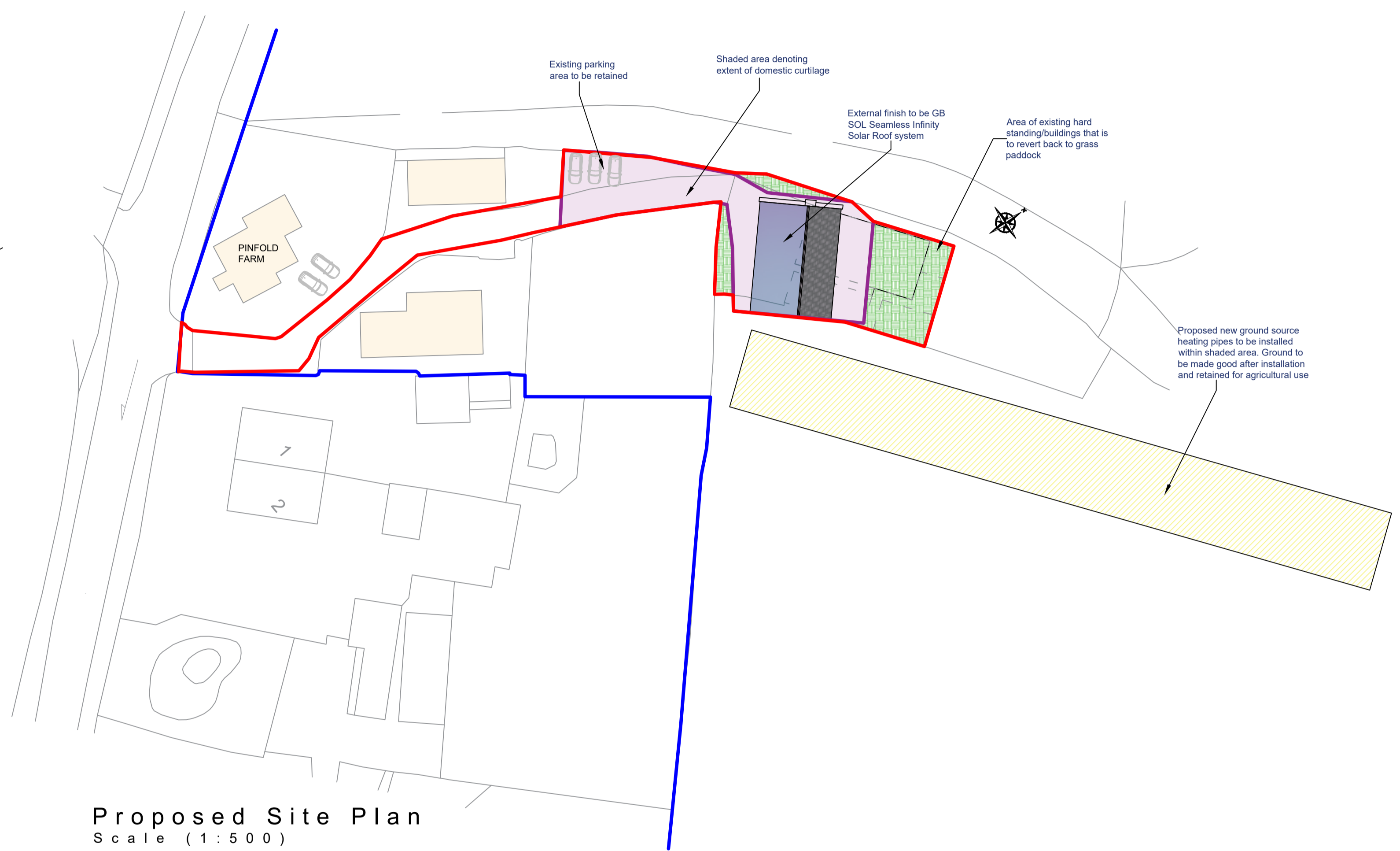
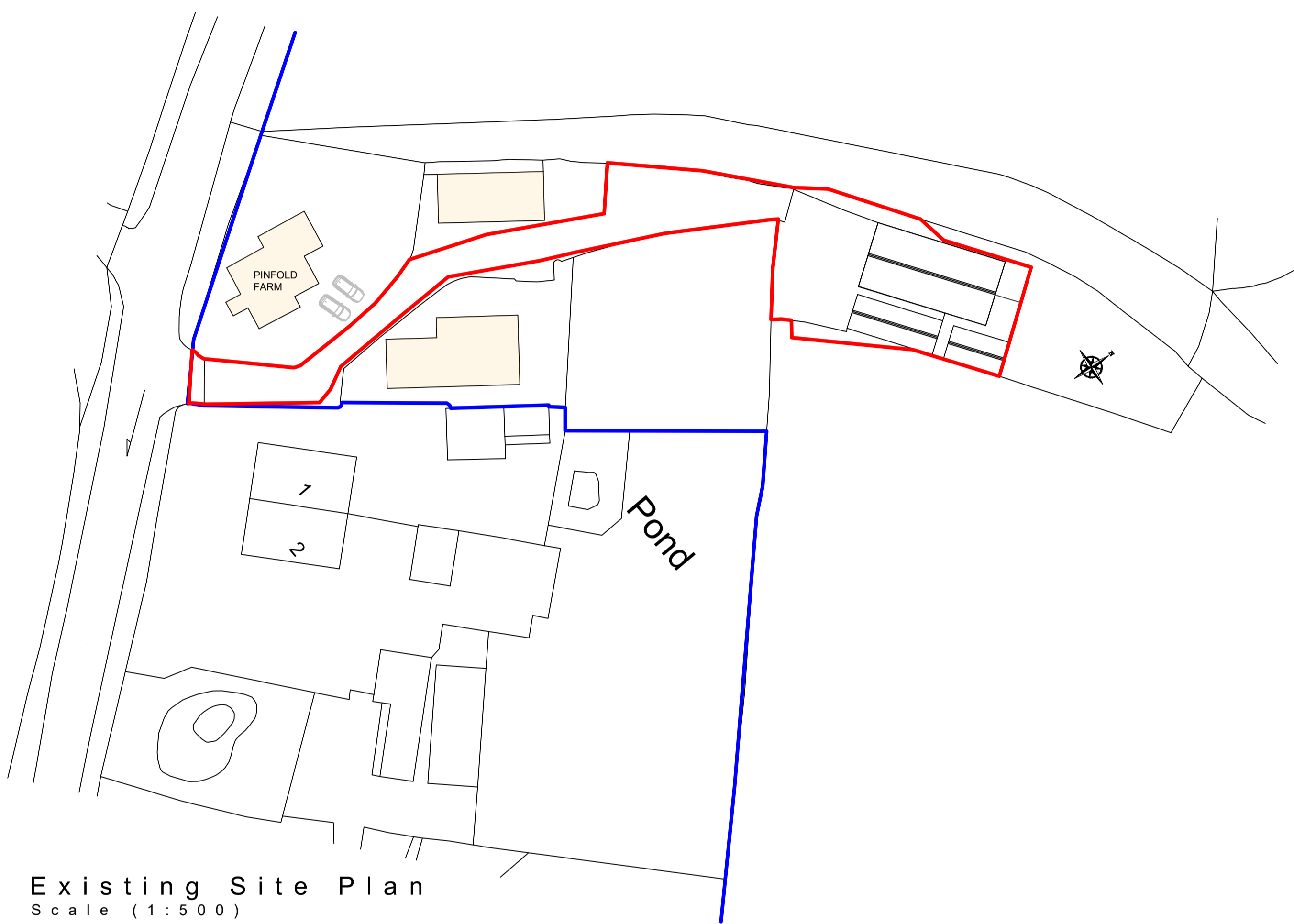

Previously Approved Floor Area -	300m <sup>2</sup>
Previously Approved Volume -	745.38m <sup>3</sup>
Previously Approved Total Site Area (including Parking and Access Road) -	907m <sup>2</sup>
Proposed Floor Area -	220m <sup>2</sup>
Proposed Volume -	736.00m <sup>3</sup>
Proposed Total Site Area (including Parking and Access Road) -	878m <sup>2</sup>
Proposed Red Edge -	1114m <sup>2</sup>

Revision	Date

**HOLDEN**  
Lancashire

83 Blackburn Road, Ribchester, BB1 4ER. Mob: 07738162386. Email: james@holdenlanc.com. Web: www.holdenlanc.com

**Drawing Title:** Approved Domestic Dwelling to New Improved Energy Efficient Domestic Dwelling

**Site Location:** Pinfold Farm, Ribchester

**Drawing Status:** Site Plans

Date:	02/11/2022	Drawn by:	JHolden
Scale:	1:100/1:50 @ A1	Ref:	009
Client:	Mr. Davies	Revision:	-