

DRAWING FOR INFORMATION PURPOSES ONLY  
This drawing and all its dimensions to be checked and verified by the contractor prior to work commencing on site. for clarification of queries contact studio John Bridge Ltd. (www.studiojohnbridge.co.uk) Contractor to ensure that all proposed materials are to Local Authority Approval. The Contractor shall take into account everything necessary for the proper execution of the works including all relevant Building Regulations, nhbc and British Standards where applicable, whether or not indicated on the drawings. please refer to structural and drainage designs to be prepared by others. Subject to services and statutory authority information & approval.

#### KEY SURFACE MATERIALS

- NEW DRIVEWAY: Resin bonded or Tarmac, or similar approved.
  - FOOTPATH PAVING / PATIO: Permeable Paving Flags, or similar approved
  - SOFT LANDSCAPING: Lawn (garden)
  - SOFT LANDSCAPING: Mulch / Bark with Karl Foerster Long Grasses to Client Approval
- Planting
- Existing Trees (Position Approximate)

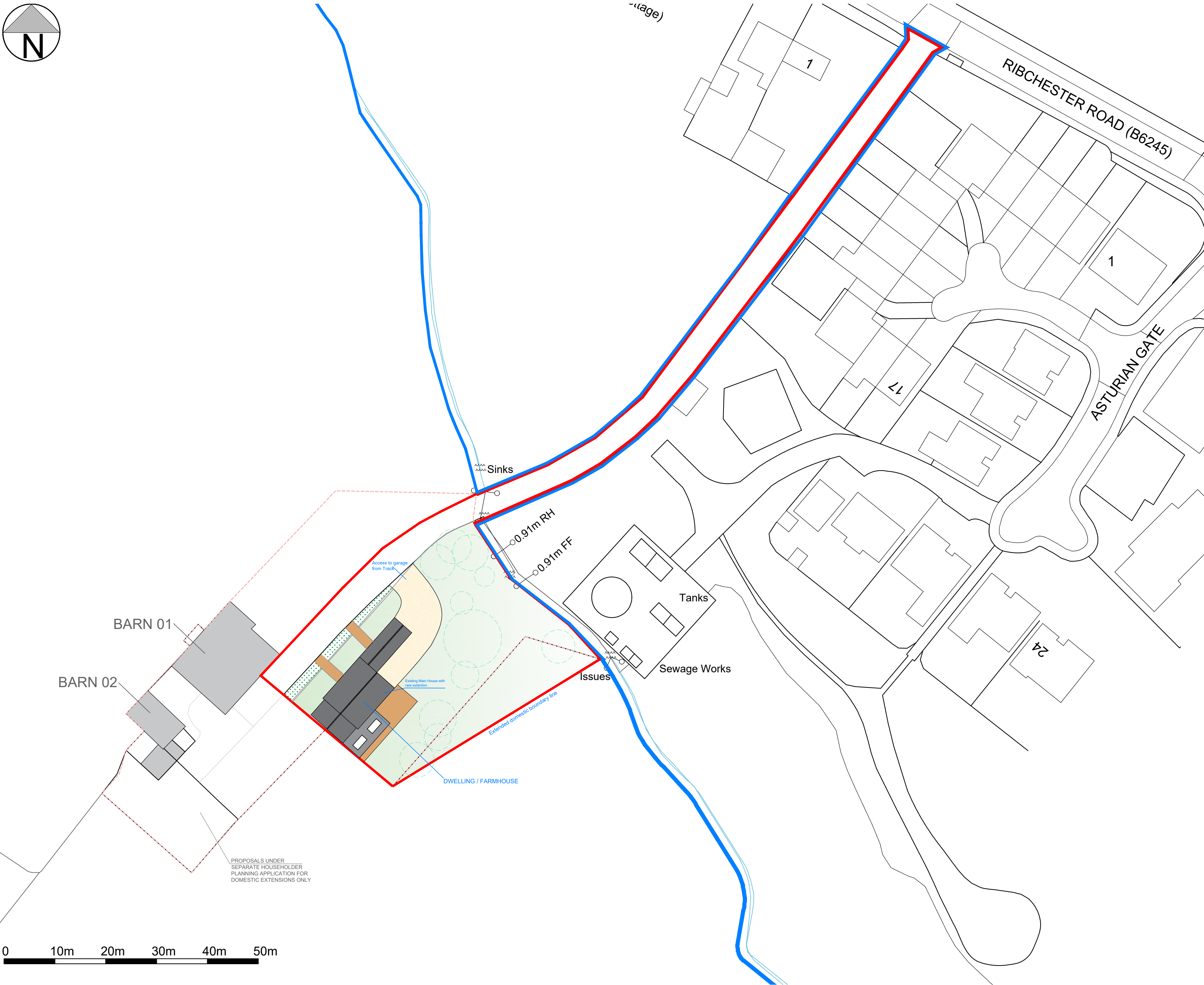

NB: sketch produced using location plans provided subject to all surveys, statutory authority information and L.A approvals  
All rights reserved. Licence number 100022432

NB: ALL DRAWINGS SUBJECT TO FURTHER DETAIL AND ALL LOCAL AUTHORITY APPROVALS.

Copyright to studio John Bridge Ltd. All rights reserved. No Duplication or Reproduction allowed, unless written consent has been granted by our practice.

CLIENT: <b>Mr. Oliver Wood</b>	DATE: JAN. 2023
PROJECT: Tan Yard Farm, Ribchester Road, Preston, PR3 3YA	REVISION: <b>B</b>
TITLE: Proposed HH Site Plan	SCALE: 1:200@A2
DWG NO.: <b>2264-P07</b>	<b>STUDIO JOHN BRIDGE</b>
01772 935959 admin@studiojohnbridge.co.uk	42 Lune Street Preston, PR1 2NN www.studiojohnbridge.co.uk