

52 X 400W PV PANELS (1722 X 1134) ARRANGED IN FOUR ROWS OF PANELS TO BE MOUNTED ON A TANTALIZED TIMBER STRUCTURAL FRAME BOLTED TO CONCRETE PAD FOUNDATIONS CONSTRUCTED WITHIN THE FIELD. ALUMINUM RAILS TO SPAN ACROSS THE UPRIGHTS TO PROVIDE A FIXING FOR THE PV PANELS.

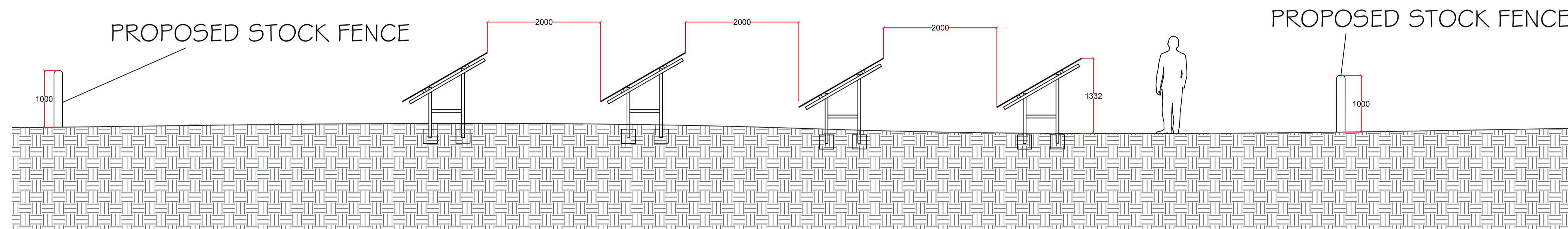

SECTION VIEW - 1:50 @ A1

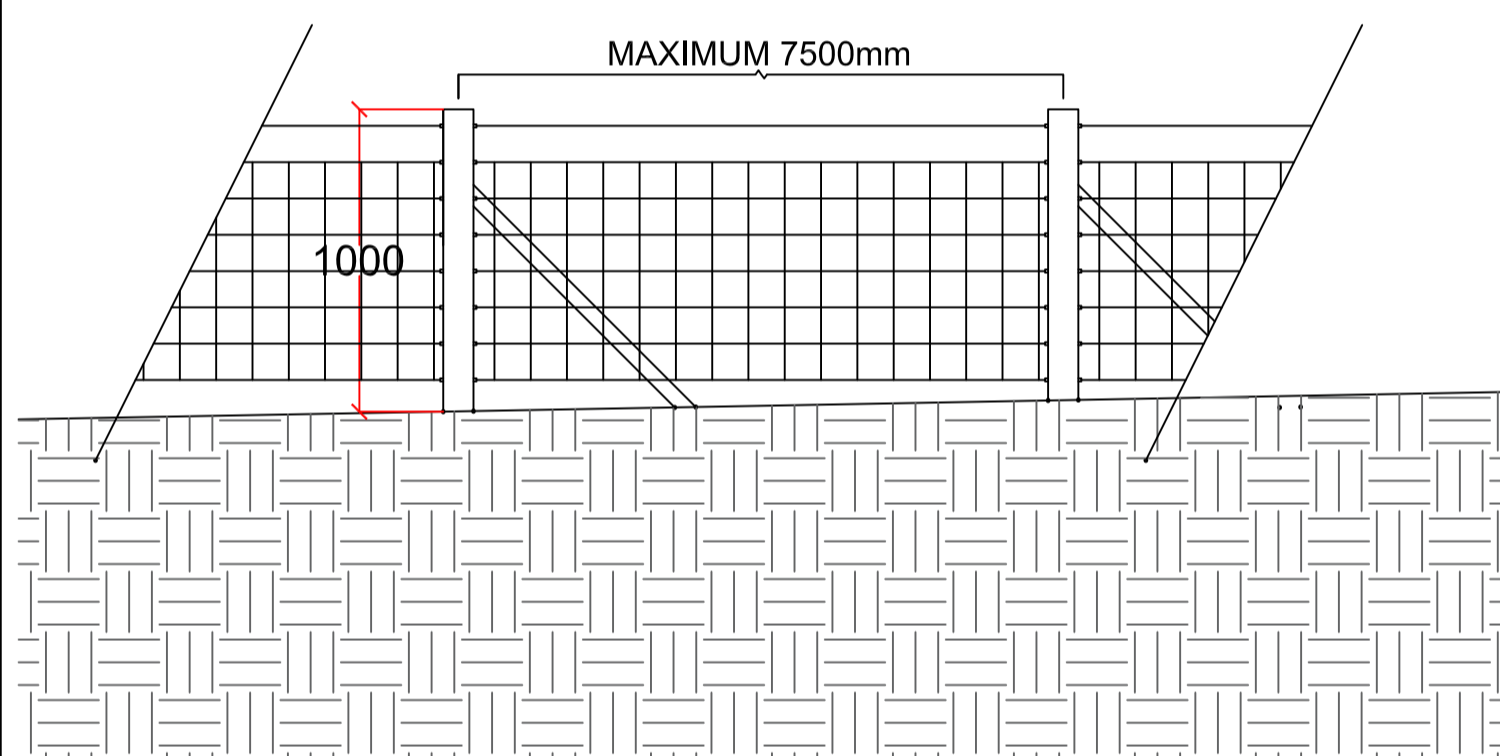

DETAIL VIEW OF STOCK FENCE - 1:25 @ A1

FOUR ROWS TO A SUM OF 52 PANELS (1722 X 1134) TOTAL OF 20,800KW

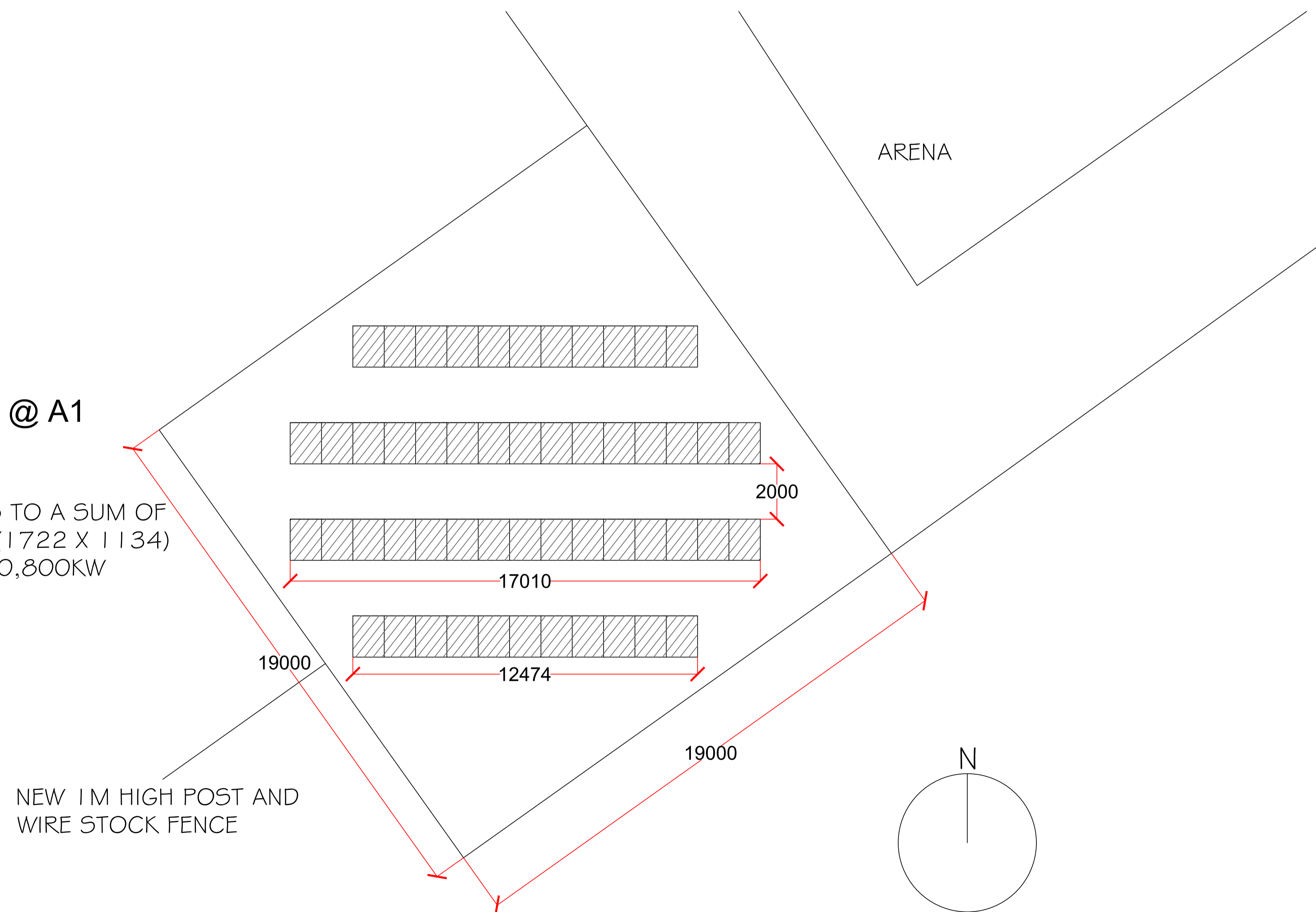

PLAN VIEW - 1:100 @ A1

Notes.

Peter Hitchen Architects

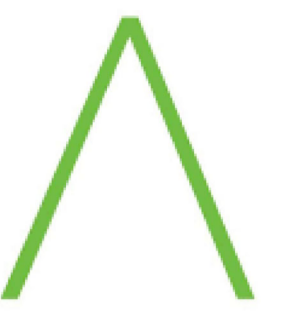

Marathon House
The Slidings Business Park
Whalley, BB7 9SE
01254 823 885
www.peterhitchenarchitects.co.uk

notes.

REFER TO DRAWING NO.100 FOR LOCATION PLAN

Project.

PROPOSED SOLAR PANEL ARRANGEMENT AT LOWER BARN FARM

Client.

MARK SOLOMON
Lower Barn Farm
Sabden
Clitheroe
BB7 9DT

drawing title:

PROPOSED SECTION AND PLAN

status.

AS SHOWN

Drawn by:

JS

checked:

PH

Date:

13/01/23

project no.

PHA/823

diag. no.

500

rev.

-