

**Key to finishes:**

- Bellmouth construction**
- 45mm thk Hot Rolled Asphalt Concrete Surface course BS594987:2007, Table 6B, HRA 30/14 F surf (Min PSV of 60);
  - 70mm thk Dense Binder Course Asphalt Concrete AC 20 HDM BIN 40/60 PEN to BS 12591;
  - 100mm thk 20mm or 32mm size Dense Base to BS EN 13108: Part 1 with 100/150 pen;
  - 300mm thk DFT Type 1 sub-base well compacted (Assumed CBR > 8%)

**Key to Services:**

British Telecom

A	Notes added for BT Asset and confirming falls.	03/04/23	RW	DH	DH
Rev	Description	Date	Revised by	Checked by	Approved
Issue Purpose: <b>Approval</b>					

Do not scale from this drawing

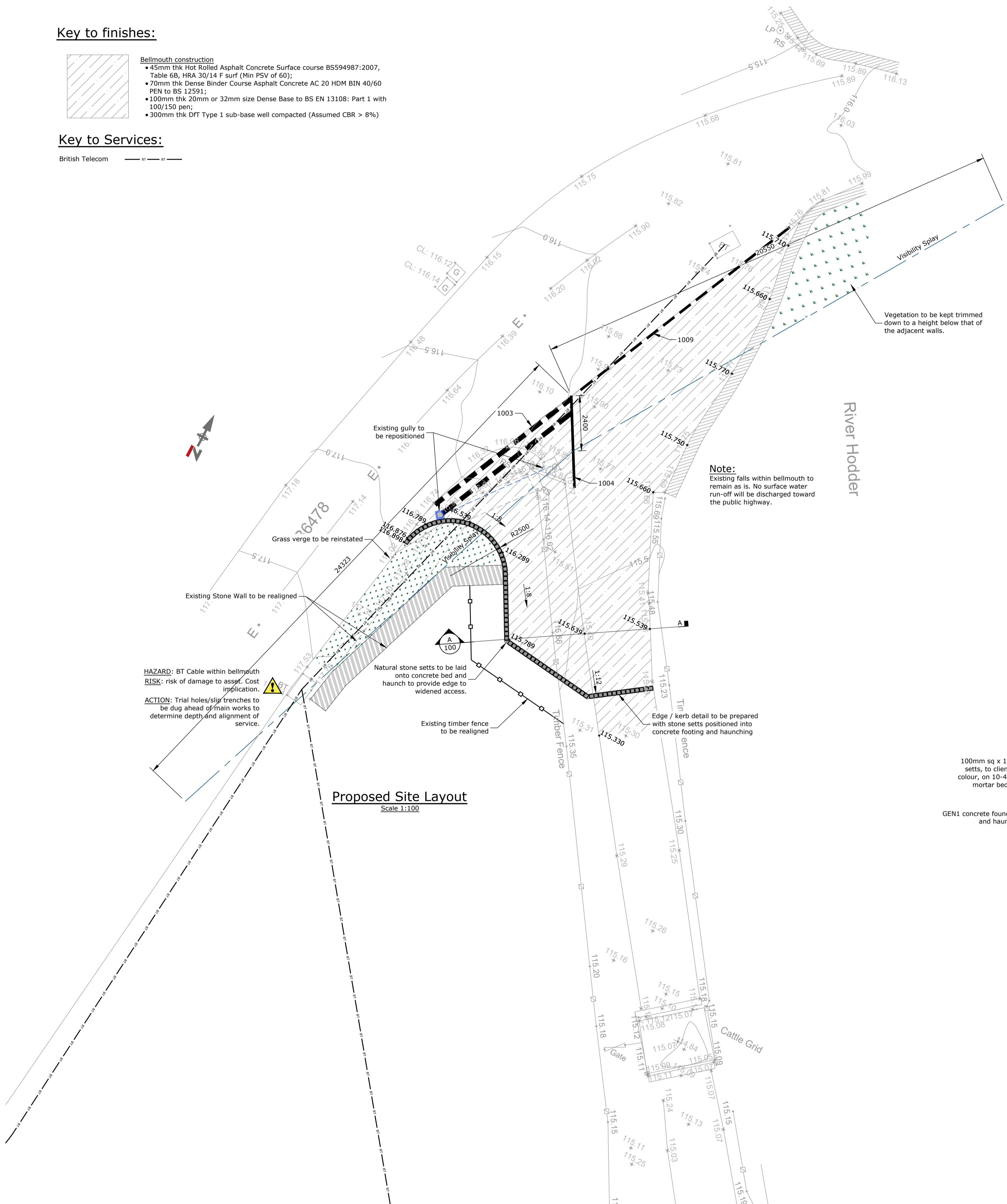

**Note:**  
Existing falls within bellmouth to remain as is. No surface water run-off will be discharged toward the public highway.

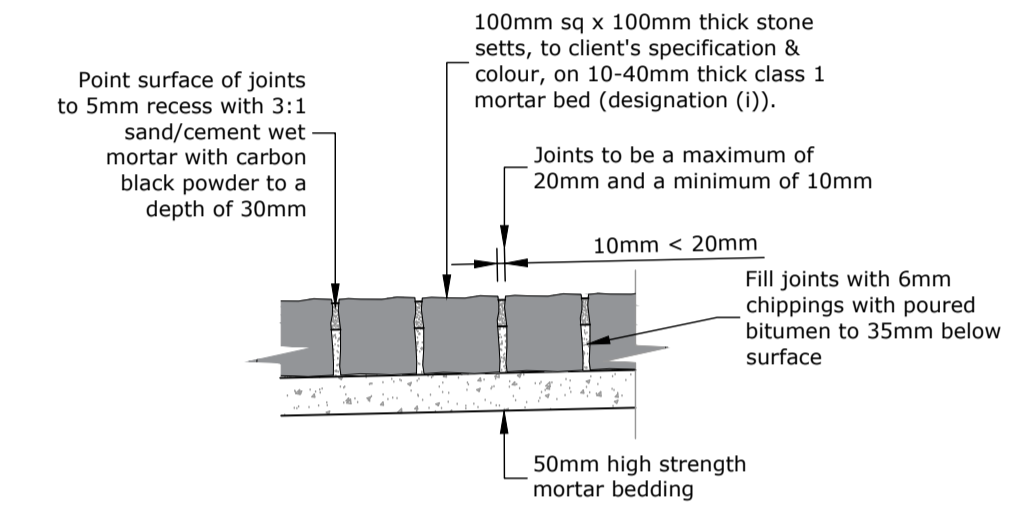

**Detail of Stone Sets Joint Pointing**  
Scale 1:10

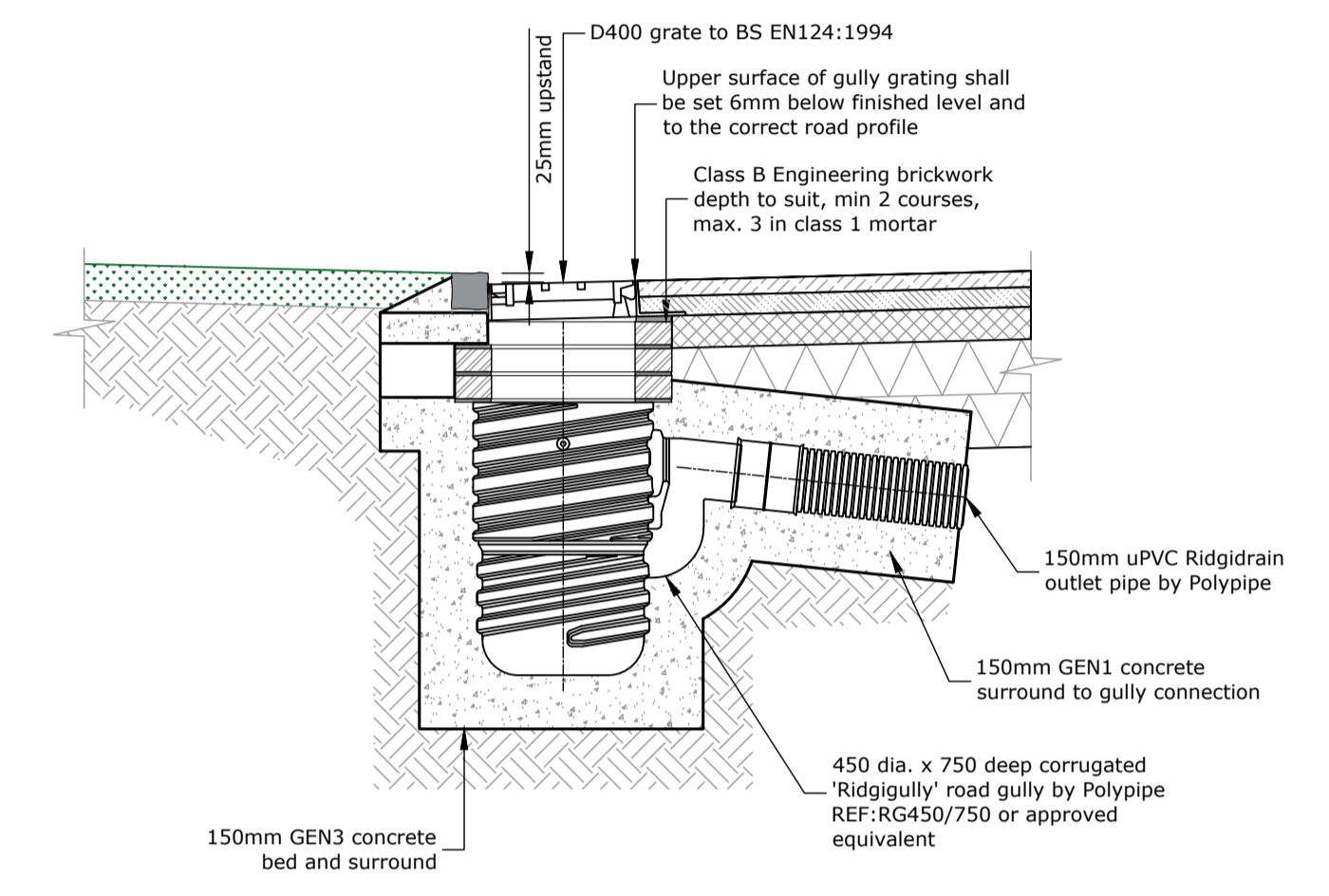

**Typical Road Gully Detail**  
Scale 1:20

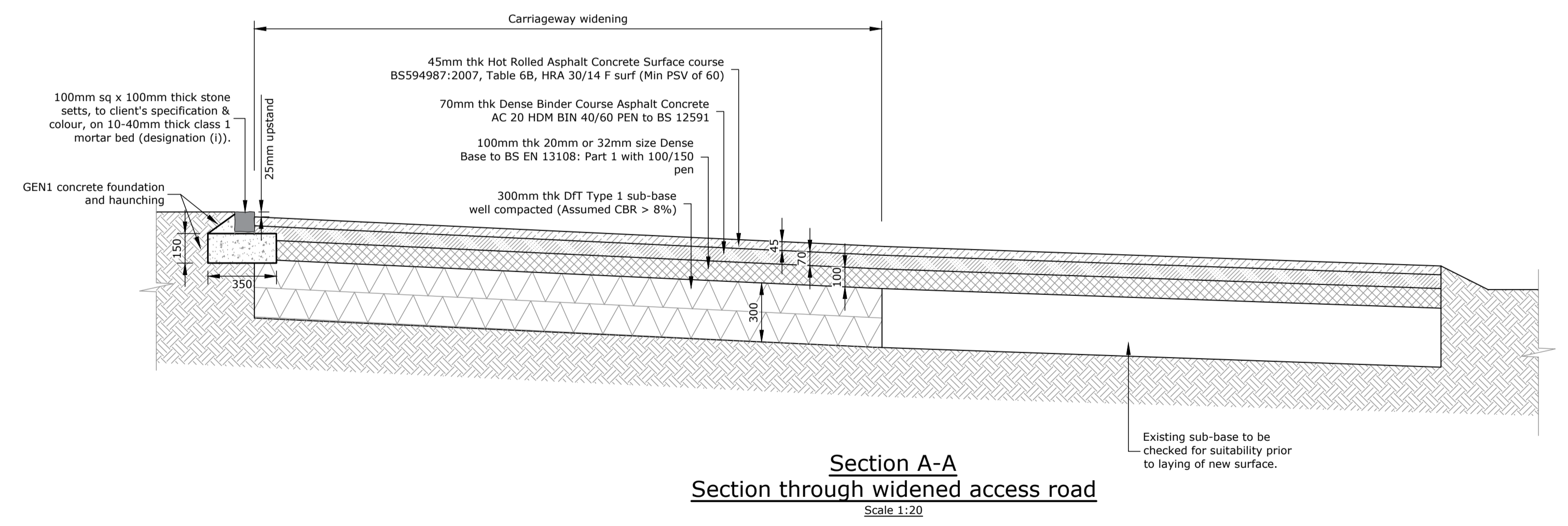

**Section A-A**  
**Section through widened access road**  
Scale 1:20

**R G PARKINS**  
Kendal | 01539 729393 Lancaster | 01524 32548

Client: **Duchy of Lancaster**  
Project: **Root Farm, Dunsop Bridge, Clitheroe**  
Drawing Title: **External Works Layout**

Scale @ A1: As shown	First Issue: 13/02/23	Office of Origin: Kendal
Drawn by: JB	Checked by: RW	Approved: DH
Project No: K39893	Drawing No: 100	Rev: A
BIM No:		