

Landscape Planting Scheme – Ashcroft

Proposed Planting Scheme.

Proposed planting scheme. (See proposed site plan showing areas for planting)

The proposed planting scheme is developed to mitigate the visual impact of a proposed stable, equipment and forage store at Ashcroft, Mill Lane, Slaidburn Road, Waddington..

A site plan showing planting areas is attached.

The scheme includes:

Planting of native species trees and shrubs in two units:

- | | |
|--------|--|
| Unit 1 | 33.0m x 7.0m Planting native species trees and shrubs to the west of the equine menage. |
| Unit 2 | 7.0m x 7.0m Planting native species trees and shrubs to the east of the access and north of existing planting. |

A planting schedule showing species and percentage mix is shown below.

Planting

General

All trees and shrubs shall conform to the relevant parts of B.S. 3936

Rejection of Plants

Any plant material, which does not meet the requirements of the specification, or is unsuitable or defective in any way, will be rejected. The minimum specified sizes in the plant schedule will be strictly enforced.

Planting

All planting material shall generally be planted between November and March in open cool weather. Planting shall not take place in frosty, snowy or waterlogged conditions. Where approved, pot or container grown plants may be planted outside the described season, but adequate watering shall be supplied. Torn or damaged roots and branches shall be clearly pruned prior to planting.

Planting of Transplants or Shrubs

The nature of the material to be planted is variable and the contractor shall allow for planting to be properly carried out in all cases as described in B.S. 4428: 1989. All plants shall be planted at the same depth, or very slightly deeper, as they were grown. Roots shall not be bent, broken or forced into inadequate pits or notches. Plants shall be upright, firmed in and wind resistant, with no air pockets around the roots. All pots and root wrappings shall be carefully removed prior to planting

Tree Ties and Stakes

Trees shall be twin staked with cross bar. Ties shall be approved nail-on type with cushioned spacer such as Toms, or other equal and approved. Nails shall be flat headed galvanised and shall hold the ties securely into the stake. Ties shall not be over tight on the tree stems.

The following ties available from J Toms Ltd are approved: Feathered Type 04, Select standards Type L1, Extra heavy Standards Type L3.

MAINTENANCE

All dead, diseased, damaged plants must be replaced for up to 10 years with a tree of the same species and of similar size to that originally planted.

Protection

Trees and shrub plants will be protected from grazing animals, sheep, deer etc with wire netting. Protection against small game and vermin will be using spiral tree guards.

Pruning

At appropriate time, prune plants to remove dead, dying or diseased wood and suckers to promote healthy growth and natural shape. Dress cut ends exceeding 25mm diameter with fungicidal sealant.

Watering

All plants will be watered to field capacity weekly during the months April – July for a minimum of 5 years. Watering will take place as required beyond this period in prolonged dry periods.

Litter

Site to be kept free of litter

PLANTING SCHEDULE**UNIT 1**

Mixed species trees and shrubs- Standard trees and feathered shrub species. Trees min spacing 1 plant/5m² Feathered plants 1 plant/2m². Groupings of 2,3,5 species randomly repeating.

Area	Species	Species	Class	No:
231 m ²	<i>Corylus avellana</i>	Hazel	F	15
	<i>Crataegus monogyna</i>	Hawthorn	F	15
	<i>Betula pubescens</i>	Silver birch	F	15
	<i>Sorbus aucuparia</i>	Rowan	F	15
	<i>Prunus avium</i>	Wild cherry	S	8
	<i>Acer campestre</i>	Field Maple	S	8
	<i>Populus tremula</i>	Aspen	S	7

UNIT 2

Mixed species shrubs 1 plant/ 3m²

Area	Species	Species	Class	No:
50m ²	<i>Viburnum opulus</i>	Guelder rose	P	3
	<i>Cornus sanguinena</i>	Dogwood	P	6
	<i>Prunus laurocerasus</i>	Laurel	P	6

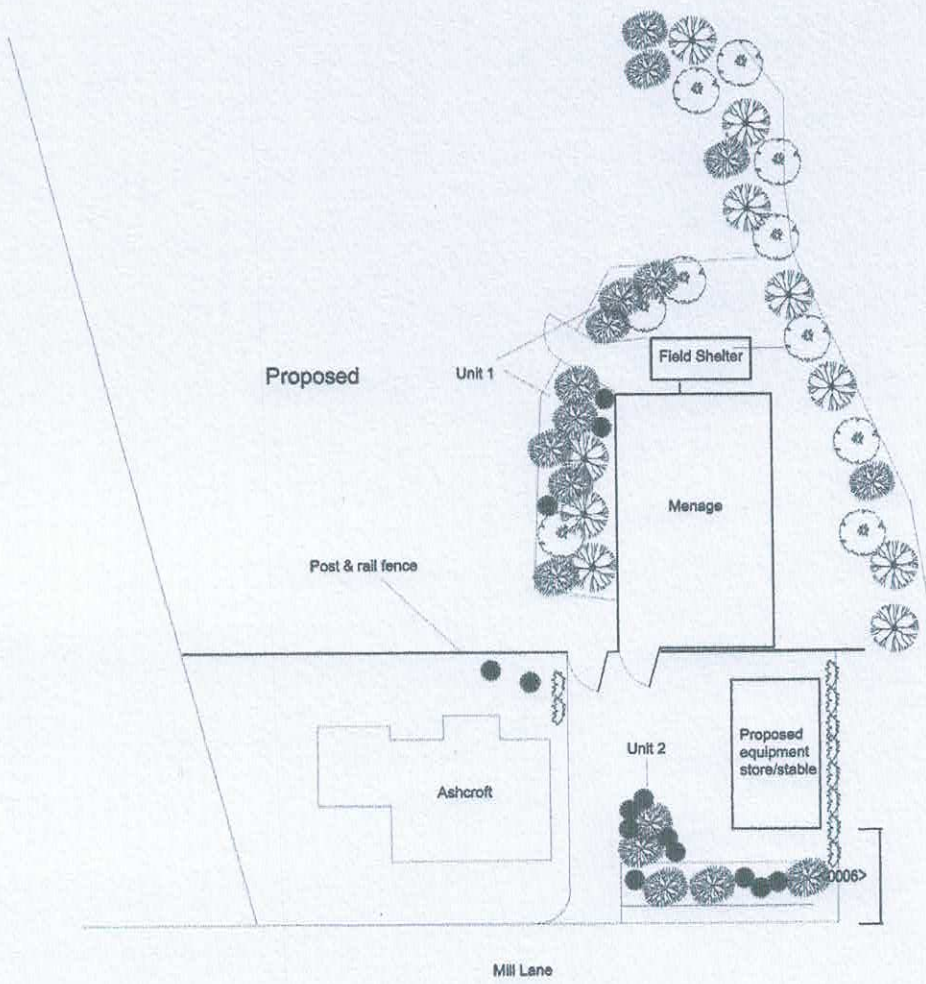

Landscaping Plan
Scale 1:500 @ A3

