

EXISTING SITE PLAN

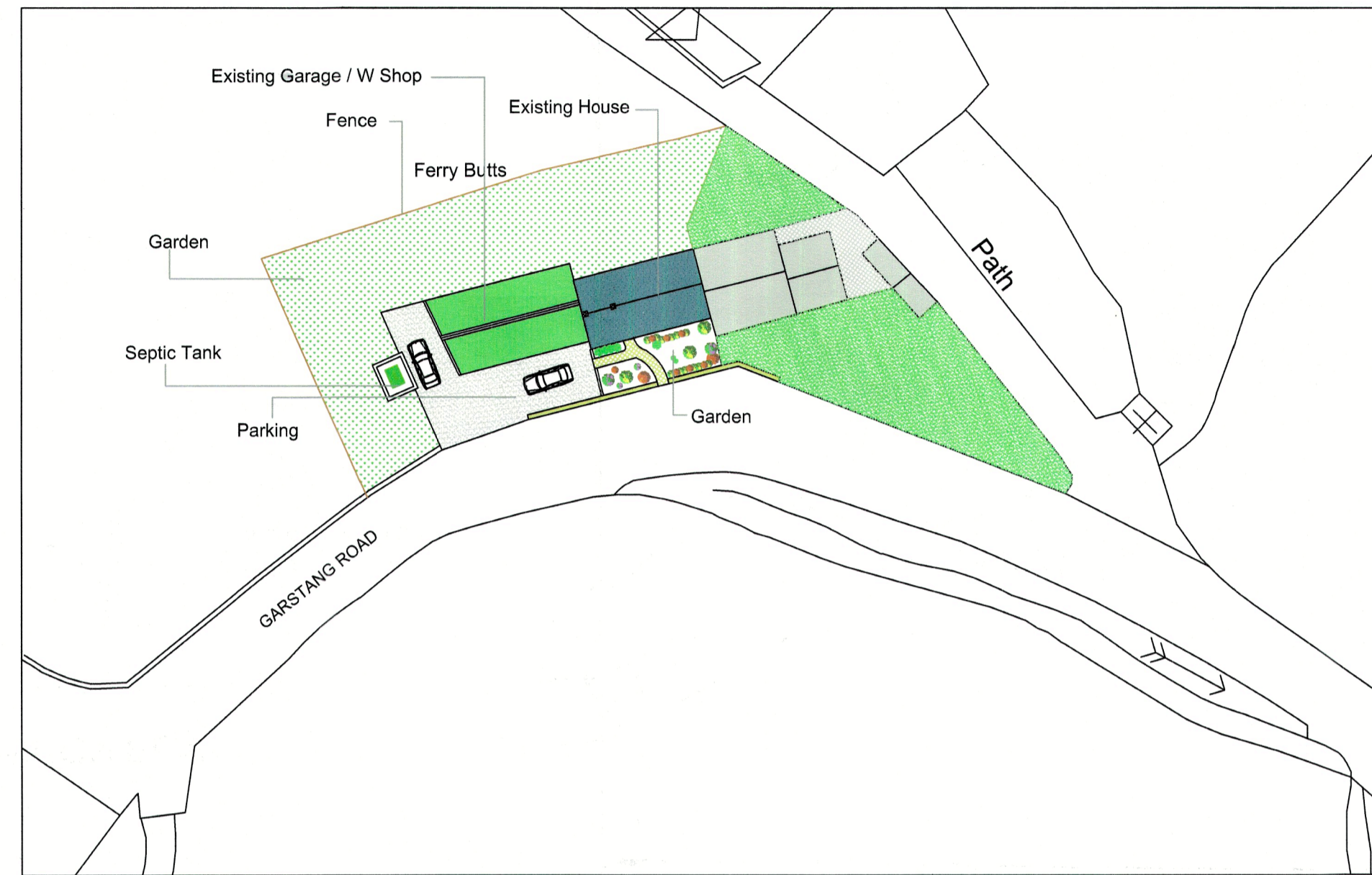

SCALE = 1:500

PROPOSED SITE PLAN

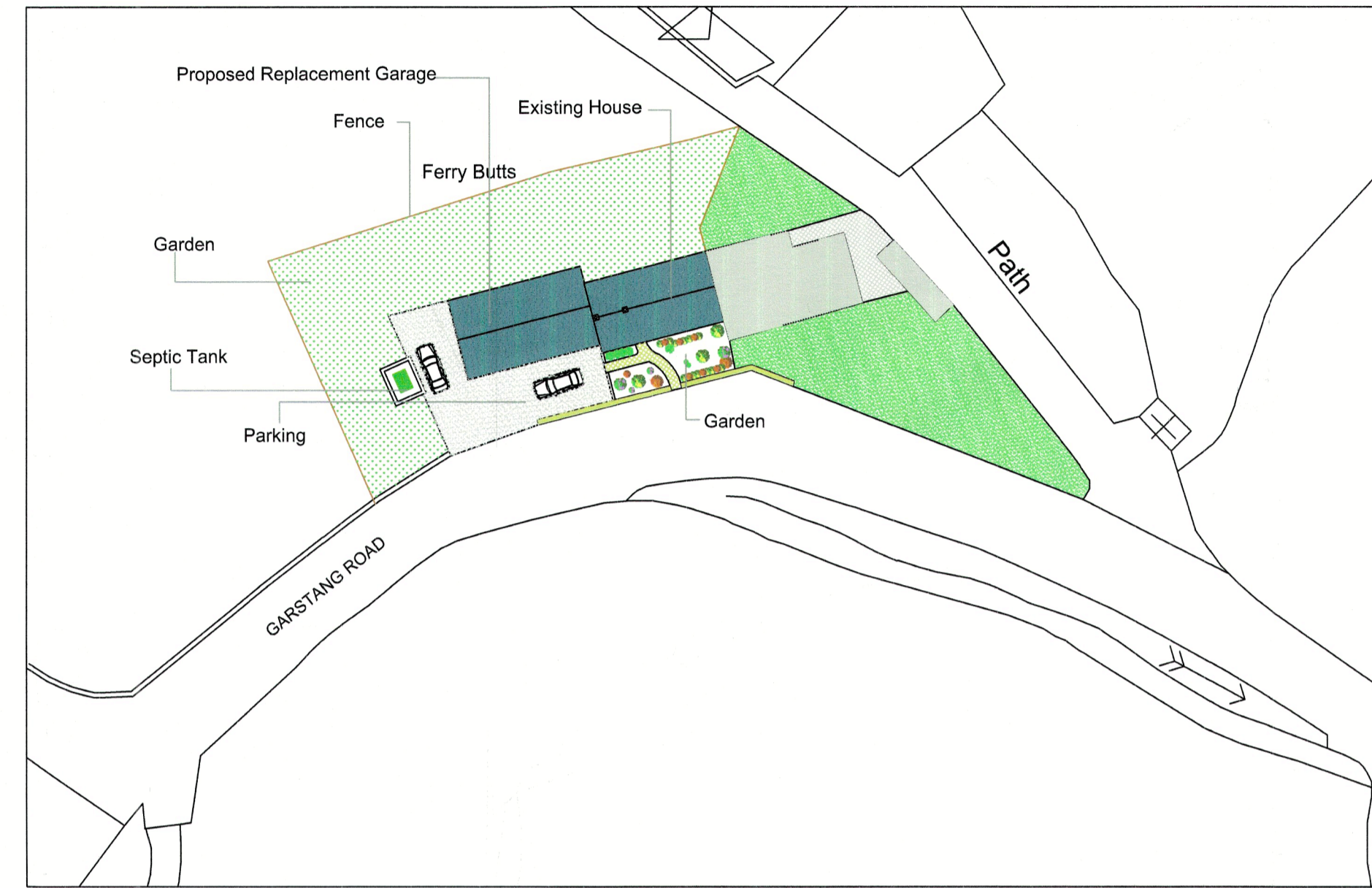

SCALE = 1:500

LOCATION PLAN

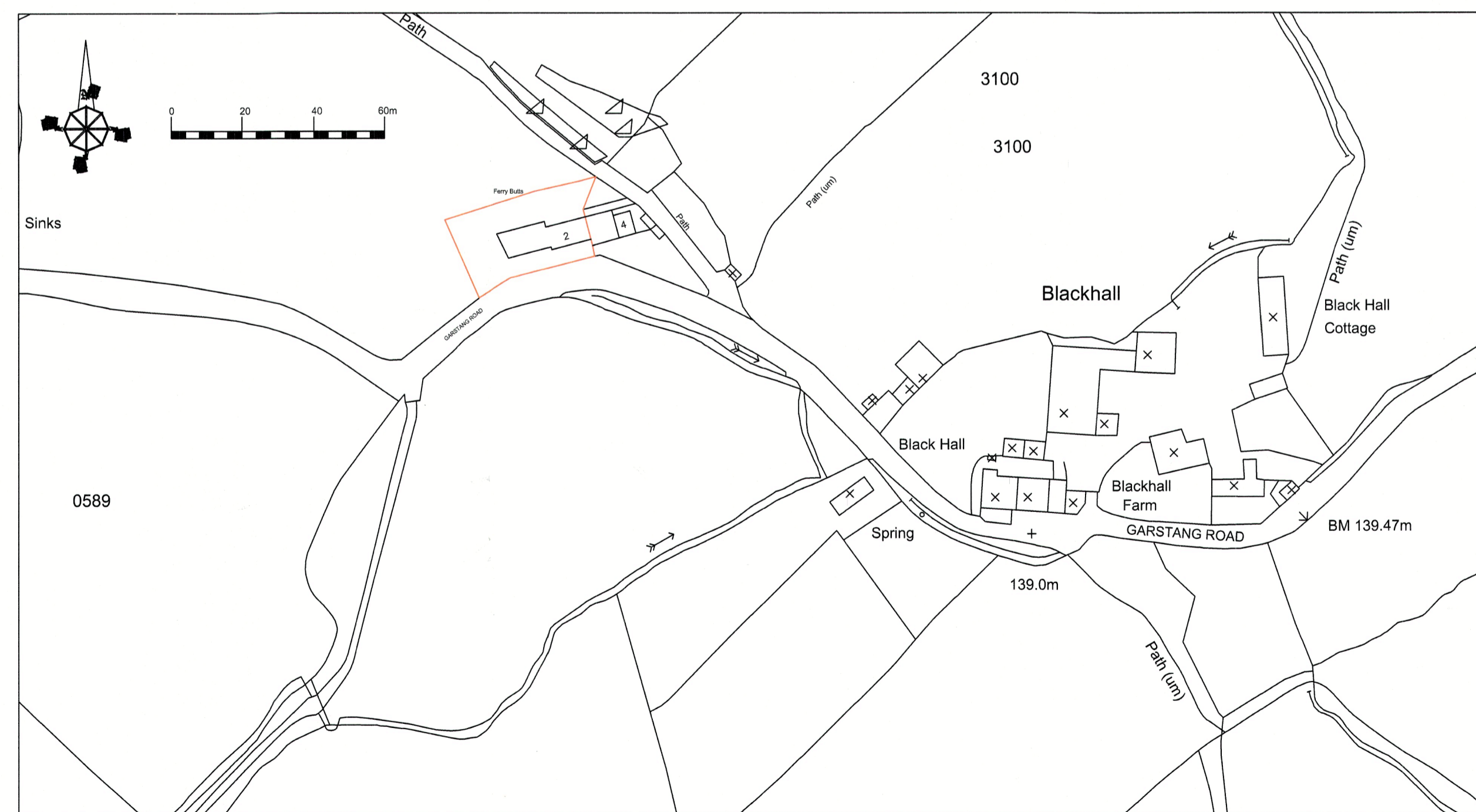

SCALE = 1:1250

320230738P

J. HADFIELD. ENGINEERING, SURVEYING.			
Spring House, Chipping, Lancashire. PR3 2GQ. Tel 07740 929096.			
Client's Details, Mr G. Gregson & Ms. S. Mercer			
Project Details, EXISTING, PROPOSED SITE, & LOCATION PLANS HOUSE EXTENSION			
Project Address, 1/2 FERRYBUTTS GARSTANG Rd CHIPPING			
Project Number, 545/203	Date, MAY/23	Scale, 1:500 1:1250	By, JH
DO NOT SCALE THIS DRAWING. CHECK ALL DIMENSIONS ON SITE			
<small>THIS DRAWING IS PROTECTED BY COPYRIGHT. IT MAY NOT BE REPRODUCED IN ANY FORM OR BY ANY MEANS FOR ANY PURPOSE, WITHOUT OBTAINING PRIOR WRITTEN PERMISSION FROM J. HADFIELD, ENGINEERING, SURVEYING.</small>			