

IF IN DOUBT - ASK

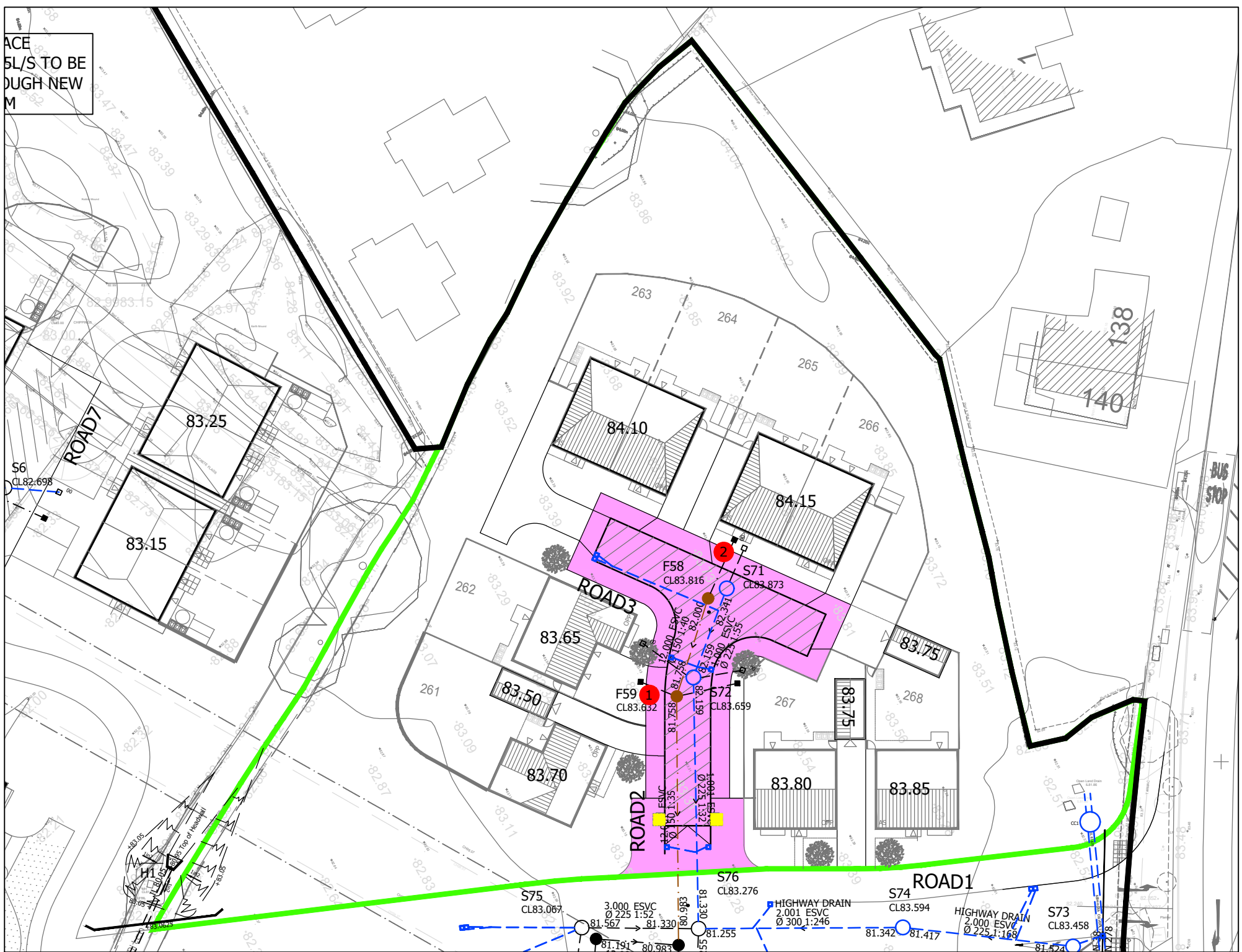
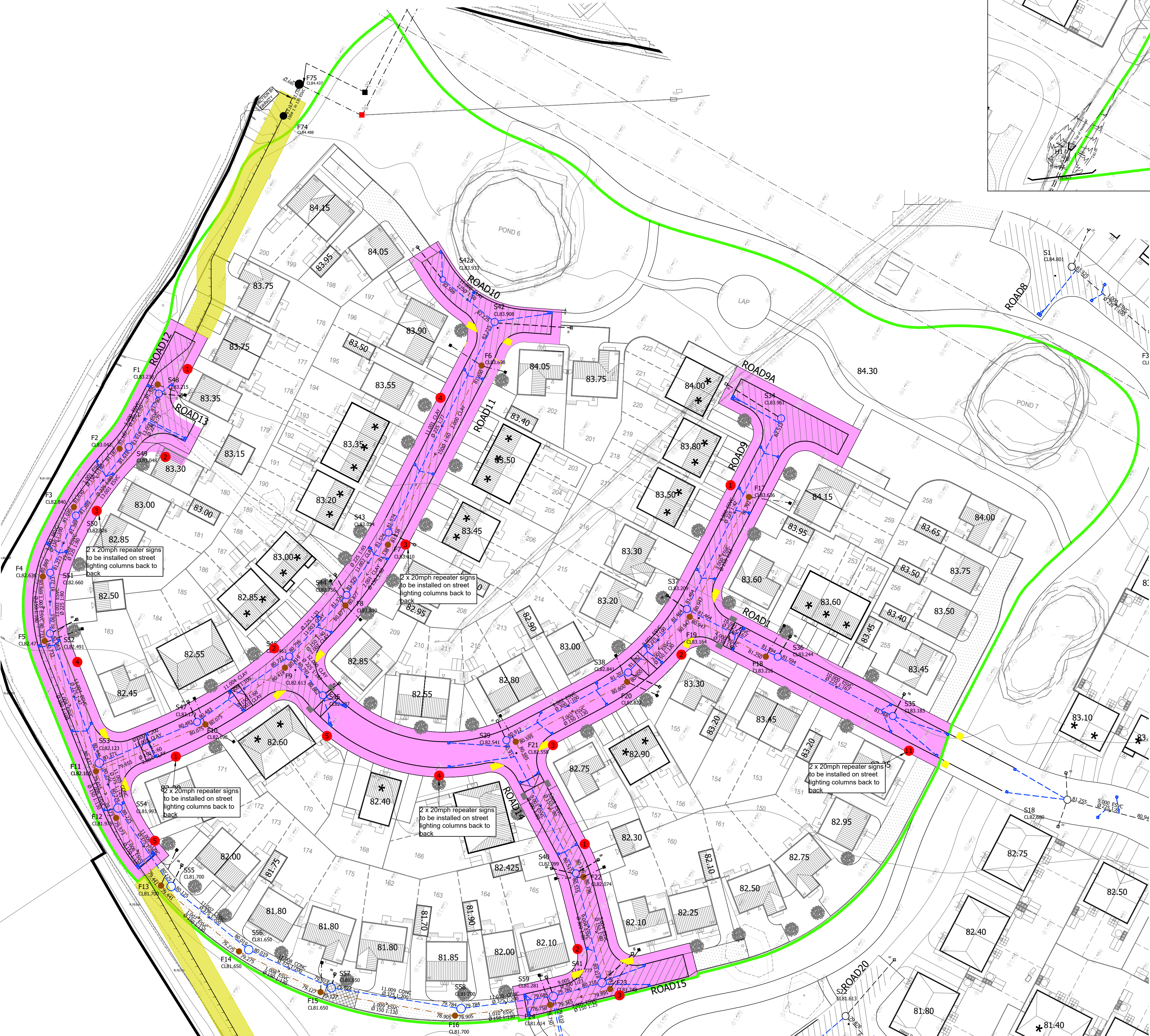

The details provided on this drawing are subject to comment by all the relevant approving authorities. Until such time as all comments have been received and incorporated onto the drawings, all the information provided and associated costings, are used at Kier Living Ltd risk and no liability will be accepted by Lees Roxburgh Ltd.

Prior to any construction, the contractor must confirm the precise location, invert level and pipe diameter of the receiving drainage system, and the existing combined network. Lees Roxburgh must be advised immediately of any variation to that which the design has been based.

| Section 38 Key:   |       |
|---|-------|
| Extents of Highway Adoption   |       |
| Extents of Off Road Footpath Adoption   |       |
| Highway Drainage Easements  |       |
| Proposed S38 Adoptable Highway Drain  |       |
| Adoptable Road Gully  |       |
| Adoptable Double Road Gully   |       |
| Proposed Site Boundary  |       |
| Proposed Street Lighting Column(Ref LCC - Road Lighting and Illuminated Traffic Sign Cabling Works - 1002.) |       |
| Proposed Tactile Paving   |       |
| Proposed Finished Floor Level   | 18.75 |
| Proposed S104 Adoptable Surface Water Sewer   |       |
| Proposed S104 Adoptable Foul Sewer  |       |
| Proposed S104 Adoptable Foul Rising Main  |       |
| Existing SW Drainage  |       |
| Existing Foul Drainage  |       |
| Proposed Surface Water Dragout  |       |
| Proposed Foul Dragout   |       |

- ### Notes
- This drawing is to be read in conjunction with the Construction (Design and Management) Regulations 2015.
- This drawing is to be read in conjunction with:- Lees Roxburgh drawing series 6196, architects and designers drawings and details.
  - Construction details to be in accordance with Lancashire design guide.
  - The contractor shall comply with the following:-
    - All operations should be carried out in accordance with the general health and safety policy of Kier Living Ltd and all relevant health and safety legislation.
    - The local authority and service companies are to be notified prior to commencement of work on site.
    - Prior to construction the actual positions and depths of services likely to be affected by the works should be established by means of hand dig in close liaison with the service companies. The contractor shall immediately advise Lees Roxburgh of any services exposed which may affect the design.
    - The location and depth of any services/apparatus shown is approximate only and has been based on plans received from the statutory undertakers.
    - Lees Roxburgh Ltd do not accept any responsibility for the accuracy of this or any other drawings which indicate the position and/or depth of services/apparatus.
    - The contractor must contact the relevant statutory undertakers and be in possession of the latest available drawings from the statutory undertakers which shows details of their services/apparatus.
  - All gravity sewerage works to be in accordance with "Sewers for Adoption" 6th Edition and United Utilities standard details. Foul Pump Station to be designed to "Sewers for Adoption" 7th Edition and United Utilities standard details.
  - Lees Roxburgh's appointment is restricted to the design of the permanent civil/structural works only and have no site role. The contractor is thus entirely responsible for compliance with the Health and Safety at Work Act. They shall be specifically responsible for all temporary works and for the stability of the affected land and structures.
  - For legal site boundary see deeds plans in possession of client.
  - All dimensions shown are in metres unless indicated otherwise.

HIGH FRICTION SURFACING IS REQUIRED TO ALL MANHOLES

| Rev | Revision                                | By | Date     |
|-----|---|----|----------|
| C   | Revised to suit new site layout (rev G) | AN | 15.12.23 |
| B   | Revised to suit new site layout (rev F) | AN | 29.09.23 |
| A   | Revised to suit new site layout (rev D) | AN | 31.08.23 |



Preston Road  
Longridge

Phase 3  
Section 38 Layout

**LeesRoxburgh**  
Consulting Engineers  
The Genesis Centre  
Science Park South  
Birchwood  
Warrington  
WA3 7BH

01925 812898  
office@leesroxburgh.co.uk  
www.leesroxburgh.co.uk

| Job No.          | Drawing No. | Revision.  |
|------------------|-------------|------------|
| 6196             | 300-08      | C          |
| Scale 1:500 @ A1 |             |            |
| Drawn By         | Designed By | Checked By |
| AN               | DM          | JL         |