

Proposed Care Home

Construction Traffic Management Plan CTMP

Issued To Discharge Planning Condition 3/2023/0305 No 7

Rev0 – 17th January 2024



Contents

- Site Details
- Project Team & Programme
- Details of the construction access including location, design and surfacing.
- Wheel cleaning measures to be employed.
- Control of heavy goods vehicle (HGV) movements in relation to peak hour traffic on Higher Standen Road and Ribblesdale School



No development shall commence on the site until such time as a construction traffic management plan, including as a minimum details of the routing of construction traffic, wheel cleansing facilities, vehicle parking facilities, and a timetable for their provision, has been submitted to and approved in writing by the Local Planning Authority. The construction of the development shall thereafter be carried out in accordance with the approved details and timetable.

REASON: to reduce the possibility of deleterious material (mud, stones etc.) being deposited in the highway and becoming a hazard for road users, to ensure that construction traffic does not use unsatisfactory roads and lead to on-street parking problems in the area.

Site Details

Proposed construction of a 68-bed residential care home, related infrastructure and landscaping at former Higher Standen Farm (adjacent Swardean Way Valley Lane Higher Peak Crescent South Gate Broadfield Street) Pendle Road Clitheroe BB7 1PR





Project Team

Client	Wrightcare
Architect	Cassidy & ashton
Structural Consultant	JPS
Landscape Architect	TEL
Principal Designer	Eric Wright Construction Ltd
Principal Contractor	Eric Wright Construction Ltd

Emergency Contact Number

EWC Operations Manager	Mark Green	Tel: 01772698822
EWC Project Manager	TBC	Tel: TBC

Project Programme

Site Commencement	2 nd Quarter 2024
Project Completion	4 th Quarter 2025



Details of the construction access including location, design and surfacing.

Access will be from the A59 down Pendle Road and then through the existing Estate Road, Higher Standen Drive.



Access to the site will be immediately of Higher Standen Road.

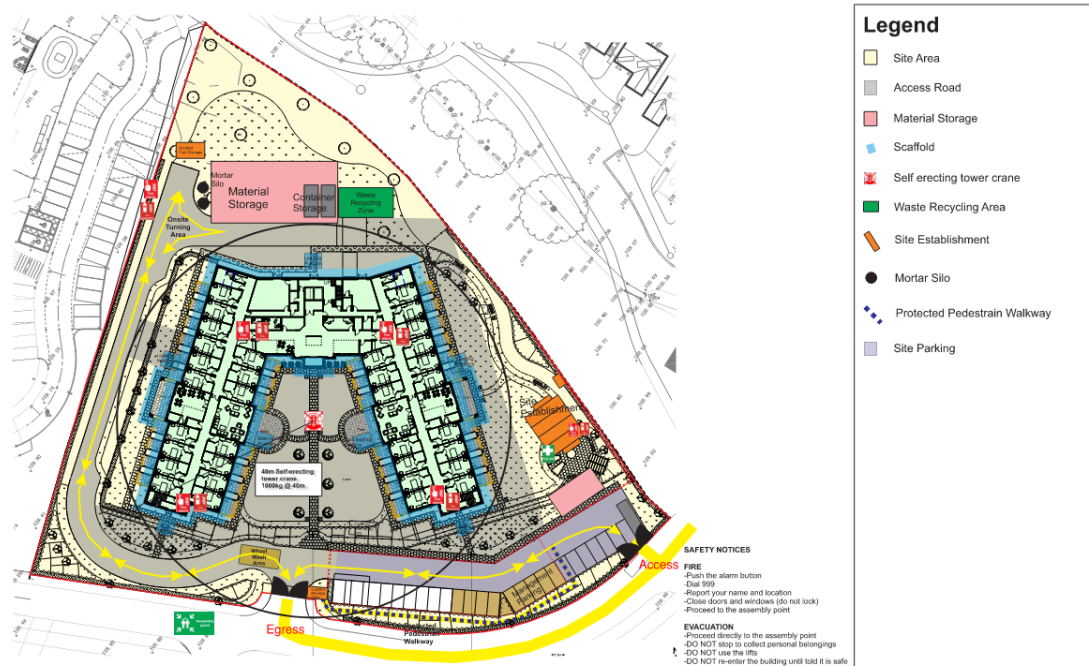



The onsite roads will be brought up to base course at early stage during the construction period to help ensure a clean, tidy site.

Wheel cleaning measures to be employed.

Eric Wright Group Ltd ensures that the working machinery, plant & vehicles, which may have the potential to cause an excessive dust, water and mud problem onto the public highway, will have the facility to wash down. This will be placed at a strategic point near to the road exit of the site, to prevent the mud being carried on to the road, with the addition of a road sweeper.

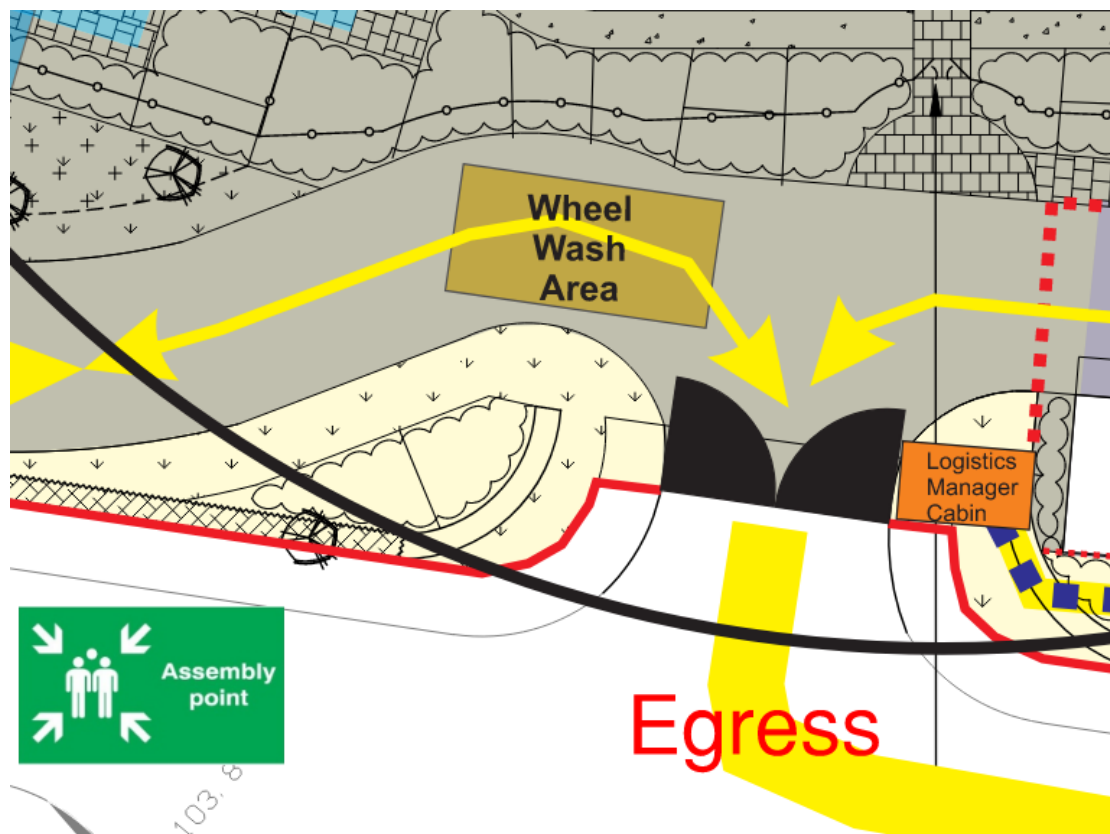

We have indicated on the proposed logistics plan the approximate location of the wheel wash area.

We will utilise an attendant with a spray gun as this will be sufficient to ensure the roads are kept clean. The gateman will manage this operation. This will be undertaken on a tarmac hardstanding area (to the area of the wheel wash only) with drainage channel connected to silt trap and water containment also ensuring water does not soak into the surrounding area.



Road Sweepers

Road sweepers will be used as required to keep hard standing areas free from build up as much as reasonably practicable both onsite and offsite. All collected build up will be tipped off site.

Control of heavy goods vehicle in relation to peak hour traffic on Higher Standen Road and Ribblesdale School

The project team will continually strive to ensure that our construction activities cause minimal disruption to the road traffic network and local community by working to the highest construction transport standards in procurement and ensuring CLOCS vehicle compliance is implemented. Our site logistics will be heavily regulated and controlled throughout the build process to ensure that our works do not cause disruption to local residents and other road users.

Movement of traffic to and from site will be restricted and controlled at sensitive times, (to be developed and agreed with Highways designated representative) and in any event deliveries will be programmed so as not to conflict with peak periods of the school day, generally between the hours of 8.00am till 9.30am and 3pm and 4.00pm. This will be agreed with Ribblesdale School prior to commencing works onsite.







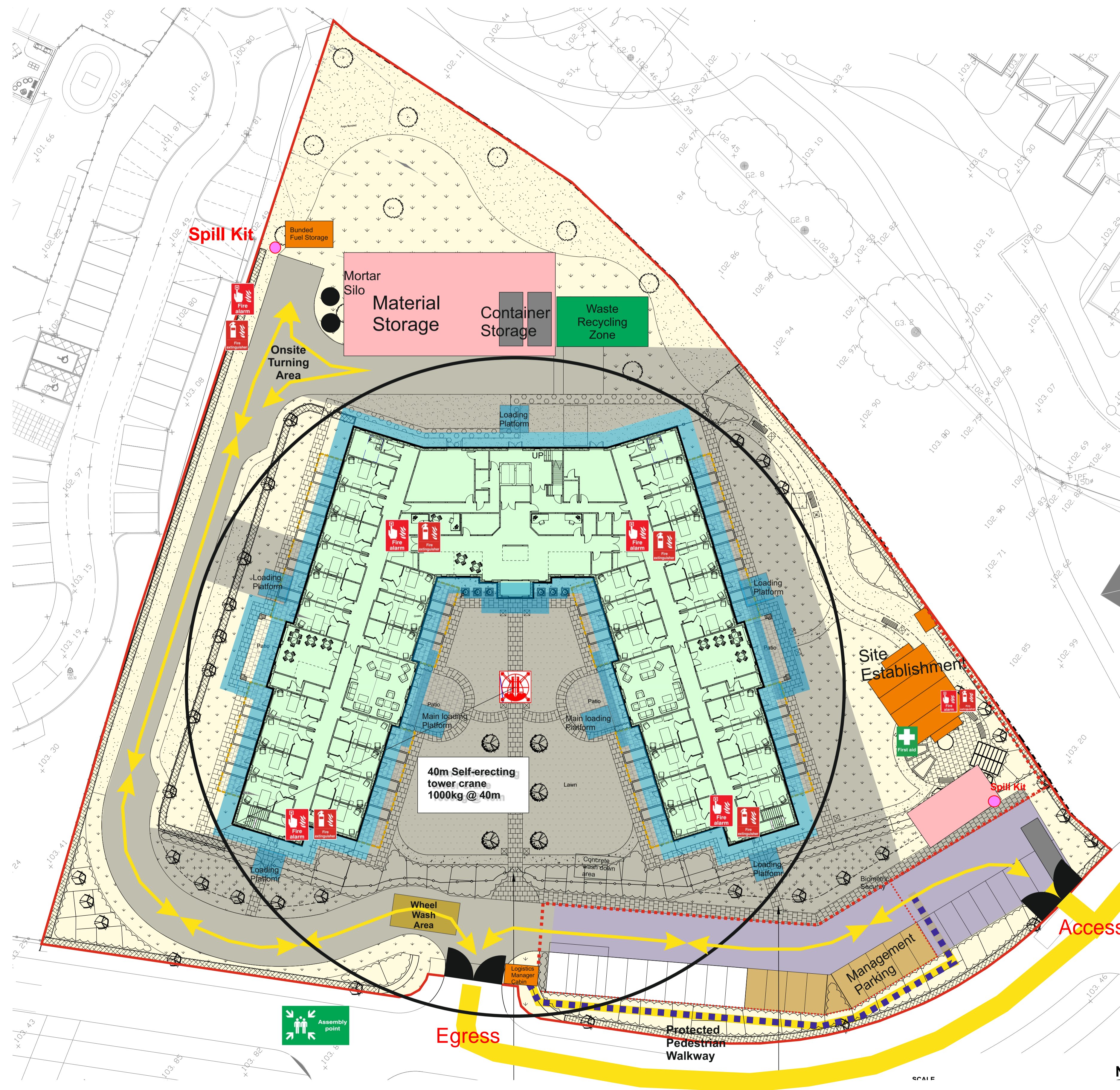



We will utilise a booking in system so site is ready to receive deliveries and bring them immediately within the site boundary upon arrival.

Care Home, Standen, Clitheroe

Draft Site Logistics Plan : Site Layout

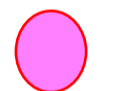

Legend

-  Site Area
-  Access Road
-  Material Storage
-  Scaffold
-  Self erecting tower crane
-  Waste Recycling Area
-  Site Establishment
-  Mortar Silo
-  Protected Pedestrian Walkway
-  Site Parking
-  Spill Kit

SAFETY NOTICES

FIRE

- Push the alarm button
- Dial 999
- Report your name and location
- Close doors and windows (do not lock)
- Proceed to the assembly point

EVACUATION

- Proceed directly to the assembly point
- DO NOT stop to collect personal belongings
- DO NOT use the lifts
- DO NOT re-enter the building until told it is safe