

2 1 PROPOSED FIRST FLOOR  
1 : 50

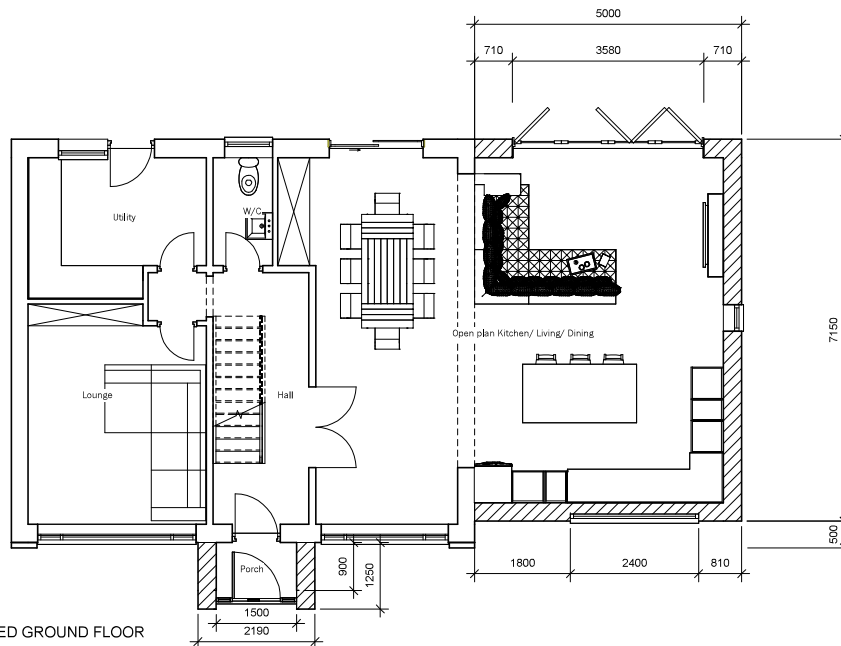

1 0 PROPOSED GROUND FLOOR  
1 : 50

Peter Hitchen  
Architects

Marathon House  
The Sidings Business Park  
Whalley, BB7 9SE

01254 823 885

www.peterhitchenarchitects.co.uk

NOTES:

For Planning approval only

No.	Description	Date

CLIENT:  
Mr & Mrs Rawlinson,  
38 Rogersfield,  
Langho, Lancashire,  
BB6 8HB

PROJECT:  
Proposed two-storey side  
extension and alterations

SHEET: Proposed floor plans

Project number PHA/910

Date 19/01/2024

Drawn by AW

Checked by PH

A2.2

Scale 1 : 50

Sheet size A1