

Safety, Health & Environmental Information:
 In addition to the hazards and risks normally associated with the types of work detailed on this drawing, please note the significant hazards identified by symbols below, and described below:

INDICATES A RESIDUAL RISK AS A WARNING

INDICATES A RESIDUAL RISK FOR INFORMATION

Construction/Maintenance/Cleaning/Demolition
 Refer to Drawing:

- General Notes:**
- Do not scale from this drawing.
 - All dimensions are in millimetres (mm), all levels in metres (m) unless noted otherwise.
 - Discrepancies or omissions are to be reported to the Engineer prior to work commencing.
 - Materials and workmanship are to comply in all respects with current British Standard Specifications, Codes of Practice, and Building Regulations Approved Documents.
 - The copyright of this drawing is vested in the Engineer and must not be copied or reproduced without written consent.
 - The Contractor is to check and verify all building and site dimensions, levels and sewer invert levels at connection points before work commences.
 - This drawing is to be read in conjunction with all relevant specifications and drawings issued by the Engineer, Architect and other Specialists.

- Notes:**
- The contractor is to check all information provided prior to commencing works, and seek clarification from the engineer in respect to any ambiguities found.
 - Assumed CBR for the site is < 2% - contractor to check insitu CBR at time of construction
 - Frost susceptibility - All materials, including sub-grade within 450mm of the finished road level shall be non-frost susceptible. Where the sub-grade is within 450mm of the finished road level, it shall be tested for frost susceptibility and if found to be so, shall be removed and replaced with suitable non-frost susceptible material to Clause 602.19 of the Specification for Highway Works.
 - Bituminous sealing grit to be applied to binder course if left exposed for more than 5 days.
 - Sub formation / formation shall be proof rolled and any soft spots removed and replaced with adequately compacted 6F2 material. Testing to be undertaken to ensure a minimum CBR of 2.5% is achieved at any point.
 - To ensure continuity of foundation drainage at all times, the bottom of new sub-base must not be above the bottom of existing sub-base, therefore thickness of new sub-base to be increased to match bottom of existing sub-base where necessary.
 - All bound surfaces shall be treated with Polymer modified bond coat prior to placing of each successive layer to BS434 and in accordance SHW clause 920.
 - All Retaining Walls to have Edge protection to Architecture Details

P01	DHAM	26/01/2024	Preliminary Issue
Rev	By / Chkd	Date	Description

PRELIMINARY DRAWING
 This drawing is not to be used for construction



BarnsleyMarshall Limited
 1 Birch Court
 Blackpole East
 Worcester
 WR3 8SG

Tel: 01905 330550
 Email: design@barnsleymarshall.co.uk
 Web: www.barnsleymarshall.co.uk



Project
Cow Shed
 Elmridge Lane, Preston,
 PR3 2NY

Drawing
External Works 01
 Site Sections & Construction Details

By/Chkd	RA/GM	Date	05/04/2023
Drawing No.	CSH-BML-XX-XX-DR-C-0702		Revision P01
BML Job No.	1000-05		Status -
Drawing Scale at A1:	As Shown		
CAD Filename:	P:\Projects\2023\05\04\CSH-BML-XX-XX-DR-C-0702-01.dwg		

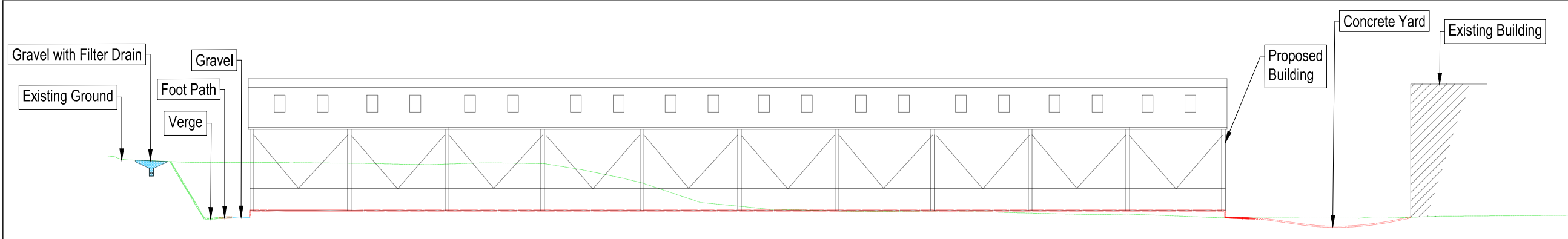

Site Section A-A
 Scale: 1:500

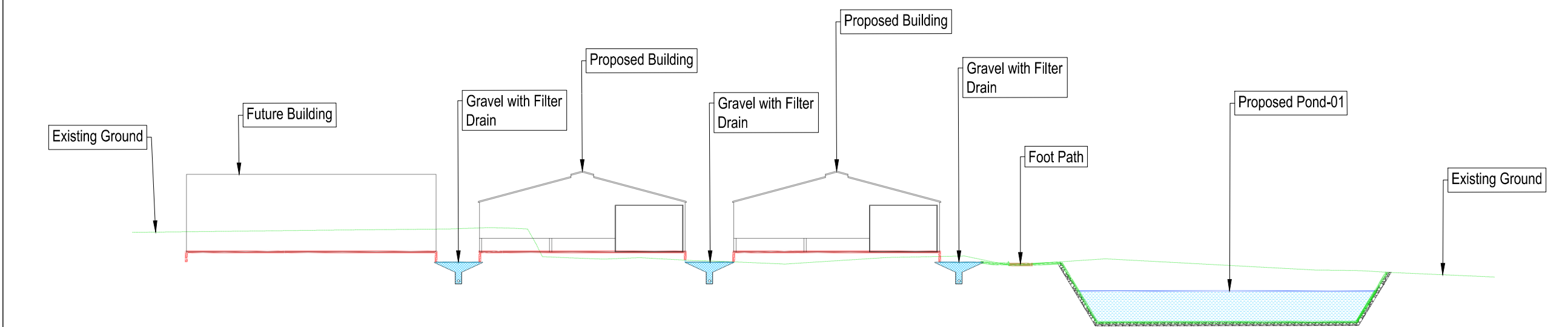

Site Section B-B
 Scale: 1:500

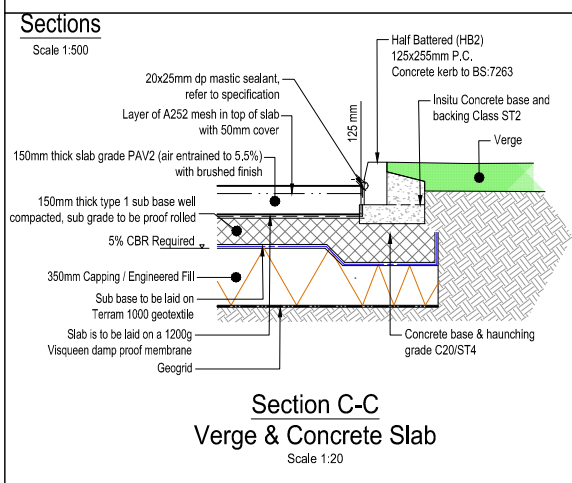

Section C-C
 Verge & Concrete Slab
 Scale 1:20

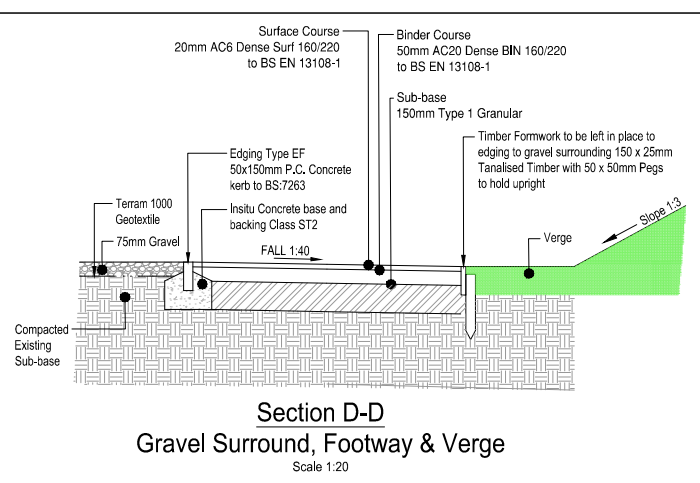

Section D-D
 Gravel Surround, Footway & Verge
 Scale 1:20

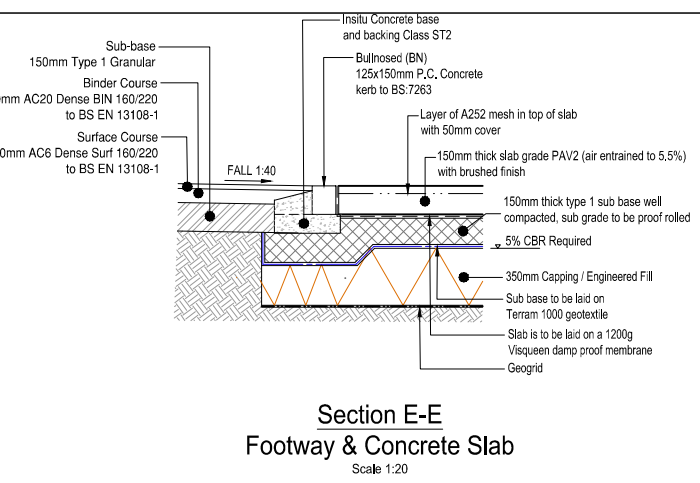

Section E-E
 Footway & Concrete Slab
 Scale 1:20

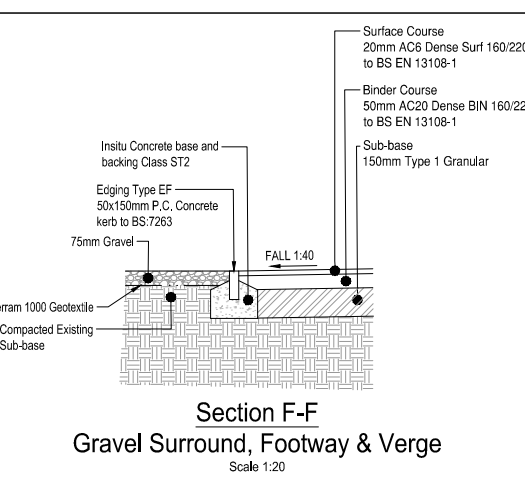

Section F-F
 Gravel Surround, Footway & Verge
 Scale 1:20