

For Proposed Buildings External Works details, refer to drawing CSH-BML-XX-XX-DR-C-0700

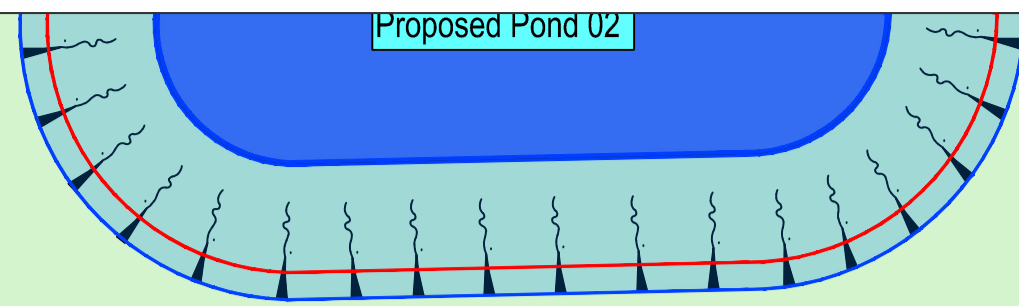

104.250

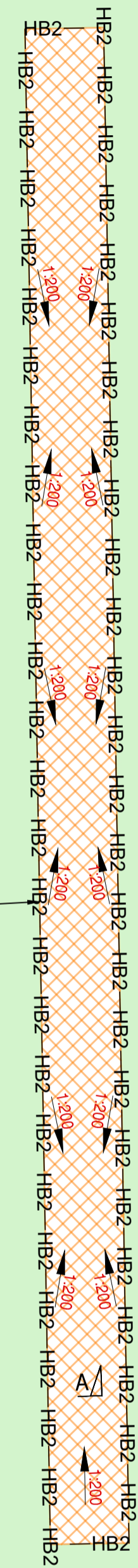

Track

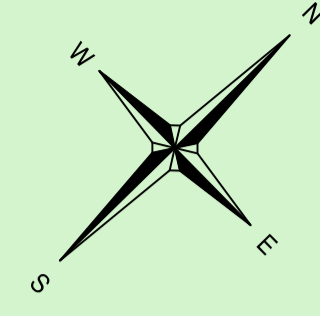

Safety, Health & Environmental Information:

In addition to the hazards and risks normally associated with the types of work detailed on this drawing, please note the significant hazards identified by symbols below.

INDICATES A RESIDUAL RISK AS A WARNING

INDICATES A RESIDUAL RISK FOR INFORMATION

and described below:

Construction/Maintenance/Cleaning/Demolition
Refer to Drawing:

General Notes:

- Do not scale from this drawing.
- All dimensions are in millimetres (mm), all levels in metres (m) unless noted otherwise.
- Discrepancies or omissions are to be reported to the Engineer prior to work commencing.
- Materials and workmanship are to comply in all respects with current British Standard Specifications, Codes of Practice, and Building Regulations Approved Documents.
- The copyright of this drawing is vested in the Engineer and must not be copied or reproduced without written consent.
- The Contractor is to check and verify all building and site dimensions, levels and sewer invert levels at connection points before work commences.
- This drawing is to be read in conjunction with all relevant specifications and drawings issued by the Engineer, Architect and other Specialists.

Notes:

- The contractor is to check all information provided prior to commencing works, and seek clarification from the engineer in respect to any ambiguities found.
- Assumed CBR for the site is < 2% - contractor to check in situ CBR at time of construction
- Frost susceptibility - All materials, including sub-grade within 450mm of the finished road level shall be non-frost susceptible. Where the sub-grade is within 450mm of the finished road level, it shall be tested for frost susceptibility and if found to be so, shall be removed and replaced with suitable non-frost susceptible material to Clause 602.19 of the Specification for Highway Works.
- Bituminous sealing grit to be applied to binder course if left exposed for more than 5 days.
- Sub formation / formation shall be proof rolled and any soft spots removed and replaced with adequately compacted 6F2 material. Testing to be undertaken to ensure a minimum CBR of 2.5% is achieved at any point.
- To ensure continuity of foundation drainage at all times, the bottom of new sub-base must not be above the bottom of existing sub-base, therefore thickness of new sub-base to be increased to match bottom of existing sub-base where necessary.
- All bound surfaces shall be treated with Polymer modified bond coat prior to placing of each successive layer to BS434 and in accordance SHW clause 920.
- All Retaining Walls to have Edge protection to Architecture Details

Rev	By / Chk'd	Date	Description
P03	DH/AM	26/02/2024	External Details updated
P02	DH/AM	06/02/2024	External Details updated
P01	DH/AM	15/08/23	Preliminary Issue

PRELIMINARY DRAWING
This drawing is not to be used for construction

Client



BarnsleyMarshall Limited
1 Birch Court
Blackpole East
Worcester
WR3 6SG



Tel: 01905 330560
Email: design@barnsleymarshall.co.uk
Web: www.barnsleymarshall.co.uk

Project

Cow Shed
Elmridge Lane, Preston,
PR3 2NY

Drawing

External Works 02
Slurry Tanks

By/Chk'd	RA/GM	Date	05/04/2023
----------	-------	------	------------

Drawing No. CSH-BML-XX-XX-DR-C-0701 Revision P03

BML Job No. 1000-05 Status -

Drawing Scale at A1: As Shown

CAD Filename: Y:\Project\100-05 Cow Shed\external - External Works\CSH-BML-XX-XX-DR-C-0701-03.dwg

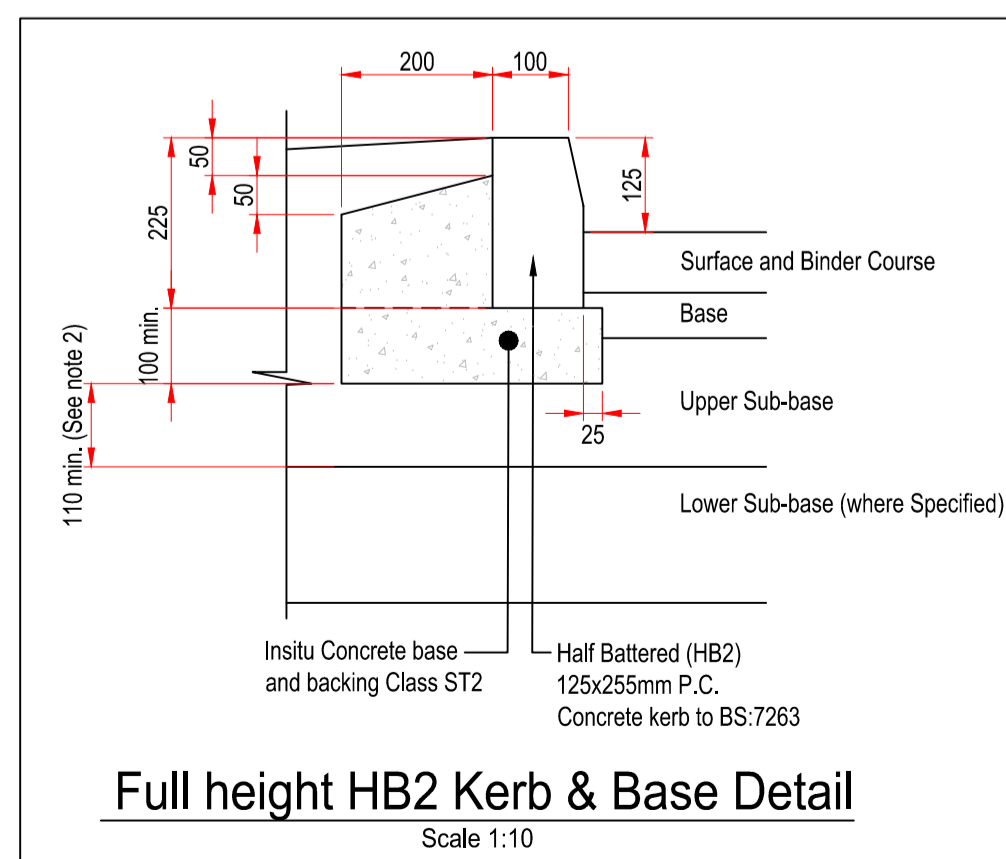
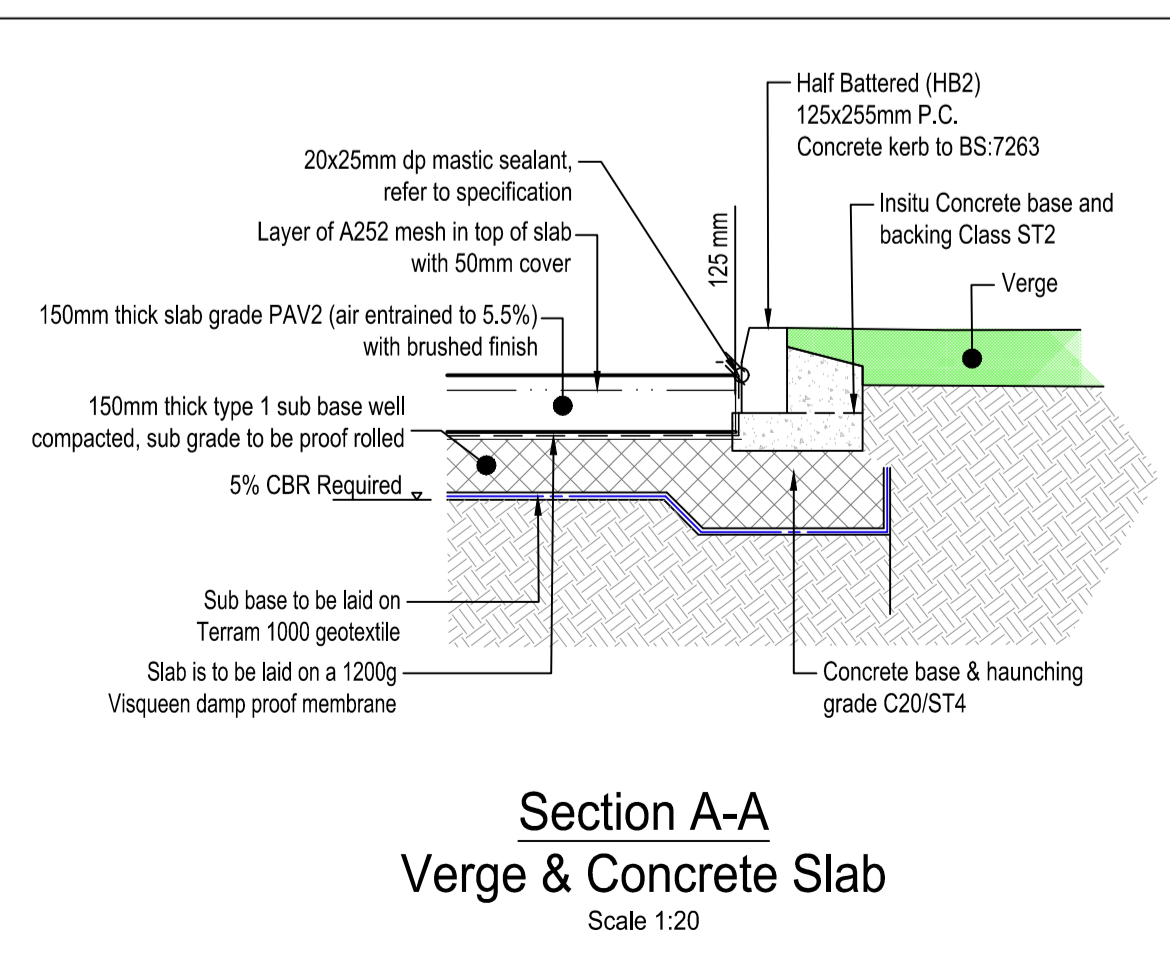
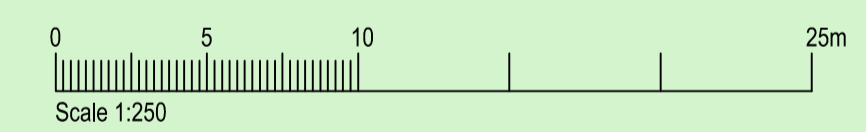

Key:	
	Proposed Slurry Tank
	Proposed Concrete Slab
	Existing and Proposed Green Areas
	Proposed Gravel Surround
	Proposed HB2 kerbs with 125mm upstand
	Design Levels