

Garage Roof Space Plan
1:50 Scale

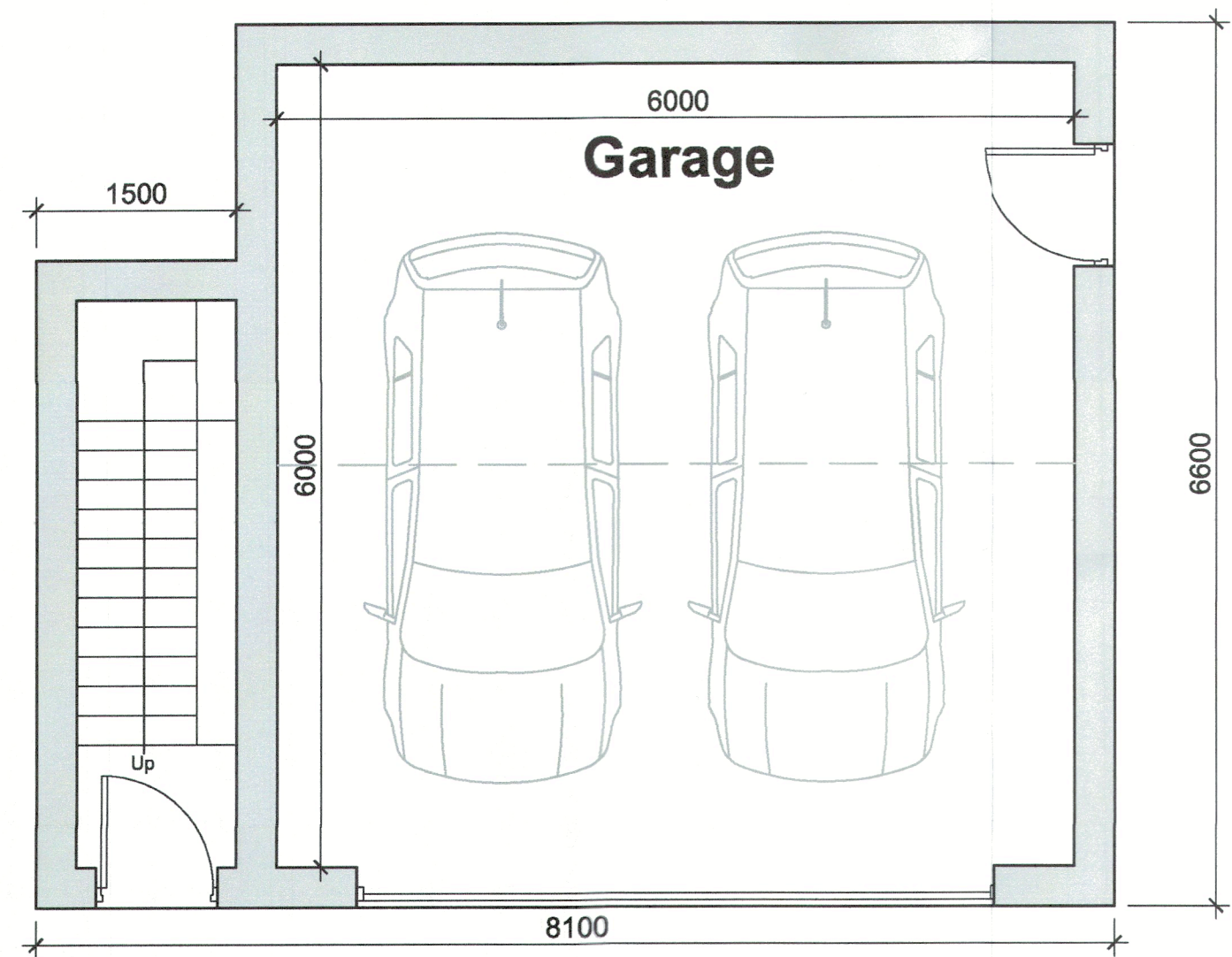

Garage Floor Plan
1:50 Scale

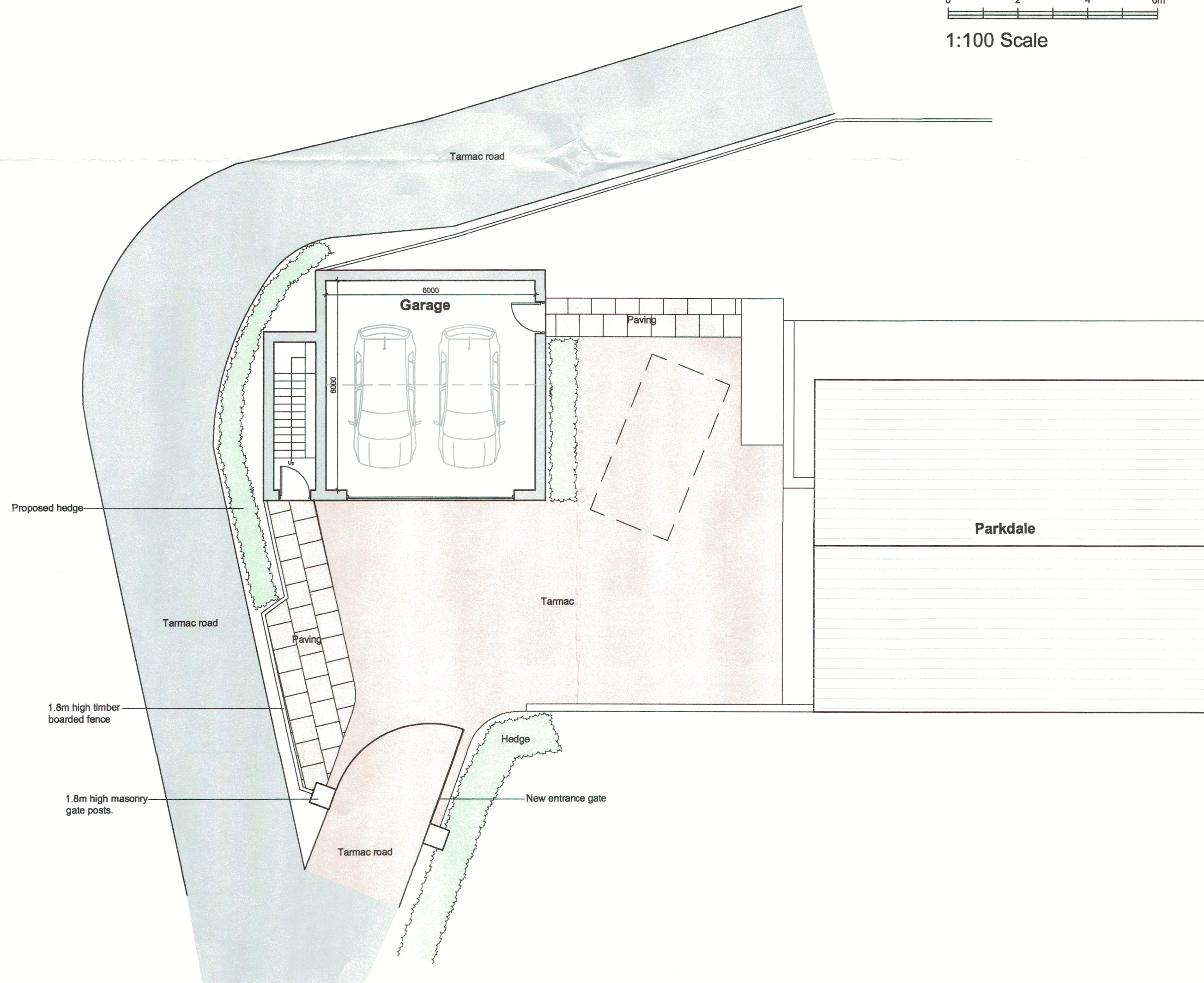

Part Site Plan
1:100 Scale

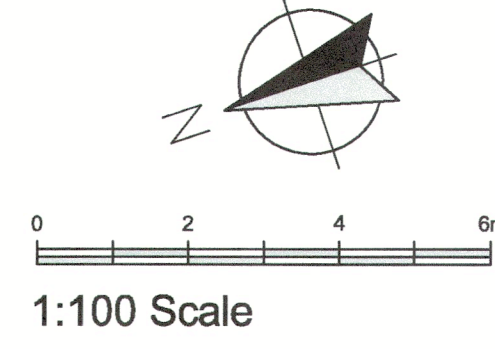

1:100 Scale

1FE Schwegler Bat Access Panel About this product

On its own, the 1FE Access Panel provides access for bats to existing roost sites. With a specially shaped entrance hole and open back, bats can crawl through the entire panel. This is particularly useful when renovation or conservation work is being undertaken in buildings already containing bat roosts. With an overall depth of just 8 cm, it is easily integrated within masonry or insulation. If necessary it can also be attached to the underlying structure using two screws. The light grey material can be over-painted as required using air-permeable exterior wall paint. The design includes a silhouette of a bat which is both decorative and informative. Alternatively the 1FE can be set into masonry and rendered so that only the entrance is visible.

With the addition of an [Optional Back Plate](#), the 1FE can be used to create new roosts for bats.

The 1FE Bat Access Panel is made from Schwegler wood-concrete, an exceedingly durable, rot-proof and breathable natural material designed to mimic the properties of natural nest sites. The design is maintenance-free with a sloping shelf to allow droppings to fall out. The 1FE can also be fixed to the underlying structure using two screws (not included).

Specification

1FE Panel without optional back plate:

* External dimensions: 30 x 30 x 8cm,
* Weight: 5.1 kg

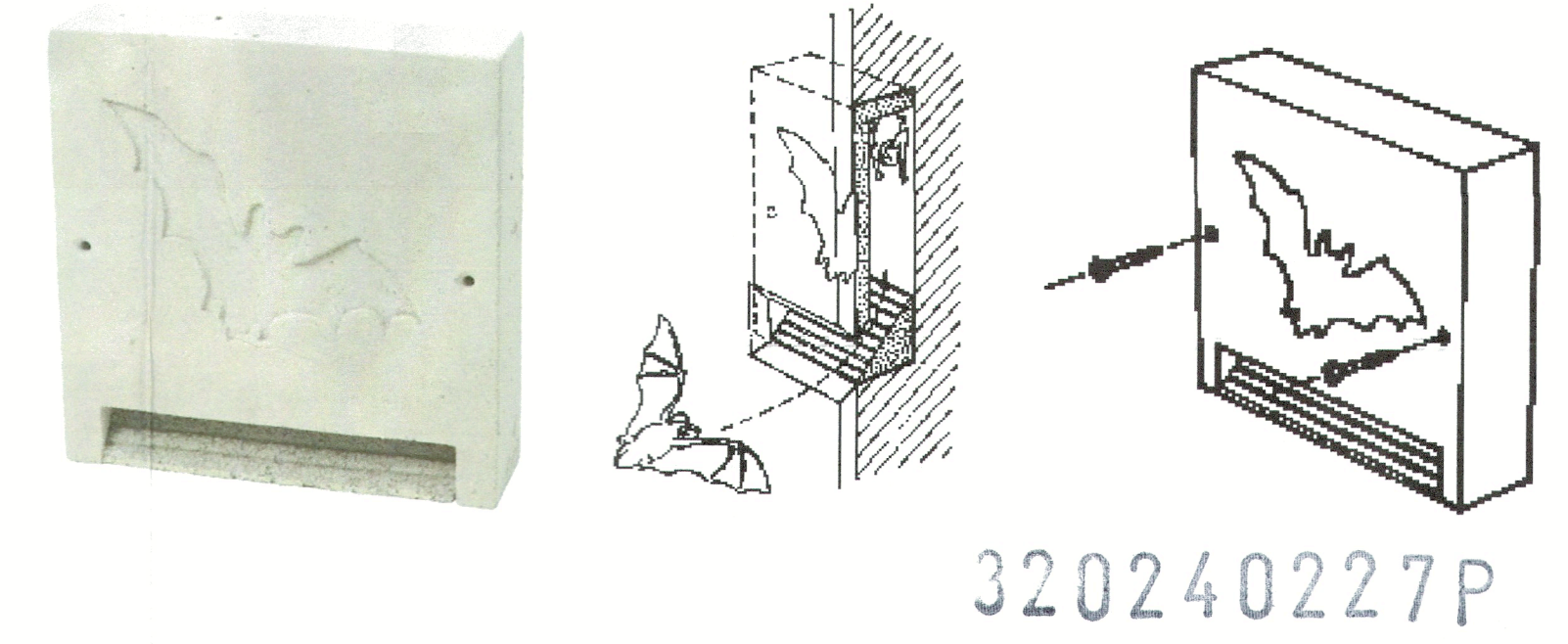

Client Mr David Smyth		
Job Title Parkdale Waddington Road Clitheroe BB7 2JE		
Showing The Proposed Garage		
Scale Various @ A1	Date Feb 2024	Drawn Craig Harrison
spa ARCHITECTS SUNDERLAND PEACOCK & ASSOCIATES LTD. WADDINGTON ROAD, WADDINGTON, CLITHEROE, LANCASHIRE, BB7 2JE 01524 427171 01524 427128 info@spaarchitects.co.uk		
7014 -002		