

Site Area -  
4044m<sup>2</sup> (0.40 hectares)

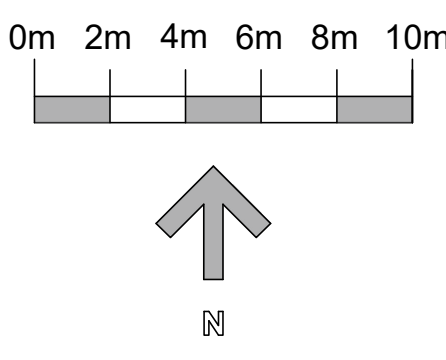

# MÜLLER

L	16/05/24	Site plan updated to accommodate updated plans	LW	JB
K	18/04/24	Site plan updated to accommodate updated plans	LW	JB
J	19/01/24	Site boundary updated	LW	JB
I	18/01/24	Site area updated	LW	JB
H	12/01/24	Site Boundary updated	LW	JB
G	07/11/23	Drawing updated according to client comments	CFF	JB
F	18/06/23	Turning head has been added to the drawing as per the Transport Consultant Report	ES	JB
E	05/05/23	Garden Terrace/Retaining Walls added	ES	JB
D	03/05/23	EV charge point added	ES	JB
C	01/12/22	Layout amended to accommodate client comments	PB	JB
B	06/09/22	Redline boundary has been updated to suit the title plan	JB	JB
A	08/08/22	Site Plan has been updated to accommodate planning officer's comments.	CM	JB
-	17/06/22	Original Drawing	CM	JB
Rev	Date	Revision Description	Drawn By	Approved By

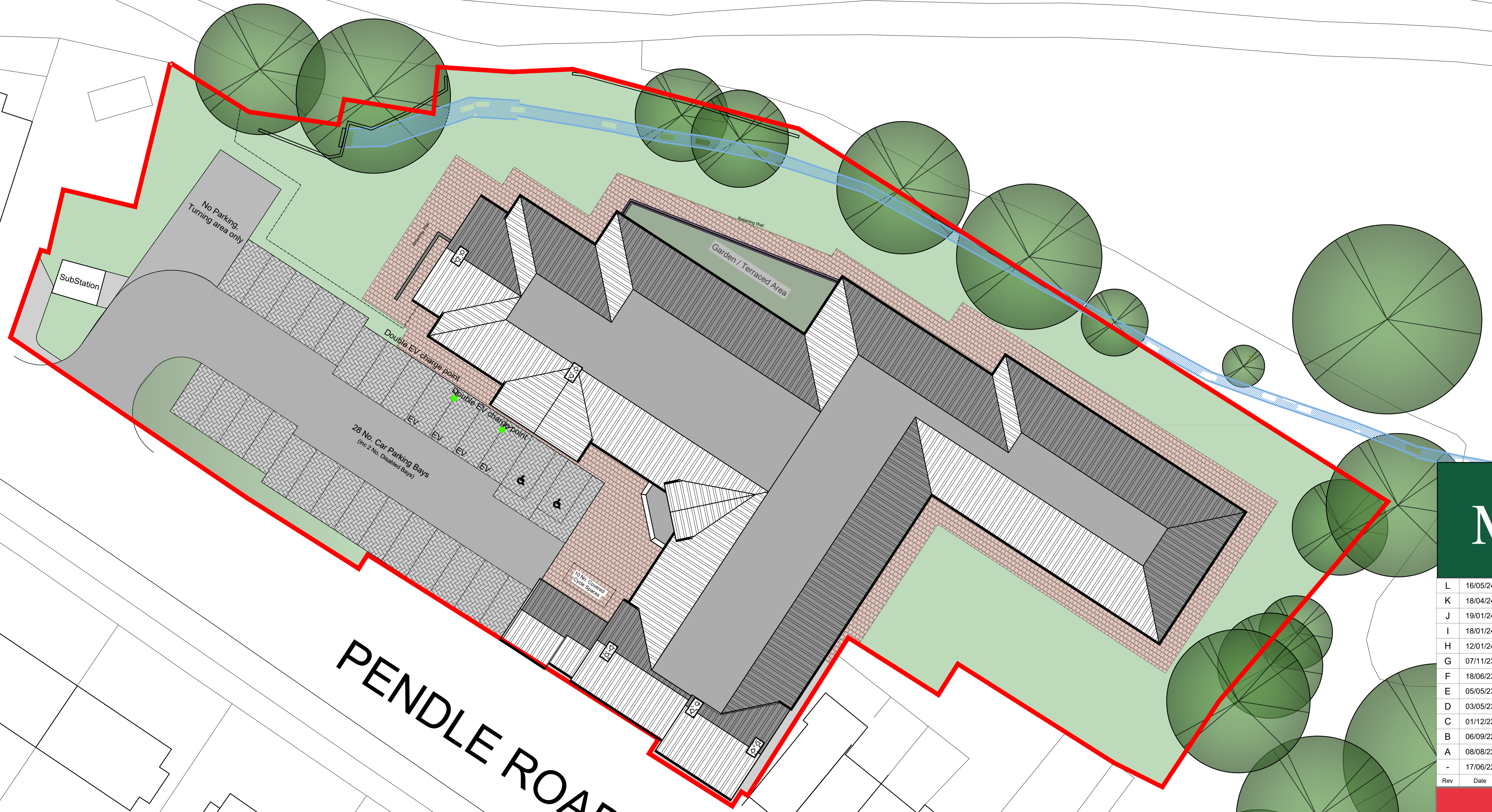

**ADG ARCHITECTS**  
6 Pioneer Court, Darlington, DL1 4WD  
t: 01325 464 111  
e: studio@adgarchitects.co.uk  
w: www.adgarchitects.co.uk

Client  
Muller Property Group

Project Information  
Proposed 75 Bed Care Home, Pendle Road, Clitheroe

Drawing Title  
Proposed Site Plan

A1 Scale 1:200	A3 Scale	
Job Number H.21.78	Drawing Number (9-) 3	Revision L
Drawing Issue PLANNING		

© Copyright 2018 ADG Architects Ltd